



**COLDWELL BANKER
COMMERCIAL**
DEVONSHIRE
REALTY

Small Warehouse Space with 12'x12' Overhead Door Available in Chatham

FOR LEASE



231 E. Walnut St

Chatham, IL 62629

3,000 SF

WAREHOUSE

AVAILABLE SPACE

3,000 SF

LEASE PRICE

\$5.00 / SF

LEASE TYPE

Modified Gross

PARKING

On-Site

TAX PIN

29-07.0-176-072

ZONING

I-1 (Village of Chatham)

PROPERTY DESCRIPTION

This open warehouse space features a 60' L x 50' W clear-span layout with a 12' x 12' drive-in overhead door and approximately 14' of clear height to the bottom of the wood trusses. The space includes a floor drain, making it ideal for vehicle or boat storage. Tenants are responsible for their own electrical service and have access to shared common-area restrooms.

AREA DESCRIPTION

The site is located near the intersection of E. Walnut Street and N. Main Street, just east of the railroad tracks. It is situated in a busy commercial area with nearby medical facilities, community banks, and a variety of retail, restaurant, and service businesses.



BLAKE PRYOR, CCIM

217.725.9518

bpryor@cbcdr.com

cbcdr.com



**COLDWELL BANKER COMMERCIAL
DEVONSHIRE REALTY**
Springfield, IL
217-547-6650

©2026 Coldwell Banker. All Rights Reserved. Coldwell Banker Commercial® and the Coldwell Banker Commercial logos are trademarks of Coldwell Banker Real Estate LLC. The Coldwell Banker® System is comprised of company owned offices which are owned by a subsidiary of Anywhere Advisors LLC and franchised offices which are independently owned and operated. The Coldwell Banker System fully supports the principles of the Equal Opportunity Act.



**COLDWELL BANKER
COMMERCIAL**
DEVONSHIRE
REALTY

Small Warehouse Space with 12'x12' Overhead Door Available in Chatham

FOR LEASE

FLOOR PLAN

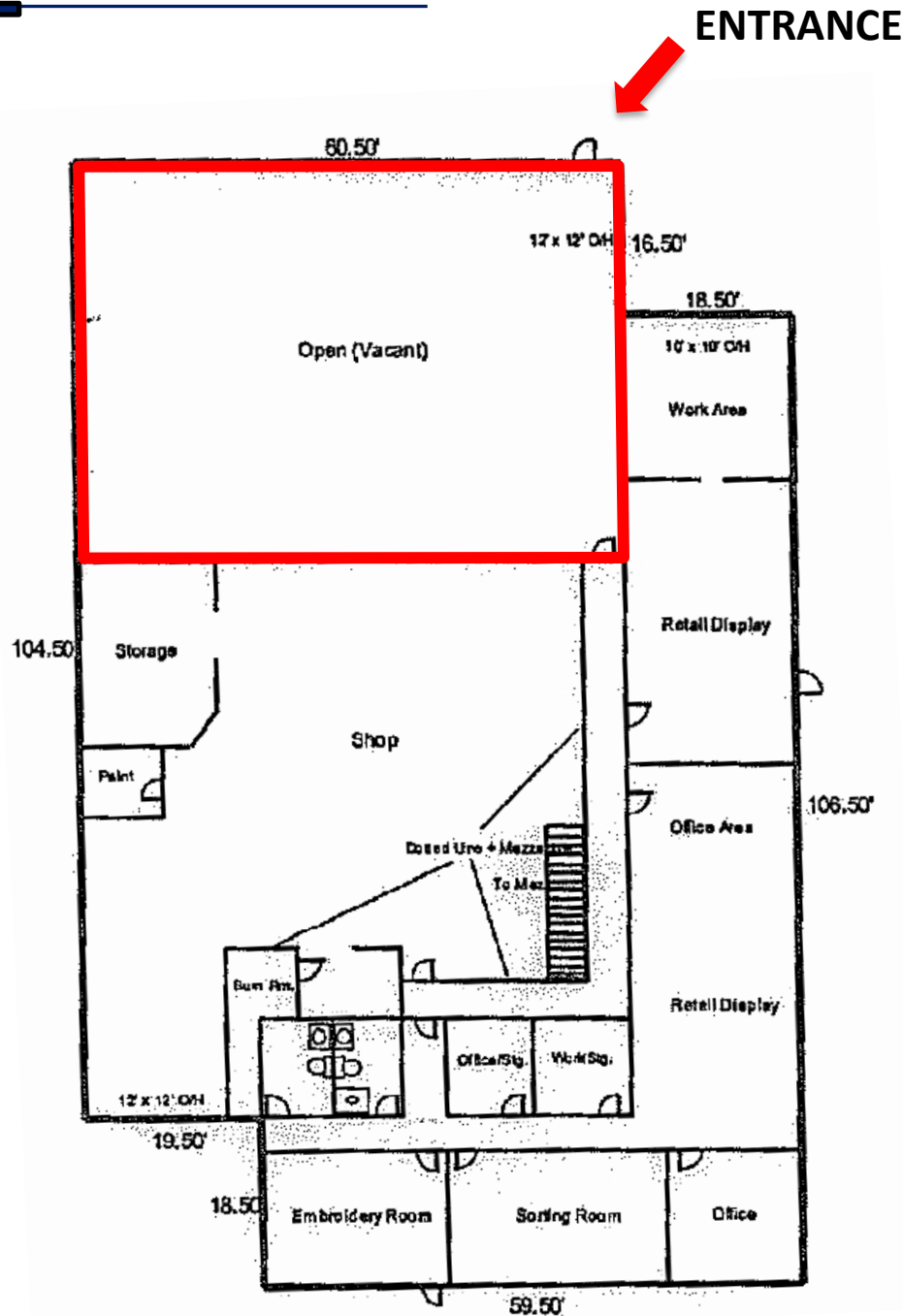

BLAKE PRYOR, CCIM
217.725.9518
bpryor@cbcdr.com
cbcdr.com





**COLDWELL BANKER
COMMERCIAL**
DEVONSHIRE
REALTY

Small Warehouse Space with 12'x12' Overhead Door Available in Chatham

FOR LEASE

PHOTOS



BLAKE PRYOR, CCIM
217.725.9518
bpryor@cbcdr.com
cbcdr.com

