



FOR LEASE

**950**  
**LAKE**  
**DRIVE**  
**EAST**

Chanhassen, MN 55317





# PROPERTY HIGHLIGHTS

- Owned by Nicola Wealth
- Heavy power available
- Easy access to Hwy 5, Hwy 212, and Hwy 41
- Climate controlled warehouse and production area
- Many area amenities nearby

## LAKE DRIVE : FEATURES

<b>ADDRESS</b>	950 Lake Dr. E, Chanhassen
<b>BUILDING TOTAL SF</b>	192,171 SF Total
<b>CLEAR HEIGHT</b>	24' - 26'
<b>YEAR BUILT</b>	1988/2001
<b>LEASE RATES</b>	Negotiable
<b>2025 ESTIMATED TAX &amp; CAM</b>	\$1.29 PSF Tax \$1.78 PSF CAM \$3.07 PSF Total
<b>POWER</b>	3,500A/480V 3P Heavy
<b>COLUMN</b>	30' x 40'

## VACANCIES

<b>SUITE</b>	950
<b>AVAILABILITY</b>	36,332 SF Office 3,589 SF 2nd Level Office 152,250 SF Warehouse 192,171 SF Total

# SUITE 950

36,332 SF OFFICE

152,250 SF WAREHOUSE

3,589 SF 2ND LEVEL OFFICE

---

**192,171 SF TOTAL**

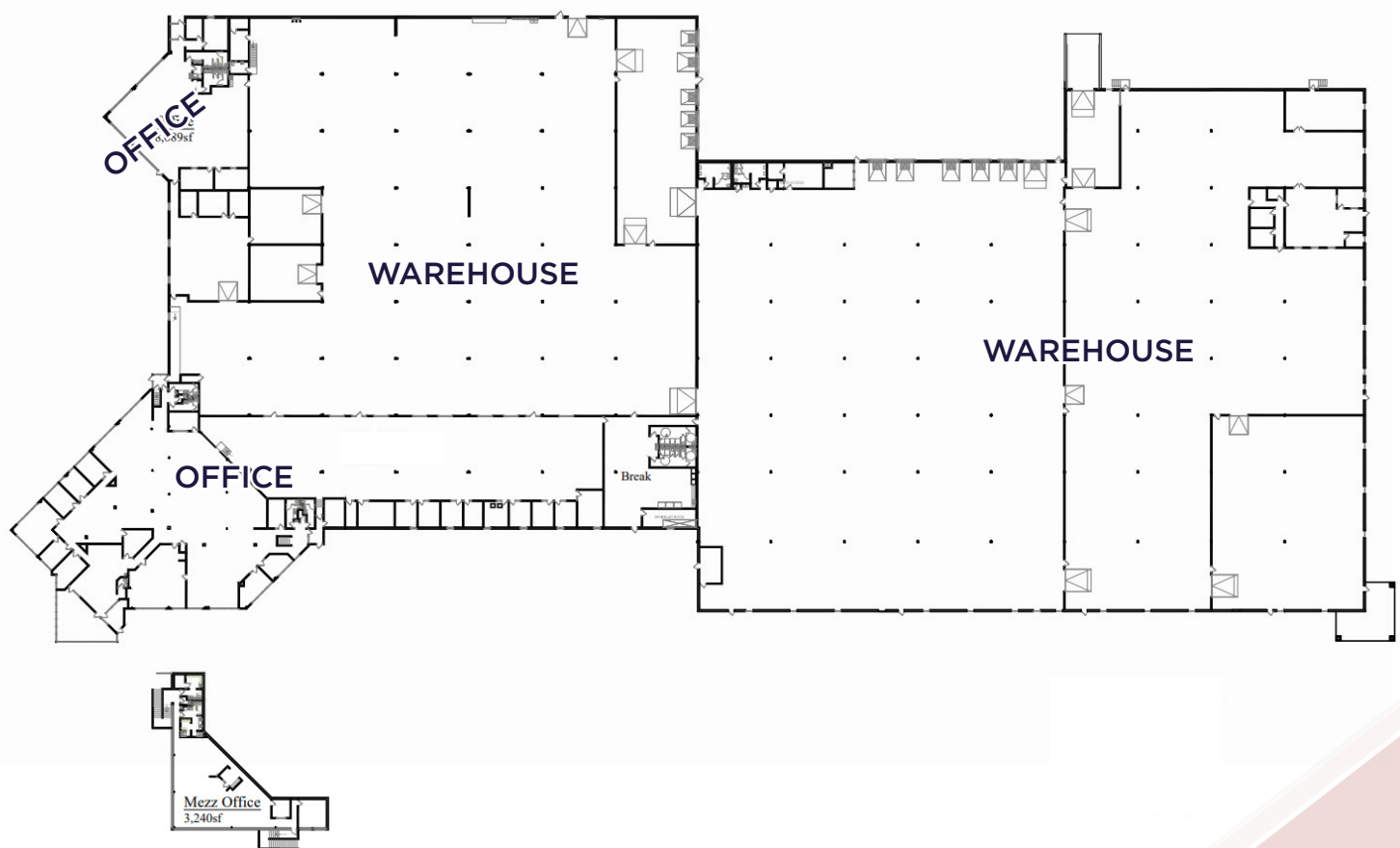



# PHOTOS





**FOR MORE INFORMATION, PLEASE CONTACT:**

**KRIS SMELTZER**

Executive Managing Director

+1 952 837 8575

[kris.smeltzer@cushwake.com](mailto:kris.smeltzer@cushwake.com)

**HUDSON BROTHEN**

Executive Director

+1 952 893 8261

[HUDSON.BROTHEN@cushwake.com](mailto:HUDSON.BROTHEN@cushwake.com)

**CUSHMAN & WAKEFIELD**

3500 American Boulevard W, Suite 200

Minneapolis, MN 55431

[cushmanwakefield.com](http://cushmanwakefield.com)



©2024 Cushman & Wakefield. All rights reserved. The information contained in this communication is strictly confidential. This information has been obtained from sources believed to be reliable but has not been verified. NO WARRANTY OR REPRESENTATION, EXPRESS OR IMPLIED, IS MADE AS TO THE CONDITION OF THE PROPERTY (OR PROPERTIES) REFERENCED HEREIN OR AS TO THE ACCURACY OR COMPLETENESS OF THE INFORMATION CONTAINED HEREIN, AND SAME IS SUBMITTED SUBJECT TO ERRORS, OMISSIONS, CHANGE OF PRICE, RENTAL OR OTHER CONDITIONS, WITHDRAWAL WITHOUT NOTICE, AND TO ANY SPECIAL LISTING CONDITIONS IMPOSED BY THE PROPERTY OWNER(S). ANY PROJECTIONS, OPINIONS OR ESTIMATES ARE SUBJECT TO UNCERTAINTY AND DO NOT SIGNIFY CURRENT OR FUTURE PROPERTY PERFORMANCE.