

2570 BOEING WAY | STOCKTON, CA

36,000± SF Building on 2.48± Acres - FOR SUBLEASE!

| | |
|---------------------------|---|
| BUILDING SF: | 36,000± SF (120' x 300') |
| OFFICE SF: | 1,000± SF |
| SITE: | 2.48± acres |
| GRADE LEVEL DOORS: | Five (5) 12' x 14' |
| DOCK HIGH DOORS: | Ten (10) 8' x 10' |
| CLEAR HEIGHT: | 23'.6"± |
| ZONING: | IG (Industrial General- City of Stockton) |
| POWER: | 800 amp, 120/208 volt, 3 phase |

FEATURES:

- Located in the Airport Business Center
- Fenced/gated yard - 2 gated entrances
- Generous truck staging area - full drive around capability
- Close to Hwy 99 with easy access to I-5 via Arch/Sperry connector

SUBLEASE RATE: ~~\$0.80 psf, NNN~~ \$0.70 psf, NNN

SUBLEASE EXPIRES: 11/1/2027

For further information, contact:

Jim Martin, SIOR
BRE # 01214270
jmartin@lee-associates.com
D 209.983.4088
C 925.352.6948

***Adjacent 58,625 sf on 4.72 acres
also available**



2570 BOEING WAY | STOCKTON, CA

36,000± SF Building on 2.48± Acres - FOR SUBLEASE!



2570 BOEING WAY | STOCKTON, CA

36,000± SF Building on 2.48± Acres - FOR SUBLEASE!

LOCAL STREET MAP

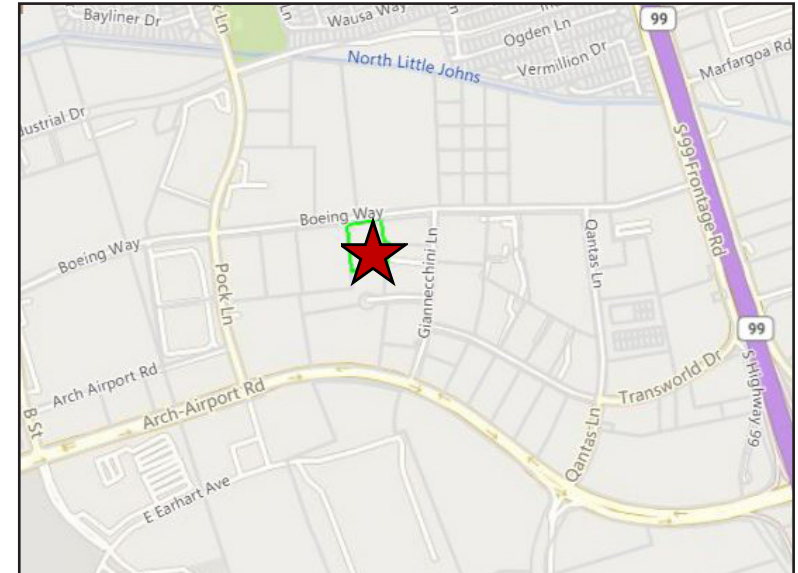

REGIONAL MAP

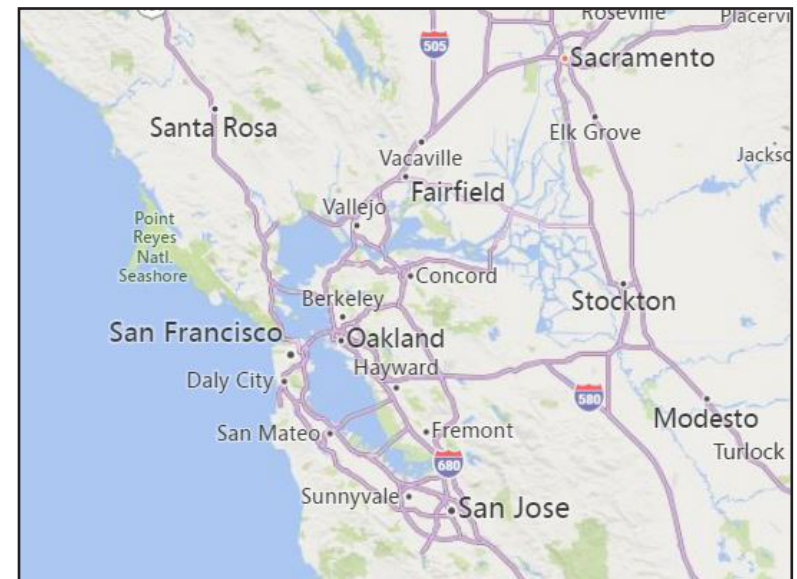

2570 BOEING WAY | STOCKTON, CA

36,000± SF Building on 2.48± Acres - FOR SUBLEASE!



Jim Martin, SIOR
BRE # 01214270
jmartin@lee-associates.com
D 209.983.4088
C 925.352.6948

All information furnished regarding property for sale, rental or financing is from sources deemed reliable, but no warranty or representation is made to the accuracy thereof and same is submitted to errors, omissions, change of price, rental or other conditions prior to sale, lease or financing or withdrawal without notice. No liability of any kind is to be imposed on the broker herein.