

# WOODSIDE RETAIL CENTER

## RETAIL FOR LEASE

1021-1023 COLUMBUS AVENUE, MARYSVILLE, OHIO 43040



**AARON HEATH** SENIOR VICE PRESIDENT

**MOBILE** 614.804.6936 | **DIRECT** 614.334.7786  
**AHEATH@EQUITY.NET**



**NOAH HEATH** ADVISOR

**MOBILE** 614.949.9876 | **DIRECT** 614.334.7783  
**NHEATH@EQUITY.NET**



The information contained herein has been obtained from the property owner or other sources that we deem reliable. Although we have no reason to doubt its accuracy, no representation or warranty is made regarding the information, and the property is offered "as is". The submission may be modified or withdrawn at any time by the property owner.

# PROPERTY HIGHLIGHTS

## WOODSIDE RETAIL CENTER

RETAIL FOR LEASE

1021-1023 COLUMBUS AVENUE, MARYSVILLE, OHIO 43040

- Two buildings of +/- 10,115 SF each
- +/- 0.72 acre outparcel available for ground lease at \$70,000 per year
- Woodside Commerce District is a 100+ acre fully integrated, mixed-use community
- Over 1,200 new residential units just off Columbus Avenue (Industrial Parkway)
- Across from Colemans Crossing and near downtown Marysville
- New retail space for lease at \$40.00 NNN psf + \$8.00 est. op. exp.





# MARYSVILLE AERIAL





# PARCEL AERIAL





# OBLIQUE AERIAL





# SITE PLAN

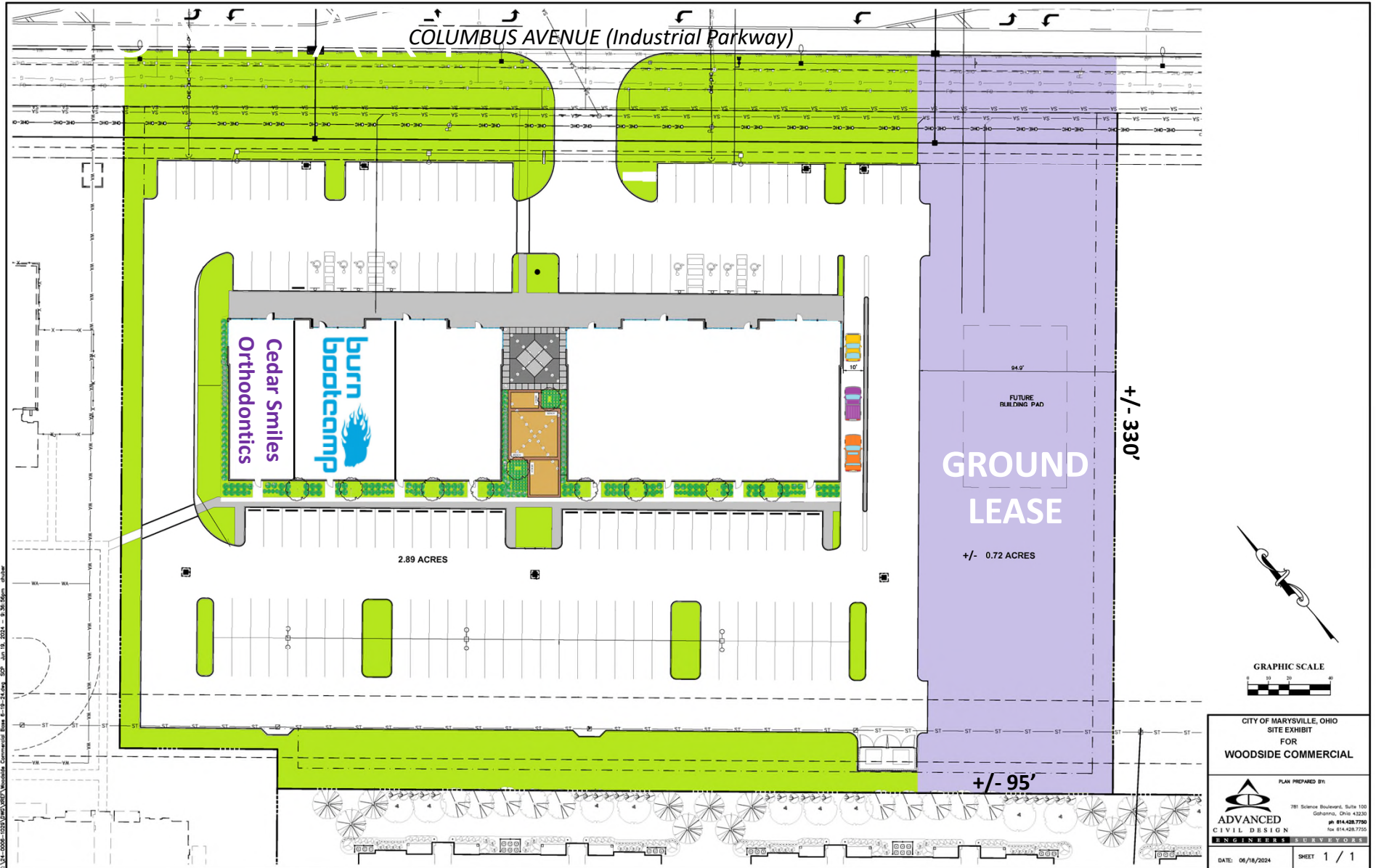



# SPACE PLAN: BUILDING ONE

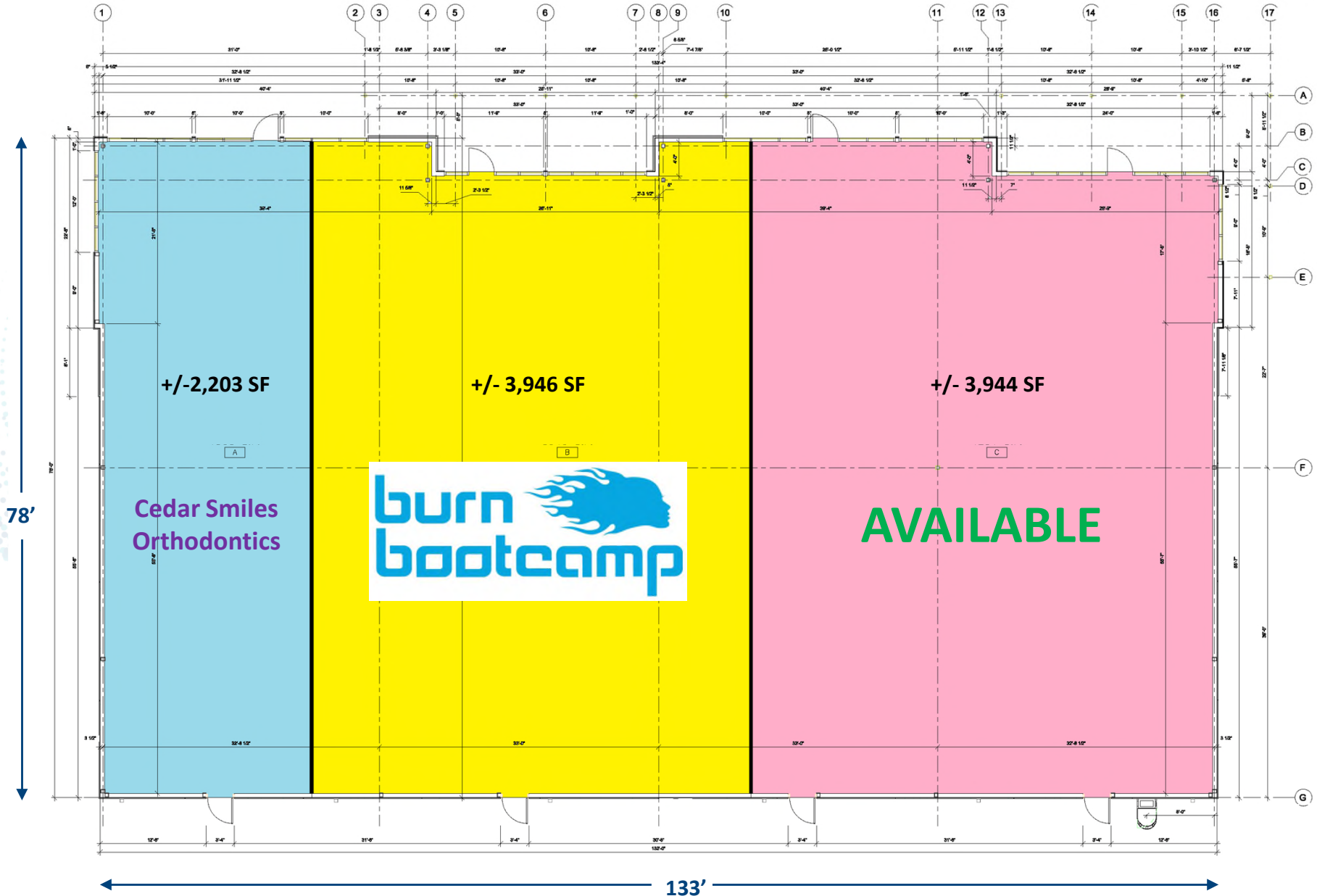



# SPACE PLAN: BUILDING TWO

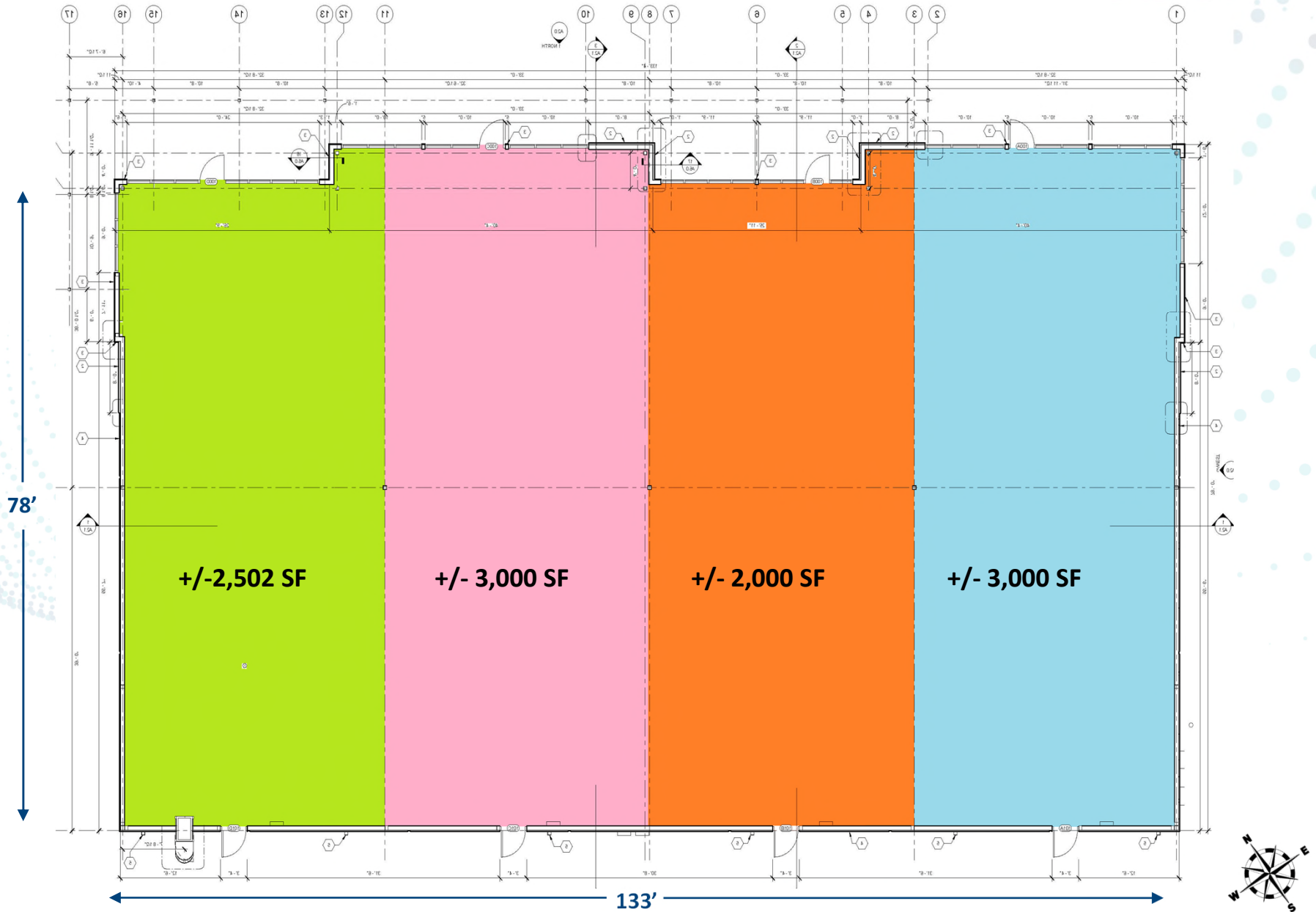



# MONUMENT SIGNAGE





# 1-MILE RADIUS DEMOS

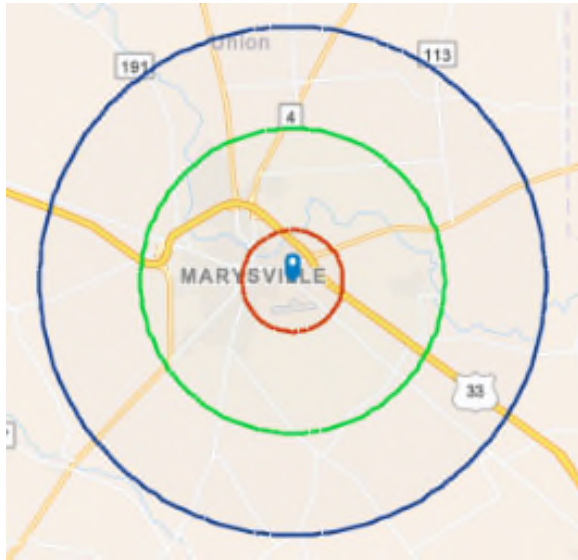

## KEY FACTS

**3,332**  
Population

**2.3**  
Average  
Household Size

**37.2**  
Median Age

**\$67,082**  
Median Household Income

## BUSINESS

**476**

Total Businesses

**6.250**

Total Employees

## EDUCATION

**10%**

No High School  
Diploma

**40%**

High School  
Graduate

**27%**

Some  
College

**23%**

Bachelor's/Grad/Prof  
Degree

## INCOME



**\$39,181**  
Per Capita  
Income



**\$67,082**  
Median  
Household  
Income



**\$94,618**  
Average  
Household  
Income

## EMPLOYMENT



**50.5**  
White  
Collar %



**34.9**  
Blue  
Collar %



**14.6**  
Services  
%

**equity** | brokerage

The information contained herein has been obtained from the property owner or other sources that we deem reliable. Although we have no reason to doubt its accuracy, no representation or warranty is made regarding the information, and the property is offered "as is." The submission may be modified or withdrawn at any time by the property owner.



# 3-MILE RADIUS DEMOS

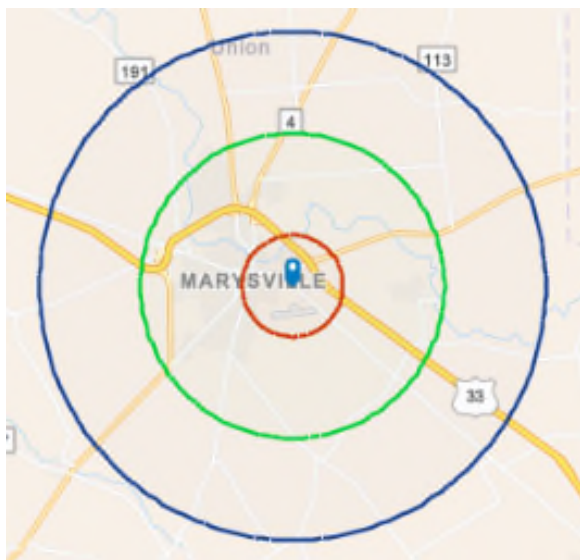

## KEY FACTS

**27,138**

Population



Average  
Household Size



Median Age

**\$84,882**

Median Household Income

## BUSINESS



**868**

Total Businesses



**12,109**

Total Employees

## EDUCATION



**7%**

No High School  
Diploma



**36%**

High School  
Graduate



**28%**

Some  
College



**30%**

Bachelor's/Grad/Prof  
Degree

## INCOME



**\$39,848**

Per Capita  
Income



**\$84,882**

Median  
Household  
Income



**\$110,113**

Average  
Household  
Income

## EMPLOYMENT



**64.4**

White  
Collar %



**25.6**

Blue  
Collar %



**10.0**

Services  
%

**equity** | brokerage

The information contained herein has been obtained from the property owner or other sources that we deem reliable. Although we have no reason to doubt its accuracy, no representation or warranty is made regarding the information, and the property is offered "as is." The submission may be modified or withdrawn at any time by the property owner.



# 5-MILE RADIUS DEMOS

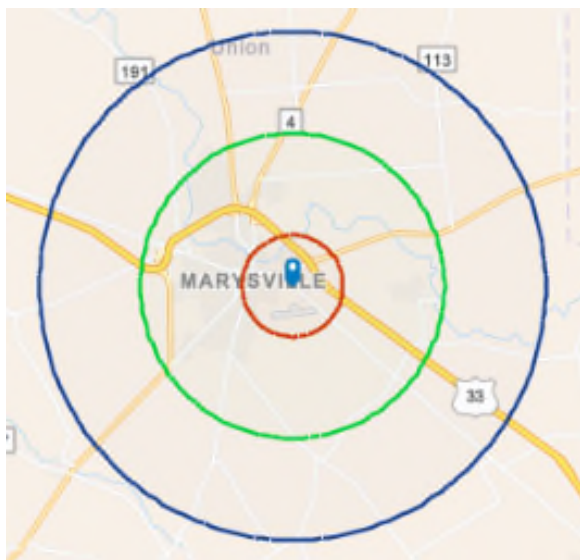

## KEY FACTS

**32,442**  
Population

**2.6**  
Average  
Household Size

**36.6**  
Median Age

**\$89,609**  
Median Household Income

## BUSINESS



**947**

Total Businesses



**13,144**

Total Employees

## EDUCATION



**6%**

No High School  
Diploma



**35%**

High School  
Graduate



**28%**

Some  
College



**32%**

Bachelor's/Grad/Prof  
Degree

## INCOME



**\$41,420**

Per Capita  
Income



**\$89,609**

Median  
Household  
Income



**\$115,852**

Average  
Household  
Income

## EMPLOYMENT



**65.8**

White  
Collar %



**24.2**

Blue  
Collar %



**10.0**

Services  
%

**equity** | brokerage

The information contained herein has been obtained from the property owner or other sources that we deem reliable. Although we have no reason to doubt its accuracy, no representation or warranty is made regarding the information, and the property is offered "as is." The submission may be modified or withdrawn at any time by the property owner.