

# VALLEY GROVE D

FOR LEASE



**MOUNTAIN WEST**  
COMMERCIAL REAL ESTATE

## CODY BLACK

cblack@mwcre.com  
direct 801.687.0094  
[View Profile](#)

## SHAD WEBB

swebb@mwcre.com  
direct 435.459.0212  
[View Profile](#)

## PROPERTY DETAILS

2086 W GROVE PARKWAY, PLEASANT GROVE, UT 84062

- \$22.50 NNN
- Available SF for 2026: 2,100 - 4,802 SF
- Flexible Layout
- Turnkey Available
- Ability to Grow within the Park
- Building Signage Available
- No Core Factor
- No Load Factor
- 5/1,000 Parking



**FULL SERVICE  
COMMERCIAL REAL ESTATE**

2015 West Grove Parkway, Suite J  
Pleasant Grove, UT 84062  
Office 385.233.9140  
[www.mwcre.com](http://www.mwcre.com)



# VALLEY GROVE D

## SITE PLAN

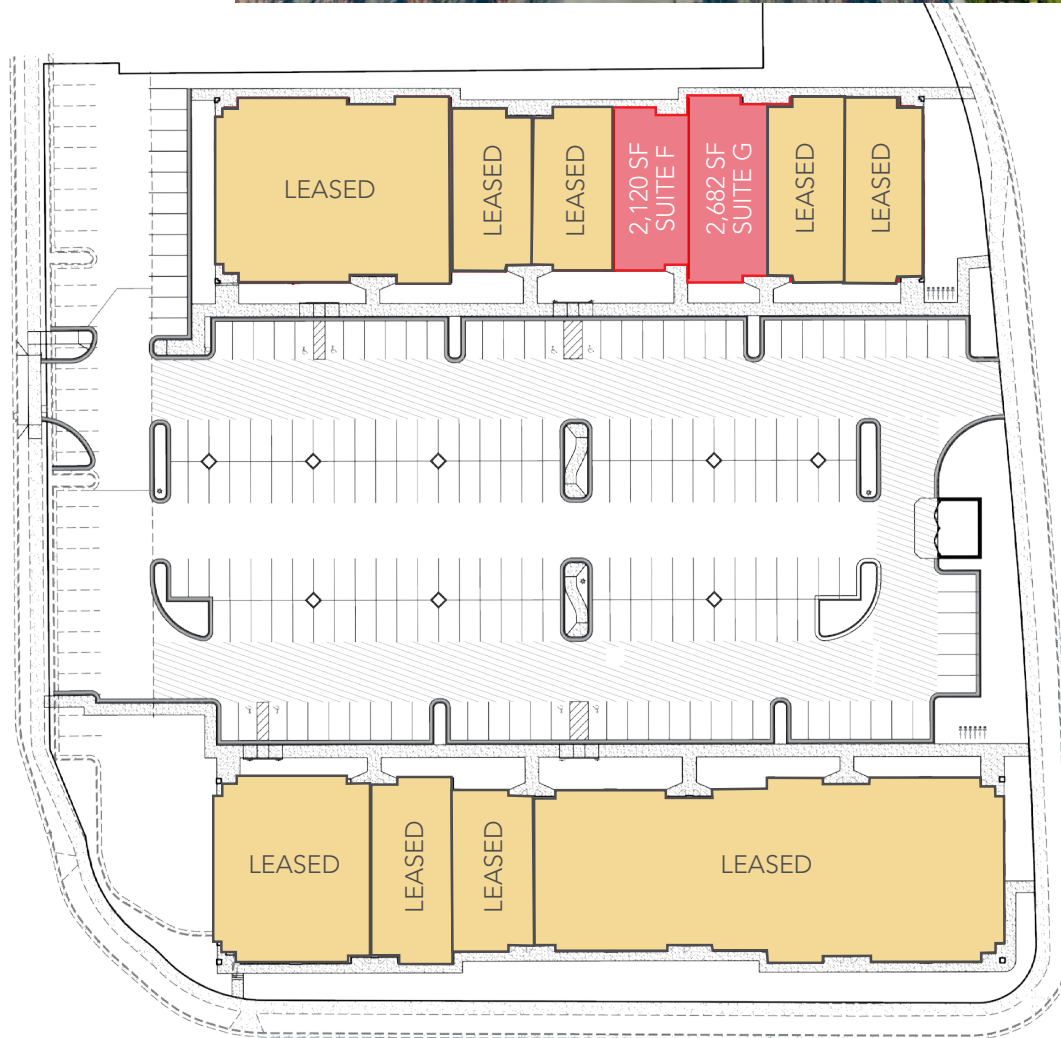

**MOUNTAIN WEST**  
COMMERCIAL REAL ESTATE

**CODY BLACK**

cblack@mwcre.com  
direct 801.687.0094  
[View Profile](#)

**SHAD WEBB**

swebb@mwcre.com  
direct 435.459.0212  
[View Profile](#)

**FULL SERVICE  
COMMERCIAL REAL ESTATE**

2015 West Grove Parkway, Suite J  
Pleasant Grove, UT 84062  
Office 385.233.9140  
[www.mwcre.com](http://www.mwcre.com)



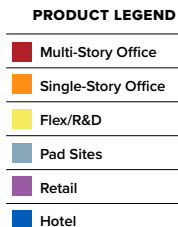

### Retail Electronic Pylon Sign



### I-15 Electronic Pylon Sign

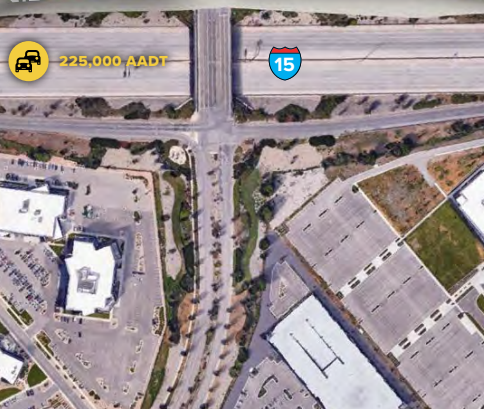

A collage of 25 logos for various businesses, arranged in three rows. The logos include:

- Row 1:** aesthetica (Medspa • Plastic Surgery), AT&T, belle (BOUTIQUE), Cafe Rio (MEXICAN GRILL), charles SCHWAB, Chick-fil-A, CLUB PILATES, and fika.
- Row 2:** Gloss (AVEDA), graze craze (Healthy Food & Drink), THE GREAT GREEK (Authentic Greek Food), Happy Toriyaki, Hilton, Johnny Mikes (CLUBS), MilkShake (EST. 1974 FACTORY 1974), and OMNIA (SALON STUDIOS).
- Row 3:** Panera (Bakery & Cafe), PRIME (TV) (RESTAURANTS & HOTELS), Ranchario's (MEXICAN FOOD), R.P.R. BBQ, SLIM CHICKENS, Spicy Munch, snooze, Starbucks, Twisted Sugar, UNDER WRAPS, verizon, VILLAGE BAKER, WAYBACK (BURGERS), Wildside (RESTAURANT), WIN-STAR, and WOK LINE.



**MOUNTAIN WEST**  
COMMERCIAL REAL ESTATE

cblack@mwcre.com  
direct 801.687.0094  
*View Profile*

swebb@mwcre.com  
direct 435.459.0212  
*View Profile*

2015 West Grove Parkway, Suite J  
Pleasant Grove, UT 84062  
Office 385.233.9140  
[www.mwcre.com](http://www.mwcre.com)

This statement with the information it contains is given with the understanding that all negotiations relating to the purchase, renting or leasing of the property described above shall be conducted through this office. The above information while not guaranteed has been secured from sources we believe to be reliable.





**MOUNTAIN WEST**  
COMMERCIAL REAL ESTATE

## CODY BLACK

cblack@mwcre.com  
direct 801.687.0094  
[View Profile](#)

## SHAD WEBB

swebb@mwcre.com  
direct 435.459.0212  
[View Profile](#)

**FULL SERVICE  
COMMERCIAL REAL ESTATE**

2015 West Grove Parkway, Suite J  
Pleasant Grove, UT 84062  
Office 385.233.9140  
[www.mwcre.com](http://www.mwcre.com)





### DRIVE TIMES

SLC Intl Airport **40 min**

Provo Airport **15 min**

BYU **20 Min**

UVU **10 min**

Sundance Ski Resort **25 Min**

Saratoga  
Springs



**MOUNTAIN WEST**  
COMMERCIAL REAL ESTATE

#### CODY BLACK

cblack@mwcre.com

direct 801.687.0094

[View Profile](#)

#### SHAD WEBB

swebb@mwcre.com

direct 435.459.0212

[View Profile](#)

#### FULL SERVICE COMMERCIAL REAL ESTATE

2015 West Grove Parkway, Suite J

Pleasant Grove, UT 84062

Office 385.233.9140

[www.mwcre.com](http://www.mwcre.com)