



WOODLAND
CORPORATE PARK



WCP I & II • 7602, 7702 • WOODLAND DRIVE • INDIANAPOLIS, IN 46278



Coastal Partners, LLC
Real Estate Development





WOODLAND I

- 78,985 total square feet
- 6/1,000 parking available
- Three story office building
- Built in 1997
- Interstate visibility and accessibility



WOODLAND II

- 61,732 total square feet
- 4.7/1,000 parking available
- Two story office building
- Built in 1999
- On-site conference center

BUSINESS PARK AMENITIES

SERVICES FOR WOODLAND CORPORATE PARK TENANTS

- Close to amenities at 71st/I-465 & Trader's Point
- 73rd exit ramp offers direct access to the buildings/park
- Ease of access/travel time to downtown, airport, northside, etc.
- Rectangular floor plates offering tenants better efficiency
- Conference facility
- Recycling program
- Highly visible along I-465
- Numerous amenities nearby
- Beautifully maintained park-like setting with a fitness path surrounding the lake
- Above market parking ratios

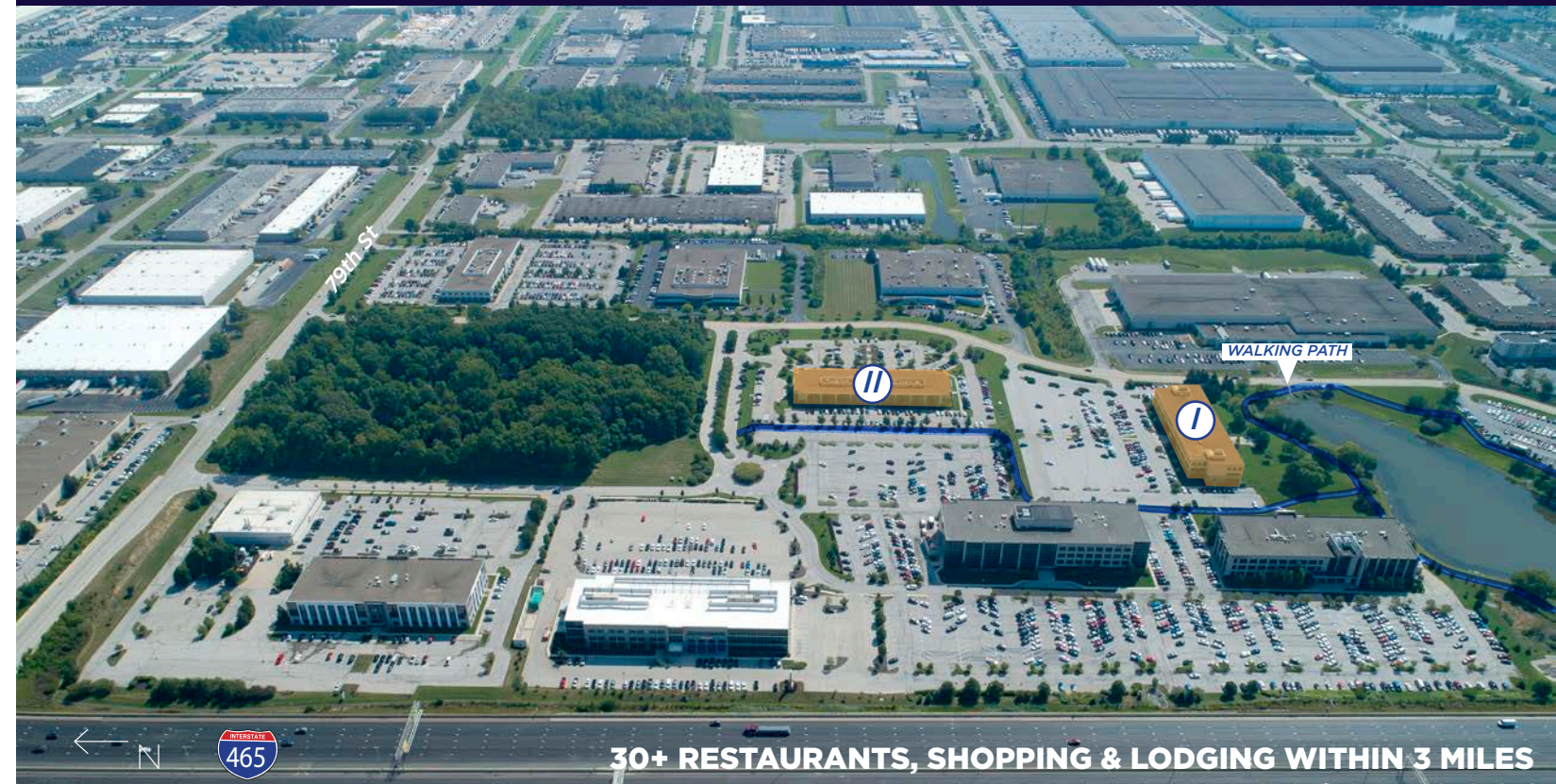

TYPICAL FLOOR PLAN

WOODLAND I



WOODLAND II

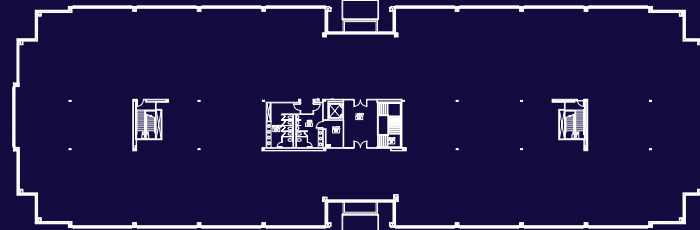

CONFERENCE FACILITY

AVAILABLE TO ALL WOODLAND CORPORATE PARK TENANTS

AVAILABILITY

- Reservations are made on a first come, first-served basis and can accommodate 100 chairs and 27 tables. The room contains a white board, overhead projector and a screen.

COST

- Half day = \$125 / Full day = \$250

SET-UP/CLEAN-UP

- Tenants are responsible for their on set-up and clean-up. If management has to clean the facility, you will be charged a \$200/hour clean-up fee.

CANCELLATION

- To avoid a cancellation fee, you must cancel your event 24 hours in advance.

LOCATION

- 7702 Woodland Drive, Suite 110



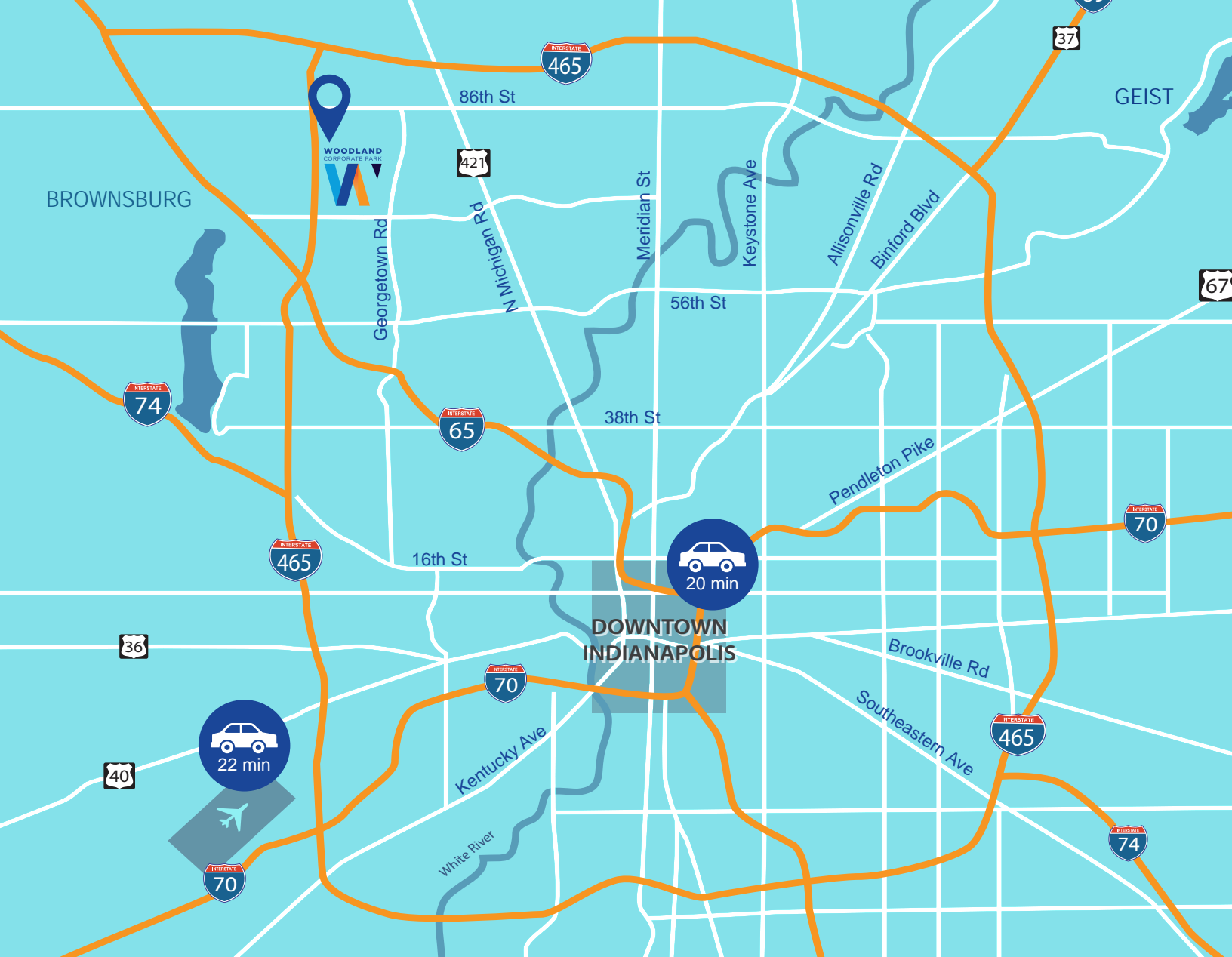

FOOD + DRINKS



- Chili's Grill & Bar
- Cold Stone Creamery
- DiBella's Subs
- Gatsby's Pub & Grill
- Jimmy John's

- Le Peep
- LongHorn Steakhouse
- Luciana's
- Monical's Pizza
- Noodles & Company

- Panera Bread
- Philadelphia Steak & Fries
- Qdoba Mexican Grill
- Slim Chickens
- Starbucks

- Ted's Montana Grill
- Tegry Bistro
- Trader's Mill Grill & Bar
- Yats
- And Many More!

SHOPPING + ENTERTAINMENT



- AMC Showplace 12
- Beef & Boards
- Books-A-Million

- Dick's Sporting Goods
- GNC
- Kroger

- Michaels
- Old Navy
- Patora Fine Jewelers

- PetSmart
- Trader Joe's

LODGING + BANKING



- Candlewood Suites
- Courtyard Marriot
- Clarion Inn
- Extended Stay America

- Fairfield Inn
- Hampton Inn
- Hilton Garden Inn
- Holiday Inn Express

- InTown Suites
- Residence Inn
- Huntington Bank
- Fifth Third Bank

- BMO Harris Bank
- Regions Bank
- PNC Bank



Coastal Partners, LLC
Real Estate Development

TRACI KAPSALIS
Senior Vice President
+1 317 810 7013
traci.kapsalis@jll.com

CONNOR SCOTT
Vice President
+1 317 810 6399
connor.scott@jll.com



Although information has been obtained from sources deemed reliable, neither Owner nor JLL makes any guarantees, warranties or representations, express or implied, as to the completeness or accuracy as to the information contained herein. Any projections, opinions, assumptions or estimates used are for example only. There may be differences between projected and actual results, and those differences may be material. The Property may be withdrawn without notice. Neither Owner nor JLL accepts any liability for any loss or damage suffered by any party resulting from reliance on this information. If the recipient of this information has signed a confidentiality agreement regarding this matter, this information is subject to the terms of that agreement. ©2025, Jones Lang LaSalle IP, Inc. All rights reserved.