



Accelerating success.



For Lease

±1,500 -
±3,000 SF

Contact us:

Jeff Barnes

Executive Vice President
+1 408 218 3366
jeff.barnes@colliers.com
Lic. No. 00883278

8070 Santa Teresa Blvd
Suite 220
Gilroy, CA 95020
P: +1 408 282 3800
F: +1 408 842 1141
colliers.com/siliconvalley

Northpointe Business Center Hollister, CA

300 Park Center Dr, Hollister, CA

Office/Industrial Units

Highlights

- Master planned office/Industrial Business Park
- Six Office/Industrial buildings
- Located in the County of San Benito which allows a wide range of uses under the zoning code
- Unit sizes start at ±1,500-3,000 SF
- 200 Amps in every ±3,000 SF of space
- Additional land for expansion or build to suits
- Can also accommodate tenants that need yard space
- Close to the city of Hollister, services and the airport

Copyright © 2024 Colliers International.

Information herein has been obtained from sources deemed reliable, however its accuracy cannot be guaranteed. The user is required to conduct their own due diligence and verification.

Property Drawings

BUILDING 300 | UNITS 5 & 6

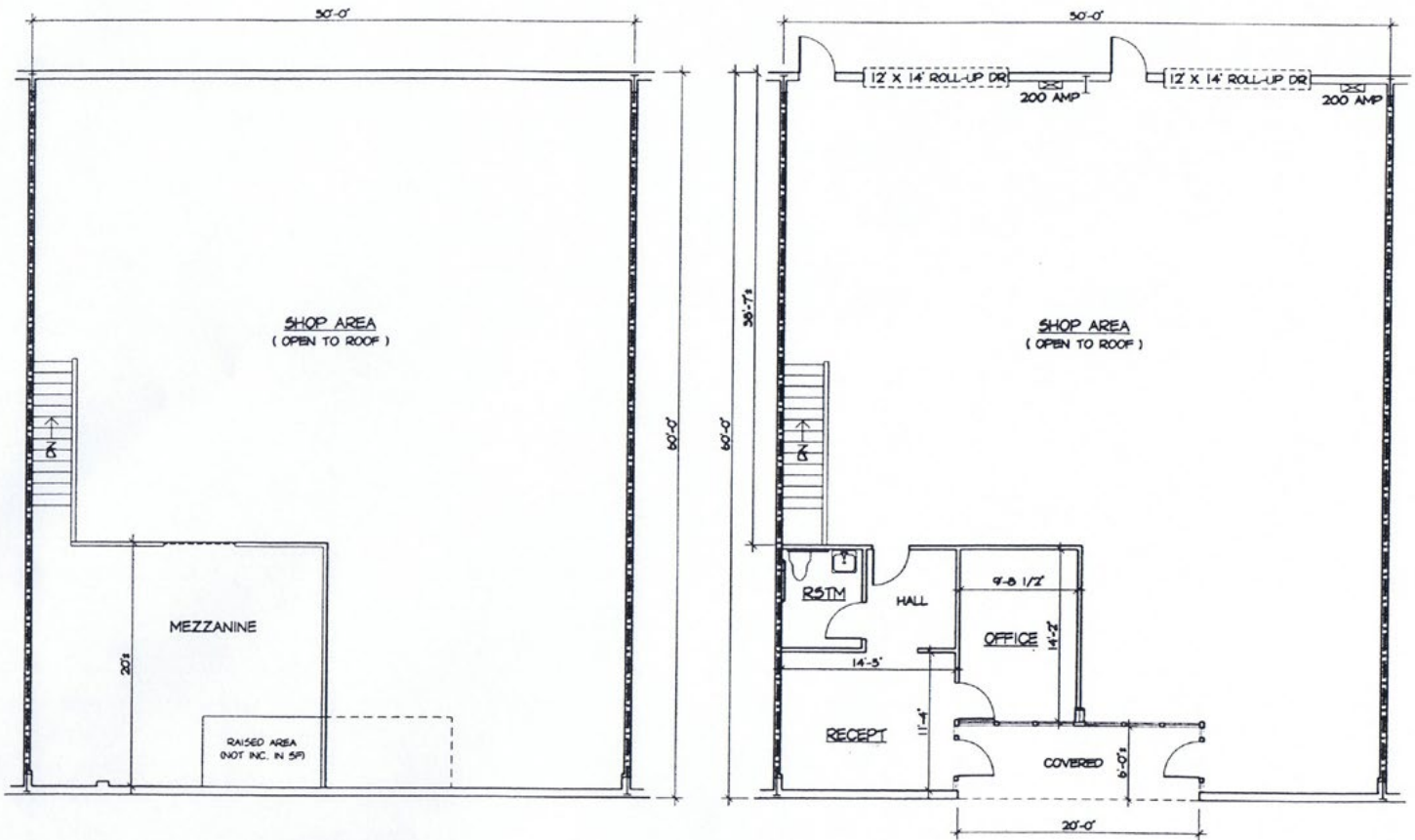

Northpointe Business Center | For Lease



Contact us:

Jeff Barnes
Executive Vice President
+1 408 218 3366
jeff.barnes@colliers.com
Lic. No. 00883278

This document has been prepared by Colliers International for advertising and general information only. Colliers International makes no guarantees, representations or warranties of any kind, expressed or implied, regarding the information including, but not limited to, warranties of content, accuracy and reliability. Any interested party should undertake their own inquiries as to the accuracy of the information. Colliers International excludes unequivocally all inferred or implied terms, conditions and warranties arising out of this document and excludes all liability for loss and damages arising there from. This publication is the copyrighted property of Colliers International and/or its licensor(s). ©2024. All rights reserved.

8070 Santa Teresa Blvd
Suite 220
Gilroy, CA 95020
P: +1 408 282 3800
F: +1 408 842 1141

