

10TH FLOOR SUBLEASE  
AVAILABLE

# 233 NORTH MICH

17,172 - 34,344 SF  
AVAILABLE NOW

VIEW VIRTUAL TOUR



**CBRE**

ILLINOIS CENTER



Available  
Now



Term Through  
May 31, 2026



Asking Rate  
Negotiable



Plug-and-Play  
Space



Great Mix of Offices,  
Conference Rooms  
and Open Office



Furnished and Wired  
at a Density of 150  
SF per Person



Illinois Center location provides  
excellent access to public  
transit, the pedway, building  
amenities and retail offerings

10TH FLOOR 17-34K SF (DIVISIBLE)

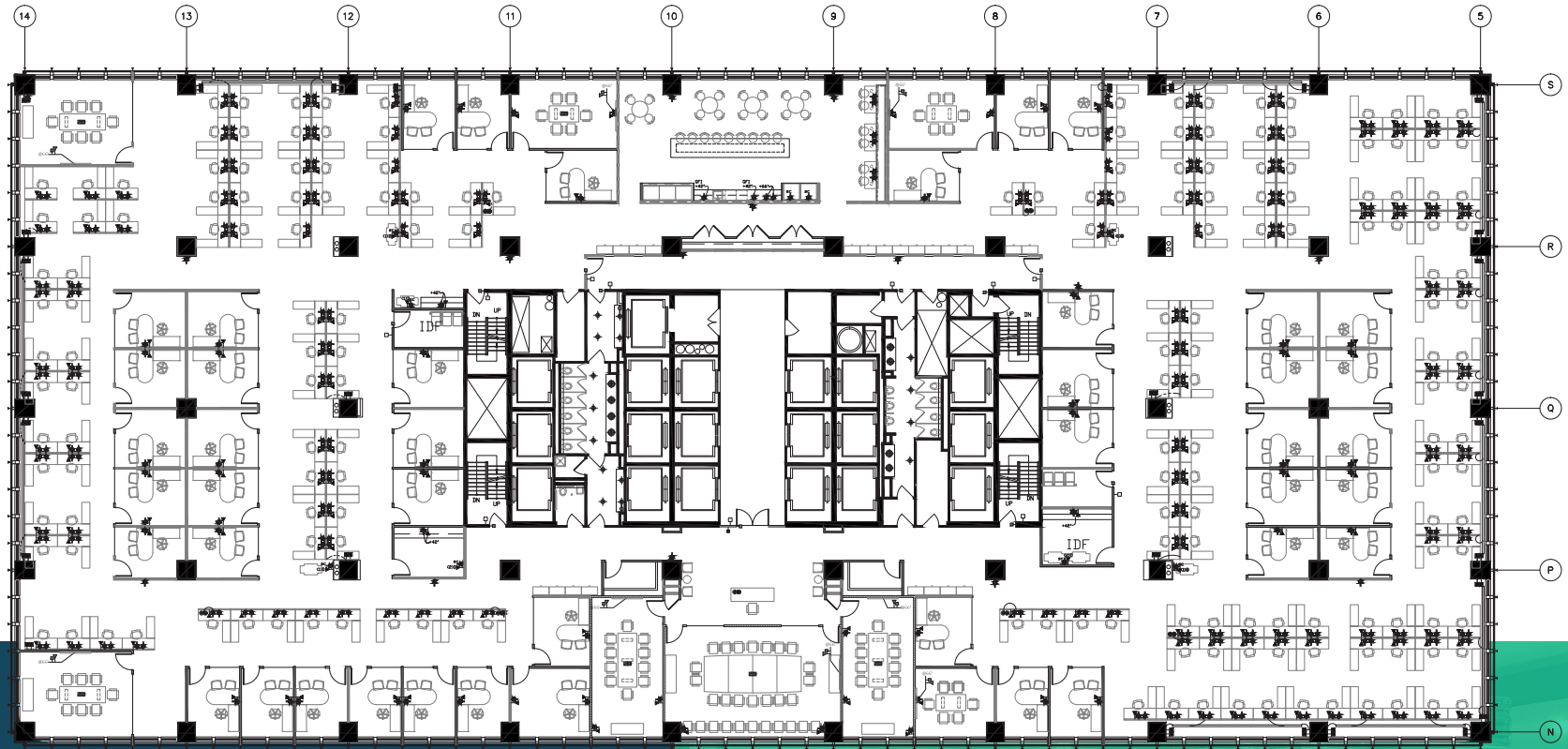

**183**  
Workstations  
(6' x 6')

**43**  
Offices  
(9'-9" x 15'-9")

**5**  
Huddle  
Rooms

**3**  
Large Conference  
Rooms





10TH FLOOR SUBLEASE  
AVAILABLE

# 233 NORTH MICH

17,172 - 34,344 SF  
AVAILABLE NOW

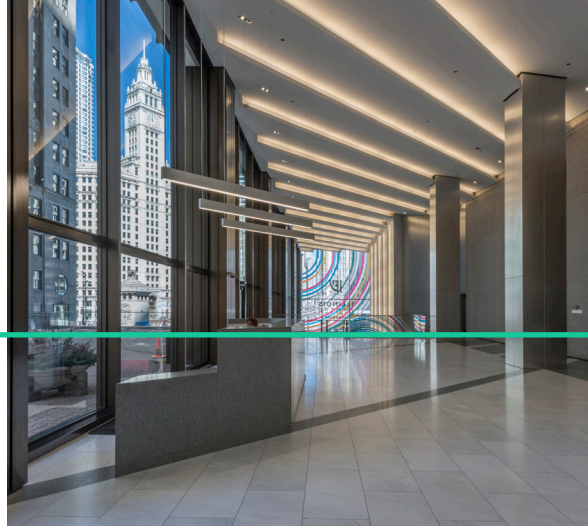

FOR MORE INFORMATION

**COURTNEY THEO**

+1 312 540 4602  
courtney.theo@cbre.com

**MAURA FLANAGAN**

+1 312 416 3076  
maura.flanagan@cbre.com

**TODD LIPPMAN**

+1 312 935 1440  
todd.lippman@cbre.com

**CBRE**

© 2022 CBRE, Inc. All rights reserved. This information has been obtained from sources believed reliable, but has not been verified for accuracy or completeness. Any projections, opinions, or estimates are subject to uncertainty. The information may not represent the current or future performance of the property. You and your advisors should conduct a careful, independent investigation of the property and verify all information. Any reliance on this information is solely at your own risk. CBRE and the CBRE logo are service marks of CBRE, Inc. and/or its affiliated or related companies in the United States and other countries. All other marks displayed on this document are the property of their respective owners. Photos herein are the property of their respective owners and use of these images without the express written consent of the owner is prohibited. PMStudio\_Jan2022