

PLANT SCHEDULE

NO.	QTY	SYMBOL	DESCRIPTION
1	1	(Symbol)	PLANT
2	1	(Symbol)	PLANT
3	1	(Symbol)	PLANT
4	1	(Symbol)	PLANT
5	1	(Symbol)	PLANT

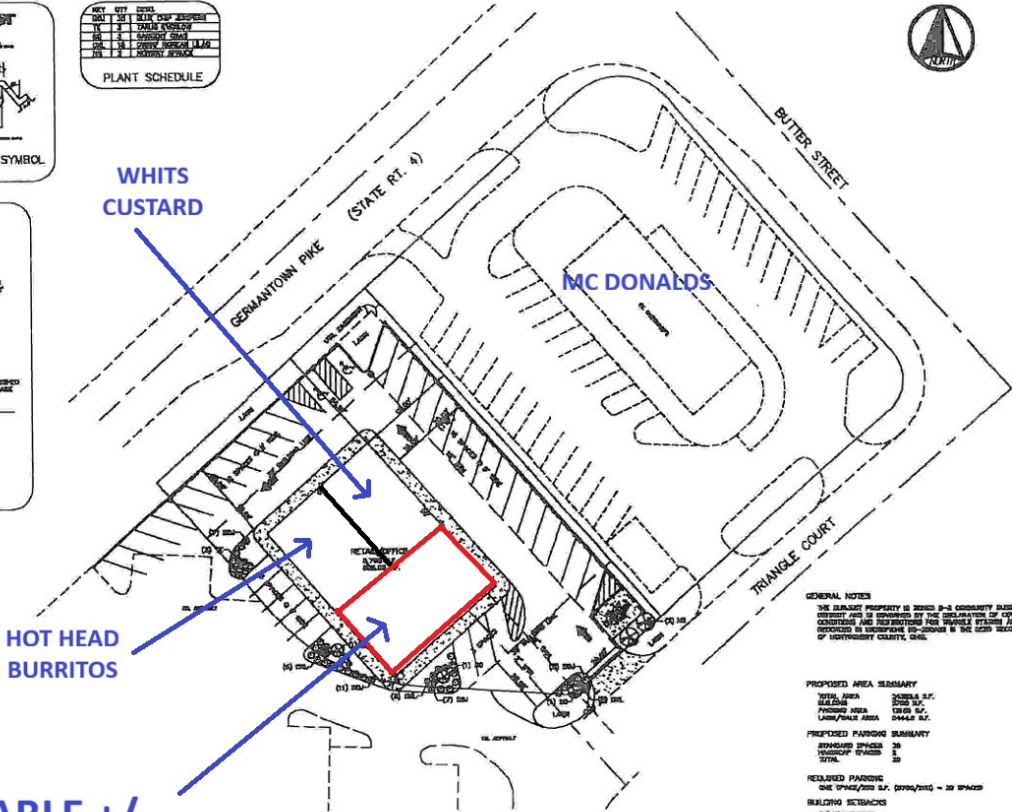
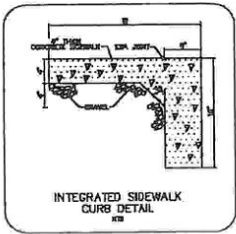
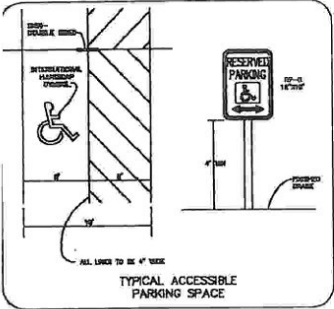

**AVAILABLE +/-  
1800 SF**

GENERAL NOTES  
THE SUBJECT PROPERTY IS ZONED R-3 COMMUNITY BUSINESS DISTRICT AND IS SUBJECT TO THE REGULATIONS OF ORDINANCES, ORDINANCES AND REGULATIONS FOR WALKABLE STREETS AS ENACTED IN SUPERSEDES TO-ORDER 8 FOR THE TOWN OF UNIVERSITY COUNTY, GA.

PROPOSED AREA SUMMARY  
TOTAL AREA 20884 S.F.  
BLDG AREA 2500 S.F.  
PAVED AREA 12400 S.F.  
LAND/PAVE AREA 9444 S.F.

PROPOSED PARKING SUMMARY  
STANDARD SPACES 28  
HANDICAP SPACES 2  
TOTAL 30

REQUIRED PARKING ONE (1) SPACE/100 S.F. PROPOSED = 30 SPACES

RELIQUO SETBACKS  
BY FRONT YARD 10' MIN. (SEE 220)

