



3333, 3335 & 3337 Susan Street
Costa Mesa

Break Some Barriers



Work Smart, Work Social

3333, 3335 & 3337 Susan Street
Costa Mesa, CA 92704



WELCOME TO HIVE

HIVE, located at 3333, 3335 & 3337 Susan Street in Costa Mesa, is a 190,000 square foot indoor/outdoor creative office campus redesigned for the way people work today with an inspiring, amenity-rich environment.

Striking architecture. A beautiful and restorative landscape. Amenities that reflect a spirit of community and a commitment to well-being. HIVE offers a mix of engaging elements geared to creative work cultures, including a state-of-the-art conference center designed to make a client presentation or team-building program a success. To enhance the conference space, overhead roll-up doors allow access to attractive courtyards.

At HIVE, anything becomes possible.





COMMUNITY COURTYARD

Grab a bite from the food trucks, have a cup a' joe at the espresso bar or cycle over to SOCO.



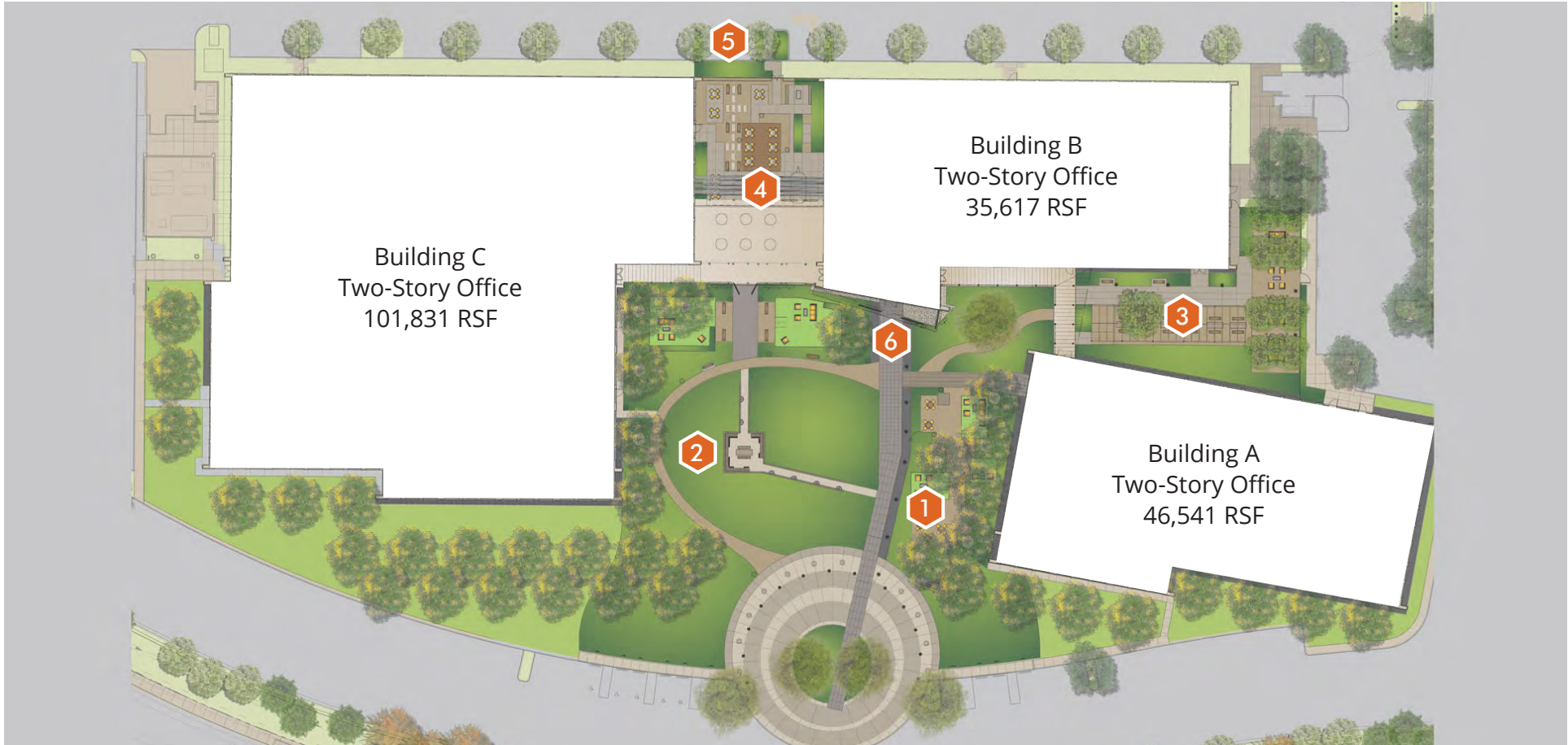

SITE PLAN

- 1 Entry Courtyard
- Informal Meeting Area
- 2 Sunken Outdoor Conference Room
- 3 Glass Barn
- Indoor/Outdoor Work Space
- 4 Espresso Bar & Lounge + Community Courtyard
- 5 Food Trucks
- 6 Building Amenities
- Conference Center
- Gym
- Zagster Bikes



IN MOTION AND IN CONTACT

Connect and collaborate in outdoor spaces designed for work and play

3333, 3335 & 3337 Susan Street
Costa Mesa, CA 92704



NEIGHBORHOOD

HIVE is located in the midst of a hub of creative companies, attracted by the energy of an emerging market where commerce and the southern California lifestyle converge. Newport Beach and Huntington Beach are less than twenty minutes away. With immediate access to primary corridors that connect you to John Wayne Airport—a mere ten minutes away—the business engines of Los Angeles and San Diego are within easy reach.



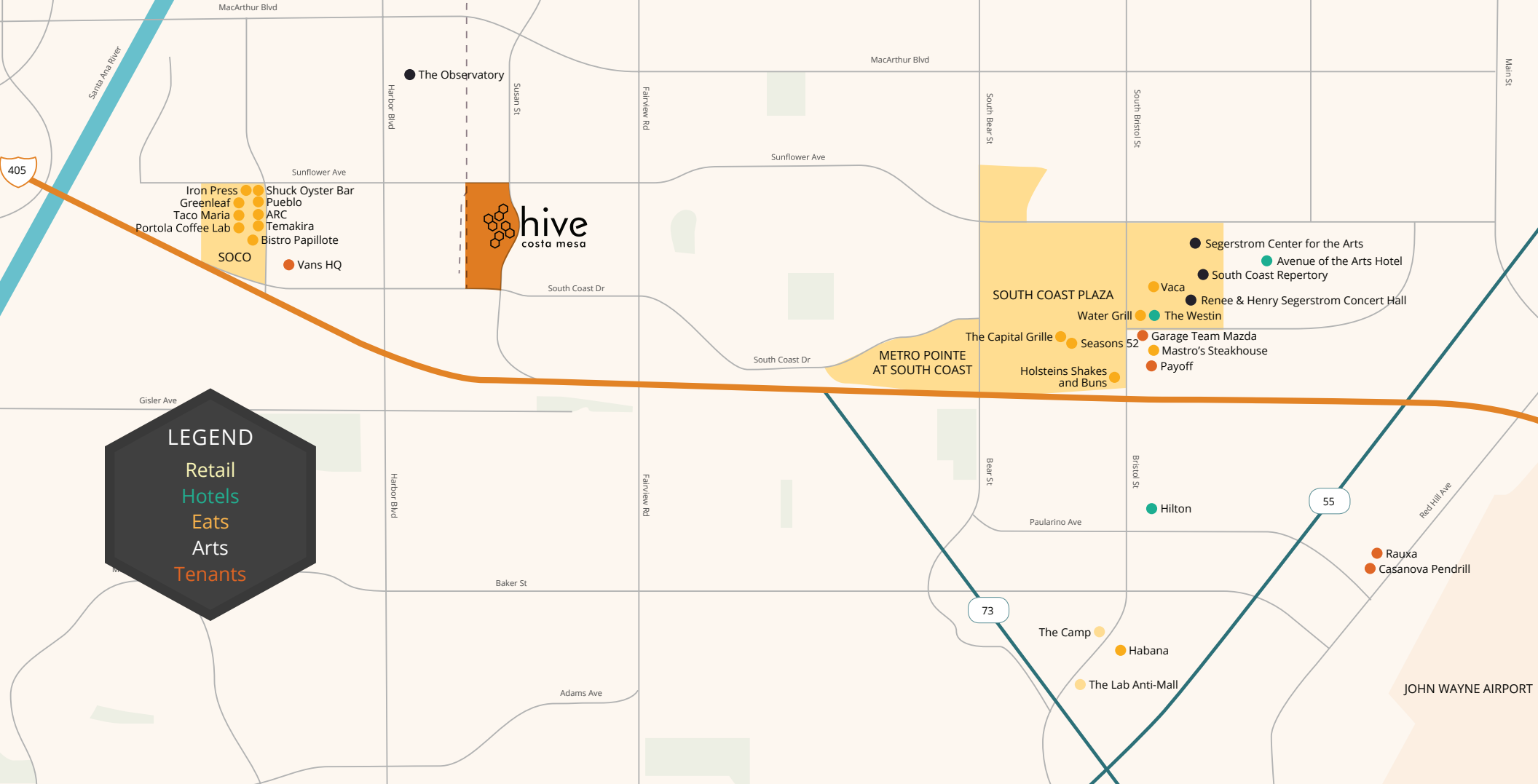

EXCLUSIVELY LEASED BY:



Jay Nugent
949.608.2035
jay.nugent@ngkf.com
CA RE License # 01248267

George Thomson
949.608.2037
george.thomson@ngkf.com
CA RE License #00947200

Naomi Rizkowsky
949.608.2038
naomi.rizkowsky@ngkf.com
CA RE License #01956011

OWNED & MANAGED BY:



Seth Hiromura
949.863.0377
shiromura@steelwavellc.com

Samantha Page Lagman
949.863.0376
slagman@steelwavellc.com

NKF | 4675 MacArthur Court, Suite 1600, Newport Beach, CA 92660 | Corporate CA RE License #01355491

Procuring broker shall only be entitled to a commission, calculated in accordance with the rates approved by our principal only if such procuring broker executes a brokerage agreement acceptable to us and our principal and the conditions as set forth in the brokerage agreement are fully and unconditionally satisfied. Although all information furnished regarding property for sale, rental, or financing is from sources deemed reliable, such information has not been verified and no express representation is made nor is any to be implied as to the accuracy thereof and it is submitted subject to errors, omissions, change of price, rental or other conditions, prior sale, lease or financing, or withdrawal without notice and to any special conditions imposed by our principal.