

OFFICE FOR LEASE

1401 SKYLINE BLVD, SUITE 1 | BISMARCK, ND





OFFERING SUMMARY

Lease Rate:	\$1,475.00 per month (NNN)
Available SF:	787 SF
Lot Size:	124,747 SF
Year Built:	2013
Renovated:	2024
Zoning:	CG
Submarket:	North Bismarck
Tenant Responsibility:	Real Estate Taxes, Property Insurance, Operational Expenses, Heat, Electric, All Utilities
Landlord Responsibility:	Structural Integrity of Roof, Walls and Foundation

PROPERTY OVERVIEW

This stunning office space provides easy access to Highway 83 and features four spacious private offices, a reception desk area, and a welcoming waiting room. Situated on a quiet second floor, the secure building offers elevator access and 24/7 entry. The efficient layout suits a variety of office needs, complemented by large windows that fill the space with natural light. Conveniently located in northeast Bismarck, it's just minutes from shopping centers, grocery stores, restaurants, and schools. NNN costs estimated at \$6.52 psf.

PROPERTY HIGHLIGHTS

- Great North Bismarck Location
- Professional Office Space
- Common Area Bathrooms
- Elevator Access - ADA
- Tenant Subject to Landlord Approval for Use
- Tenant Subject to Lease Application
- Showings By Appointment Only
- Available May 1, 2025



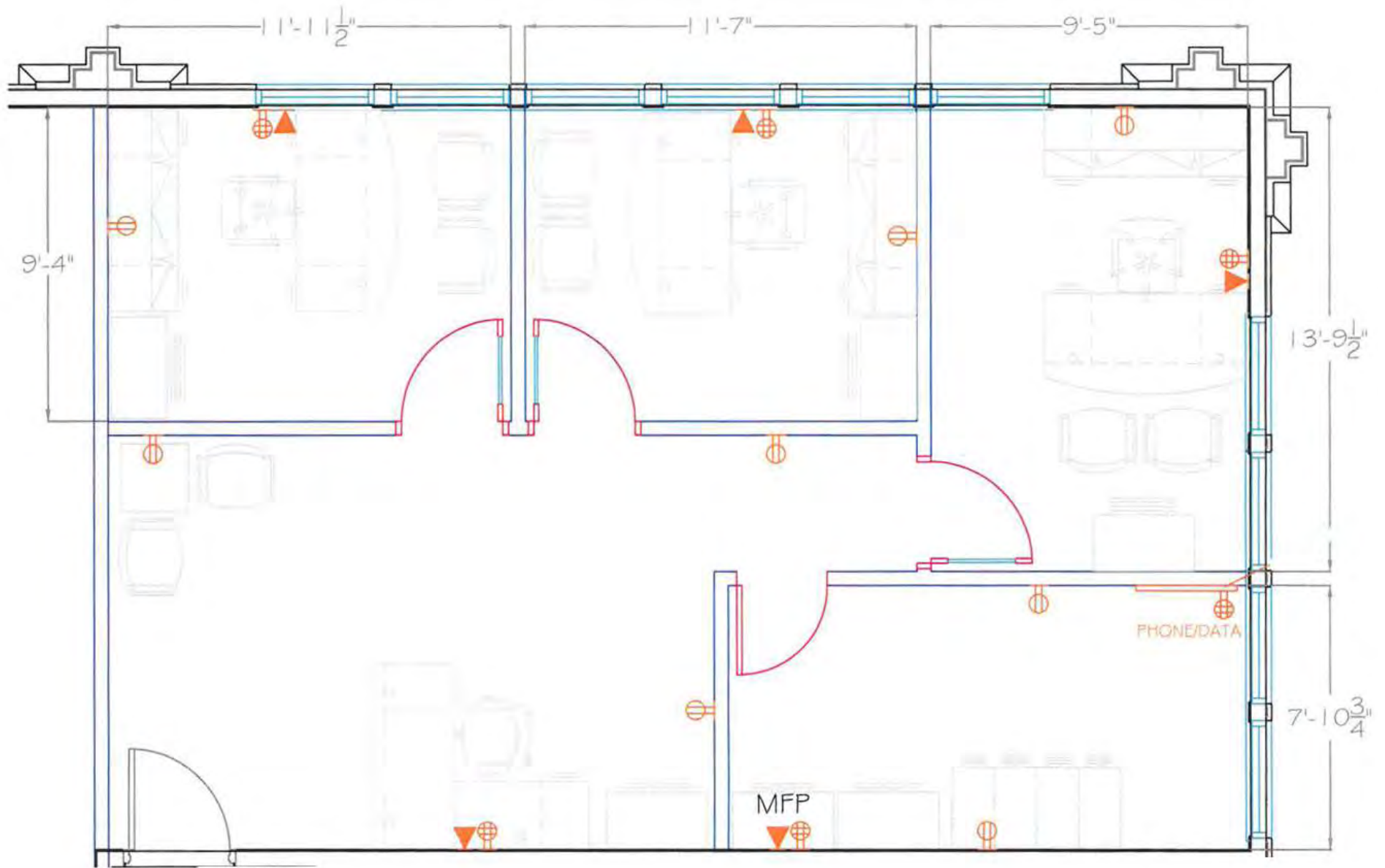





JON LEE, CCA

Certified Commercial Advisor
701.400.4445
jon@thecragroup.com



KRISTYN STECKLER, COMMERCIAL REALTOR®

Broker | Owner
701.527.0138
kristyn@thecragroup.com



@THECRAGROUP

Although information has been obtained from sources deemed reliable, neither Owner nor CRA makes any guarantees, warranties, or representations, express or implied, as to the completeness or accuracy as to the information contained herein. You should conduct a careful, independent investigation of the property and verify all information. Any reliance on this information is solely at your own risk. The Property may be withdrawn without notice. Neither Owner nor CRA accepts any liability for any loss or damage suffered by any party resulting from reliance on this information. Photos, logos, and other images herein are the property of their respective owners. Use of these images without the express written consent of the owner is prohibited.