

1 Acre Out Parcel - Acworth, GA

Pad Ready for 5,000rsf Building - **Billboard Possible**

31,200 cars/day - C2 Zoning - Adjacent to Lowes

Great Visibility and Access to Cobb Parkway

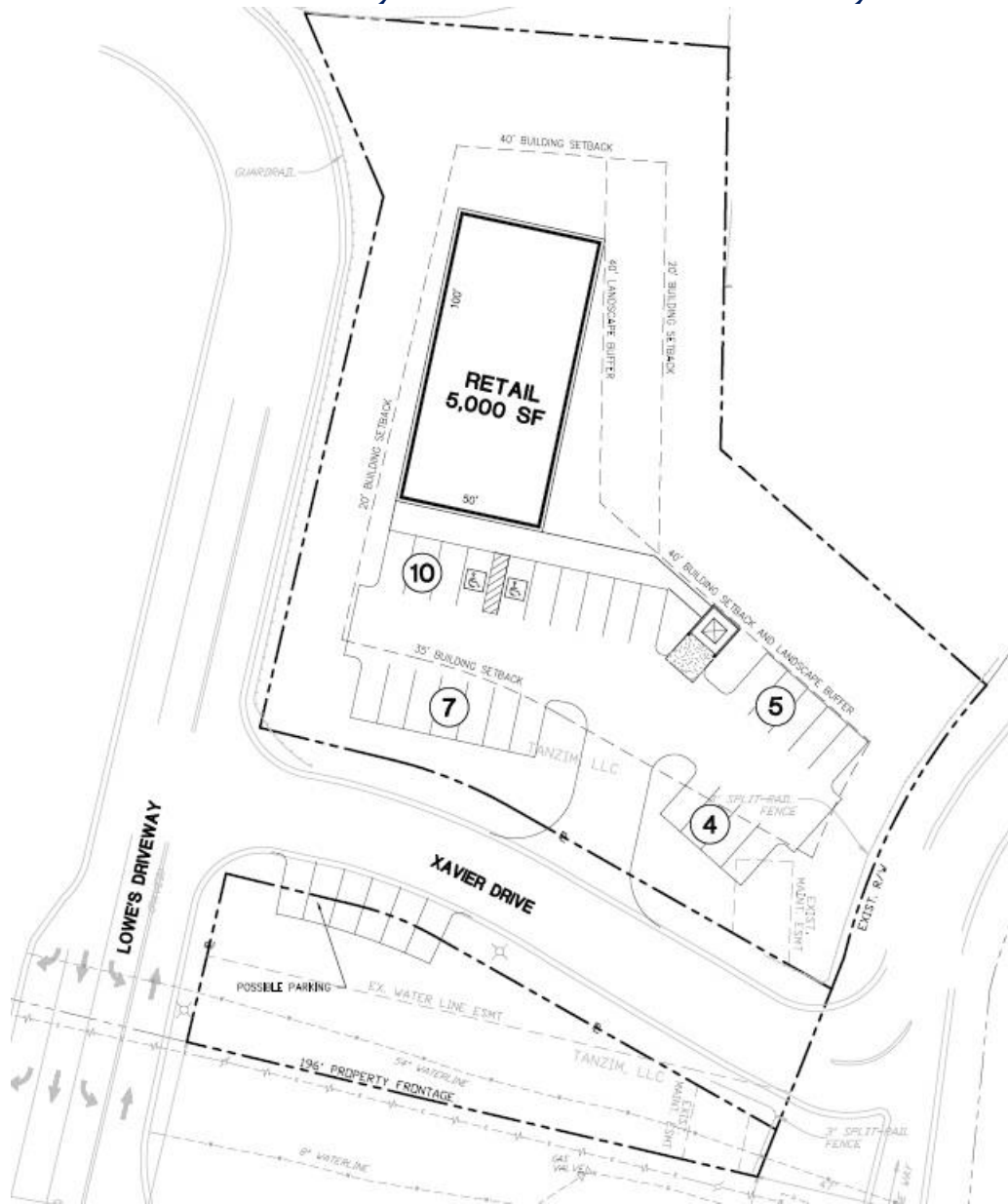

Good Visibility & Signage - Red Light Access

For More Information Contact Rex Baker, Peach State Properties, Inc.

Rex@pspga.com 770-645-9163 Owner/Broker

Owner nor Broker make any guarantees, warranties or representations, express or implied, as to the completeness or accuracy as to the information contained herein. Neither Owner nor Broker accepts any liability for any loss or damage suffered by any party resulting from reliance on this information.