

BOUNDARY SURVEY PLAT

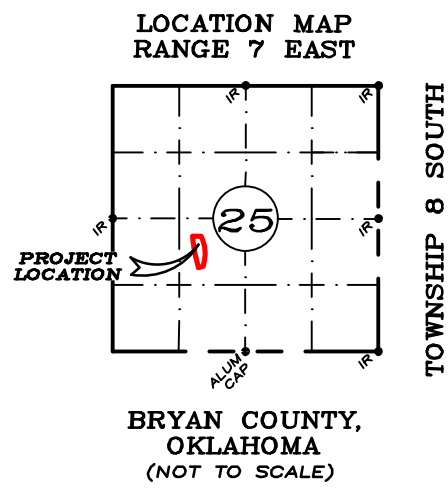

LEGEND

P.O.B.	POINT OF BEGINNING
P.O.C.	POINT OF COMMENCEMENT
●	1/2" STEEL ROD SET
⊙	1/2" STEEL ROD FOUND
(M)	MEASURED
(R)	RECORDED, B. 1271, PG. 17
(OR)	ODOT RECORD, B. 387, PG. 477
PP	POWER POLE
---	BOUNDARY LINE
---	PROPERTY LINE
---	OVERHEAD ELEC.

CURVE TABLE

CURVE	RADIUS	ARC	CHORD BEARING	CHORD
C1	814.94'	577.78'	S 05°26'00" E	565.75'
C2	1769.84'	40.00'	S 15°31'30" W	40.00'
C3	1394.70'	428.99'	N 08°09'27" W	427.30'

LINE TABLE

LINE	BEARING	DISTANCE
L1	S 73°18'39" W	86.04'

FURNISHED LEGAL DESCRIPTION:

A tract of land situated in the SW/4 of Section 25, Township 8 South, Range 7 East of the Indian Base and Meridian, Bryan County, Oklahoma; more particularly described by metes and bounds as follows: Commencing at the W/4 corner of said Section 25, THENCE East 1329.50 feet, THENCE South 348.33 feet to a point of beginning in the East Right of Way of the Frisco Railroad;

THENCE North 89 degrees 32 minutes 00 seconds East a distance of 153.93 feet to a point on the West Right of Way line of U.S. Highway 69/75;

THENCE following said highway right of way around a curve to the right having a radius of 816.03 feet with a arc length of 754.86 feet and a chord, bearing of South 01 degrees 09 minutes 07 seconds West with a chord length of 728.23 feet to a point in the East Right of Way of the Frisco railroad;

THENCE North 15 degrees 41 minutes 28 seconds West along the East right of way of said railroad a distance of 280.71 feet;

THENCE continuing along said railroad right of way around a curve to the right having a radius of 1469.16 feet with an arc length of 462.87 feet to the point of beginning.

REVISED LEGAL DESCRIPTION:

Being a part of NE/4 SW/4 Section 25, Township 8 South, Range 7 East of the Indian Base and Meridian according to the Government Survey thereof and being described by metes and bound as follows:

Commencing at a 1/2" steel rod found for the W/4 corner of said Section 25;

Thence North 89°12'14" East, with the northerly line of said SW/4, a distance of 1594.60 feet to a point;

Thence South 00°47'48" East, a distance of 348.33 feet to a 1/2" steel rod set for the True Point-of-Beginning;

Thence North 89°12'14" East, a distance of 160.53 feet to a set 1/2" steel rod;

Thence with a curve to the right having a radius of 814.94 feet, (chord bears South 05°26'00" East, 565.75 feet) an arc length of 577.78 feet to a set 1/2" steel rod;

Thence with a compound curve to the right having a radius of 1769.84 feet, (chord bears South 15°31'30" West, 40.00 feet) an arc length of 40.00 feet to a set 1/2" steel rod;

Thence South 73°18'39" West, a distance of 86.04 feet to a set 1/2" steel rod;

Thence North 16°41'21" West, a distance of 210.10 feet to a set 1/2" steel rod;

Thence with a curve to the right having a radius of 1394.70 feet, (chord bears North 08°09'27" West, 427.30 feet) an arc length of 428.99 feet to the Point of Beginning and containing 2.53 acres of land, more or less.

GENERAL NOTES:

- LEGAL DESCRIPTION IN BOOK 1271, PAGE 17 OVERLAPS THE STATE OF OKLAHOMA TAKING IN BOOK 387, PAGE 477.
- LEGAL DESCRIPTION IN BOOK 1271, PAGE 17 ONLY HAS ONE CURVE FOR RAMP "A". ODOT AND BOOK 387, PAGE 477 HAS TWO CURVES ALONG RAMP "A"

