



30622 & 30682 Santa Margarita Pkwy.
Rancho Santa Margarita, CA 92691

30682 Santa Margarita Pkwy.
Potential Recapture - Big 5
DEMISABLE 2,200 - 10,000 SF
ONLY DRIVE-THRU OPPORTUNITY IN RSM



**SANTA
MARGARITA
TOWN CENTER**



30622 Santa Margarita Pkwy.
Former Five Guys
3,250 SF
2ND GENERATION END CAP



SANTA MARGARITA TOWN CENTER

Available Space Locations



SANTA MARGARITA TOWN CENTER

30682 Santa Margarita Pkwy.
[Big 5 Space]

A ONCE-IN-A-LIFETIME OPPORTUNITY

This is not just another pad site. This is the **iconic front-door location** to Rancho Santa Margarita's #1 Shopping Center — anchored by Trader Joe's, Target, McDonald's, Ross, Panera Bread, and Chili's. It is one of the most successful, highest-traffic centers in all of Orange County, and now, ownership has created a **rare, first-of-its-kind drive-thru opportunity**.

POTENTIAL PLAN 1

Tenant 100: 7,000 SF
Tenant 101: 3,000 SF

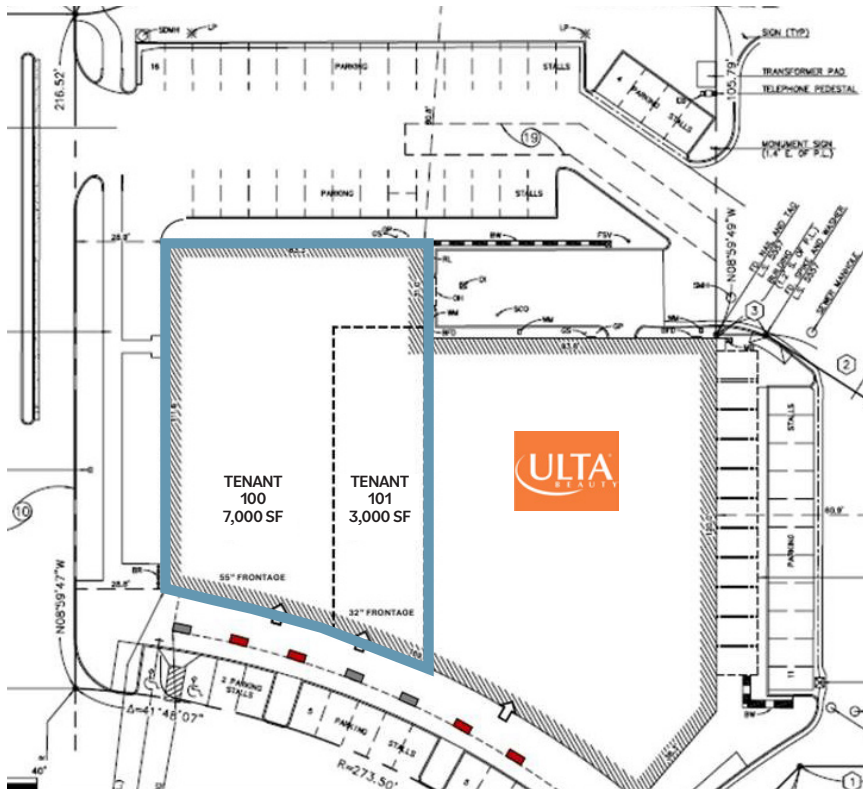

POTENTIAL PLAN 2

Tenant 100: 3,900 SF
Tenant 101: 3,900 SF
Tenant 102: 2,200 SF with drive-thru

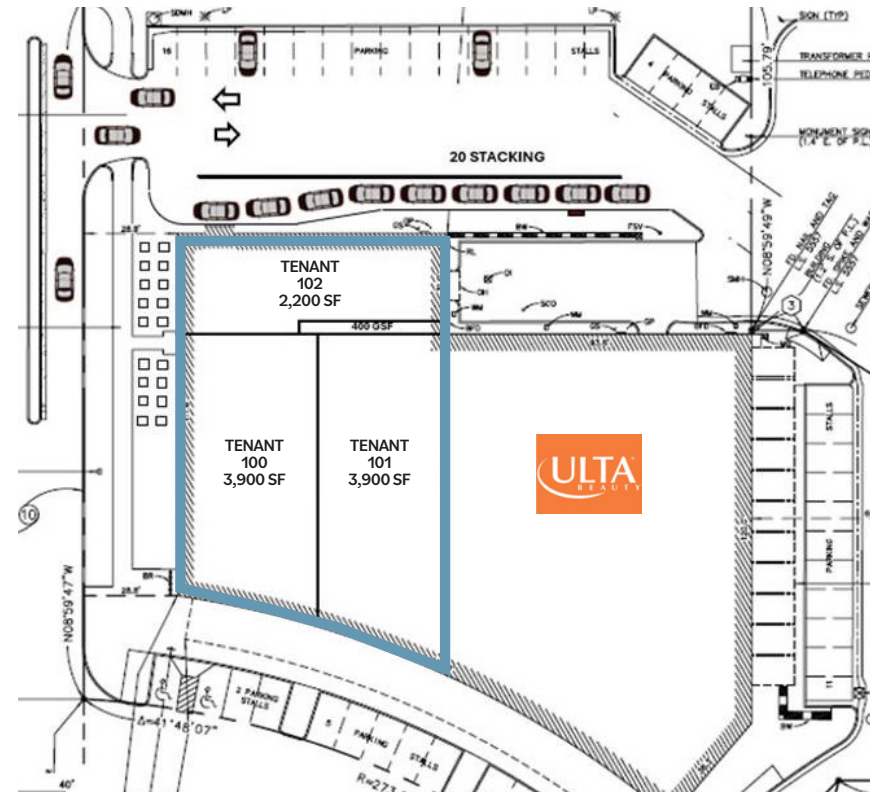

- Site plans are for illustration purposes only.
- Landlord open to uses and layouts as requested by potential tenants.

SANTA MARGARITA TOWN CENTER

Rendering
Drive-Thru Concept
View From Santa Margarita Pkwy.



SANTA MARGARITA TOWN CENTER

Surrounding Retail



SANTA MARGARITA TOWN CENTER

Tenant Summary/Available Space



30682 Santa Margarita Pkwy.
Potential Recapture - Big 5
DEMISABLE 2,200 - 10,000 SF
ONLY DRIVE-THRU OPPORTUNITY IN RSM

- **Front entrance position** directly into the Trader Joe's, Target Shopping Center.
- **Incredible visibility and signage at the main intersection**, with direct exposure to Rancho Santa Margarita Parkway.

Unit	Tenant	SF
30622		
D97	2nd Gen Restaurant End Cap	3,250
D98/D99	Wells Fargo Bank	5,362
D100	Cleaners	1,331
D101	Happy Nails	1,366
D102	OC Hair & Makeup	1,425
D103	Amazing Lash Studio	1,425
D104-105	Handel's Ice Cream	2,036
D106	Flame Broiler	1,107
30642		
E101	T-Mobile	1,903
E102	Panera Bread	3,100
E103	Poke Bowlz	996
E104	Sgt. Pepperoni's Pizza Store	2,604
E105	Wanfu China Bistro	2,233
30652		
F101A	Hand & Stone	2,450
F101B	Cox	2,560
F102/F103	Trader Joe's	10,826
F105	Lindora	3,354
F106	HOTWORX	1,500
F107	Kumon Math and Reading	1,250
30682		
--	Potential Recapture (Big 5)	10,000
--	Ulta Beauty	11,746



- **Only drive-thru opportunity in RSM**
- A front-row seat at the entrance to **the most successful retail hub in the trade area**
- **Best-in-class ownership** offering flexibility, creativity, and a true win-win partnership
- **Seamless freeway access**—located just off the toll road with effortless regional connectivity
- **Daily traffic powerhouse** with non-stop flow from both Trader Joe's and Target, plus cross-shopping synergy with McDonald's, Ross, Panera, and Chili's.
- **Unrivaled visibility** from both directions of Rancho Santa Margarita Parkway.
- Positioned at the **#1 center in RSM**, with the strongest anchors and highest consumer draw.
- **Dominate location in an upscale master planned community**, centrally located in the middle of the city and situated next to City Hall and other civic offices
- **Abundant parking**, ample open space and easy accessibility
- **High income demographics**
- **Diverse array of retail outlets**, from popular national brands to unique local shops
- **Numerous dining options** from casual, fast food, or sit-down experiences

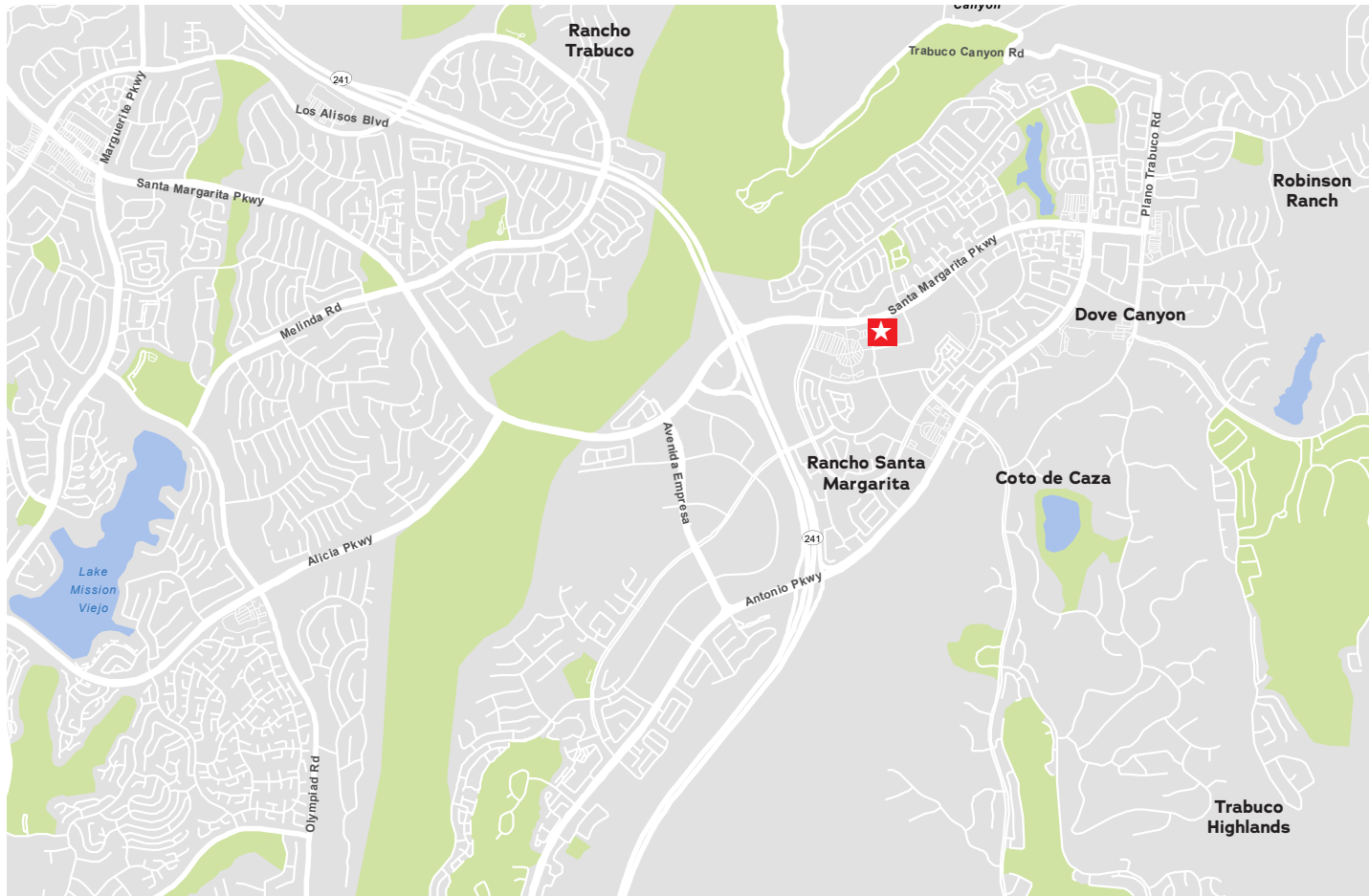

Corporate License #01796698

The distributor of this communication is performing acts for which a real estate license is required. The information contained herein has been obtained from sources deemed reliable but has not been verified and no guarantee, warranty or representation, either express or implied, is made with respect to such information. Terms of sale or lease and availability are subject to change or withdrawal without notice.

POPULATION

1 Mile	15,744
3 Miles	77,341
5 Miles	169,485

DAYTIME POPULATION

1 Mile	16,364
3 Miles	57,755
5 Miles	137,884

AVERAGE HOUSEHOLD INCOME

1 Mile	\$155,609
3 Miles	\$207,776
5 Miles	\$199,183

For more information, please contact:

Mark Baziak

Senior Managing Director
t 949-608-2049
mark.baziak@nrmrk.com
CA RE Lic. #01202116

Bryan Norcott

Executive Managing Director
t 213-298-3595
bryan.norcott@nrmrk.com
CA RE Lic. #01054568