

±393,440 SF AVAILABLE FOR SUBLEASE

14301 Mattawoman Drive

Brandywine, MD

PROPERTY FEATURES

Located just 20 miles from Washington DC and 50 miles from the Port of Baltimore, 14301 Mattawoman Drive provides easy access to Interstate 95 and Route 301.

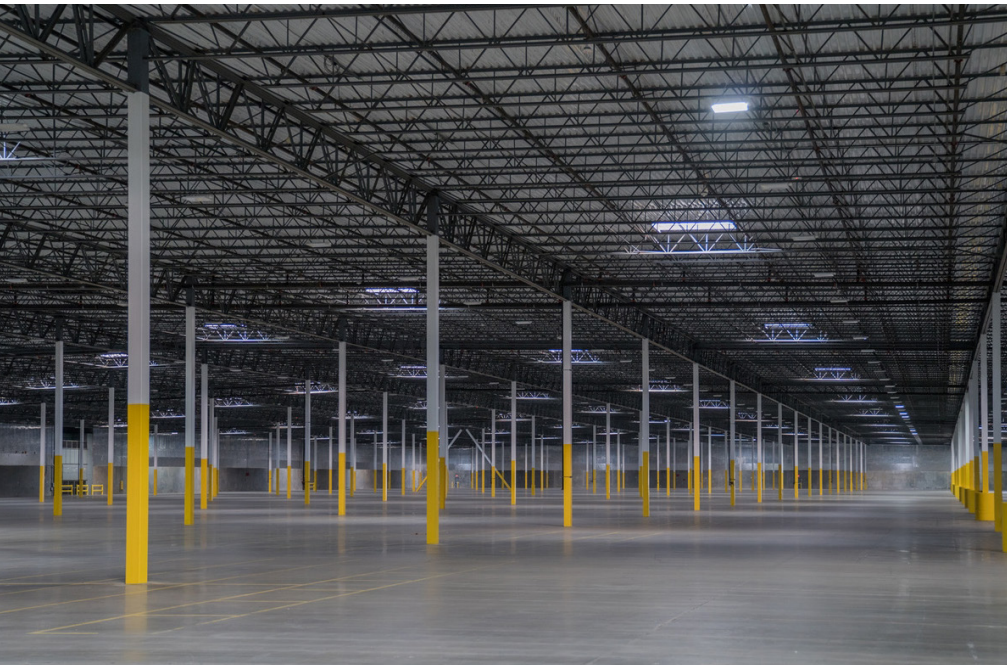

Building Size:	± 393,440 SF
Space Available:	± 393,440 SF
Office Area:	± 9,440 SF
Clear Height:	27' - 29'
Dock Doors:	52 Fully equipped docks
Year Built:	1998
Column Spacing:	48 x 50'
Sprinkler:	ESFR
	12' x 16' Ramped Drive in
	3,000 AMP/480 Volt 3 ph 4/wire electric
	4 Recessed air rotation units
	LED Motion sensory lighting
	66 Trailer drops
	180' Fenced Truck Court

FLOOR PLANS

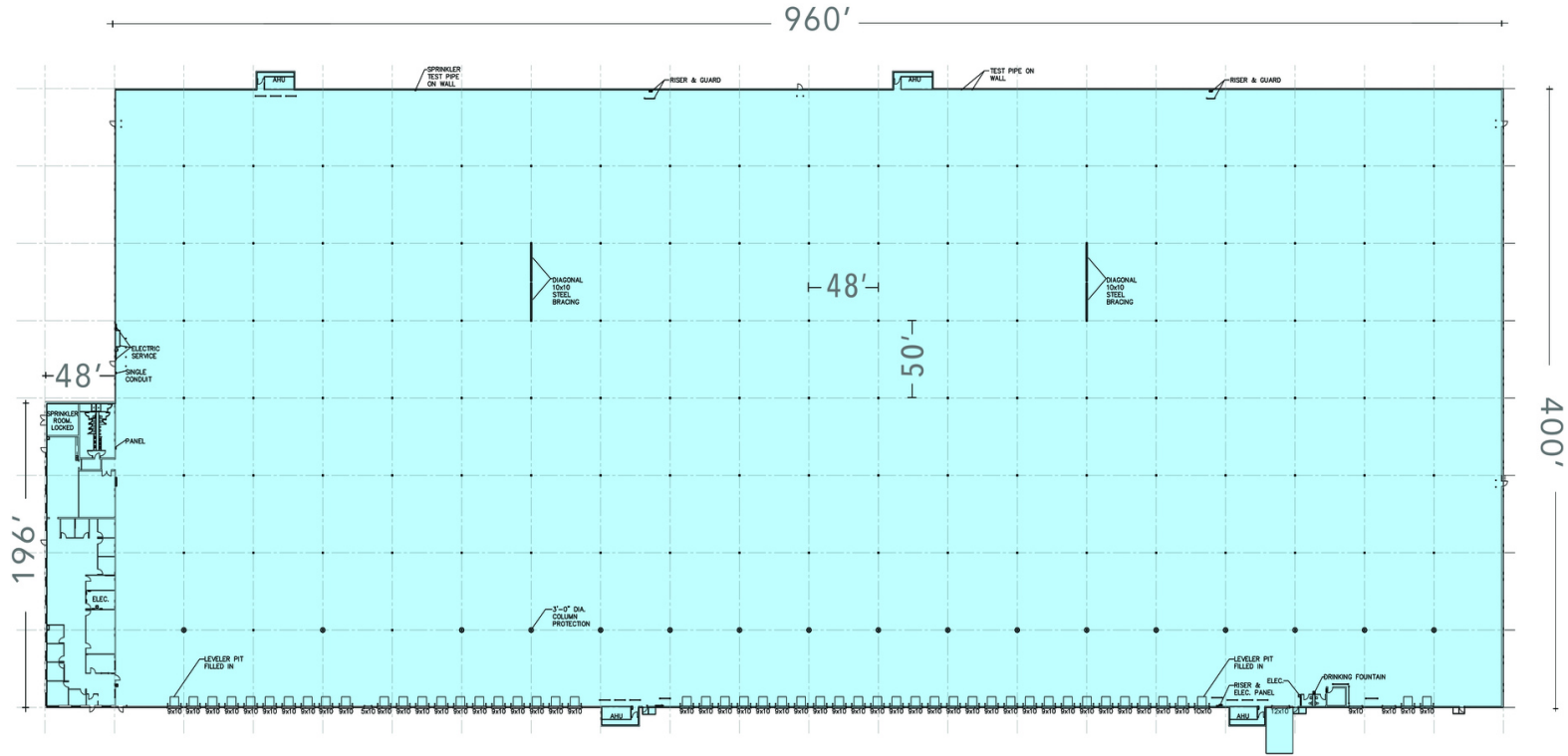

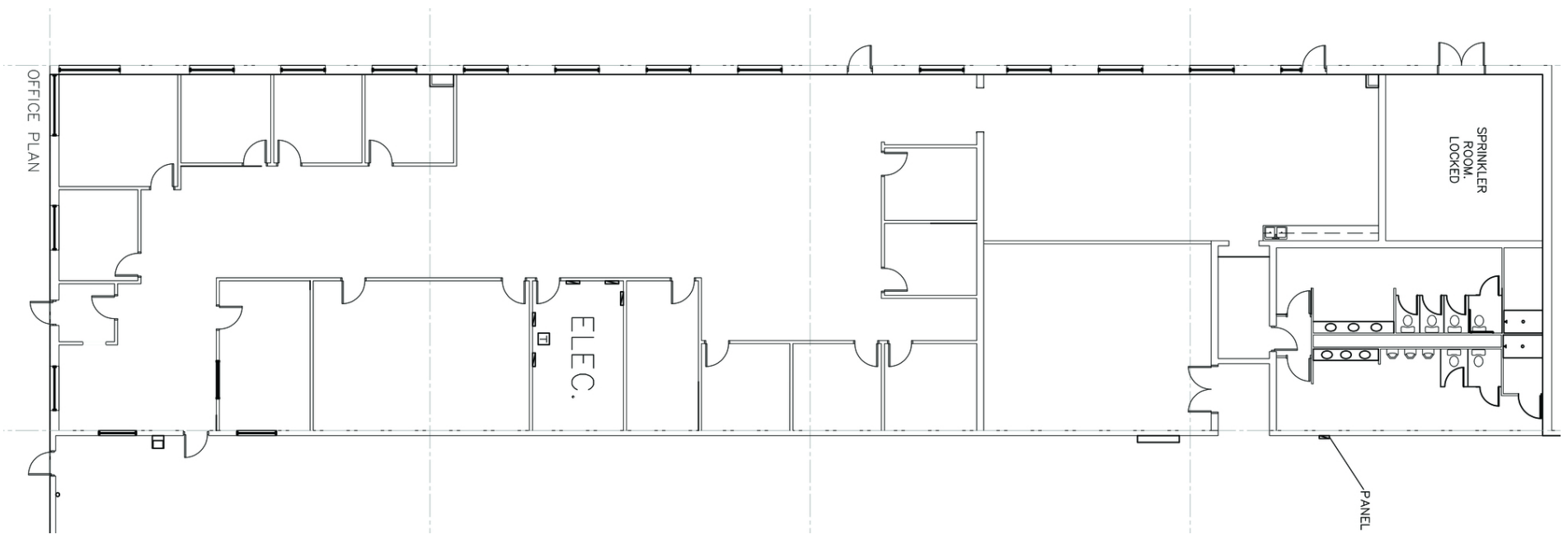

CORPORATE NEIGHBORS



REGIONAL CONNECTIONS

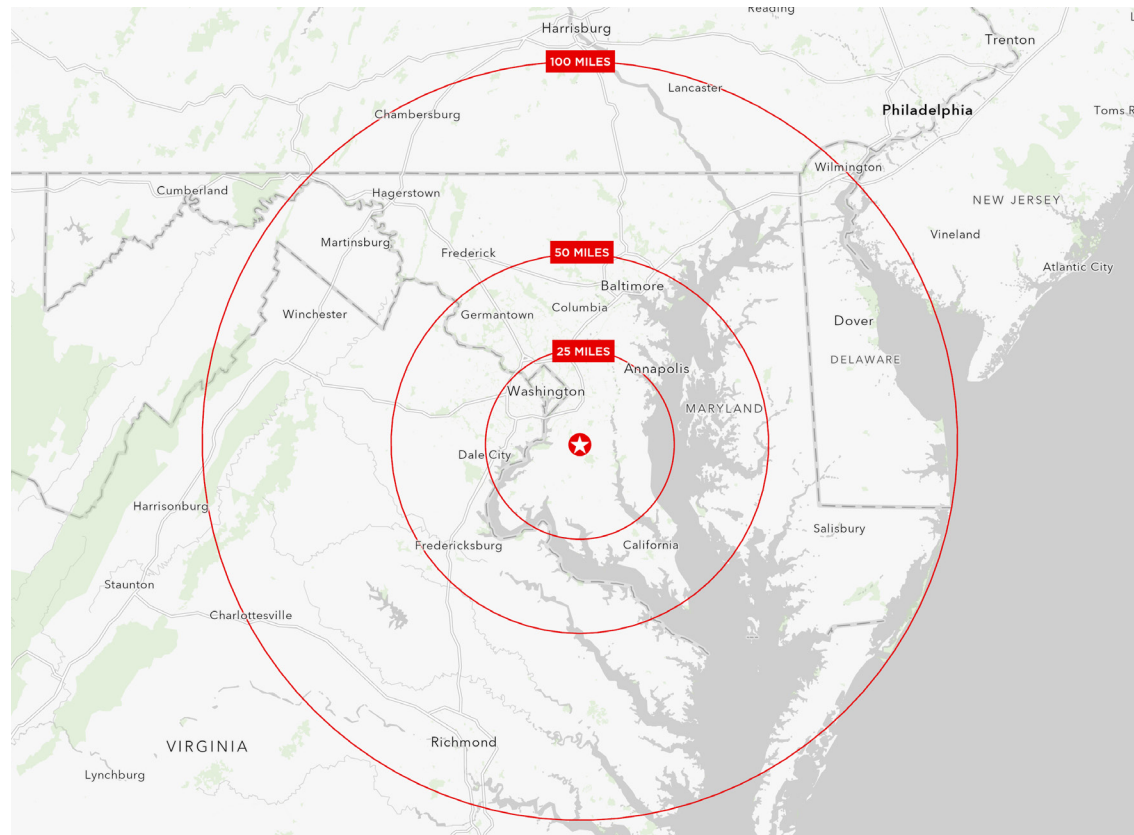

POPULATION

2023 Total Population
2023 Median Age

25 MILES

3,419,879
37.9

50 MILES

8,240,444
38.4

100 MILES

14,058,381
39.4

HOUSEHOLDS & INCOME

2023 Total households
2023 Average Household Size
2023 Average Household Income
2023 Average Home Value

25 MILES

1,342,364
2.49
\$158,182
\$647,415

50 MILES

3,111,349
2.60
\$154,692
\$590,234

100 MILES

5,374,656
2.56
\$136,786
\$497,291

CONTACT

KATIE GORMLEY
+1 301 634 8492
katie.gormley@cushwake.com

PETER ROSAN
+1 301 634 8487
peter.rosan@cushwake.com



©2023 Cushman & Wakefield. All rights reserved. The material in this presentation has been prepared solely for information purposes, and is strictly confidential. Any disclosure, use, copying or circulation of this presentation (or the information contained within it) is strictly prohibited, unless you have obtained Cushman & Wakefield's prior written consent. The views expressed in this presentation are the views of the author and do not necessarily reflect the views of Cushman & Wakefield. Neither this presentation nor any part of it shall form the basis of, or be relied upon in connection with any offer, or act as an inducement to enter into any contract or commitment whatsoever. NO REPRESENTATION OR WARRANTY IS GIVEN, EXPRESS OR IMPLIED, AS TO THE ACCURACY OF THE INFORMATION CONTAINED WITHIN THIS PRESENTATION, AND CUSHMAN & WAKEFIELD IS UNDER NO OBLIGATION TO SUBSEQUENTLY CORRECT IT IN THE EVENT OF ERRORS.