



Spectrum Blvd 3,192 CPD

Price Rd 38,220 CPD

SUBJECT

VENEZIA'S
PIZZERIA

THE Parlay
KITCHEN + COCKTAILS

Future
Commercial
Development

PARK PLACE STATION

±1,650 SF SPACE FOR LEASE

Northeast Corner of Spectrum Blvd and Price Rd
Chandler, AZ 85286

Joe Hoyer
602.682.8163
joe.hoyer@velocityretail.com



PARK PLACE STATION



◆ **±1,650 SF SPACE FOR LEASE NEXT TO PARLAY KITCHEN AND VENEZIA'S PIZZA**

Property Highlights

- Strong Co-Tenancy: Located next to Venezia's NY Style Pizzeria, Starbucks, and other popular retailers in the Park Place center.
- High Visibility: Excellent corner exposure with a monument sign and 455 feet of Price Rd frontage.
- Easy Access: Convenient dual entry from Price Rd and Spectrum Blvd with ample parking.
- Affluent Demographics: Surrounded by households with ~\$141K median income and high consumer spending.
- Daytime Traffic: Located in Chandler's Price Corridor with major employers like Northrop Grumman, Toyota Financial, and Wells Fargo nearby.
- Freeway Proximity: Quick access to Loop 202 and Loop 101 for regional visibility and convenience.
- Growing Market: Area continues to expand with new retail, office, and entertainment developments

Traffic Counts

Spectrum Blvd	3,192 CPD
Price Rd	38,220 CPD
Loop 202	174,115 CPD
Total	215,527 CPD

Demographics

	1 mi	3 mi	5 mi
Estimated Population	7,842	99,871	237,060
Estimated Households	3,387	40,057	94,403
Avg Household Income	\$134,471	\$140,764	\$141,734
Daytime Population	10,543	39,642	104,747

Source: SitesUSA

Joe Hoyer
602.682.8163
joe.hoyer@velocityretail.com



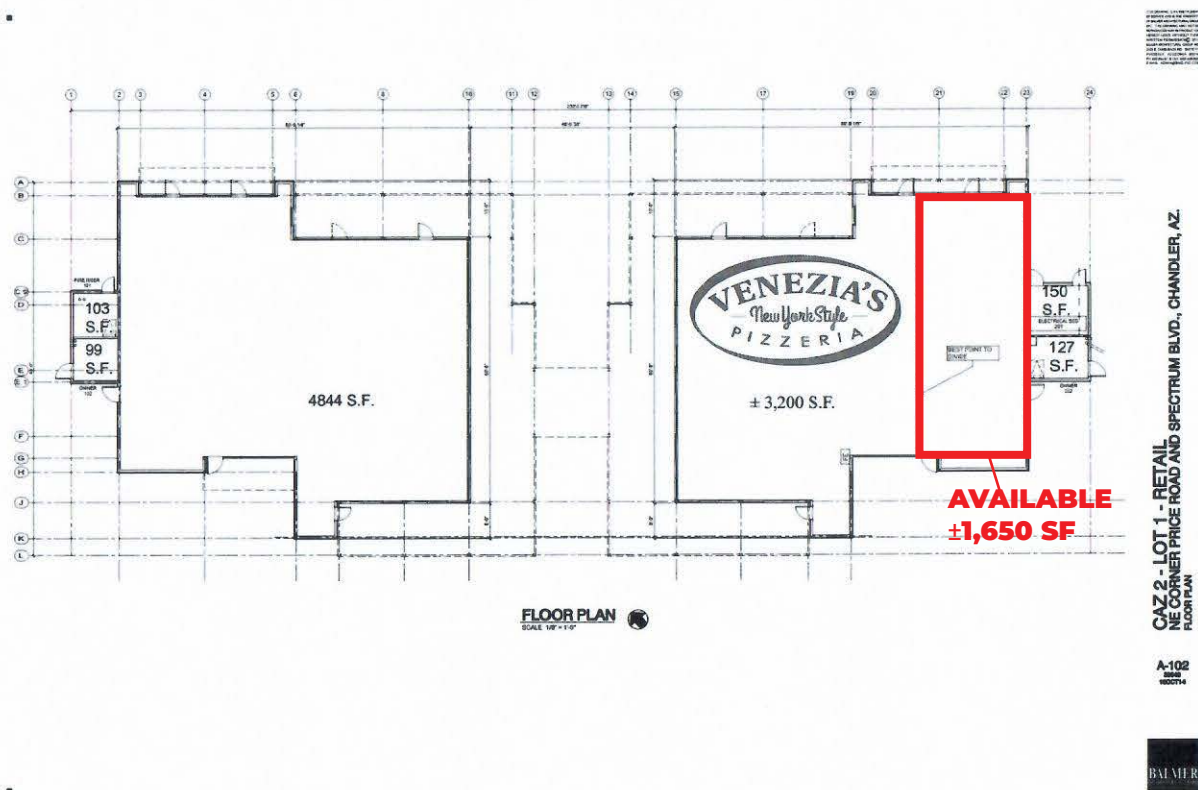







DEMOGRAPHICS



2025 POPULATION

1 MILE: 7,842
3 MILES: 99,871
5 MILES: 237,060



MEDIAN HOUSEHOLD INCOME

1 MILE: \$134,471
3 MILES: \$140,764
5 MILES: \$141,734



2025 TOTAL HOUSEHOLDS

1 MILE: 3,387
3 MILES: 40,057
5 MILES: 94,403



TOTAL BUSINESSES

1 MILE: 474
3 MILES: 4,419
5 MILES: 11,601



MEDIAN HOME VALUE

1 MILE: \$551,438
3 MILES: \$520,886
5 MILES: \$511,019



NUMBER OF EMPLOYEES

1 MILE: 10,543
3 MILES: 39,642
5 MILES: 104,747

©2022, Sites USA, Chandler, Arizona, 480-491-1112 Demographic Source: Applied Geographic Solutions 6/2022, TIGER Geography - RF5
This report was produced using data from private and government sources deemed to be reliable. The information herein is provided without representation or warranty.



VELOCITY
RETAILGROUP

2415 East Camelback Road, Suite 400
Phoenix, Arizona 85016
602.682.8100

Joe Hoyer

602.682.8163

joe.hoyer@velocityretail.com

The information contained in this brochure has been obtained from sources believed reliable. We have not verified the information, and make no guarantee, warranty or representation about it. Any financial projections, assumptions or estimates used are for example only and do not represent the current or future performance of the property. We recommend that you and/or your advisors conduct a complete analysis of the property and make your own determination on the suitability of the property for your specific needs. Accelerated Development Services and the ADS logo are service marks of Velocity Retail Group, LLC. All other marks displayed in this document are the property of their respective owners.



VELOCITY
RETAILGROUP