



FOR LEASE

191 MARGINAL WAY
PORTLAND, ME 04101

- 3,522± SF retail/office unit
- Exceptionally well-located, mixed-use building; walkability score of 93
- Marginal Way frontage and high exposure to I-295
- Rare opportunity for retail, office and medical users to join anchor tenants ConvenientMD, Dunkin', Thrive Dental Studio and PetMedic
- Close to I-295 on/off ramps with combined traffic counts in excess of 70,000 per day

**HIGHLY VISIBLE
RETAIL/OFFICE
UNIT**

FOR LEASE

191 MARGINAL WAY, SUITES E-F
PORTLAND, ME 04101



PROPERTY DETAILS

OWNER	Earle W. Noyes & Sons
ASSESSOR'S REFERENCE	Map 24, Block C, Lot 21 Map 25, Block B, Lot 9
BUILDING SIZE	16,750± SF
AVAILABLE SPACE	3,522± SF
# OF STORIES	One (1)
INTERIOR LAYOUT	Mixture of private offices and open area with a conference room, break room and kitchenette
RESTROOMS	Two (2)
YEAR BUILT	1969, Completely Renovated in 2016/2017
HVAC	Heat - Natural gas-fired AC - Electric Separately metered
ZONING	B3 - Downtown Business
LOT FRONTAGE	303' on Marginal Way
UTILITIES	Municipal water/sewer
SIGNAGE	Monument and building signage
PARKING	Eighty-eight (88) spaces in common
LEASE RATE	\$38.00/SF NNN
REAL ESTATE TAXES	\$3.47/SF (Est.)
NNN EXPENSES	\$6.11/SF (Est.)



FOR LEASE

191 MARGINAL WAY, SUITES E-F
PORTLAND, ME 04101



FLOOR PLAN

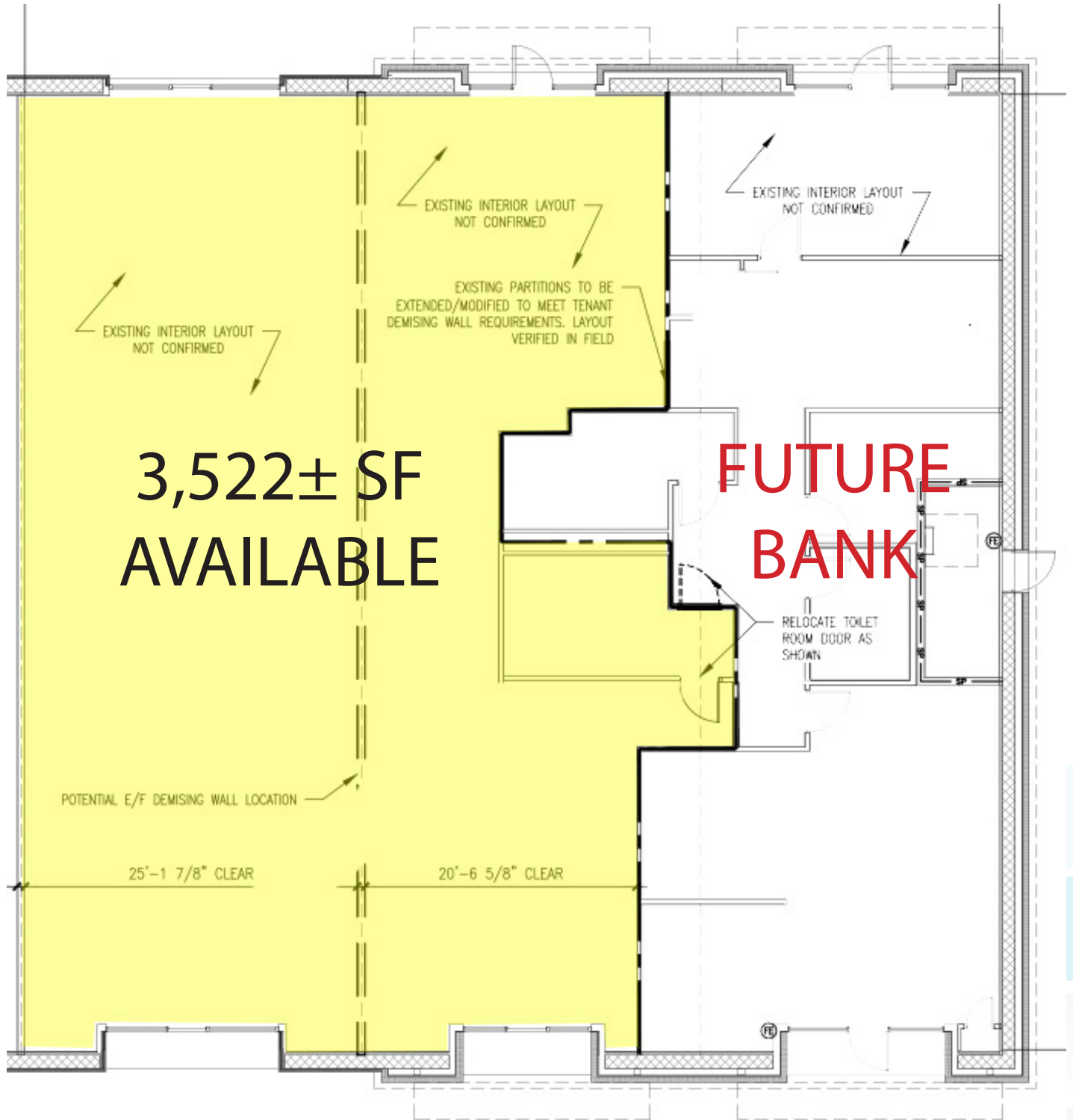

FOR LEASE

191 MARGINAL WAY, SUITES E-F
PORTLAND, ME 04101

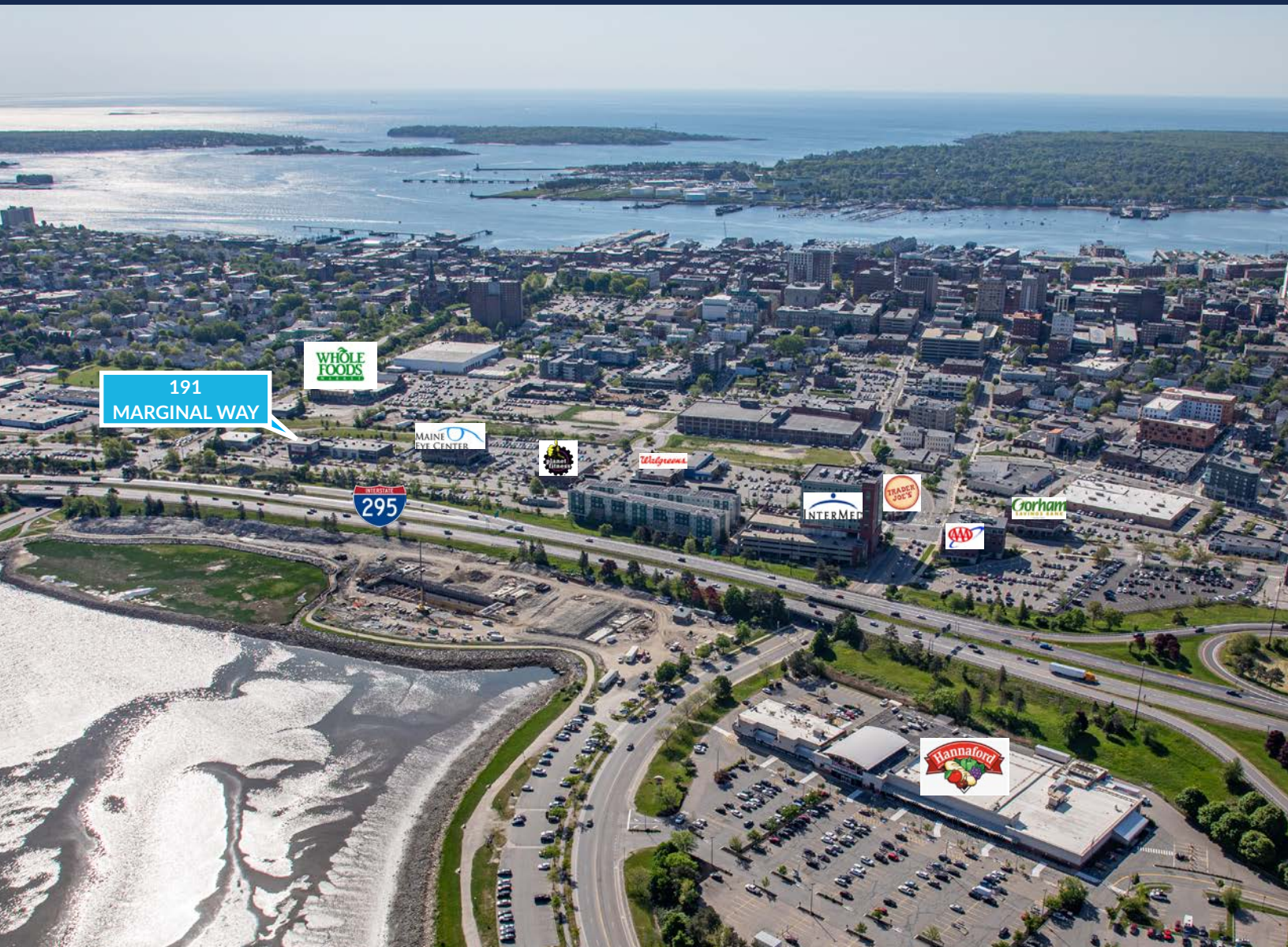

CONTACT US



SAMANTHA MARINKO
Broker

+1 207.553.1723 D
+1 908.433.5049 C
smarinko@boulos.com



GREG BOULOS
Managing Partner

+1 207.553.1715 D
+1 207.831.3000 C
gboulos@boulos.com

©2026 The Boulos Company, Inc. All rights reserved. This information has been obtained from sources believed reliable but has not been verified for accuracy or completeness. You should conduct a careful, independent investigation of the property and verify all information. Any reliance on this information is solely at your own risk. The Boulos Company and The Boulos Company logo are service marks of The Boulos Company, Inc. All other marks displayed on this document are the property of their respective owners. Photos herein are the property of their respective owners. Use of these images without the express written consent of the owner is prohibited.