

FOR LEASE

# Shoreline Retail

3542 Shoreline Dr Wayzata, MN 55391

FORREST KALK

763.706.7901

forrest@cre-fund.com



**PROPERTY DESCRIPTION**

Located along Shoreline Drive, the property benefits from strong local traffic, a refined neighborhood atmosphere, and convenient access to nearby retail, dining, and residential communities. The surrounding area is synonymous with quality, making it an ideal setting for professional services, boutique retail, specialty medical, wellness, or other customer-facing businesses seeking a distinguished address. Suite 3542 A is the showroom side of the building, with large windows and shared bathrooms.

**PROPERTY HIGHLIGHTS**

- Prominent Shoreline Drive visibility
- Flexible space for various uses
- Spacious open floor plan
- Ample interior lighting throughout
- Convenient drive-in door for deliveries and access

**OFFERING SUMMARY**

Lease Rate:	\$14 SF/yr (NNN)
Available SF:	1,505 - 3,380 SF
Building Size:	5,876 SF

DEMOGRAPHICS	0.25 MILES	0.5 MILES	1 MILE
Total Households	52	256	1,351
Total Population	123	533	2,578
Average HH Income	\$166,513	\$155,067	\$139,348



### **PROPERTY DESCRIPTION**

Located along Shoreline Drive, the property benefits from strong local traffic, a refined neighborhood atmosphere, and convenient access to nearby retail, dining, and residential communities. The surrounding area is synonymous with quality, making it an ideal setting for professional services, boutique retail, specialty medical, wellness, or other customer-facing businesses seeking a distinguished address. Suite 3542 A is the showroom side of the building, with large windows and shared bathrooms.

### **LOCATION DESCRIPTION**

Explore Shoreline Retail in Wayzata, MN, an upscale lakeside community with boutique shops, fine dining, and scenic Lake Minnetonka nearby. This prime location offers the perfect setting for a retail or free standing building tenant to thrive.

### **SITE DESCRIPTION**

This property is well suited for office, showroom, service, or specialty retail users seeking a customer-facing location with operational capabilities.

The building features tall ceilings, an open-plan layout, ample LED lighting, central air conditioning and heating, and private restrooms.

A 10 ft by 8 ft drive-in door provides efficient grade-level access for deliveries or equipment. The site includes 16 dedicated parking spaces and excellent signage opportunities, including large pylon signage, offering strong exposure along Shoreline Drive with high daily traffic counts.

This single-tenant building presents a compelling opportunity for users seeking a high-visibility location with flexible use potential in a supply-constrained submarket.

Lease Rate	<b>\$14 SF/YR NNN</b>
------------	-----------------------

**LOCATION INFORMATION**

Building Name	Shoreline Retail
Street Address	3542 Shoreline Dr
City, State, Zip	Wayzata, MN 55391
County	Hennepin

**PROPERTY INFORMATION**

Property Type	Retail or Office
Property Subtype	Free Standing Building
Zoning	B-5 Limited Neighborhood Business District

**BUILDING INFORMATION**

Building Size	5,876 SF
Ceiling Height	16 ft
Year Built	1986
Year Last Renovated	2026





**LEASE INFORMATION**

Lease Type:	NNN	Lease Term:	Negotiable
Total Space:	1,505 - 3,380 SF	Lease Rate:	\$14 SF/yr

**AVAILABLE SPACES**

SUITE	TENANT	SIZE (SF)	LEASE TYPE	LEASE RATE	DESCRIPTION
Suite 3542 A	Available	1,875 - 3,380 SF	NNN	\$14.00 SF/yr	Flexible office and showroom suites available from 1,505 to 1,875 SF, or up to 3,380 SF. Shared restrooms. Functional layouts accommodate a variety of office, showroom, and light flex users.
Suite 3542 B	Available	1,505 - 3,380 SF	NNN	\$14.00 SF/yr	Flexible office and showroom suites available from 1,505 to 1,875 SF, or up to 3,380 SF. Shared restrooms. Functional layouts accommodate a variety of office, showroom, and light flex users.

# SUITES AVAILABLE

3542-A Shoreline Drive

## UNIT INFORMATION

Unit Size	3,376 SF
Drive-In Door	No
Parking	16
Shared Bathrooms	YES - 2
Lease Rate	\$18 PSF NNN

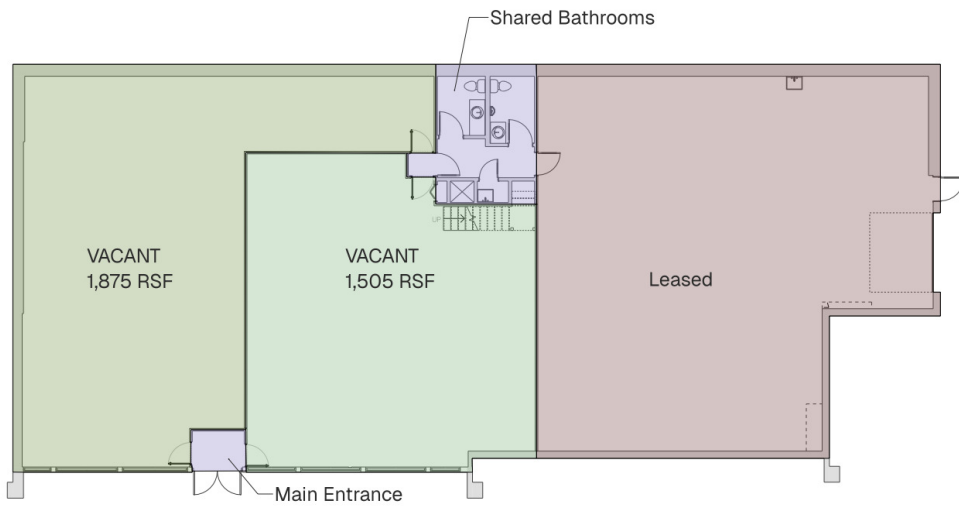



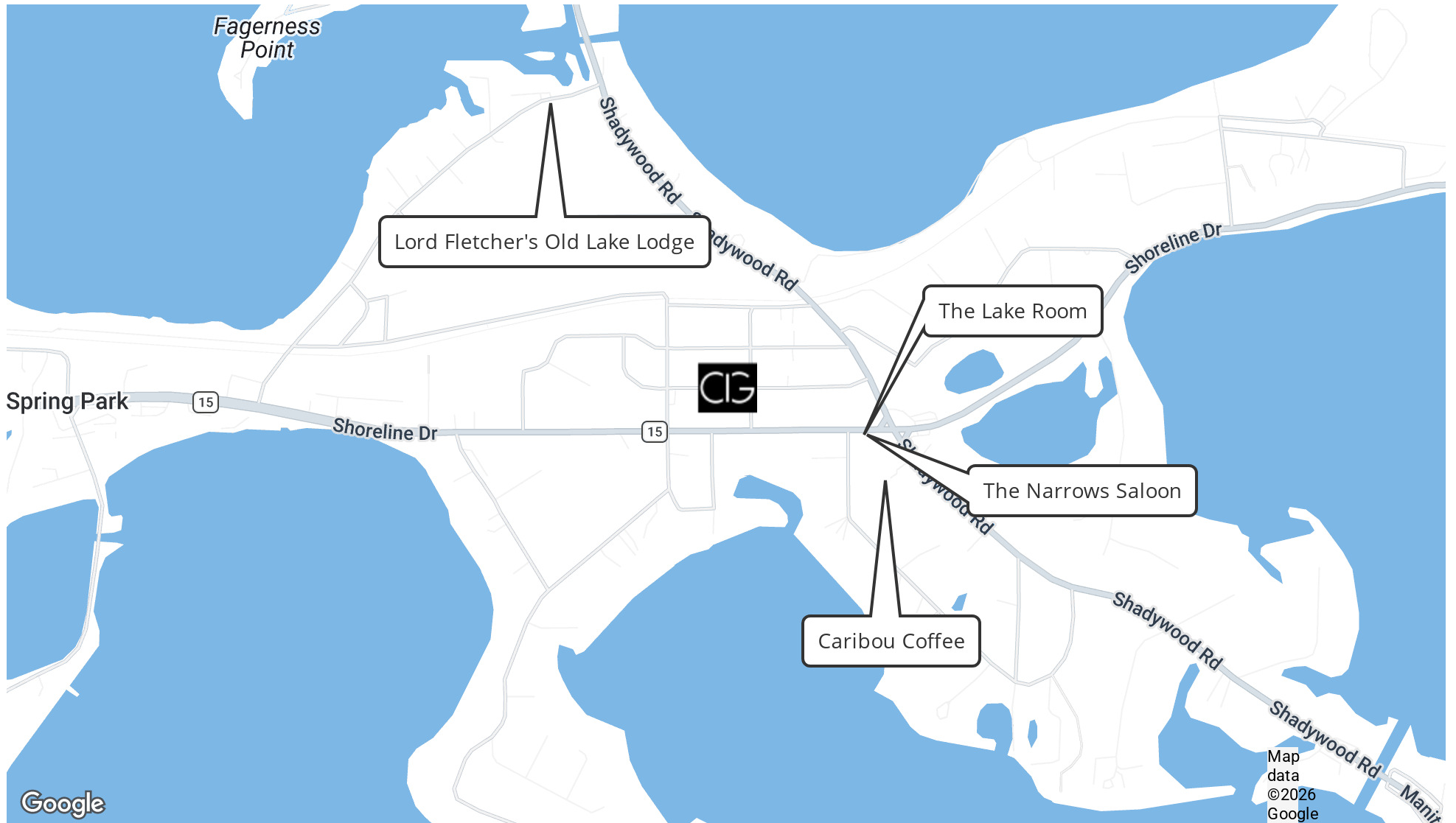

<b>POPULATION</b>	<b>0.25 MILES</b>	<b>0.5 MILES</b>	<b>1 MILE</b>
Total Population	123	533	2,578
Average Age	55.0	55.1	54.4
Average Age (Male)	55.5	55.0	54.2
Average Age (Female)	54.6	55.5	55.1

<b>HOUSEHOLDS &amp; INCOME</b>	<b>0.25 MILES</b>	<b>0.5 MILES</b>	<b>1 MILE</b>
Total Households	52	256	1,351
# of Persons per HH	2.4	2.1	1.9
Average HH Income	\$166,513	\$155,067	\$139,348
Average House Value	\$610,277	\$734,238	\$741,625

2023 American Community Survey (ACS)

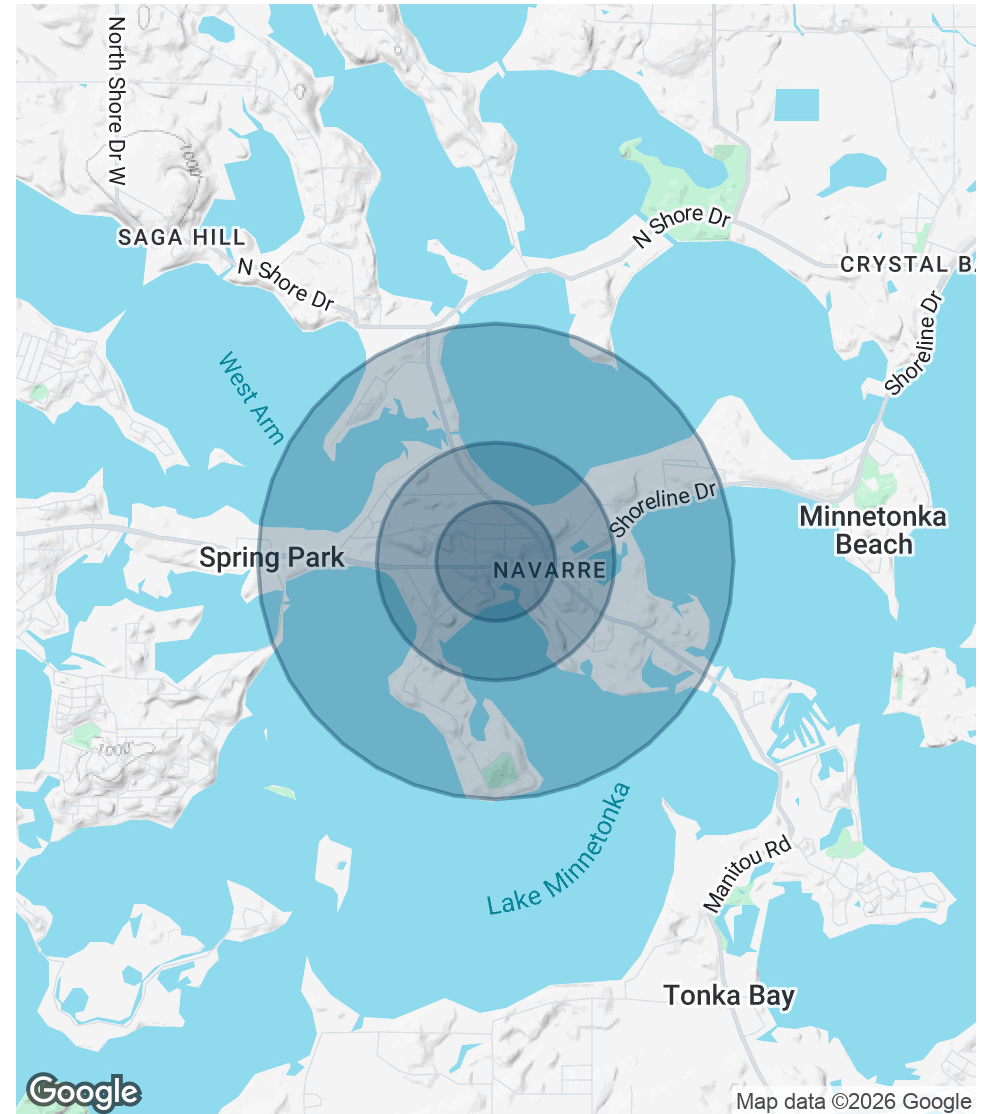

## COMMERCIAL INVESTORS GROUP

7825 Washington Avenue South, Suite 700 Minneapolis MN , 55439

763.706.7901

[cre-fund.com](http://cre-fund.com)

## FORREST KALK

763.706.7901

[forrest@cre-fund.com](mailto:forrest@cre-fund.com)

## FORREST KALK

763.706.7901

[forrest@cre-fund.com](mailto:forrest@cre-fund.com)

This document has been prepared by Commercial Investors Group for advertising and general information only. Commercial Investors Group makes no guarantees, representations or warranties of any kind, expressed or implied, regarding the information including, but not limited to, warranties of content, accuracy and reliability. Any interested party should undertake their own inquiries as to the accuracy of the information. Commercial Investors Group excludes unequivocally all inferred or implied terms, conditions and warranties arising out of this document and excludes all liability for loss and damages arising therefrom. This publication is the copyrighted property of Commercial Investors Group and/or its licensors. ©2026. All rights reserved.