

Pier 17



SITE FEATURES

- 18,000 SQUARE FEET (APPROX).
- ADJACENT TO THE HOME OF THE EXPLORATORIUM AT PIER 15.
- PART OF THE EXPLORATORIUM'S 9-ACRE CAMPUS
- WORLD CLASS VIEWS OF THE BAY
- CREATIVE, HIGH CEILING, COLUMN FREE SPACE
- FANTASTIC NATURAL LIGHT

FOR TERMS OR TO TOUR PLEASE CALL
DAVID POLATNICK or MARIANNE DEAN

415.442.5005

david@propertyx.com

marianne@propertyx.com

18,000 SQUARE FEET AVAILABLE FOR LEASE

Polatnick Properties, in coordination with the Exploratorium, is pleased to offer for lease up to 18,000 square feet of prime space along San Francisco's world famous Embarcadero and adjacent to the Exploratorium Science Museum at Pier 15.

The space allows for a variety of uses including PDR, industrial, robotics, maker space, with ancillary office. The uses are subject to approval by the authorized agencies.

This is an exciting opportunity to lease an historic space and to experience a piece of old San Francisco.

The Exploratorium brings excitement and amenities to the 9-acre campus along the bustling Embarcadero with millions of annual visitors and adjacent to the popular Ferry Building and other waterfront attractions.



Polatnick Properties, INC.

660 Third Street, Suite 150 San Francisco, CA 94107 Tel 415.442.5000



Above: View from between Piers 15 and 17 towards Telegraph Hill and the financial district.



Left and Below: Views of the interior space of Suite 700, Pier 17, highlighting its well lit, column free, spaciousness.





Polatnick Properties, INC.

660 Third Street, Suite 150 San Francisco, CA 94107 Tel 415.442.5000

The information provided above is believed to be reliable but its accuracy has not been verified and it is given with no guarantee or warranty. Offering is subject to errors, omissions, price changes, prior rental, lease, sale or withdrawal without notice. Projections, opinions, assumptions and estimates are for example only and may not accurately reflect property performance. You should conduct a thorough investigation of the property and arrange for all necessary tax, legal and other advisors prior to any purchase or lease.

site plan

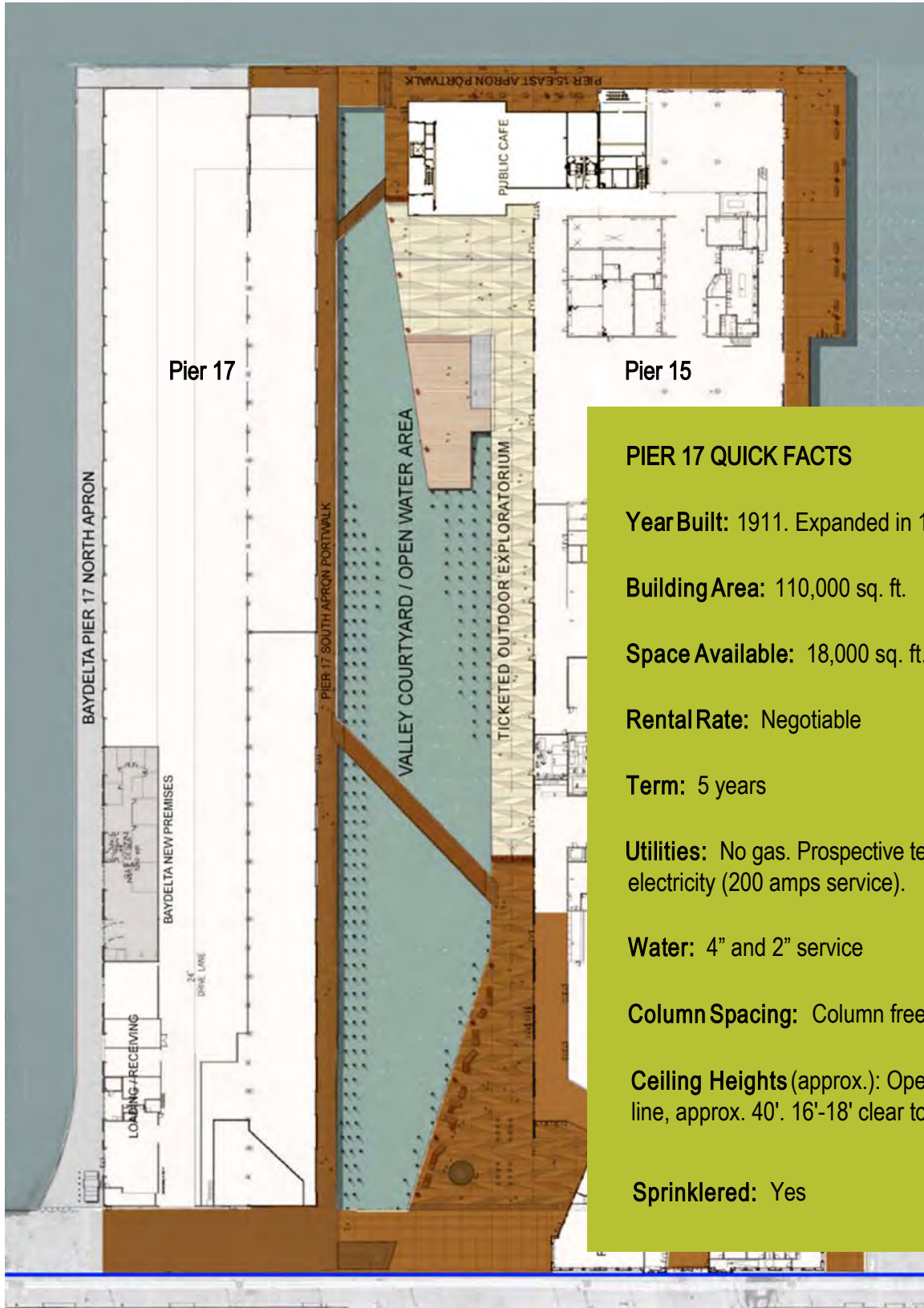

PIER 17 QUICK FACTS

Year Built: 1911. Expanded in 1956. Recently renovated.

Building Area: 110,000 sq. ft.

Space Available: 18,000 sq. ft.

Rental Rate: Negotiable

Term: 5 years

Utilities: No gas. Prospective tenant's pro-rata share of electricity (200 amps service).

Water: 4" and 2" service

Column Spacing: Column free 42' span

Ceiling Heights (approx.): Open trusses to roof line, approx. 40'. 16'-18' clear to trusses.

Sprinklered: Yes

floor plan

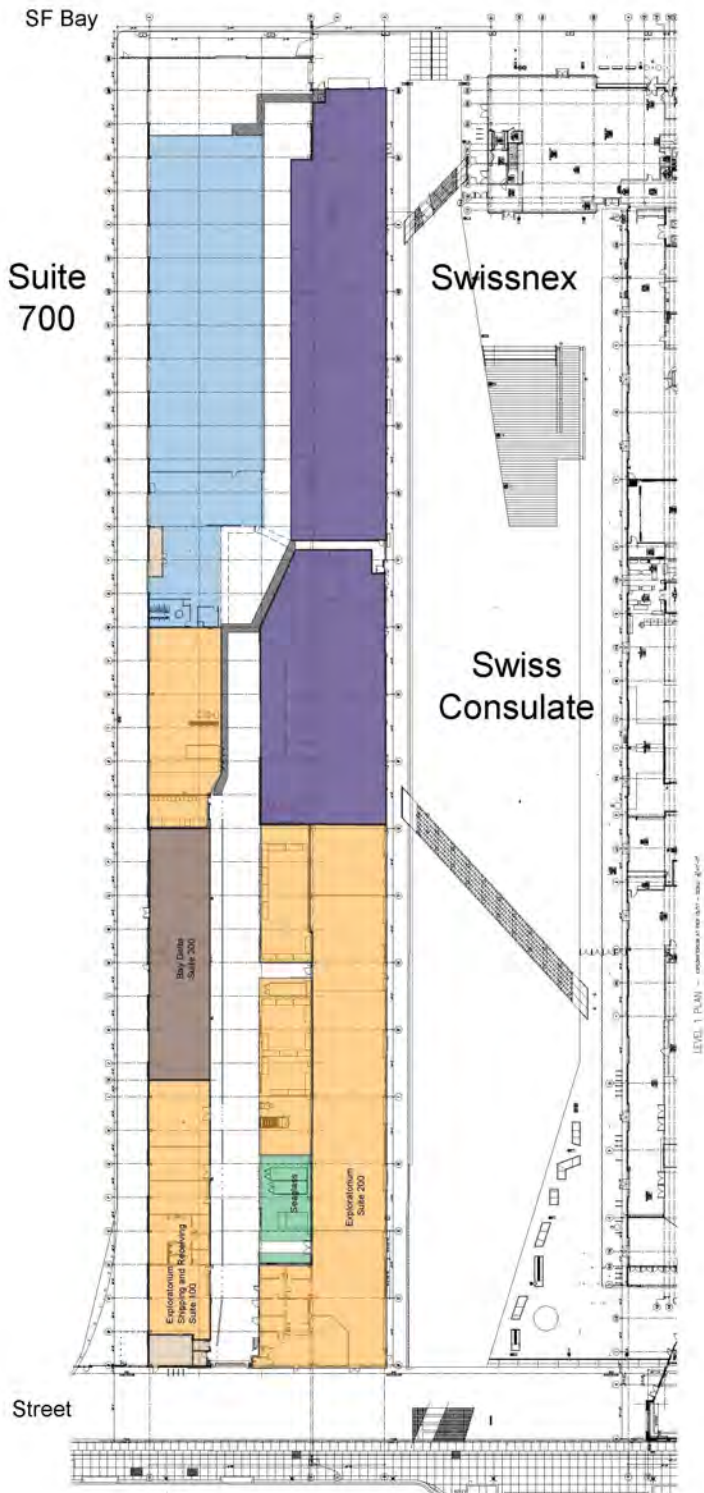

The available space, Suite 700, is the enclosed blue area. Besides the Exploratorium, the most notable neighbors on Pier 17 are the Swiss Consulate and their incubator, Swissnex, indicated in purple.



getting there



- Muni's historic E Embarcadero and F Market & Wharves streetcars stops in front of the Exploratorium at Embarcadero & Green Street.
- Muni bus lines, 2, 6, 14, 21, 31 and metro lines J, K, L, M, T, N stop within walking distance. Bus lines 1, 10, 12, 41 and 38 also stop in the vicinity.
- Embarcadero BART/MUNI stations and ferry terminals at the Ferry Building are a 10 to 15 minute walk away.
- There are several parking lots/garages in the area. For updated information go to www.exploratorium.edu/visit.
- There are ample public bike racks as well as Ford Go-Bike nearby. In addition, Public Bike Work Stations for a quick fix are on the South apron of Pier 15 and in front of Pier 17.