

Midtown Property For Lease

11 N.W. 10th Street
Oklahoma City, Oklahoma 73103

Lease Rate:
\$35.00 PSF NNN



Highlights

+Available Square Feet:

-1,804± to 8,748± RSF

+Parking:

-(28) Total spaces

- (20) Free surface spaces

- (8) Under building, covered

+Private outdoor covered deck provides great views of Downtown Oklahoma City skyline

+Short walk to Midtown restaurants, bars, shopping & museums

+Perfect space for office or showroom

INTERIOR PHOTOS



11 N.W. 10th St

+Available Square Feet:

-1,804± to 8,748± RSF

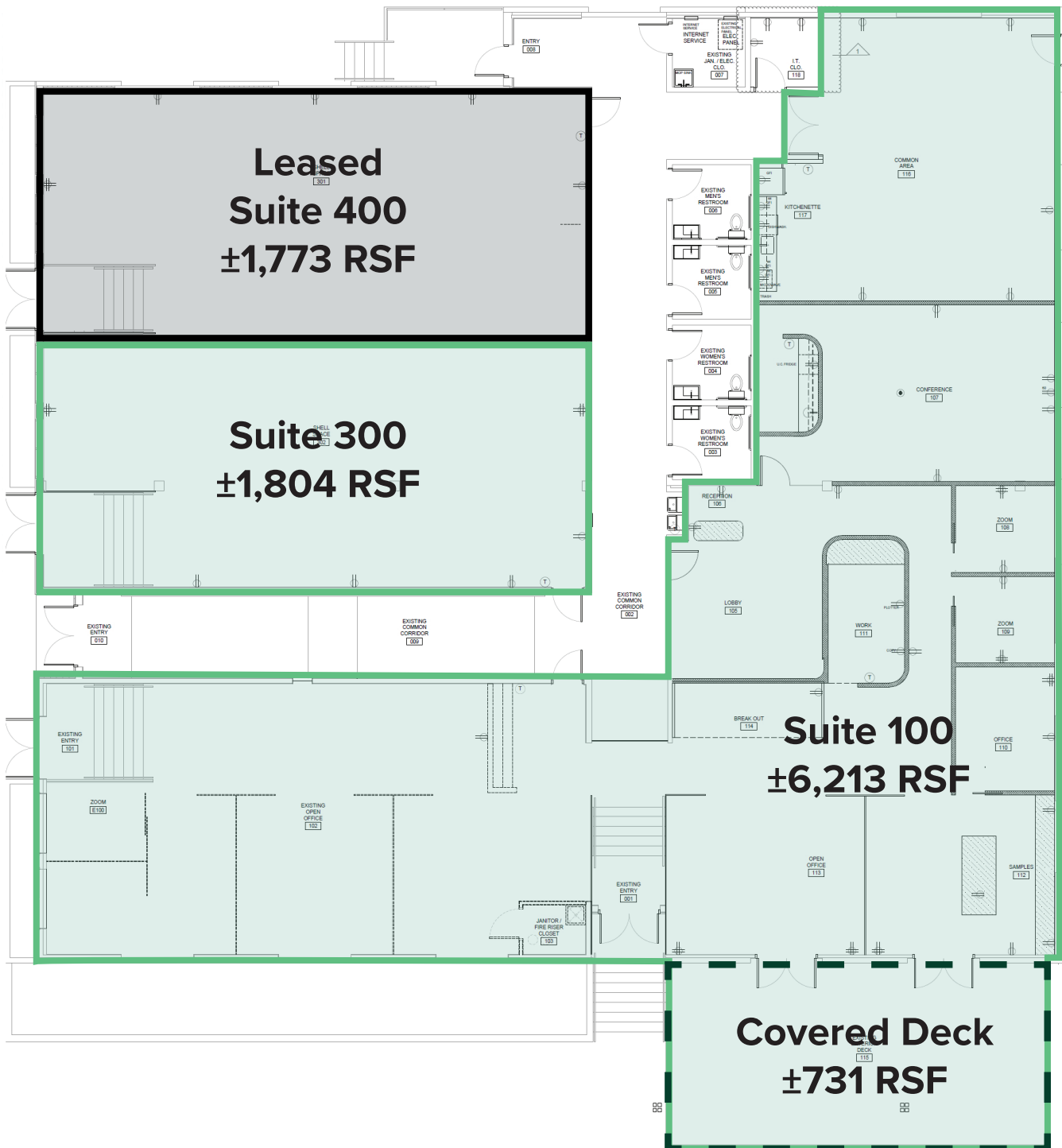

Contact Us



Midtown

Walking distance
to shops and
restaurants



Growth

4.16% Population
growth within 1 mile



Traffic

13,051 VPD @ NW
10th & N Broadway

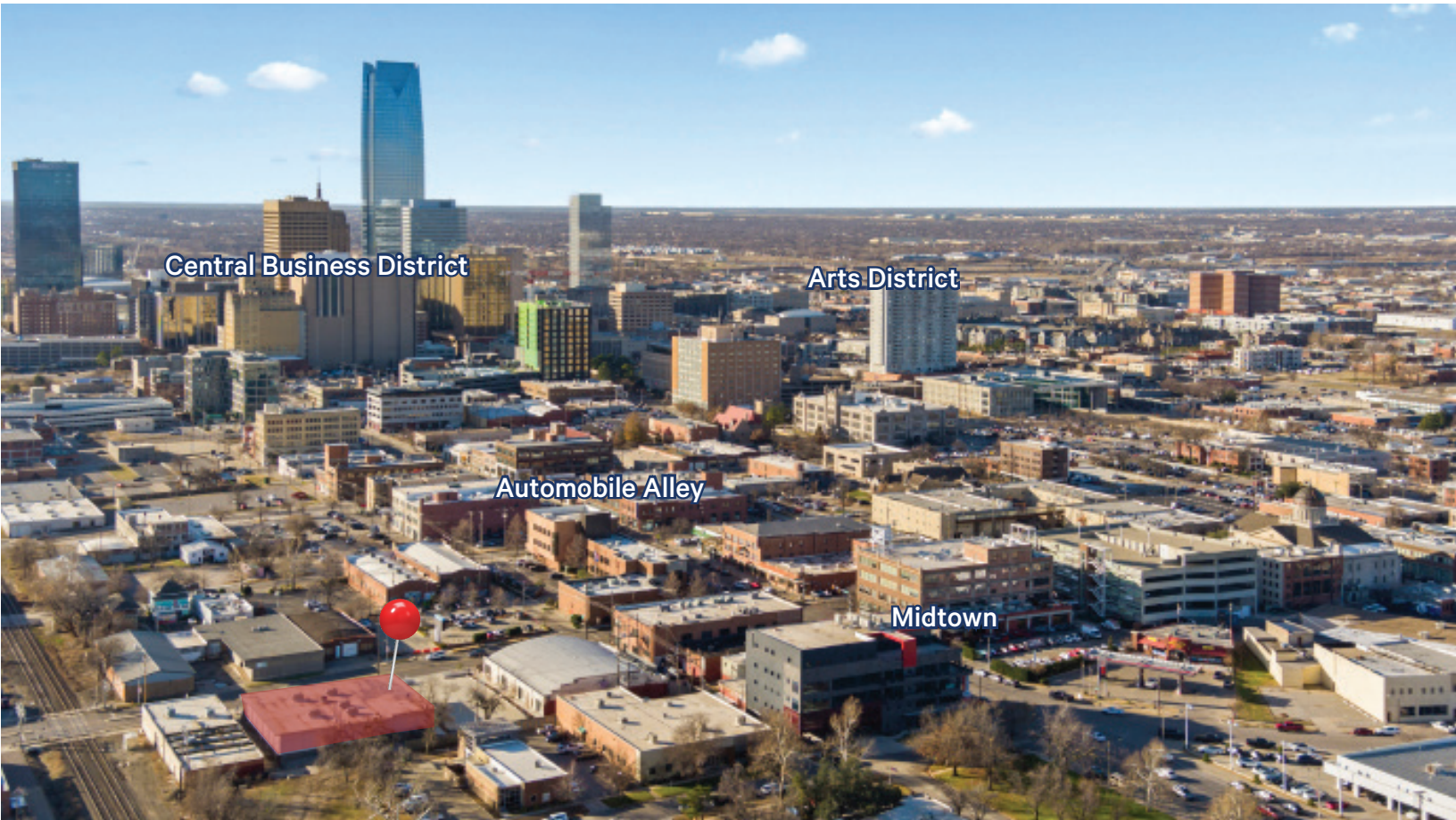

Amy Dunn, CCIM
First Vice President
+1 405 209 3656
amy.dunn@cbre.com

Lease Rate:
\$35.00 PSF NNN

CBRE