

RETAIL SPACE AT SYCAMORE CENTER

FOR LEASE

6020-6060 E. BROWN RD. | MESA, AZ 85205

±2,037

SQUARE FEET

available



PROPERTY DETAILS

- ±19,292 SF Retail Project
- 7.7/1,000 Parking Ratio
- Built 1999 - Sprinklered
- LC Zoning, City of Mesa
- Frontage - Northeast Corner Recker & Brown Rd
- Monument & Building Signage
- Easy Access to Loop 202

The information contained herein has been obtained from various sources. We have no reason to doubt its accuracy; however, J & J Commercial Properties, Inc. has not verified such information and makes no guarantee, warranty or representation about such information. The prospective buyer or lessee should independently verify all dimensions, specifications, floor plans, and all information prior to the lease or purchase of the property. All offerings are subject to prior sale, lease, or withdrawal from the market without prior notice. 06.05.26



COMMERCIAL PROPERTIES INC.

Locally Owned. Globally Connected. CRIFAC

TEMPE: 2323 W University Drive, Tempe, AZ 85281 | 480.966.2301
SCOTTSDALE: 8767 E Via de Commercio, Suite 101, Scottsdale, AZ 85258 | www.cpiaz.com



Brandon Koplin

D 480.214.1103

M 602.373.4717

bkoplin@cpiaz.com

RETAIL SPACE AT SYCAMORE CENTER

FOR LEASE

6020-6060 E. BROWN RD. | MESA, AZ 85205

±2,037

SQUARE FEET

available



AVAILABLE SUITES:

A101 | ±1,128 SF

\$1,880 MO/RENT + \$423 MO / NNN

B106 | ±909 SF

\$1,212 MO/RENT + \$340.87 MO / NNN



contact:



Brandon Koplin

D 480.214.1103

M 602.373.4717

bkoplin@cpiaz.com

RETAIL SPACE AT SYCAMORE CENTER

6020-6060 E. BROWN RD. | MESA, AZ 85205

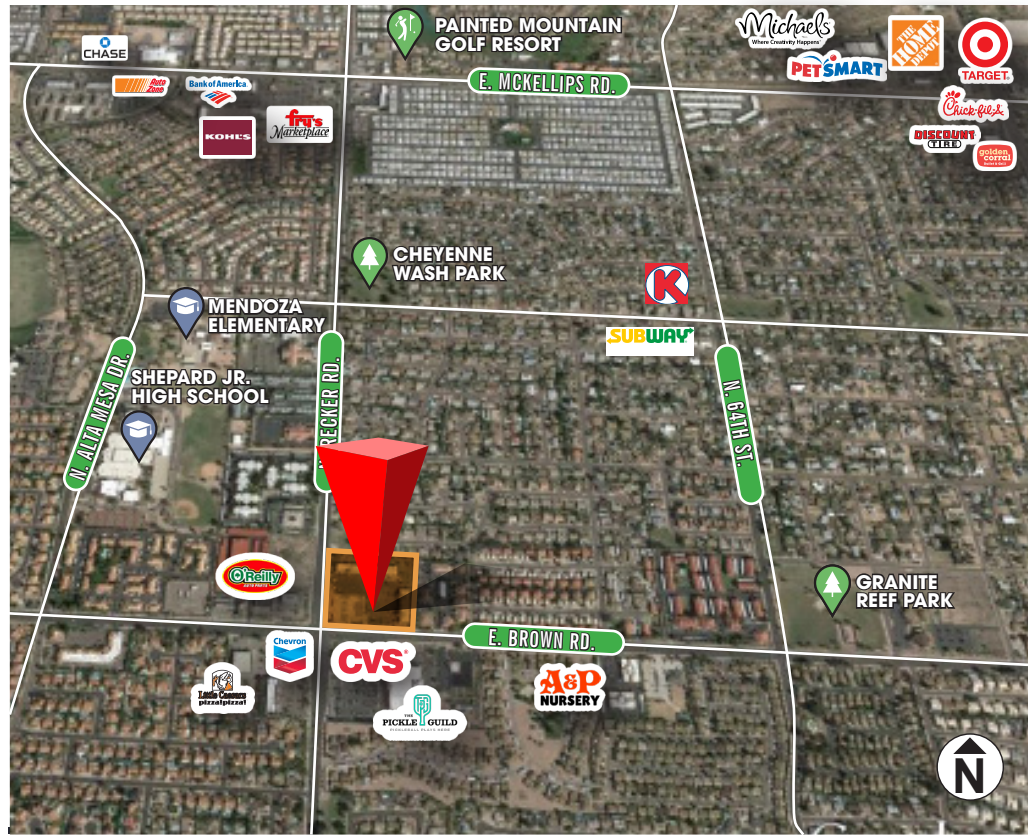
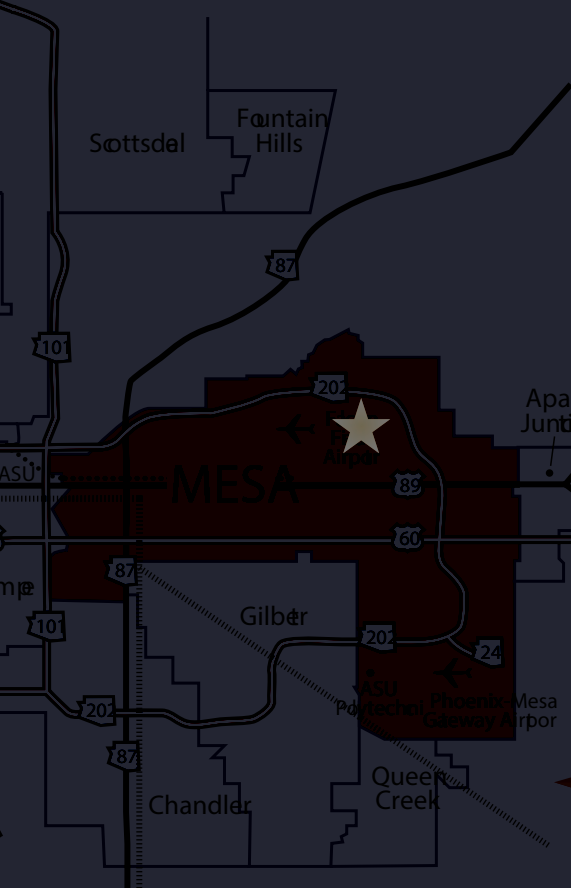

DEMOGRAPHICS 1 MILE 3 MILE 5 MILE

	1 MILE	3 MILE	5 MILE
2025 Population	15,982	97,772	250,932
Median Age	48.5	51.3	46
Bachelor's Degree or Higher	28%	28%	29%
2025 Households	6,831	42,688	103,471
Renter Occupied HHs	1,629	11,951	29,666
Avg Household Income	\$100,420	\$99,659	\$104,984
Median Household Income	\$77,784	\$74,790	\$80,789
Median Home Value	\$377,591	\$387,136	\$404,280
Median Year Built	1986	1988	1990
Avg Household Size	2.3	2.2	2.4
Total Consumer Spending	\$222.5M	\$1.4B	\$3.5B
Daytime Employees	2,577	34,861	76,684
Businesses	386	3,992	10,421

contact:



Brandon Koplin
 D 480.214.1103
 M 602.373.4717
 bkoplin@cpi.az.com