

20,180± for Lease Gateway Business Park



3390 V Street NE

Washington, District of Columbia 20018-1527

Property Highlights

- 3390 V STREET: 20,180± SF available
- Includes 1,859± SF office
- Two loading docks
- Available September 1, 2024
- 18' clear ceilings

Location Overview

- Quick access to Route 50 (New York Avenue), the Baltimore-Washington Parkway, and the Capital Beltway (I-495/I-95)
- Convenient to serve downtown Washington DC and Maryland



Lance Schwarz

O: 301 918 2938
lschwarz@naimichael.com

Peter Burleigh

O: 301 918 2913
pburleigh@naimichael.com

Brady Thompson

O: 301 918 2912
bthompson@naimichael.com

20,180± SF for Lease
Gateway Business Park



20,180± SF for Lease
Gateway Business Park

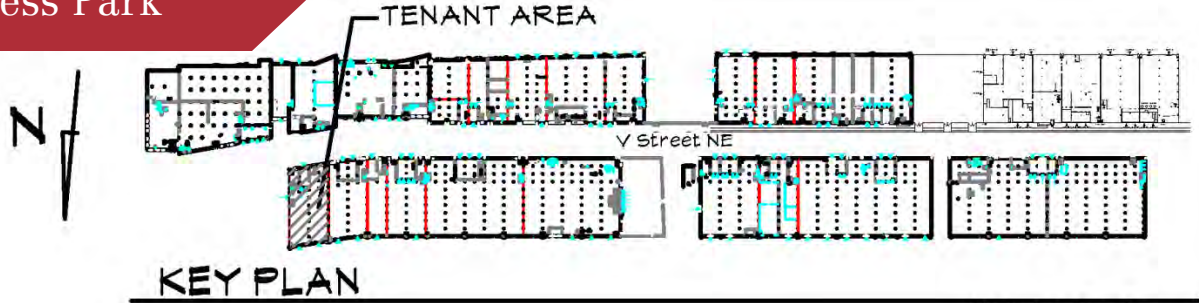

Not to Scale

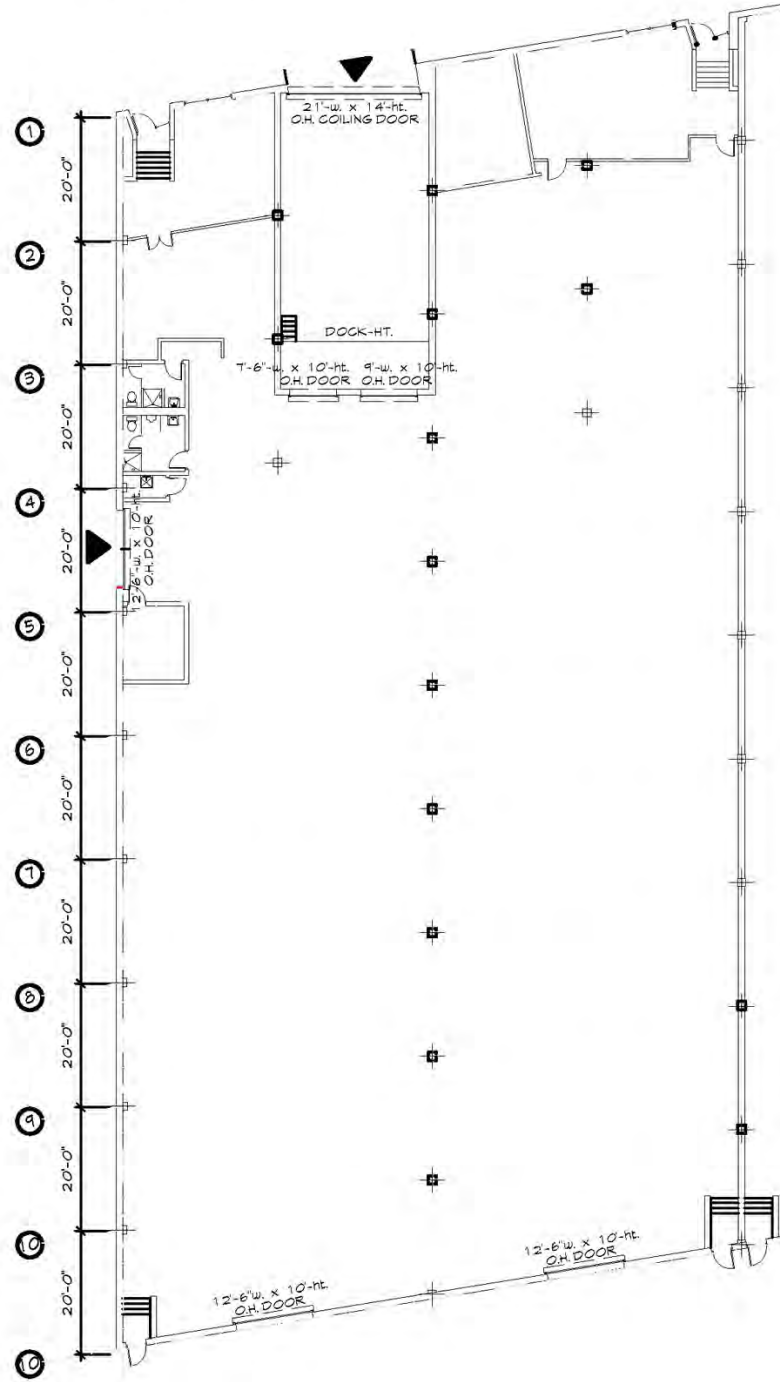

Scale : 1/32" = 1'-0"

APRIL 3, 2024

20,180± SF for Lease
Gateway Business Park

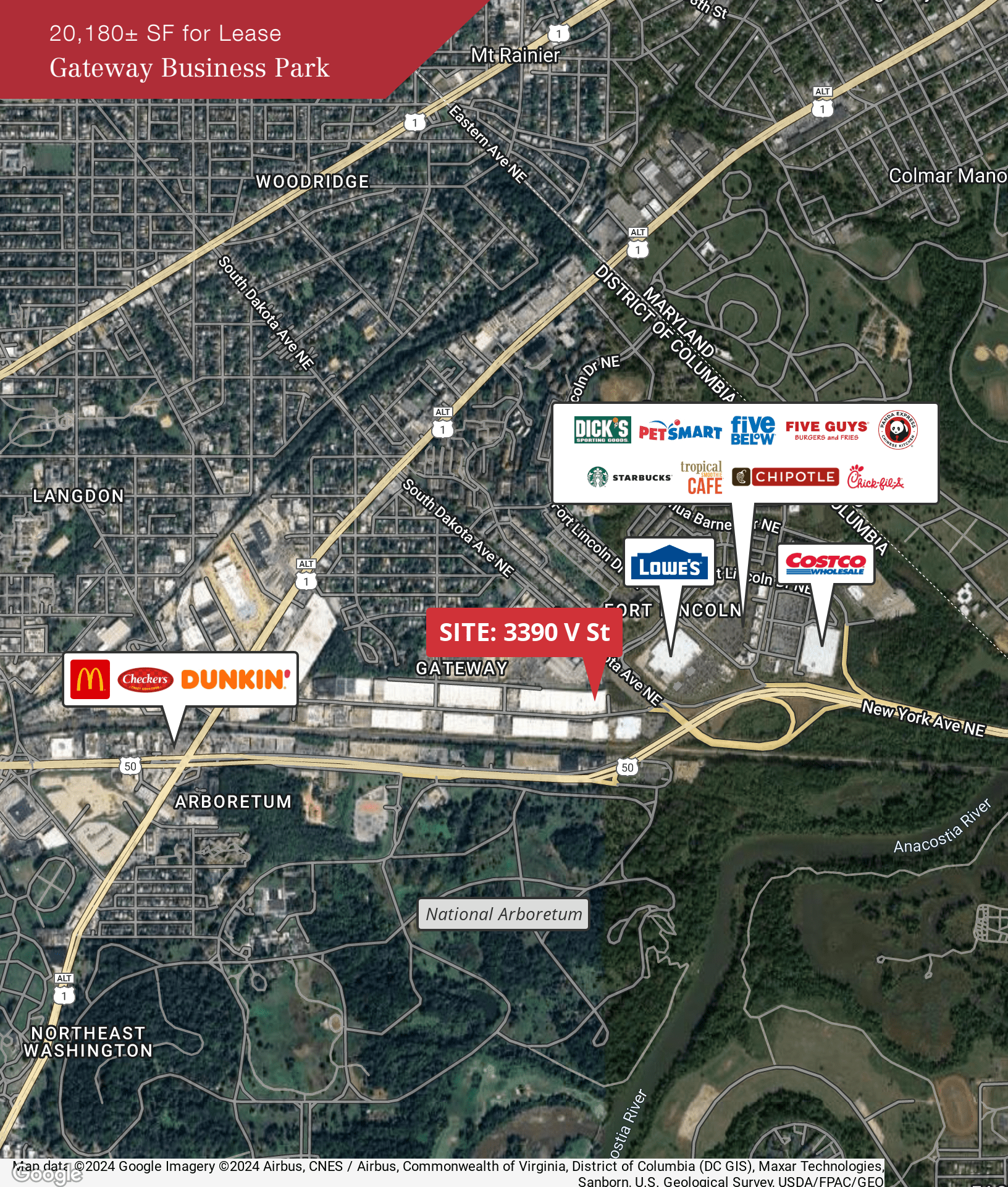

SITE: 3390 V St

McDonald's
Checkers
DUNKIN'

DICK'S SPORTING GOODS **PETSMART** **five BELOW** **FIVE GUYS BURGERS and FRIES** **PANDA EXPRESS**
STARBUCKS **tropical smoothie CAFE** **CHIPOTLE** **Chick-fil-A**

LOWE'S

COSTCO WHOLESALE

Map data ©2024 Google Imagery ©2024 Airbus, CNES / Airbus, Commonwealth of Virginia, District of Columbia (DC GIS), Maxar Technologies, Sanborn, U.S. Geological Survey, USDA/FPAC/Geo