

Industrial | For Sublease

Townsend Way Distribution Center - Building C



For Sublease

22875 NE Townsend Way | Fairview, OR, 97024

PROPERTY OVERVIEW

- + ± 47,395 SF
- + ± 1,694 SF of Office
- + 10 Dock Doors
- + 1 Grade Door
- + Clear Height: ± 26'
- + Sublease through May 31, 2028
- + Available: April 1, 2025

CALL FOR RATES

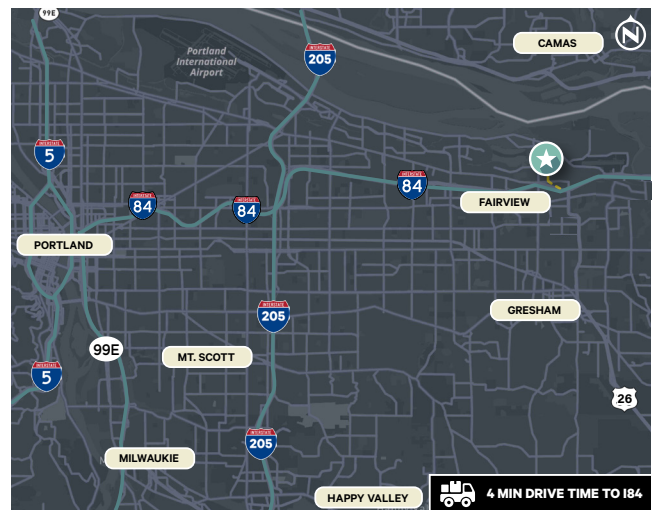

Floor Plan

22875 NE Townsend Way
Fairview, OR, 97024

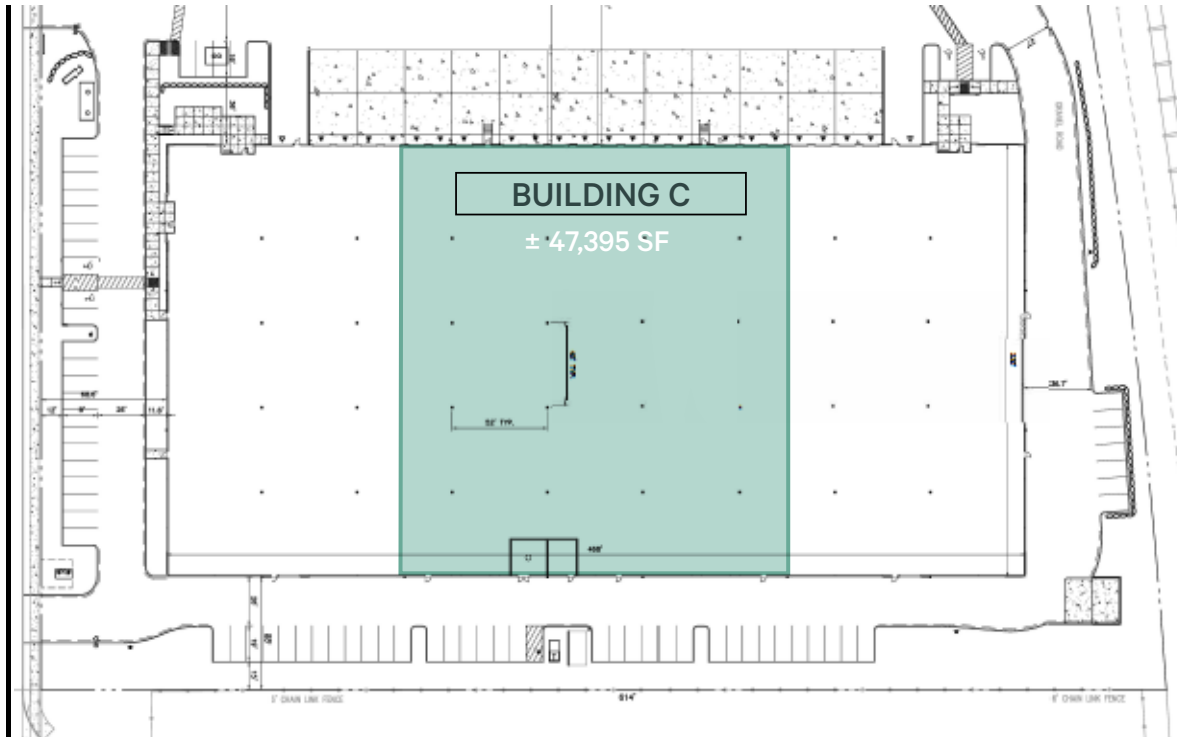

STUART SKAUG, SIOR
Executive Vice President
+1 503 221 4822
stuart.skaug@cbre.com
Licensed in OR & WA

CARA NOLAN, SIOR
Senior Vice President
+1 503 221 4840
cara.nolan@cbre.com
Licensed in OR & WA

LAYLA EVANS
Transaction Specialist
+1 503 221 4851
layla.evans@cbre.com
Licensed in OR & WA

© 2024 CBRE, Inc. All rights reserved. This information has been obtained from sources believed reliable, but has not been verified for accuracy or completeness. You should conduct a careful, independent investigation of the property and verify all information. Any reliance on this information is solely at your own risk. CBRE and the CBRE logo are service marks of CBRE, Inc. All other marks displayed on this document are the property of their respective owners, and the use of such logos does not imply any affiliation with or endorsement of CBRE. Photos herein are the property of their respective owners. Use of these images without the express written consent of the owner is prohibited.