



# 220 • UNIT B217 MIRACLE MILE

2ND FLOOR OFFICE SPACE

CORAL GABLES, FLORIDA 33134

# 220 MIRACLE MILE: B217

## // PROPERTY OVERVIEW



SPACE B217



SPACE B217



### PRIME LOCATION

697 SF, 2nd floor office space overlooking Miracle Mile, now available on the best corner in Coral Gables.

Miracle Mile & Ponce De Leon Blvd



### PEDESTRIAN FRIENDLY

Home to Miami's finest retail boutiques and acclaimed restaurants, Miracle Mile has a walkability score of 98.

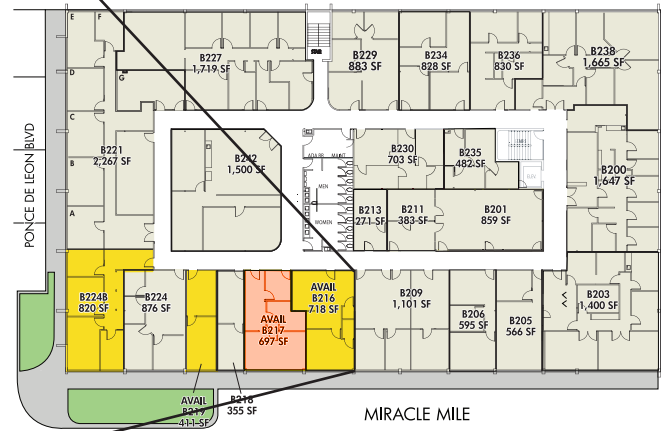
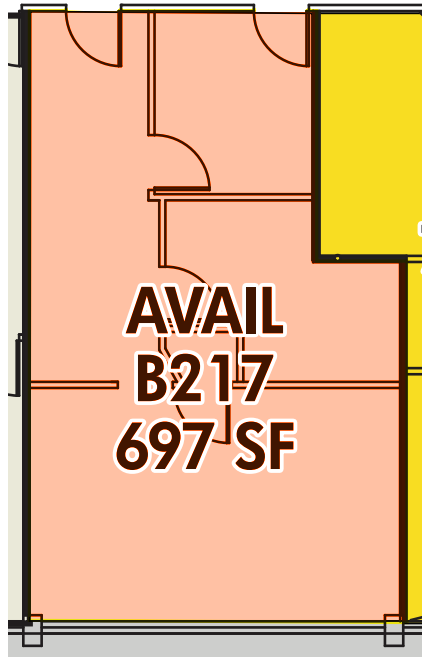

### CULTURAL HUB

Steps away from renowned arts, cultural, & educational institutions: Miracle Theater, Coral Gables Museum, & Coral Gables Cinema



### NEIGHBORS

Surrounded by 120 trendy restaurants and 115 top retailers including Hillstone, Morton's, Kettal, Forte, & Pronovias.



### PARKING-A-PLenty

The area boasts more than 2,400 parking spaces & 6 valet stations right on Miracle Mile.



For retail leasing information, please contact:

MINDY MCILROY • [mmcilroy@terranozacorp.com](mailto:mmcilroy@terranozacorp.com) • 305.970.6344

LAUREN ROBBINS • [lrobbins@terranozacorp.com](mailto:lrobbins@terranozacorp.com) • 757.581.2766

# 220 MIRACLE MILE: B217 // AREA MAP

■ = LOCATION



For retail leasing information, please contact:

MINDY MCILROY • [mmcilroy@terranovacorp.com](mailto:mmcilroy@terranovacorp.com) • 305.970.6344

LAUREN ROBBINS • [lrobbins@terranovacorp.com](mailto:lrobbins@terranovacorp.com) • 757.581.2766





## // SURROUNDING AREA

Known as the City Beautiful, Coral Gables flourishes as the garden city its founders envisioned. Lush, canopy trees line the avenues and Mediterranean architecture decorates the buildings. Coral Gables boasts a unique blend of residential allure, international influence, and a thriving business environment. It is home to a mix of commercial spaces, from modern office buildings to unique boutiques and a cosmopolitan restaurant scene. The city is very desirable to businesses as it is unaffected by seasonal shifts unlike other parts of Florida. It is also close in proximity to Miami International Airport and the Port of Miami to facilitate efficient logistics for business and personal travels.

### DOWNTOWN CORAL GABLES

**150**  
Multi-National  
Companies // **100K**  
Total Daytime  
Population

**172**  
Businesses // **11.5M**  
SF of  
Office Space

**1.7%**  
Vacancy Rate // **21**  
Consulates

### CORAL GABLES SALES

**\$1.5B**  
Total  
Retail Sales

**\$363M**  
Total  
Hospitality Sales // **\$31,502**  
Total Retail Sales  
per Capita

### CORAL GABLES POPULATION

**50K**  
Residents // **39**  
Median Age

**\$977K**  
Median  
Home Price // **\$114K**  
Median  
HH Income

### VISITORS TO CORAL GABLES

**19%**  
Florida Resident  
Visitors // **3M**  
Tourist Annually

**11%**  
FL Resident  
Overnight Visitors // **9%**  
International  
Overnight Visitors



For retail leasing information, please contact:

MINDY MCILROY • [mmcilroy@terranozacorp.com](mailto:mmcilroy@terranozacorp.com) • 305.970.6344

LAUREN ROBBINS • [lrobbins@terranozacorp.com](mailto:lrobbins@terranozacorp.com) • 757.581.2766

# CORAL GABLES

## //EVENTS & CELEBRATIONS



TRICK OR TREAT ON THE MILE  
October



GIRALDA UNDER THE STARS  
Nov thru April



CHRISTMAS TREE LIGHTING  
December

### NOTABLE EVENTS

#### ANNUALLY

Carnaval on the Mile  
Coral Gables Festival of the Arts  
NightGarden - Fairchild Botanical Gardens  
Miami Rum Renaissance Festival  
Coral Gables Food, Wine, and Spirits Festival  
Trick or Treat on the Mile  
The 4th at the Biltmore  
Taste the Gables  
Fiesta at the Park  
Annual Christmas Tree Lighting

#### MONTHLY

Giralda Live  
Gables Gallery Night  
Gables Bike Tours

#### OTHER EVENTS

Book Signings & Readings at Books and Books  
Artistic and cultural activations



CARNAVAL ON THE MILE  
March



4TH AT THE BILTMORE  
July



FESTIVAL OF THE ARTS  
January



NIGHTGARDEN @ FAIRCHILD  
November



For retail leasing information, please contact:

MINDY MCILROY • [mmcilroy@terranovacorp.com](mailto:mmcilroy@terranovacorp.com) • 305.970.6344

LAUREN ROBBINS • [lrobbins@terranovacorp.com](mailto:lrobbins@terranovacorp.com) • 757.581.2766

# MIRACLE MILE

## // LOCATION MAP OVERVIEW



### DRIVE TIMES

#### // 00 to 15 min

University of Miami	// 09 min
Coconut Grove	// 12 min
Little Havana	// 12 min
Vizcaya Museum	// 14 min
South Miami	// 14 min
MIA (Airport)	// 15 min
Brickell	// 15 min

#### // 16 to 29 min

Downtown Miami	// 16 min
Kendall	// 20 min
Design District	// 22 min
Doral	// 22 min
Pinecrest	// 22 min
Port of Miami	// 24 min
Wynwood	// 24 min
Key Biscayne	// 25 min
South Beach	// 27 min

#### // 30+ min

Miami Beach Conv Cntr	// 30 min
Hard Rock Stadium	// 30 min
Miami Lakes	// 30 min
Aventura	// 40 min



For retail leasing information, please contact:

MINDY MCILROY • [mmcilroy@terranovacorp.com](mailto:mmcilroy@terranovacorp.com) • 305.970.6344

LAUREN ROBBINS • [lrobbins@terranovacorp.com](mailto:lrobbins@terranovacorp.com) • 757.581.2766