

# AVE

PHOENIX SKY



601 N. 3RD AVE  
Phoenix, AZ 85003

Retail  
Storefront  
w/Double  
Height  
Windows

Divisible to  
± 3,595 SF

Outdoor  
Patio Space

Institutional  
Owner  
w/National  
Portfolio

**D** **DIVERSIFIED  
PARTNERS**

*Nationwide Real Estate Services*

**LUXURY GROUND FLOOR RETAIL  
FOR LEASE**

7339 E. McDonald Drive  
Scottsdale, AZ 85250  
(O) 480.947.8800  
[www.dpcr.com](http://www.dpcr.com)

# PROPERTY HIGHLIGHTS

- 254 Unit, 17 Floor Luxury Residential High-Rise overlooking Downtown Phoenix
- Highly visible signage potential
- Join The Vig and Cibo, serving over 1,300 resident units along Fillmore Street
- Highly convenient access to I-10 (0.8 miles) in addition to public transportation
- Easy access and walkable distance to Chase Field, Footprint Center and Roosevelt Row
- Great retail space for a restaurant, work lounge or café
- Shared customer parking stalls in structured parking garage
- Additional street parking



7339 E. McDonald Drive  
Scottsdale, AZ 85250  
(O) 480.947.8800  
www.dpcre.com

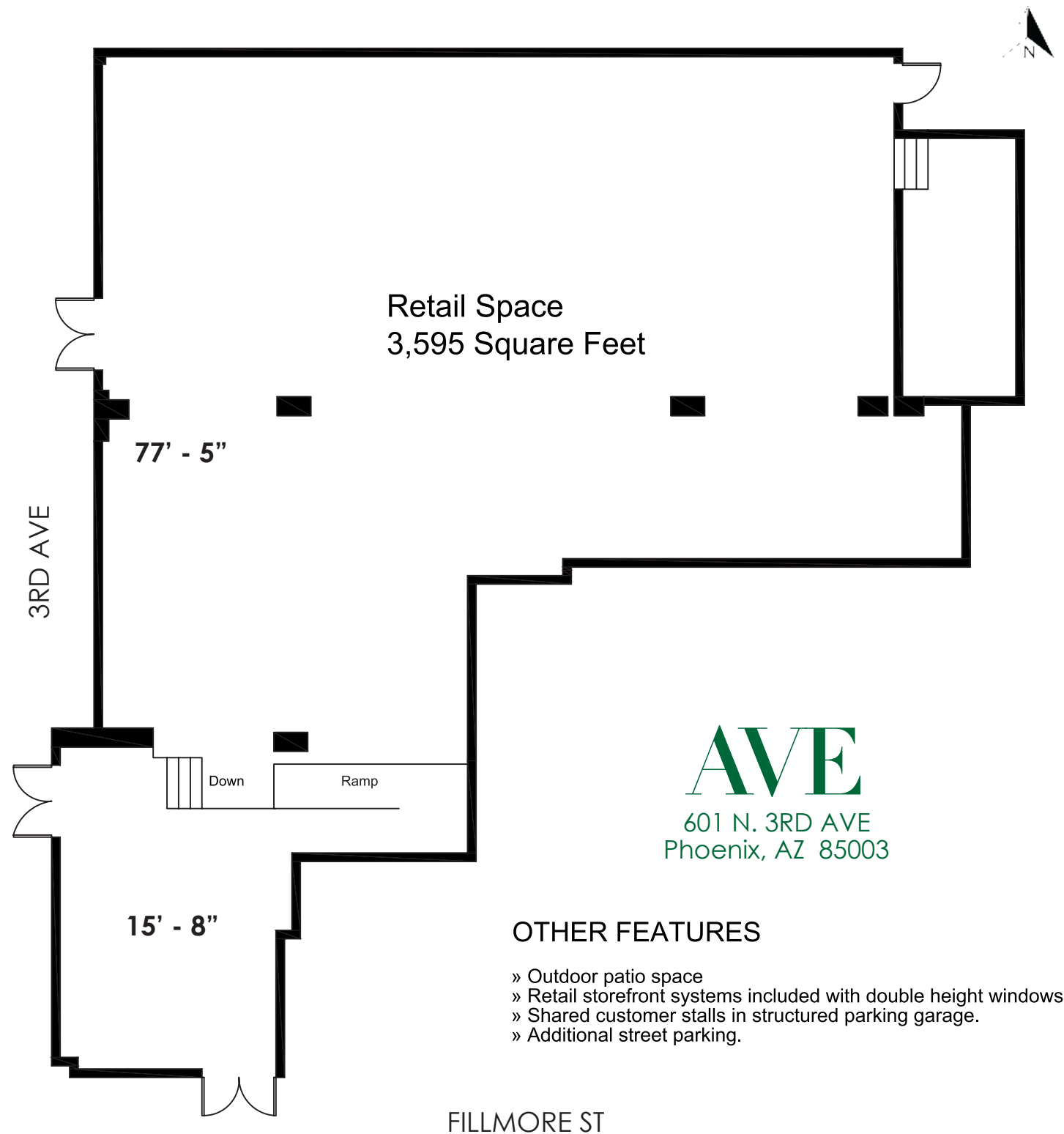

# PHOTOS - Interior & Exterior





Chase Field - 1.3 miles



Footprint Center - 0.9 miles

CityScape - 0.7 miles



Warehouse District - 0.9

Roosevelt Row - 0.6 miles



Notable area attractions (and distances from)

AVE PHOENIX SKY

# demographics 2025



## TOTAL ANNUAL CONSUMER EXPENDITURE

	1 MILE	3 MILE	5 MILE
Total HH Expenditure	\$1.42 B	\$5.04 B	\$14.32 B
Total Non-Retail	\$757.19 M	\$2.61 B	\$7.33 B
Total Retail	\$658.91 M	\$2.43 B	\$6.99 B
Entertainment	\$79.16 M	\$288.66 M	\$830.44 M
Food & Beverages	\$152.95 M	\$583.63 M	\$1.71 B
Personal Care	\$16.68 M	\$64.96 M	\$191.63 M

## TOTAL MONTHLY CONSUMER EXPENDITURE

	1 MILE	3 MILE	5 MILE
Total HH Expenditure	\$7,256	\$7,583	\$7,915
Total Non-Retail	\$3,880	\$3,930	\$4,051
Total Retail	\$3,376	\$3,653	\$3,864
Entertainment	\$406	\$435	\$459
Food & Beverages	\$784	\$879	\$944
Personal Care	\$85	\$98	\$106

## DEMOGRAPHICS 2025

	1 MILE	3 MILE	5 MILE
POPULATION (2025)	29,397	123,184	389,193
PROJECTED POPULATION (2030)	35,818	129,919	393,927
AVG HH INCOME	\$94,758	\$90,959	\$94,215
PROJECTED AVG HH INCOME (2030)	\$90,519	\$88,877	\$92,603
DAYTIME POPULATION	45,592	176,041	385,713
MEDIAN AGE	33.5	33.3	32.2
TOTAL BUSINESSES	2,696	11,337	25,292

# Multi-Family Properties

## EXISTING 8,406 UNITS

- 1 RENEUE  
200 units, built in 2001
- 2 601 PAX  
230 units, built in 2016
- 3 AMBASSADOR WEST  
102 units, built in 1979
- 4 AVA TERRA  
348 units, built in 2022
- 5 LOFTS AT MCKINLEY  
60 units, built in 2012
- 6 PHOENIX SILVERCREST  
125 units, built in 1980
- 7 URBAN LIVING ON RILLMORE  
63 units, built in 2019
- 8 UL2  
70 units, built in 2014
- 9 THE MCKINLEY  
108 units, built in 2020
- 10 UNION @ ROOSEVELT  
80 units, built in 2017
- 11 ROOSEVELT SQUARE  
403 units, built in 2001
- 12 THE STEWART  
312 units, built in 2019
- 13 WESTWARD HO  
290 units, built in 2004
- 14 THE DERBY  
222 units, built in 2022
- 15 THE MET  
140 units, built in 1997
- 16 SKYLINE LOFTS  
332 units, built in 2009
- 17 ALTURA  
257 units, built in 2019
- 18 JOY ON 4TH  
234 units, built in 2021
- 19 PROXY 333  
118 units, built in 2016
- 20 LINEAR  
104 units, built in 2016
- 21 ROOSEVELT POINT  
326 units, built in 2013
- 22 ILLUMINATE  
111 units, built in 2016
- 23 ROOSEVELT ROW  
316 units, built in 2018
- 24 BROADSTONE PORTLAND  
162 units, built in 2021
- 25 CAMDEN COPPER SQUARE  
332 units, built in 1999
- 26 VB ON 12TH  
235 units, built in 2022
- 27 MCARTY ON MONROE  
69 units, built in 2009
- 28 WASHINGTON MANOR  
112 units, built in 1977
- 29 MASON OLIVER  
140 units, built in 2016
- 30 THE PATTERY PHX  
478 units, built in 2022
- 31 ADELINE  
379 units, built in 2022
- 32 THE RYAN  
332 units, built in 2020
- 33 CITYSCAPE RESIDENCES  
224 units, built in 2014
- 34 THE DERBY  
222 units, built in 2022
- 35 KENECT  
380 units, built in 2021
- 36 X PHOENIX  
318 units, built in 2022
- 37 THE ABBEY  
94 units, built in 1995
- 38 209 WEST JACKSON  
297 units, built in 2003

## UNDER CONSTRUCTION 3,161 UNITS

- 1 AVE PHOENIX SKY  
254 units, delivery 2023
- 2 ROSIE  
370 units, delivery 2025
- 3 SAIYA  
389 units, delivery 2024
- 4 ECO PHX  
70 units, delivery 2023
- 5 MOON TOWER  
326 units, delivery 2023
- 6 SKYE ON 6TH  
309 units, delivery 2023
- 7 PALM TOWER  
334 units, delivery 2024
- 8 PHOENIX CENTRAL STATION  
362 units, delivery 2024
- 9 SOL MODERN  
747 units, delivery 2025

## PLANNED 988 UNITS

- 1 HENRI | 313 units, delivery 2025
- 2 HAVEN | 407 units, delivery N/A
- 3 THE RAGSDALE | 268 units, delivery 2024

## PROPOSED 1,077 UNITS

- 1 1ST & MCKINLEY | 714 units
- 2 BROADSTONE VAN BUREN | 336 units

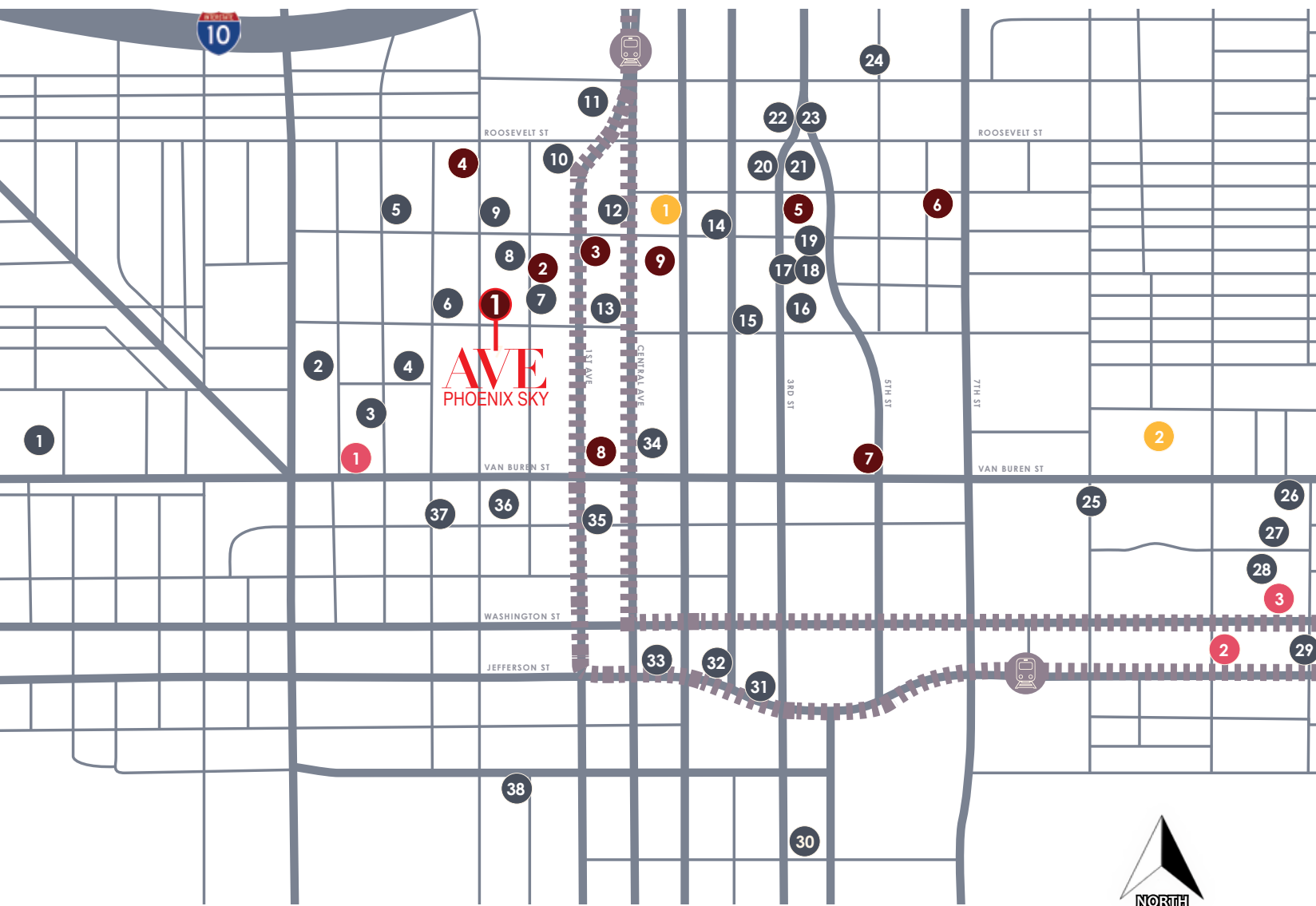

# multi-family overview

complexes with 50+ units



**Downtown Phoenix Partnership**  
DTPHX.ORG

**Downtown Information Center**

**Arts & Culture**

- 1 AMC Theatres
- 2 Arizona Latino Arts & Cultural Center (ALAC)
- 3 Arizona Federal Theatre
- 4 Herberger Theater Center
- 5 Orpheum Theatre
- 6 St. Mary's Basilica
- 7 Symphony Hall
- 8 Valley Youth Theatre

**Convention Center**

- 9 Phoenix Convention Center North
- 10 Phoenix Convention Center South
- 11 Phoenix Convention Center West

**Education**

- 12 ASU Downtown
- 13 Phoenix Biomedical Campus

**Government**

- 14 Phoenix City Council Chambers
- 15 Phoenix City Hall / The Gallery @ City Hall
- 16 Phoenix Municipal Court
- 17 Sandra Day O'Conner Federal Courthouse
- 18 Superior Court Complex
- 19 US Bankruptcy Court

**Hotels**

- 20 AC Hotel Phoenix Downtown
- 21 Hampton Inn & Suites Phoenix Downtown
- 22 Hilton Garden Inn Phoenix Downtown
- 23 Home2 Suites By Hilton
- 24 Hotel Palomar Phoenix
- 25 Hotel San Carlos
- 26 Hyatt Place
- 27 Hyatt Regency Phoenix
- 28 Marriott Residence Inn & Courtyard
- 29 Sheraton Phoenix Downtown
- 30 Renaissance Phoenix Downtown
- 31 Westin Phoenix Downtown

**Museums**

- 32 Arizona Science Center
- 33 Children's Museum of Phoenix
- 34 Maricopa County Justice / Phoenix Police Rosson House
- 35

**Parks**

- 36 Civic Space Park
- 37 Heritage & Science Park
- 38 Patriot's Park
- 39 Paw-Pup Dog Park
- 40 Space Between, The

**Shopping**

- 41 Arizona Center
- 42 CityScape Phoenix
- 43 Collier Center
- 44 Downtown Phoenix Farmers Market
- 45 Fry's Food Store



For dining recommendations, information on how to get around or general questions about Downtown Phoenix, call the Ambassador at 602-495-1500 or visit [dtphx.org](http://dtphx.org)

# EXCLUSIVELY LISTED BY:



**EMMA BARRECA**  
Cell: 610.469.4000  
emma@dpcr.com



**MARTI WEINSTEIN**  
Cell: 224.612.2332  
marti@dpcr.com



7339 E. McDonald Drive  
Scottsdale, AZ 85250  
(O) 480.947.8800 | (F) 480.947.8830  
www.dpcr.com

The information contained herein has been obtained from sources believed reliable. While we do not doubt its accuracy, we have not verified it and make no guarantee, warranty or representation about it. It is your responsibility to independently confirm its accuracy and completeness. Any projections, opinions, assumptions or estimates used for example only, and do not represent the current or future performance of the property. The value of this transaction to you depends on tax and other factors which should be evaluated by your tax, financial & legal advisors. You and your advisors should conduct a careful, independent investigation of the property to determine, to your satisfaction, the suitability of the property for your needs.