

COTTAGE CITY.

NEAR
RHODE ISLAND AVENUE EXTENDED & D. C. LINE
Prince Georges County, Maryland.

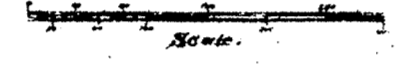

The Clerk of the Circuit Court for Prince Georges County, Maryland, will file this plat among the land records of Prince Georges County, Maryland, and record the same as one of such records.

James Leary
J. Hamilton
Richard N. Byron

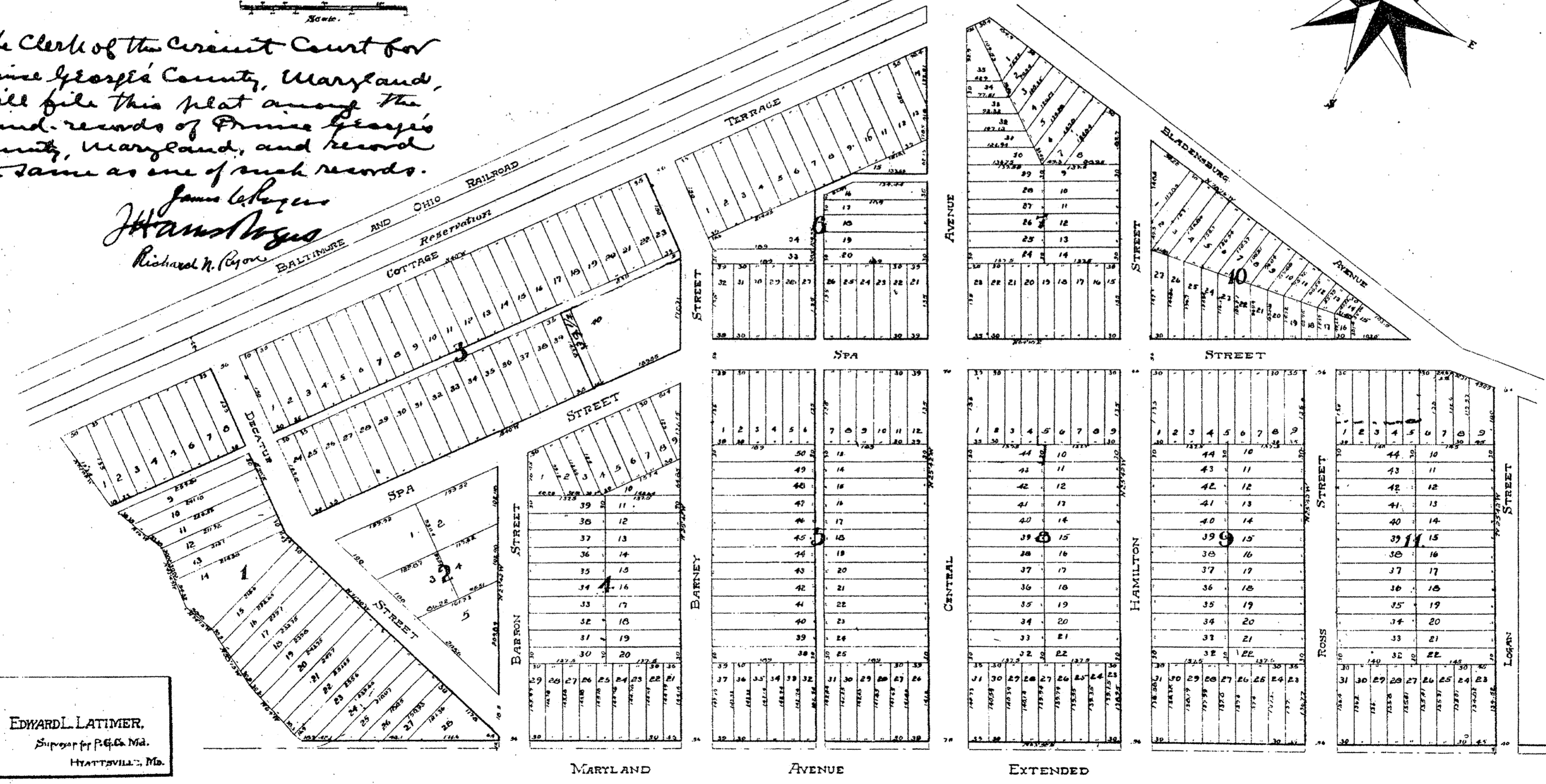
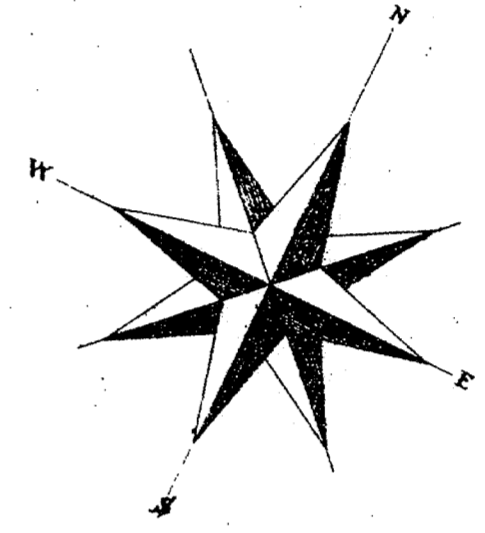

EDWARD L. LATIMER,
Surveyor for P.G. Co. Md.
HYATTSVILLE, Md.

P. 300453

PRINCE GEORGES COUNTY CIRCUIT COURT (Plat Book) Plat Book BDS 17, p. 14, MSA 2581-886. Date available: Printed 06/13/2024.

01-1

1-10

MSA CSU 2581-886

1-10