

**CHRISTIE DEVELOPMENT  
ASSOCIATES, LLC**



REAL ESTATE DEVELOPMENT  
INVESTMENTS / BROKERAGE

# Sherwood Crossings

**2727 SW Wanamaker Rd, Topeka, KS 66614**

**12.7 Acres ~ 73,048 sq. ft. leasable ~ 445 parking spaces**

For Information:

**David Christie**

913.522.6333

djc@christiedev.com

**Sean Walsh**

913.957.2089

sean@christiedev.com

Christie Development  
Associates, LLC  
Real Estate Development  
Investments/Brokerage  
7217 W. 110th Street Overland  
Park, KS 66210  
O: 913.649.4500  
F: 913.649-4566



"This information has been secured from sources we believe to be reliable, but we make no representation or warranties, expressed or implied, as to the accuracy of the information. References to square footage or age are approximate. Buyer/Tenant must verify the information and bears all risk for any inaccuracies."

CHRISTIE DEVELOPMENT  
ASSOCIATES, LLC

# Sherwood Crossings

2727 SW Wanamaker Rd, Topeka, KS 66614



REAL ESTATE DEVELOPMENT  
INVESTMENTS / BROKERAGE



- **12.7 Acres**
- **73,048 SF leasable**
- **445 parking spaces**
- **7 Brew coming soon**
- **Join several national retailers**

**CHRISTIE DEVELOPMENT ASSOCIATES, LLC**



**REAL ESTATE DEVELOPMENT INVESTMENTS / BROKERAGE**

**2.5 ACRES AVAILABLE**

Apricot Lane BOUTIQUE  
Sola  
CosmoProf  
Dirty Dough

**GLORY DAYS PIZZA**  
**1,658 SF AVAILABLE**  
The Big Biscuit

SHELTER INSURANCE  
SEVEN BROW  
BIG TIRES  
THE TEAM YOU TRUST

Wanamaker Rd

PREMIER BULLDOGS  
JOY WOK

**KANSASLAND**  
TIRE AND SERVICE

Advance Auto Parts

**AVAILABLE 14,425 SF**

UNITED STATES POSTAL SERVICE

TOPEKA CHEER  
THE BEST BAR AT MIKE'S PLACE  
THE HAIR MILL  
CBD American Shaman  
Cell Phone Repair  
SUBWAY

Capitol Federal

DEVIL'S WINE & SPIRITS

29th St



Batteries + Bulbs

Papa Murphy's

ups

**HyVee**  
GAS

Jefferson's

bp

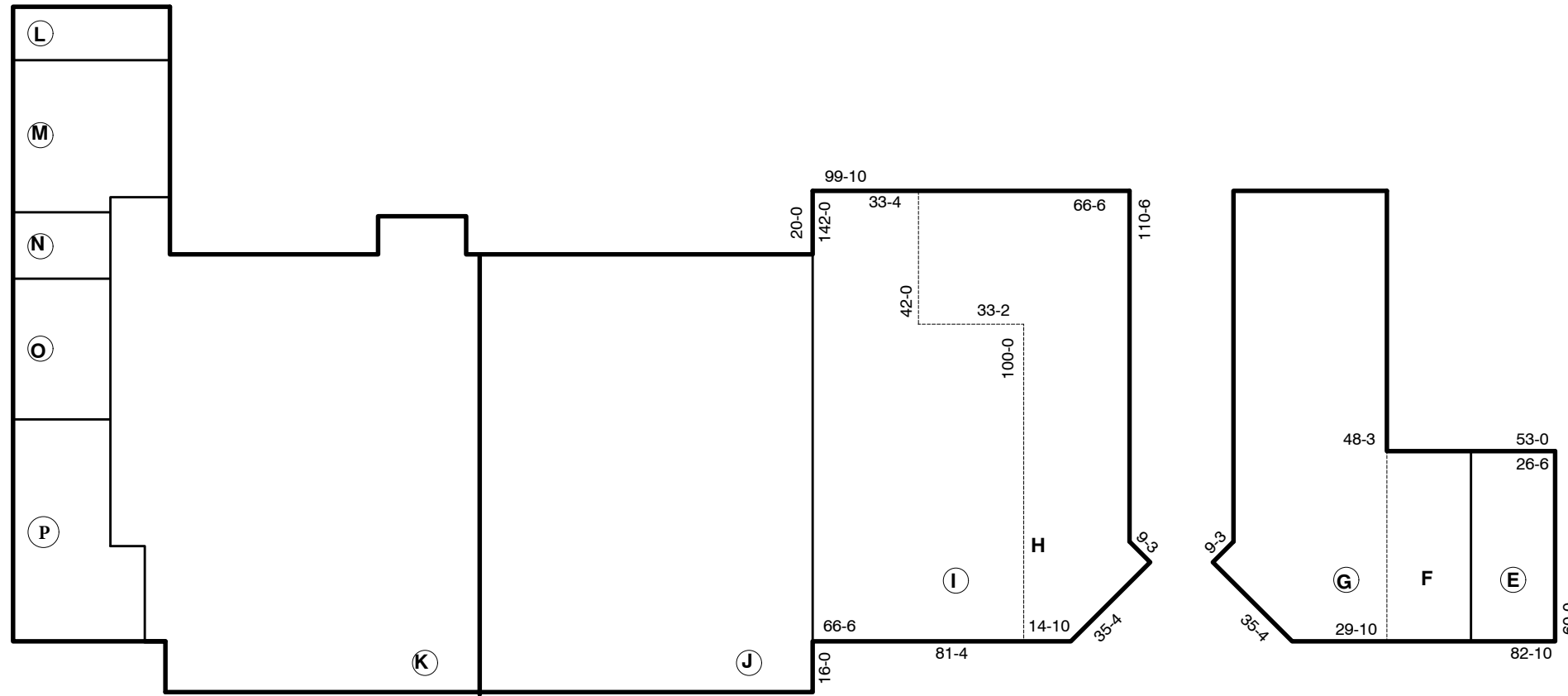

existing  
**Lease Plan**  
 5 June 2026

**Sherwood Crossings Center**  
 SW 29th Street at SW Wanamaker Road  
 Topeka . Kansas

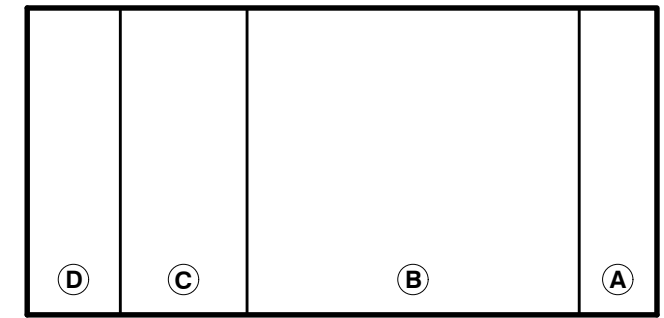

- Ⓛ 827 sf **Topeka Cheer**  
6048 SW 29th Street
- Ⓜ 2,363 sf **The Best Bar at Mike's Place**  
6042 SW 29th Street
- Ⓝ 769 sf **The Hair Mill**  
6036 SW 29th Street
- Ⓞ 1,331 sf **CBD American Shaman**  
6028-6032 SW 29th Street
- Ⓟ 2,475 sf **Subway**  
6020 SW 29th Street

- Ⓜ 15,000 sf **Advance Auto Parts**  
2835 SW Wanamaker Road
- Ⓚ 14,425 sf **AVAILABLE**  
2831 SW Wanamaker Road

- ⓔ 1,573 sf **Glory Days Pizza**  
2811 SW Wanamaker Road
- ⓕ 1,658 sf **AVAILABLE**  
2813 SW Wanamaker Road
- ⓖ 4,500 sf **Big Biscuit**  
2815 SW Wanamaker Road
- ⓗ 6,000 sf **Jeremiah Bullfrogs**  
2827 SW Wanamaker Road
- Ⓢ 8,182 sf **Joy Wok**  
2829 SW Wanamaker Road

- ⓐ 1,700 sf **Apricot Lane**  
2727 SW Wanamaker Road . Suite 100
- ⓑ 7,045 sf **Sola Salons**  
2727 SW Wanamaker Road . Suite 102
- ⓒ 2,640 sf **CosmoProf**  
2727 SW Wanamaker Road . Suite 108
- ⓓ 1,740 sf **Dirty Dough**  
2727 SW Wanamaker Road . Suite 110

**CHRISTIE DEVELOPMENT  
ASSOCIATES, LLC**



**Income**

|                         | <b>1 mile</b> | <b>3 miles</b> | <b>5 miles</b> |
|-------------------------|---------------|----------------|----------------|
| Avg Household Income    | \$96,454      | \$96,168       | \$85,891       |
| Median Household Income | \$73,512      | \$71,757       | \$64,235       |

**Population**

|                             | <b>1 mile</b> | <b>3 miles</b> | <b>5 miles</b> |
|-----------------------------|---------------|----------------|----------------|
| 2020 Population             | 11,183        | 51,903         | 93,386         |
| 2025 Population             | 10,281        | 48,910         | 92,444         |
| 2030 Population Projection  | 10,064        | 48,178         | 92,136         |
| Annual Growth 2020-2025     | -1.6%         | -1.2%          | -0.2%          |
| Annual Growth 2025-2030     | -0.4%         | -0.3%          | -0.1%          |
| Median Age                  | 43.9          | 42.9           | 40.8           |
| Bachelor's Degree or Higher | 46%           | 41%            | 36%            |

**Population By Age**

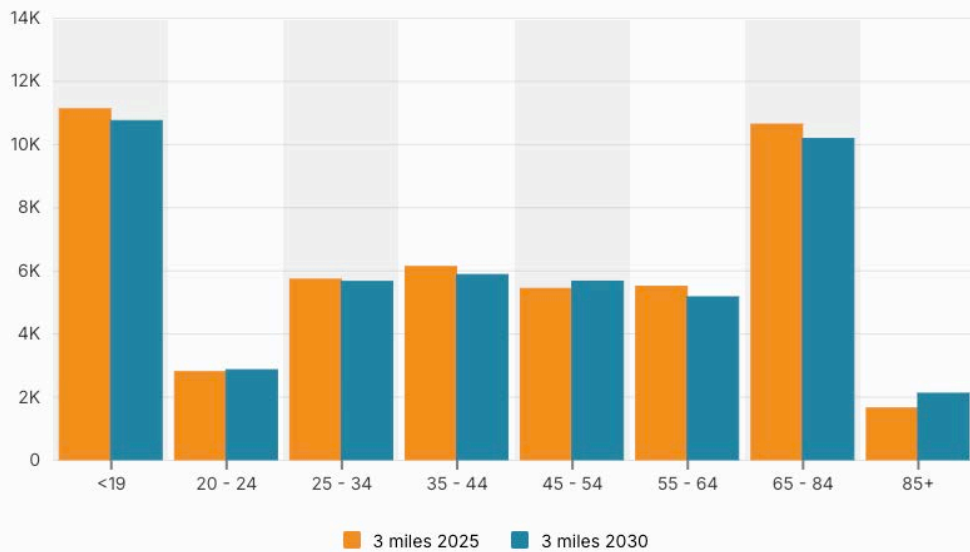

**Households**

|                                   | <b>1 mile</b> | <b>3 miles</b> | <b>5 miles</b> |
|-----------------------------------|---------------|----------------|----------------|
| 2020 Households                   | 4,983         | 23,242         | 40,991         |
| 2025 Households                   | 4,570         | 21,818         | 40,520         |
| 2030 Household Projection         | 4,472         | 21,470         | 40,369         |
| Annual Growth 2020-2025           | -0.8%         | -0.4%          | 0.2%           |
| Annual Growth 2025-2030           | -0.4%         | -0.3%          | -0.1%          |
| Owner Occupied Households         | 2,901         | 13,255         | 22,846         |
| Renter Occupied Households        | 1,571         | 8,215          | 17,523         |
| Avg Household Size                | 2.1           | 2.2            | 2.2            |
| Avg Household Vehicles            | 2             | 2              | 2              |
| Total Specified Consumer Spending | \$134.9M      | \$643.2M       | \$1.1B         |

# Sherwood Crossings

29<sup>th</sup> Street and Wanamaker Road

Topeka, KS



## Income

|                         | 1 mile   | 3 miles  | 5 miles  |
|-------------------------|----------|----------|----------|
| Avg Household Income    | \$96,454 | \$96,168 | \$85,891 |
| Median Household Income | \$73,512 | \$71,757 | \$64,235 |