

HIGH VISIBILITY RETAIL SPACE IN THE DANA POINT LANTERN DISTRICT

AVAILABLE FOR LEASE

34212 Pacific Coast Highway, Unit C, Dana Point



Exclusively Offered By:

RYAN HARMAN
Senior Vice President
License ID #01399616
949.790.3136
rharman@leeirvine.com

KEVIN BAYLESS
Senior Vice President
License ID #01788899
949.790.3142
kbayless@leeirvine.com

JESSE KNIGHT
Senior Associate
License ID# 0205899
949.790.3103
jknight@leeirvine.com

**LEE &
ASSOCIATES**

COMMERCIAL REAL ESTATE SERVICES

COASTAL INVESTMENT GROUP

coastalinvestmentsales.com | 949.727.1200

All information furnished regarding property for sale, rental or financing is from sources deemed reliable, but no warranty or representation is made to the accuracy thereof and same is submitted to errors, omissions, change of price, rental or other conditions prior to sale, lease or financing or withdrawal without notice. No liability of any kind is to be imposed on the broker herein.

PROPERTY FEATURES

Size	±1,039 SF
Asking:	\$4.00/SF + \$1.35/SF NNN
Total Asking:	\$5,558/Month
Buildout:	Large open space with private restroom
Parking:	±43 parking spaces for the property + street parking
Signage:	PCH and Parking Lot Signage Available
Location:	In the revitalized Dana Point Lantern District
Signage:	±20,000 cars per day



Exclusively Offered By:

RYAN HARMAN
Senior Vice President
License ID #01399616
949.790.3136
rharman@leeirvine.com

KEVIN BAYLESS
Senior Vice President
License ID #01788899
949.790.3142
kbayless@leeirvine.com

JESSE KNIGHT
Senior Associate
License ID# 0205899
949.790.3103
jknight@leeirvine.com

LEE & ASSOCIATES
COMMERCIAL REAL ESTATE SERVICES

COASTAL INVESTMENT GROUP

coastalinvestmentsales.com | 949.727.1200



Exclusively Offered By:

RYAN HARMAN
Senior Vice President
License ID #01399616
949.790.3136
rharman@leeirvine.com

KEVIN BAYLESS
Senior Vice President
License ID #01788899
949.790.3142
kbayless@leeirvine.com

JESSE KNIGHT
Senior Associate
License ID# 0205899
949.790.3103
jknight@leeirvine.com

LEE & ASSOCIATES

COMMERCIAL REAL ESTATE SERVICES

COASTAL INVESTMENT GROUP

coastalinvestmentsales.com | 949.727.1200

SITE PLAN

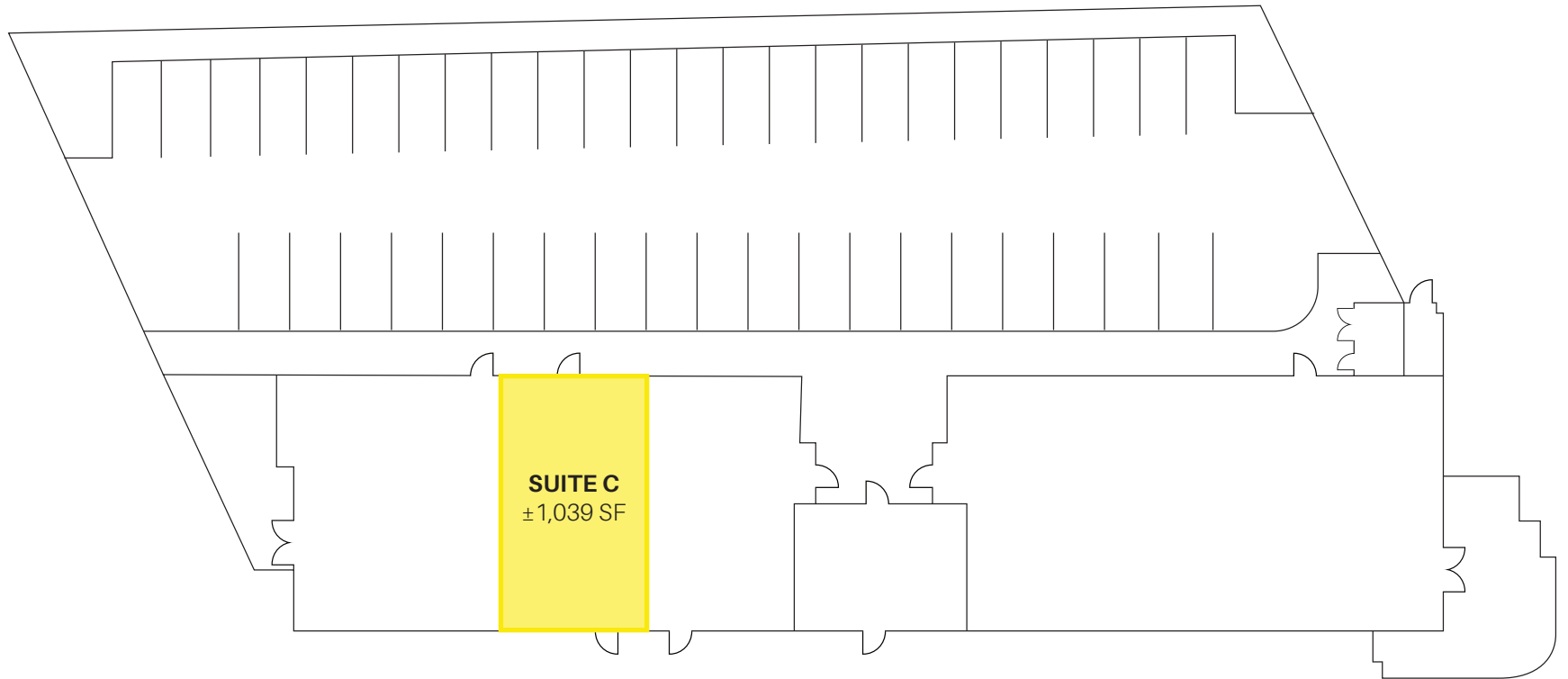

PACIFIC COAST HWY

Exclusively Offered By:

RYAN HARMAN

Senior Vice President
License ID #01399616
949.790.3136
rharman@leeirvine.com

KEVIN BAYLESS

Senior Vice President
License ID #01788899
949.790.3142
kbayless@leeirvine.com

JESSE KNIGHT

Senior Associate
License ID# 0205899
949.790.3103
jknights@leeirvine.com



COMMERCIAL REAL ESTATE SERVICES

COASTAL INVESTMENT GROUP

coastalinvestmentsales.com | 949.727.1200

MONARCH BAY PLAZA



Dana Hills
TENNIS CENTER

MONARCH BEACH
GOLF LINKS

WALDORF ASTORIA
HOTELS & RESORTS



THE RITZ-CARLTON

RH DANA ELEMENTARY



DANA POINT LANTERN DISTRICT

BABY BEACH

DANA POINT HARBOR



34212 PACIFIC COAST HWY
UNIT C, DANA POINT



PRADO WEST



LANTERN BAY VILLAGE



CAPISTRANO VALLEY PLAZA

