

NOTES

1. SURVEYOR: NOEL M. PETERSON, R.L.S. NO. 2043
ADAMS CRAFT HERZ WALKER, INC.
800 OAK RIDGE TURNPIKE, SUITE A-400
OAK RIDGE, TENNESSEE 37831
PH: (865) 482-4451
FAX: (865) 482-4454
2. CLIENT: LMC PROPERTIES
107 PARK MEADE DRIVE
OAK RIDGE, TENNESSEE 37830
3. SITE ADDRESS: COMMERCE PARK
OAK RIDGE, TENNESSEE 37830
4. DATE OF SURVEY: NOVEMBER 20, 2002
5. IRON PIN WITH PLASTIC YELLOW CAP SET;
NOVEMBER 18, 19, AND 20, 2002
6. UNLESS OTHERWISE NOTED, ALL IRON PINS ARE
5/8" STEEL RODS.
7. A 10' DRAINAGE & UTILITY EASEMENT INSIDE ALL
EXTERIOR BOUNDARY LINES, AND A 5' DRAINAGE
& UTILITY EASEMENT ON EACH SIDE OF ALL
INTERIOR LOT LINES IS HEREBY RESERVED IN
FAVOR OF THE CITY OF OAK RIDGE.
8. PROPERTY IS ZONED IND. 2; SETBACKS: 30' FRONT,
25' REAR & SIDE

LEGEND

- DOE MONUMENT (GPS 21)
- IRON PIN (FOUND)
- IRON PIN WITH CAP (FOUND)
- IRON PIN WITH CAP (SET)
- CONC. RIGHT OF WAY MARKER (FOUND)
- 36" OAK TREE (FOUND)
- DATA FROM THIS SURVEY
- RECORD DATA
- POINT OF BEGINNING
- ABANDONED ESM'T.
- FIRE HYDRANT
- VALVE
- SAN. SEWER MANHOLE
- ELECTRIC POWER POLE
- TWIN ELECTRIC POWER POLES
- ELECTRIC
- GAS
- WATER
- SANITARY SEWER
- SLOPE ESM'T.
- PERMANENT DRAINAGE ESM'T.

**ADAMS ARCHITECTS
CRAFT ENGINEERS
HERZ PLANNERS
WALKER SURVEYORS**
OAK RIDGE TENNESSEE

**BOUNDARY SURVEY OF LOTS
29CD-2, 26CC-3, 28CD-4, 30CC-4.02,
29CC-4.03, AND 28CC-4.05**

**COMMERCE PARK
DISTRICT 2, CITY OF OAK RIDGE
ANDERSON COUNTY, TENNESSEE**

issue	drawn by	checked by	date	approval
original	J.C.P.		11-22-02	

7840BS-1
file dwg. no. field book no. 01784.0
job no.

BS-1

drawing number

CERTIFICATION

I HEREBY CERTIFY THAT THIS IS A CATEGORY I SURVEY, AND THE FIELD TRAVERSE UPON WHICH THIS MAP IS BASED HAS A CLOSURE PRECISION OF ONE FOOT IN 30,600 FEET. ALSO, THE FIELD TRAVERSE HAS AN ANGULAR ERROR OF 2 SECONDS PER ANGLE POINT, AND WAS ADJUSTED USING THE COMPASS RULE.

NOEL M. PETERSON DATE
TN RLS NO 2043

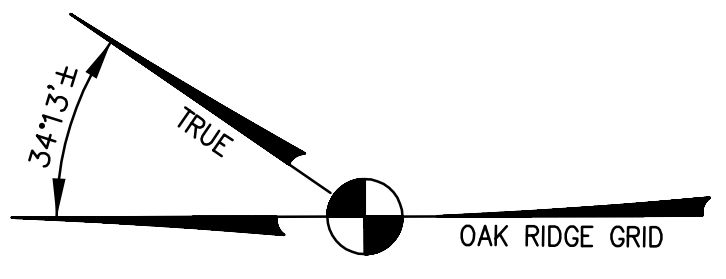

DIRECTIONAL BEARINGS USED ON THIS MAP ARE BASED ON THE OAK RIDGE COORDINATE SYSTEM AND DO NOT REFER TO EITHER TRUE OR MAGNETIC NORTH.

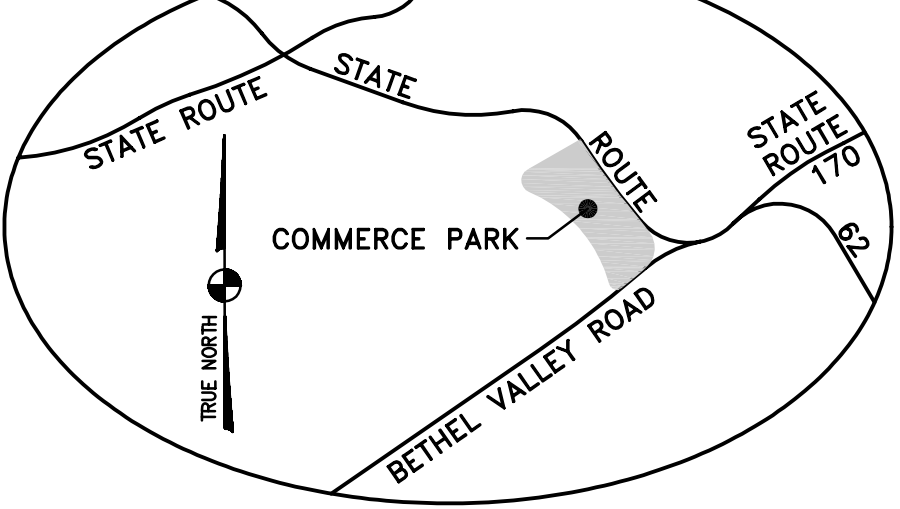

LOCATION MAP
NOT TO SCALE

CURVE TABLE								
CURVE	RADIUS	LENGTH	CHORD BEARING	CHORD	RADIUS	LENGTH	CHORD BEARING	CHORD
C1	(597.95')	(1026.27')	(N 34°00'51" W)	(904.86')	598.06'	1026.46'	N 34°01'53" W	905.03'
C2	(465.74')	(412.21')			465.74'	412.21'	S 71°26'41" W	398.89'
C3					11516.16'	283.91'	S 00°00'53" E	283.90'
C4	(525.46')	(379.09')			525.33'	378.42'	N 58°44'00" W	370.29'
C5	(614.56')	(445.95')	(N 17°15'58" W)	(436.24')	618.97'	446.01'	N 17°18'56" W	436.43'
C6	(1544.9')	(613.52')			1527.89'	511.69'	N 85°41'51" W	509.31'
C7	(50.00')	(221.08')	(N 53°37'30" E)	(80.21')	50.00'	221.08'	N 53°37'48" E	80.21'
C8	(75.00')	(54.60')	(N 52°11'23" W)	(53.40')	75.00'	54.59'	N 52°11'16" W	53.39'
C9	(495.87')	(202.25')	(N 19°39'03" W)	(200.85')	496.40'	202.25'	N 19°39'51" W	200.86'
C10	(434.26')	(120.85')	(N 15°56'20" W)	(120.46')	434.15'	120.88'	N 15°58'05" W	120.49'
C11	(75.00')	(77.71')	(N 15°46'23" E)	(74.28')	75.00'	77.65'	N 05°43'03" E	74.23'
C12					620.33'	154.19'	S 83°38'01" E	153.79'
C13	(251.00')	(360.98')	(N 52°11'59" W)	(330.67')	251.13'	360.77'	N 52°12'50" W	330.54'
C14	(293.31')	(181.57')	(S 12°37'22" W)	(178.68')	293.20'	181.52'	S 12°35'53" W	178.63'
C15	(1723.26')	(69.70')	(N 08°59'07" E)	(69.70')	1722.00'	69.71'	N 08°59'00" E	69.71'
C16	(597.96')	(287.04')	(S 09°10'07" E)	(284.30')	597.74'	286.71'	S 09°10'49" E	283.97'
C17	(1932.60')	(327.71')	(N 02°58'07" E)	(327.32')	1945.90'	327.31'	N 02°57'52" E	326.93'
C18	(3723.19')	(197.31')	(N 00°22'47" W)	(197.14')	3867.51'	197.16'	N 00°23'37" W	197.14'

ADJACENT PROPERTY OWNERS				
LOT NO.	DEED BOOK	PAGE NO.	BLOCK	OWNERS (N/F)
1	H-19	778	29CD	PARCEL RP LLC C/O M4 ENVIRONMENTAL LP
1.03	1162	296	26CC	ROGER K. STEVENS & LARRY E. WEBB
2	1011	665	26CD	UNITED STATES DEPARTMENT OF ENERGY (USDOE)
3.02	R-16	430	26CD	REMOTE TECHNOLOGY
3.03	M-19	156	27CC	COORS TECHNICAL CERAMICS
4	D-18	752	26CD	CITY OF OAK RIDGE
4.01	R-17	904	29CC	FEIN TOOL TENNESSEE, INC.
4.04	1001	724	28CC	TECHNOLOGY 2020, INC.
4.06	F-19	860	28CC	CITY OF OAK RIDGE
4.07	1232	751	28CC	OPHTHALMIC GROUP WORLDWIDE, INC.
5	K-17	525	26CD	CITY OF OAK RIDGE
8	J-17	402	28CD	CITY OF OAK RIDGE
8	B-19	26	25CC	RICHARD G. CHINN AND WIFE SHIRLEY A.
9	J-17	402	28CD	CITY OF OAK RIDGE

LINE TABLE				
LINE	BEARING	LENGTH	BEARING	LENGTH
L1	(N 73°55'19" E)	(18.81')	N 74°12'20" E	18.89'
L2	(N 00°11'54" E)	(21.46')	N 00°12'00" E	21.46'
L3	(S 87°07'07" E)	(187.30')	S 87°07'00" E	187.30'
L4	(S 32°17'00" E)	(88.50')	S 32°17'00" E	88.50'
L5	(S 85°00'06" E)	(200.38')	S 85°00'00" E	200.38'
L6	(S 87°28'07" E)	(168.37')	S 87°28'00" E	126.23'
L7	(S 49°56'16" W)	(69.95')	S 51°14'30" W	67.98'
L8	(N 05°10'00" W)	(5.0')	S 00°44'00" E	59.70'
L9	(N 05°17'30" W)	(5.00')	N 05°17'30" W	5.00'
L10	(S 84°50'00" W)	(64.00')	S 84°42'30" W	64.23'
L11		(11.66')	N 23°56'40" W	11.66'
L12	(S 33°17'11" E)	(43.64')	S 33°23'50" E	43.64'
L13	(N 73°29'11" E)	(118.74')	N 73°30'15" E	118.77'
L14	(N 86°34'55" E)	(72.31')	N 86°35'40" E	72.20'
L15	(N 49°56'16" E)	(79.84')	N 49°55'15" E	79.91'
L16	(N 11°00" W)	(108.0')	N 11°03'30" W	107.89'
L17	(N 16°08'45" W)	(81.01')	N 16°11'40" W	80.90'
L18	(N 10°00" W)	(102.60')	N 10°10'30" W	102.53'
L19	(S 05°06'41" E)	(90.30')	S 05°08'15" E	90.28'
L20	(S 30°21'25" W)	(63.09')	S 30°20'00" W	63.17'
L21	(N 07°49'35" E)	(60.00')	N 07°47'00" E	60.26'
L22	(N 01°08'50" E)	(105.00')	N 01°04'00" E	104.82'