

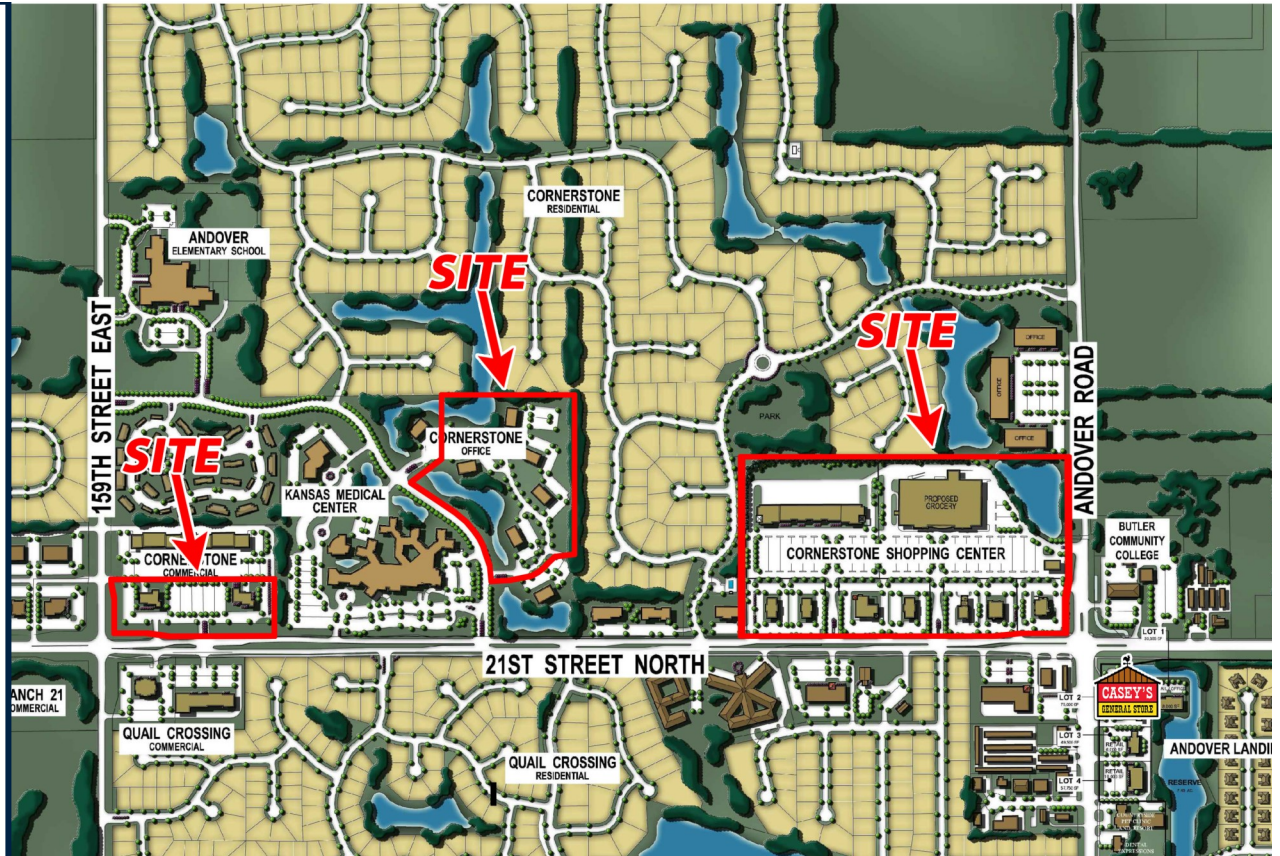

21st Street between 159th Street
& Andover Road
Andover, Kansas



- Sites available for sale or lease
 - 1 Acre up to 20 Acres
- Martin Elementary – Andover School District
- Future Andover Middle School, High School and District Stadium Complex
- 500 single family home sites of which over half are developed



*For Additional Information
Contact Christi Royce, CCIM
J.P. Weigand & Sons, Inc.*

316-292-3919

or

croyse@weigand.com

lahamdevelopment.com



Available Sites Outlined in Red.

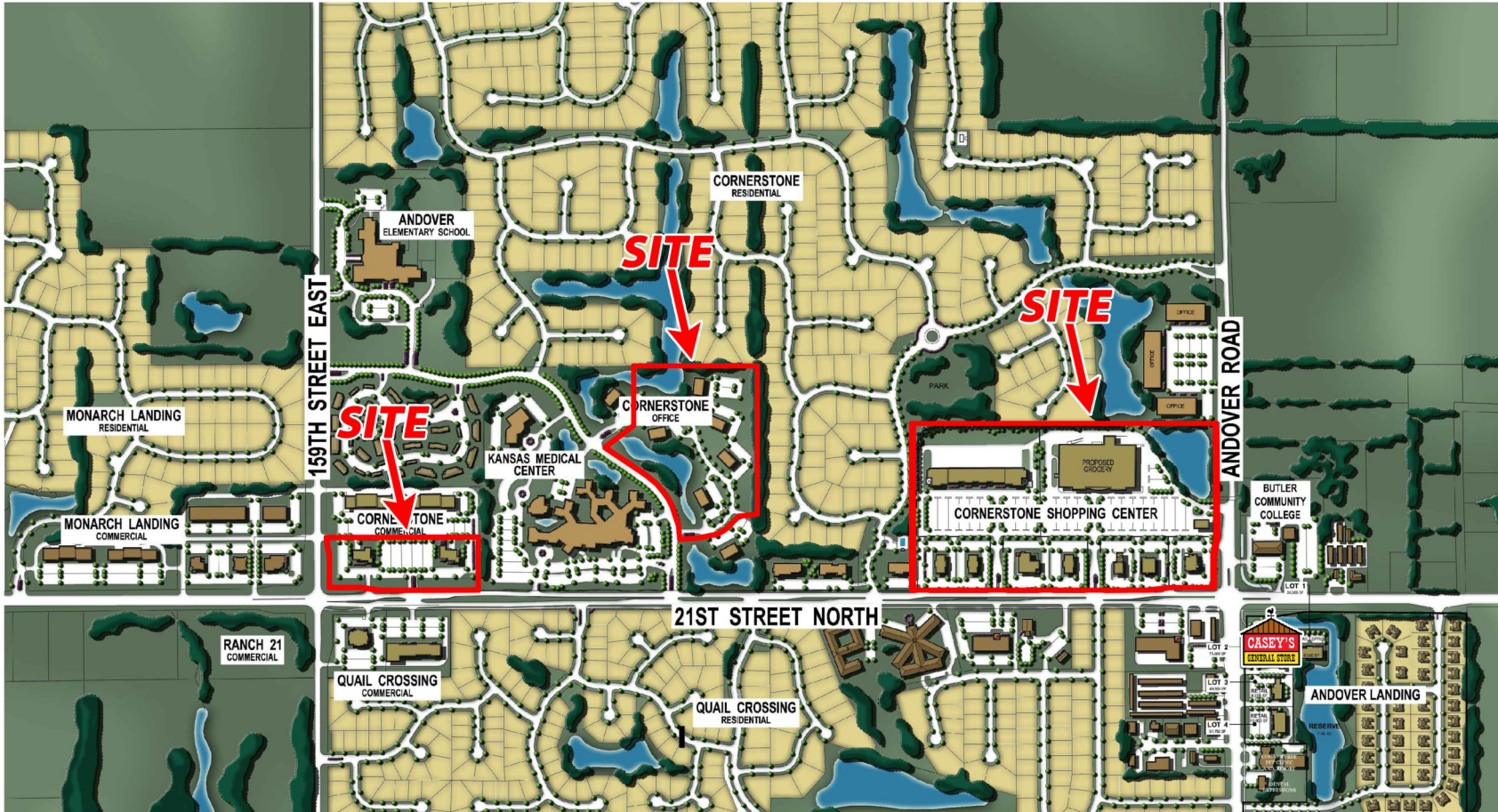

MASTER SITE PLAN
 0' 100' 300' 600'

THIS IS AN ARTIST RENDERING. ALL SITE AMENITIES, LANDSCAPING, BUILDING TYPES AND LOCATIONS ARE CONCEPTUAL AND MAYBE SUBJECT TO CHANGE PER THE DEVELOPER'S DIRECTION. REFER TO THE FINAL PLAT FOR EXACT DIMENSIONS.



160 North Market T 316.292.3950
 Wichita, KS 67202 F 316.262.5877
 lahamdevelopment.com



121 N. Mead Ste 201 Wichita KS 67202
 T 316.267.4202 F 316.267.1599
 www.sptiarchitecture.com

21ST STREET AND ANDOVER ROAD CORRIDOR

WICHITA, KANSAS

24 AUGUST 2012

Contact Christi Royse, CCIM for Information at 316-292-3919 or croyse@weigand.com.

RED TEXT DENOTES
LAHAM DEVELOPMENT PROJECTS

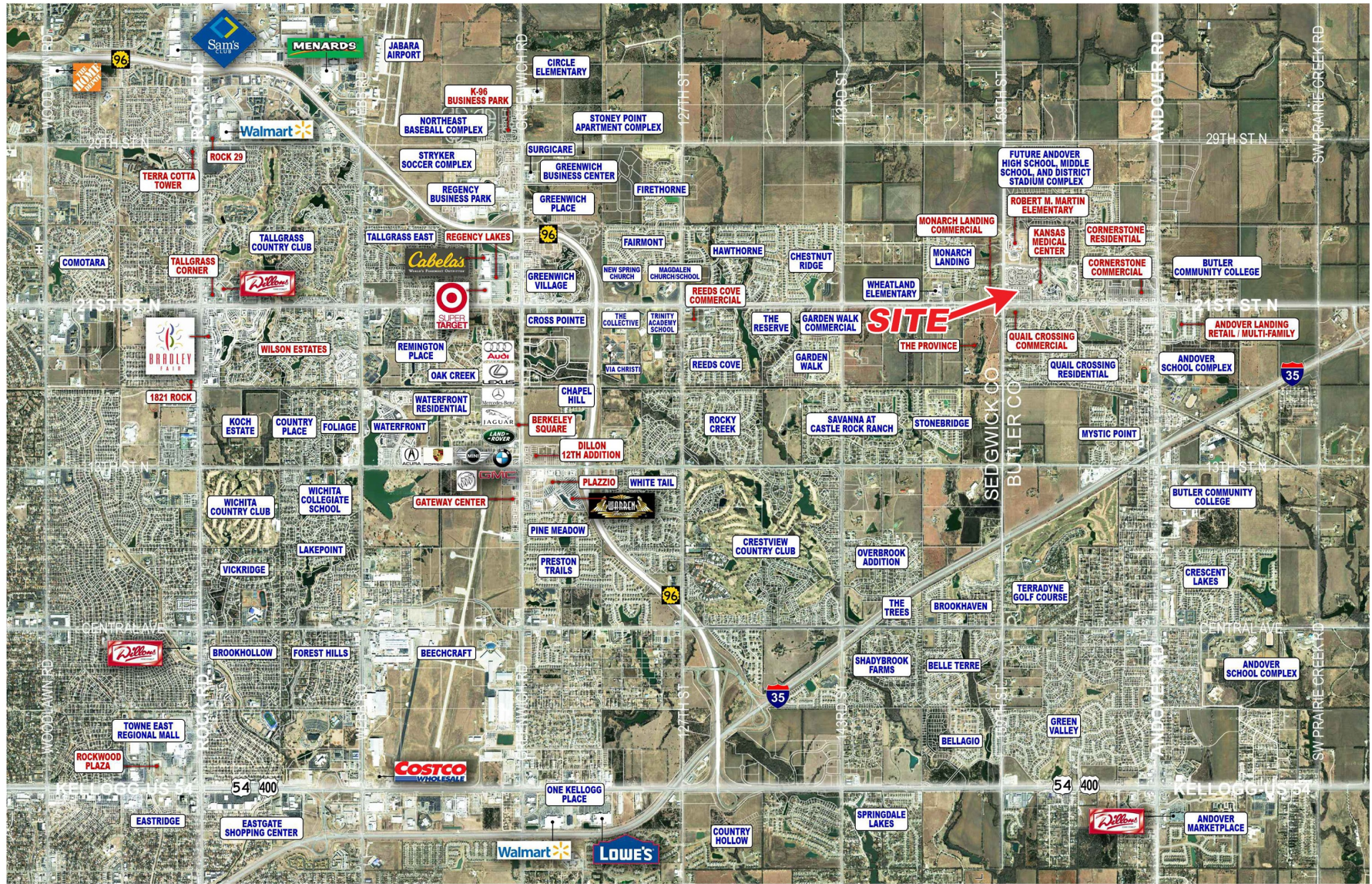

150 North Market T 316.292.3950
Wichita, KS 67202 F 316.262.5377
lahamdevelopment.com

NORTHEAST WICHITA - ANDOVER CORRIDOR



WICHITA, KANSAS
19 SEPT 2016

Contact Christi Royce, CCIM for Information at 316-292-3919 or croyce@weigand.com.