

# 1500 MARKET STREET

CENTRE SQUARE • PHILADELPHIA, PA



**GROUND FLOOR RETAIL/RESTAURANT  
SPACE AVAILABLE**

# 1500 MARKET STREET

CENTRE SQUARE • PHILADELPHIA, PA



## RETAIL/RESTAURANT OPPORTUNITIES

**INTERIOR LOBBY SPACE**    **16TH STREET**  
974 - 2,332 SF                      635 - 1,273 SF

**MARKET STREET**  
±16,200 SF  
(DIVISIBLE)

The 40,000 SF of retail space is situated under 1.8M SF of office space in two towers and adjacent to City Hall and the highly acclaimed urban park, Dilworth Plaza with 11M visitors annually

Newly finished extensive interior lobby and exterior renovations, inclusive of a new dramatic glass facade along Market Street

The retail space has exposure on 15th Street, 16th Street, Market Street and the concourse to the train-shed

Direct access to the commuter train-shed, serving the suburbs and City's subway systems



# FLOOR PLANS

Market Street

16<sup>th</sup> Street

15<sup>th</sup> Street

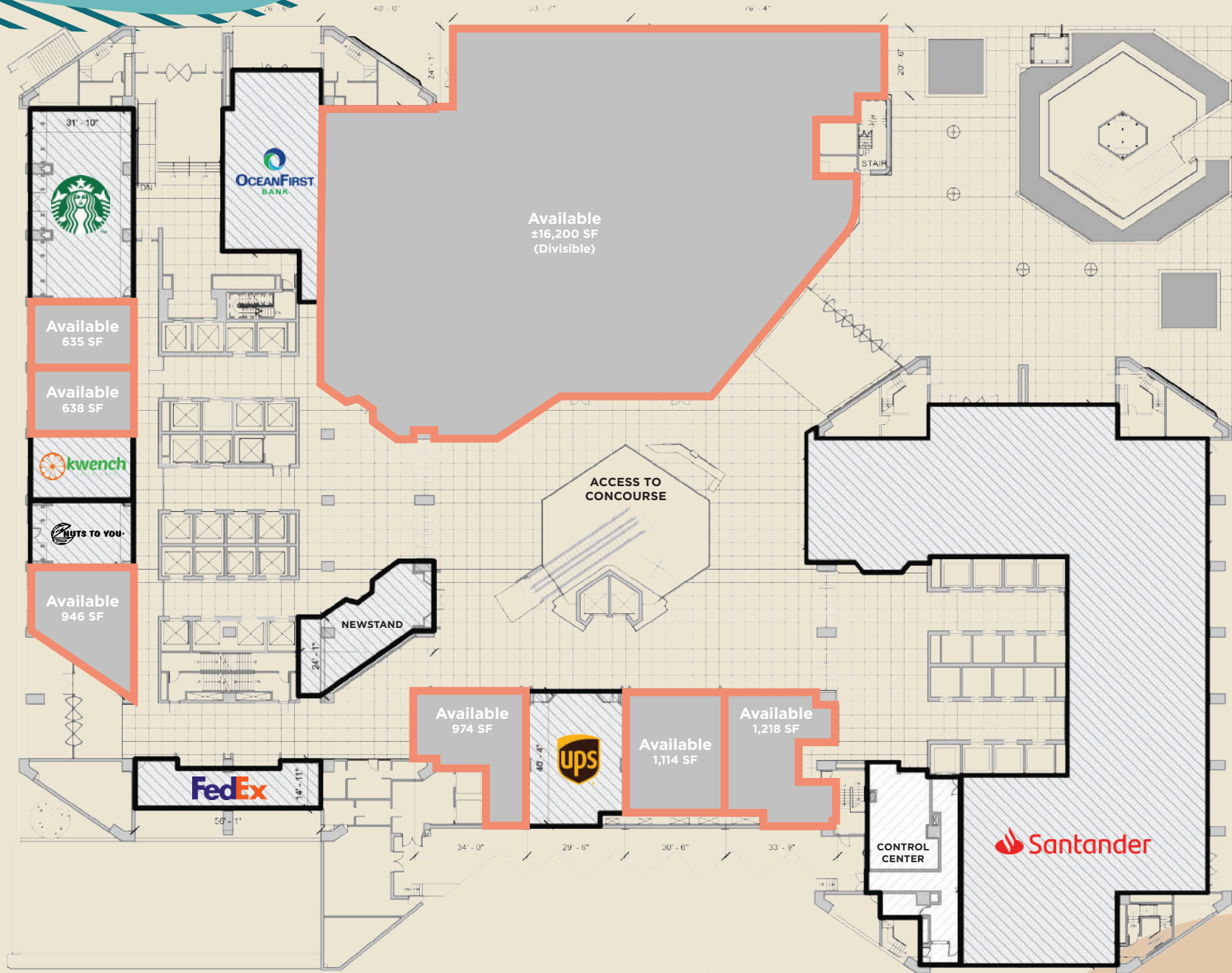

# RETAIL MAP

## 1500 MARKET STREET

CENTRE SQUARE • PHILADELPHIA, PA



City Hall

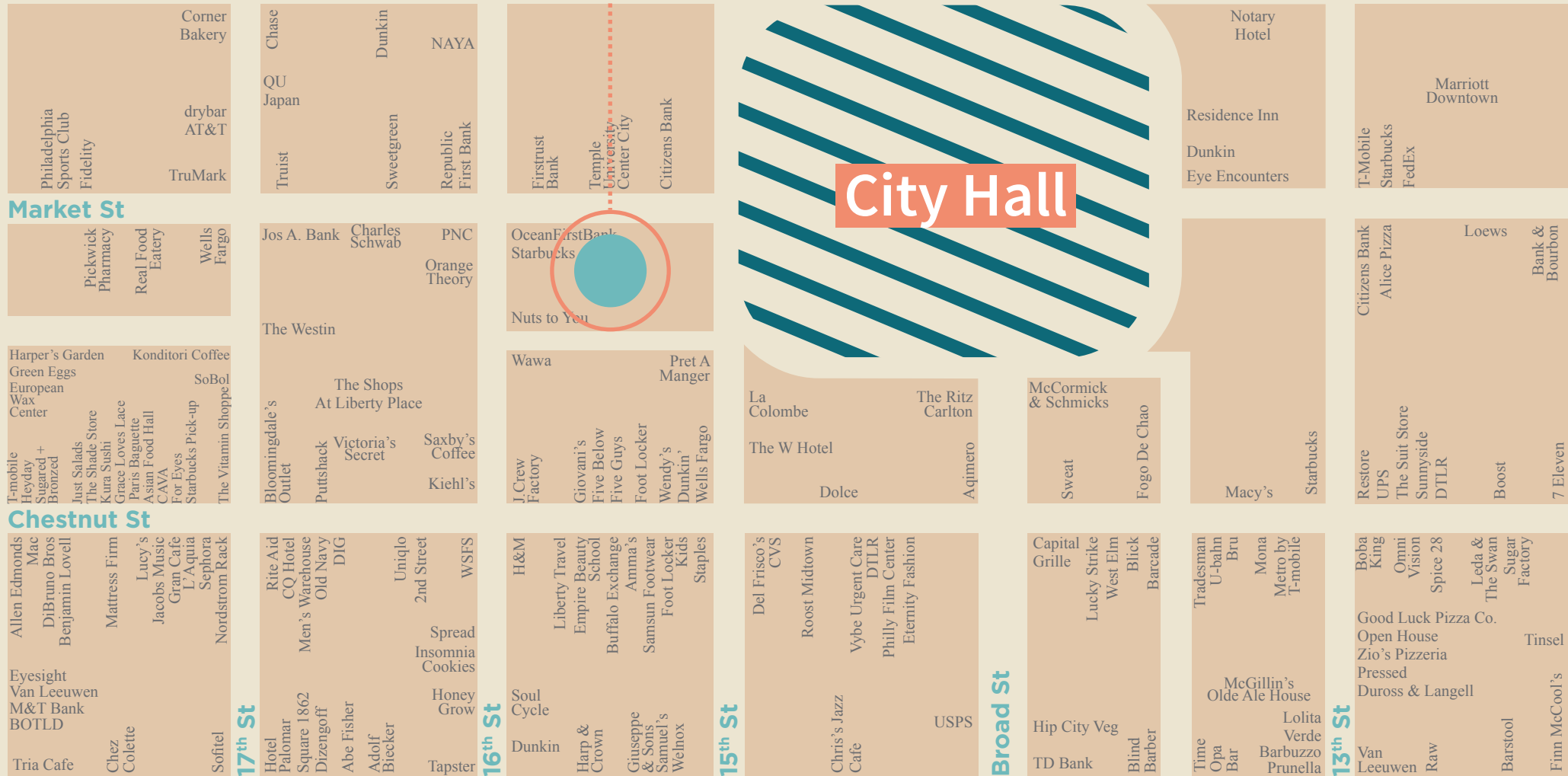

# 1500 MARKET STREET

CENTRE SQUARE • PHILADELPHIA, PA

JONES LANG LASALLE  
BROKERAGE, INC.  
1650 Arch Street  
Suite 2500  
Philadelphia, PA 19103  
215 988 5500  
jll.com/philadelphia

**Paige Jaffe • Managing Director**

215 988 5500    [paige.jaffe@am.jll.com](mailto:paige.jaffe@am.jll.com)

**Mallory Scaccetti • Senior Vice President**

215 988 5500    [mallory.scaccetti@am.jll.com](mailto:mallory.scaccetti@am.jll.com)



DISCLAIMER

© 2022 Jones Lang LaSalle IP, Inc. All rights reserved. All information contained herein is from sources deemed reliable; however, no representation or warranty is made to the accuracy thereof.