



FOR SUBLEASE

**5430-5440
W. SAN FERNANDO ROAD
Los Angeles, CA 90039**

**32,412 SF AVAILABLE
Total, 2 Buildings**

**STATE - OF - THE - ART BREWING AND COLD
STORAGE WAREHOUSE/DISTRIBUTION FACILITY**

REMAINING TERM: 06/30/2026

ASKING RATE: TBD - PLEASE CALL BROKER FOR
MORE INFORMATION



CONTACT US:

PAUL SIMS

Director
+1 213 955 5153
paul.sims@cushwake.com

ERIK LARSON

Executive Managing Director
+1 213 955 5126
erik.larson@cushwake.com



5430-5440
W. SAN FERNANDO ROAD



BUILDING DETAILS AND HIGHLIGHTS

Building 1 | 17, 500 SF: Brewing Facility (Blue Building)

- State-of-the-Art Brewing Facility
- 2 Ground Level Doors
- See Partial Equipment List

Building 2 | 14,912 SF: Cold Storage warehouse/distribution (Red Building)

- 2 Dock High Loading Positions
- 1 Ground Level
- 2 Separate Cold Rooms
- Ability for 6 Bobtail Loading Positions



PARTIAL EQUIPMENT LIST

Unit Tanks: 4 - 700 Barrel

Fermenter: 3 - 300 Barrel

Bright Tank: 3 - 300 Barrel

Fermenter: 5 - 200 Barrel

Fermenter: 2 - 100 Barrel

- Boilers
- 3 Full Laboratories
- New Compressed Air System
- New Computer and Security Systems
- New Automated Canning and Kegging System

CALL FOR FULL LIST OF EQUIPMENT



EQUIPMENT PHOTOS



SITE PLAN - BREWING FACILITY WITH EQUIPMENT

SAN FERNANDO ROAD

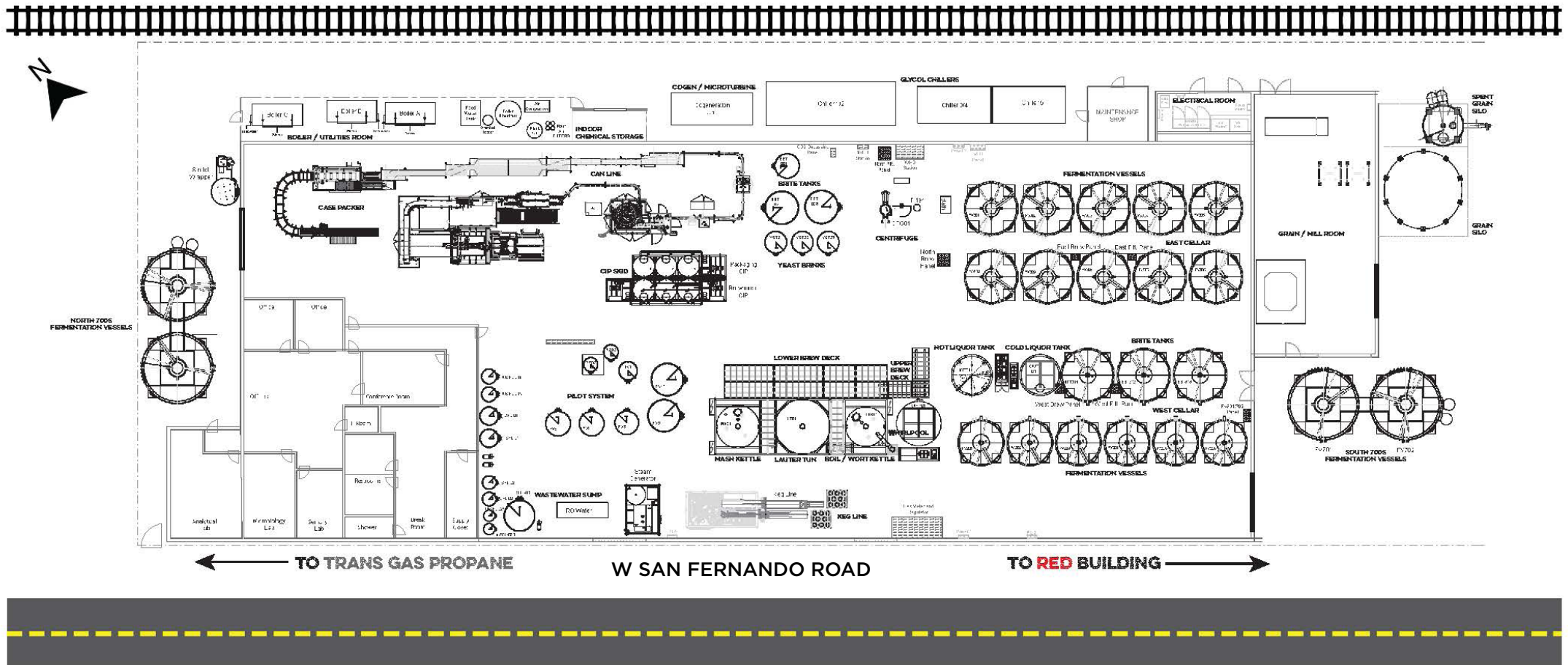

SITE PLAN - BREWING FACILITY WITHOUT EQUIPMENT

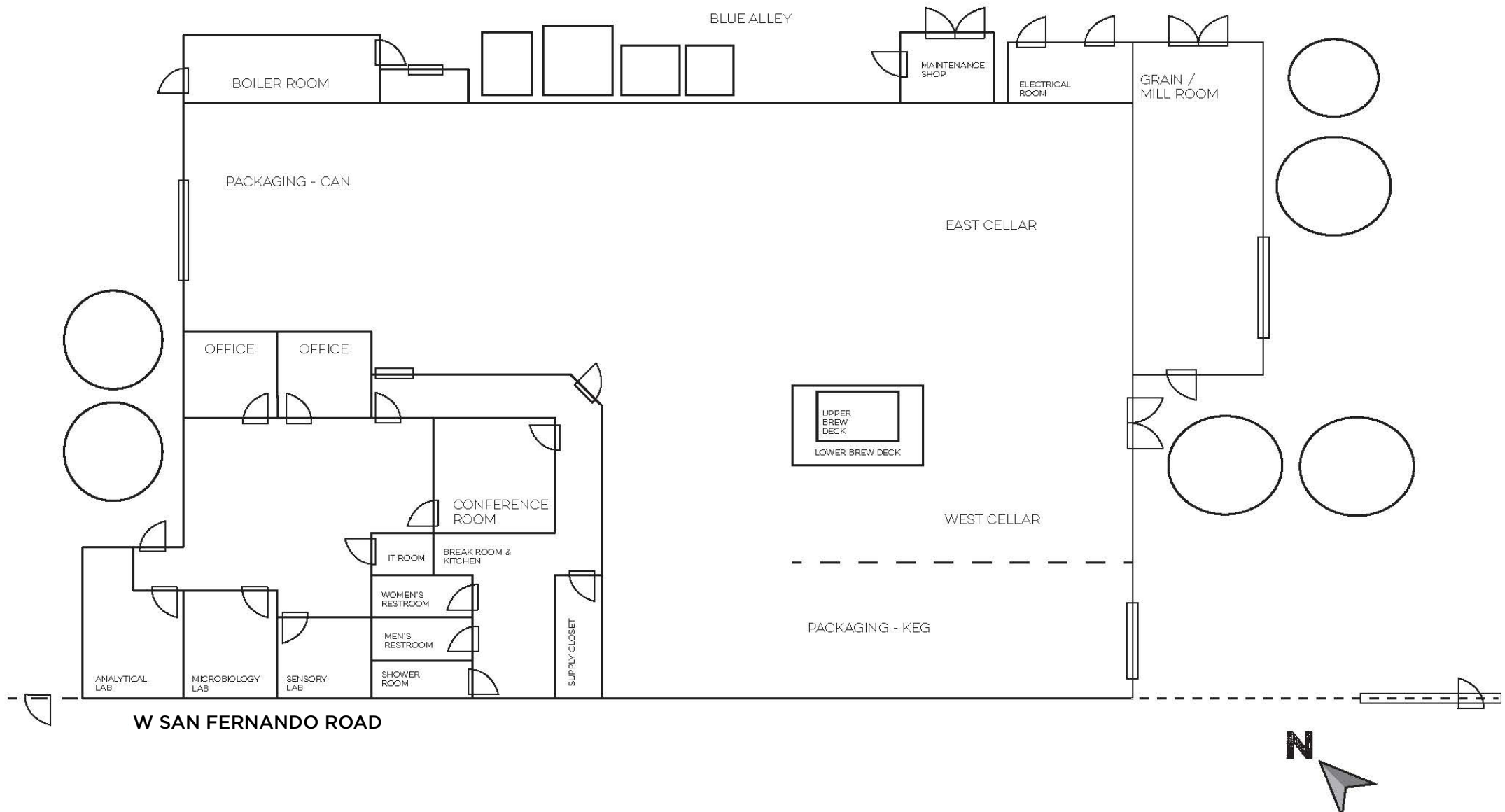

SITE PLAN - COLD STORAGE WAREHOUSE/DISTRIBUTION BUILDING

SAN FERNANDO ROAD

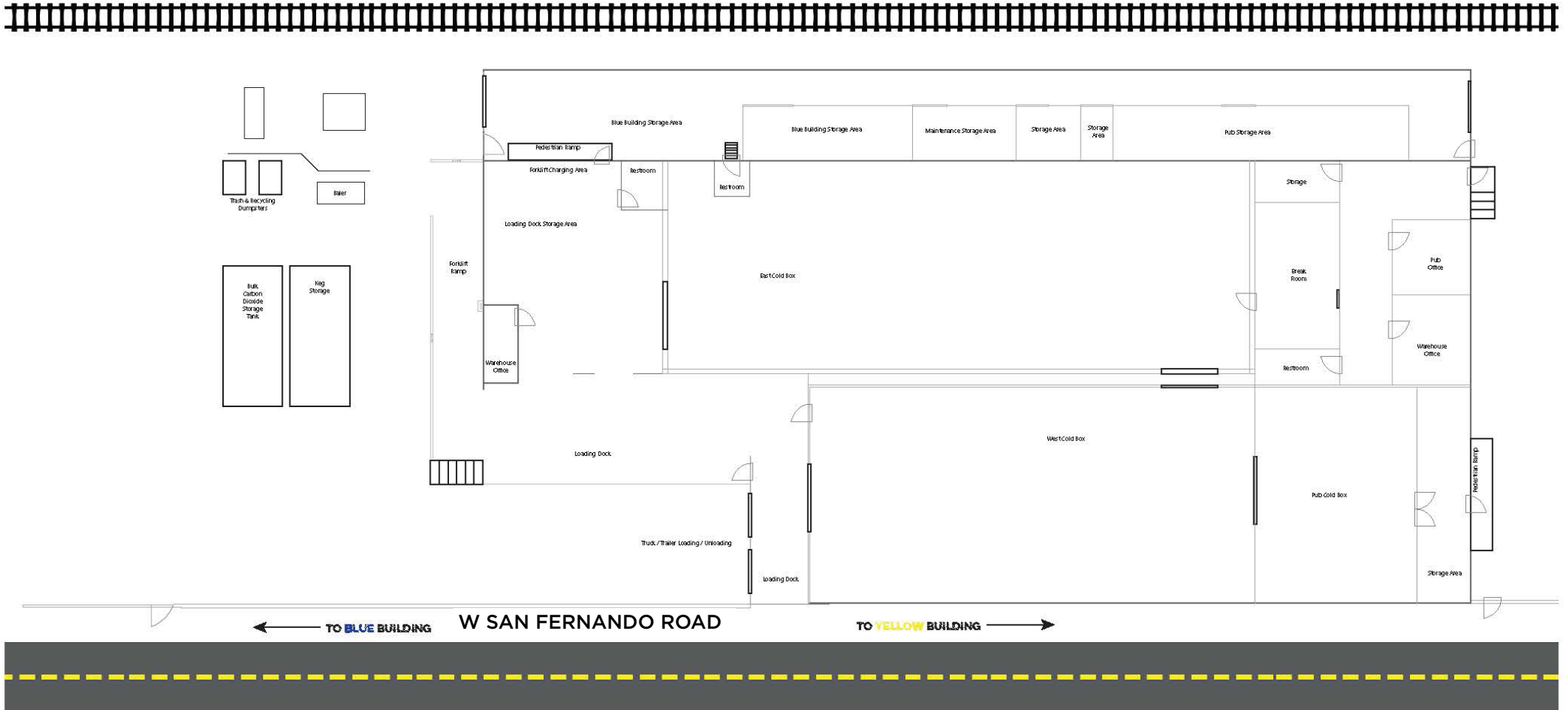

AERIAL

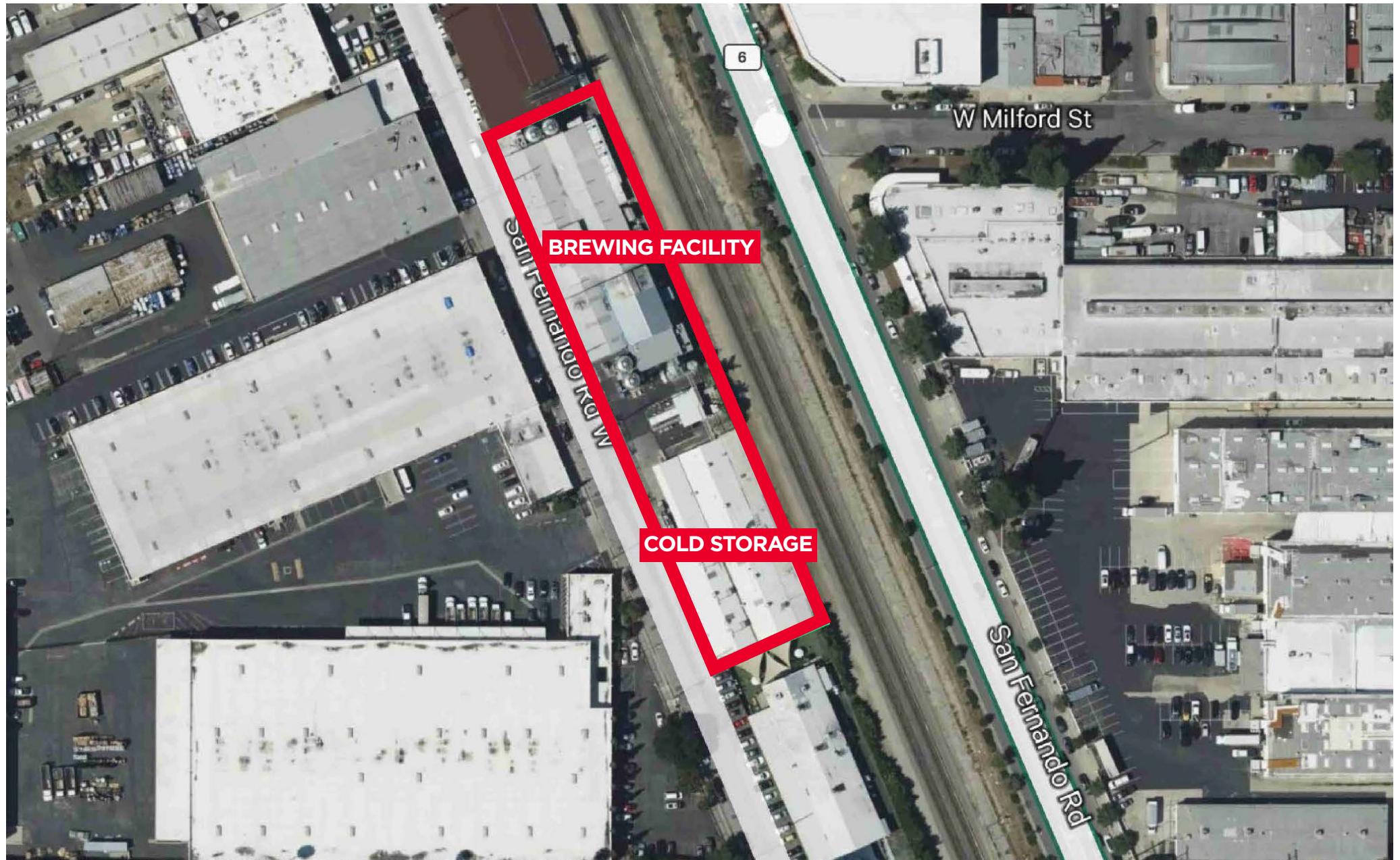

LOCATION MAP

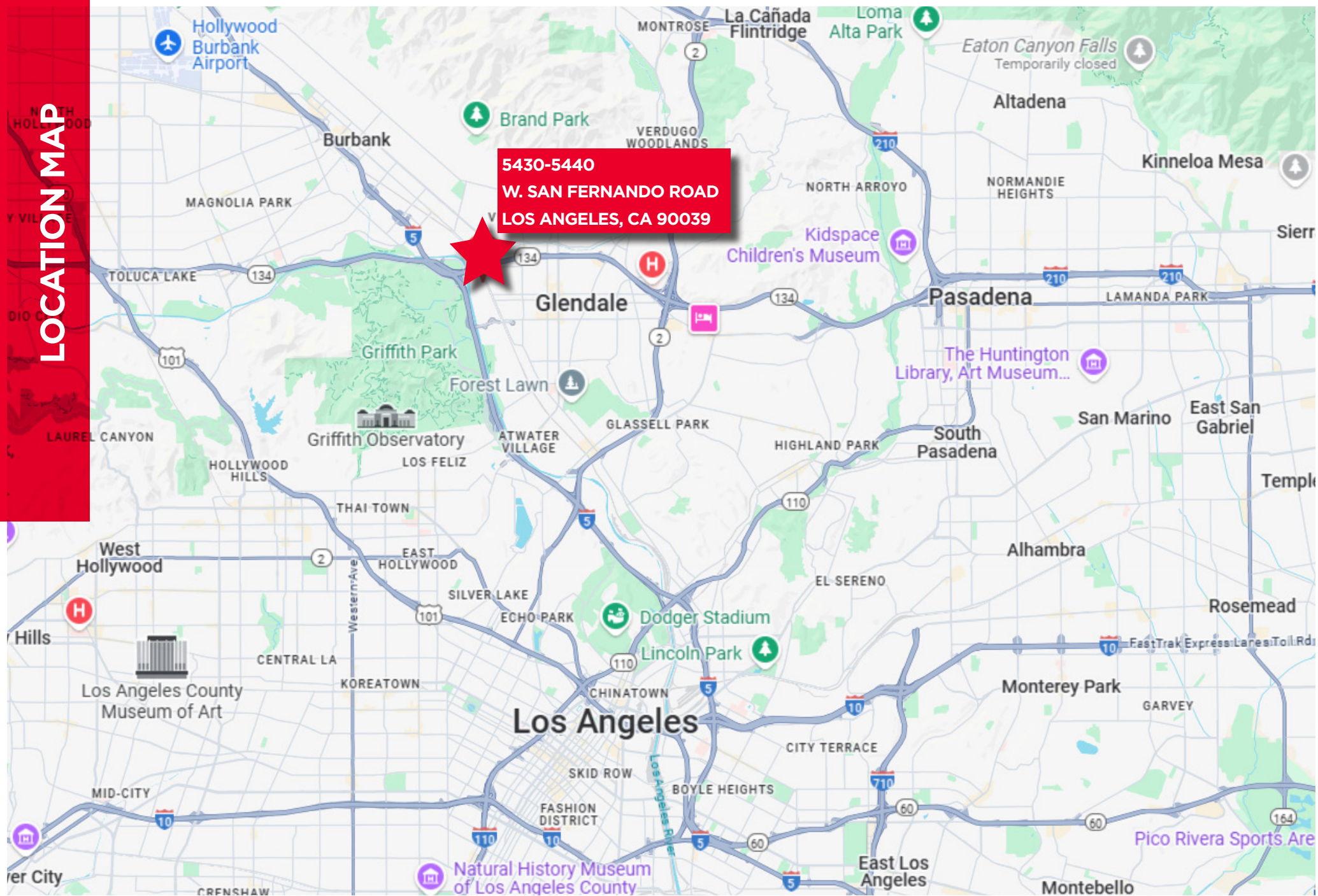



CONTACT INFORMATION:

PAUL SIMS

Director

+1 213 955 5153

paul.sims@cushwake.com

ERIK LARSON

Executive Managing Director

+1 213 955 5126

erik.larson@cushwake.com

©2025 Cushman & Wakefield. All rights reserved. The information contained in this communication is strictly confidential. This information has been obtained from sources believed to be reliable but has not been verified. NO WARRANTY OR REPRESENTATION, EXPRESS OR IMPLIED, IS MADE AS TO THE CONDITION OF THE PROPERTY (OR PROPERTIES) REFERENCED HEREIN OR AS TO THE ACCURACY OR COMPLETENESS OF THE INFORMATION CONTAINED HEREIN, AND SAME IS SUBMITTED SUBJECT TO ERRORS, OMISSIONS, CHANGE OF PRICE, RENTAL OR OTHER CONDITIONS, WITHDRAWAL WITHOUT NOTICE, AND TO ANY SPECIAL LISTING CONDITIONS IMPOSED BY THE PROPERTY OWNER(S). ANY PROJECTIONS, OPINIONS OR ESTIMATES ARE SUBJECT TO UNCERTAINTY AND DO NOT SIGNIFY CURRENT OR FUTURE PROPERTY PERFORMANCE.