

115,500 SF Class A Industrial Space in Charleston Trade Center

553

TRADE CENTER PARKWAY

SUMMERVILLE, SC 29483



AVAILABLE FOR SUBLEASE THROUGH JULY 31, 2026

CBRE

PROPERTY HIGHLIGHTS



Year Built
2019



Zoning
I - Industrial



Surface Parking
75 Spaces



Asking Rate
Upon Request



Sublease Term
July 31, 2026



15 DOCK DOORS

7 Equipped with 35,000 # Levelers and
2 Edge of Dock Levelers



BUILDING SPECIFICATIONS

115,500 SF

SIZE

210' x 550'

DIMENSIONS

2,500 SF

OFFICE SPACE

32'

CLEAR HEIGHT

1 (12' x 14')

DRIVE-IN DOORS

30 FC LED

LIGHTING

100%

AIR-CONDITIONED

50' x 50'

COLUMN SPACING
WITH 60' SPEED BAY

ESFR

SPRINKLER

CBRE

FLOOR PLAN

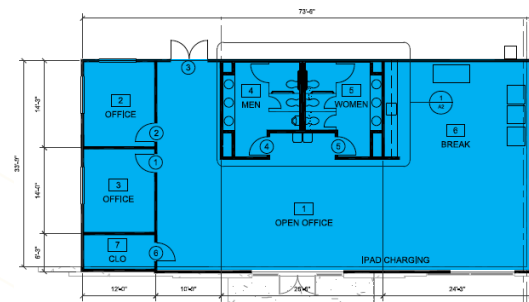
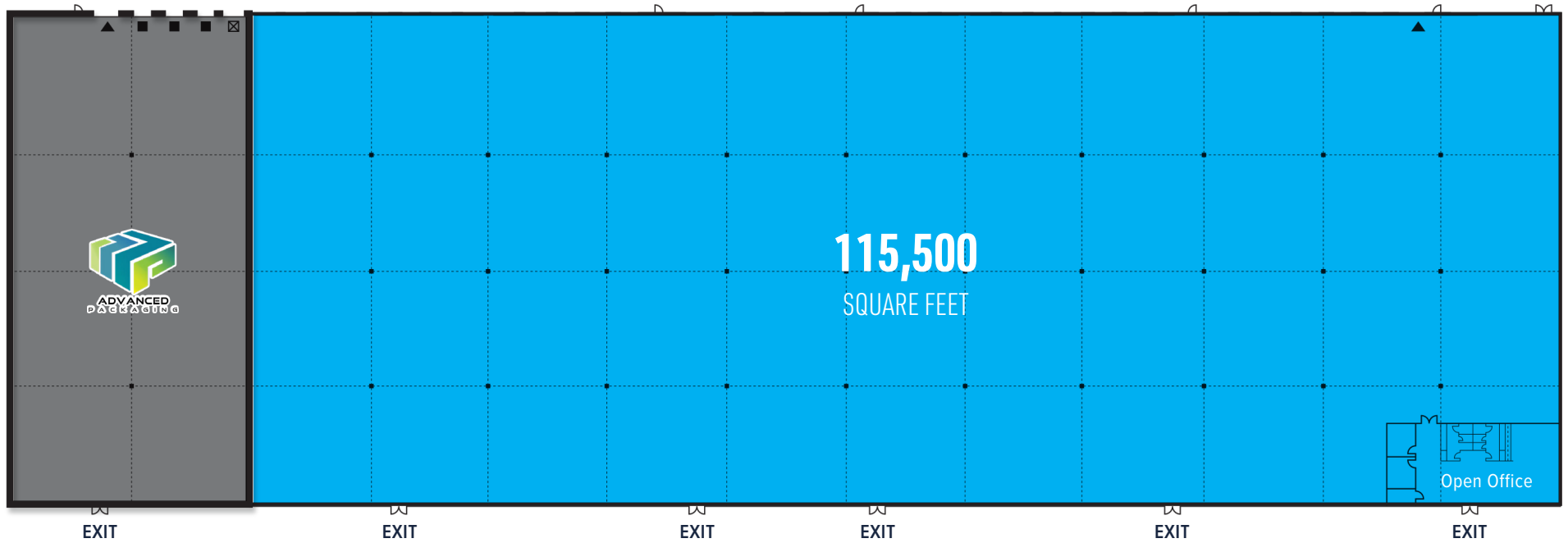

SITE PLAN



ADVANCED
PACKAGING

AVAILABLE
THROUGH JULY 31, 2026

TRADE CENTER PARKWAY

STRATEGIC LOCATION

Ideally located in the Charleston Trade Center, 553 Trade Center Parkway in Summerville, South Carolina, offers top-notch industrial space with unparalleled connectivity to major transportation routes.



±2.1 Miles

Nexton Parkway Interchange (Exit 197)

Ideally situated less than one mile from I-26 and in proximity to I-526 and I-95. Additionally, businesses can reach Charleston International Airport in a 33-minute drive, and North Charleston Freight Port Terminal in a 32-minute drive.



553

TRADE CENTER PARKWAY

SUMMERVILLE, SC 29483

CBRE

www.cbre.com/charleston



FOR MORE INFORMATION, PLEASE CONTACT:

Brendan Redeyoff

Senior Vice President

T +1 843 577 1167

brendan.redeyoff@cbre.com

Robert Barrineau

Senior Vice President

T +1 843 577 1157

robert.barrineau@cbre.com

Tim Raber

Vice President

T +1 843 972 3220

tim.raber@cbre.com

© 2023 CBRE, Inc. All rights reserved. This information has been obtained from sources believed reliable, but has not been verified for accuracy or completeness. You should conduct a careful, independent investigation of the property and verify all information. Any reliance on this information is solely at your own risk. CBRE and the CBRE logo are service marks of CBRE, Inc. All other marks displayed on this document are the property of their respective owners, and the use of such logos does not imply any affiliation with or endorsement of CBRE. Photos herein are the property of their respective owners. Use of these images without the express written consent of the owner is prohibited.