



**● HIGHLIGHTS**

- **Cameron Court Office Park**
- **MEDICAL & OFFICE USE**
- Campus setting with 4 office buildings surrounding an interior courtyard
- Ample, free surface parking
- Professionally managed
- Elevator service and common area restrooms
- Immediate 10 freeway access
- Easy connect to 57, 60, 210 & 605 freeways
- Located in West Covina's Civic Center near the Superior Court House, Police Station, Library & Plaza Mall

<b>OFFICE USE RATE</b>	<b>\$2.10 PSF/FSG</b>
<b>MEDICAL USE RATE</b>	<b>\$2.35 PSF/FSG</b>

**AVAILABILITY**

**495 SF - 14,836 SF**

**● PROPERTY DETAILS**

Campus Building Size	±118,433 SF
Year Renovated	1992
Parking	3.3:1,000
Elevator	Yes



For more information please contact:

**CHRISTOPHER LARIMORE**

Founding Principal  
D • 626.240.2788  
E • clarimore@lee-associates.com  
LICENSE ID #01314464

**VINCENT MOLITOR**

Founding Principal  
D • 626.240.2787  
E • vmolitor@lee-associates.com  
LICENSE ID #01295360

**LEE & ASSOCIATES - PASADENA, INC.**  
1055 E. Colorado Blvd., Suite 330  
Pasadena, CA 91106  
Corporate ID 02059558  
lee-pasadena.com



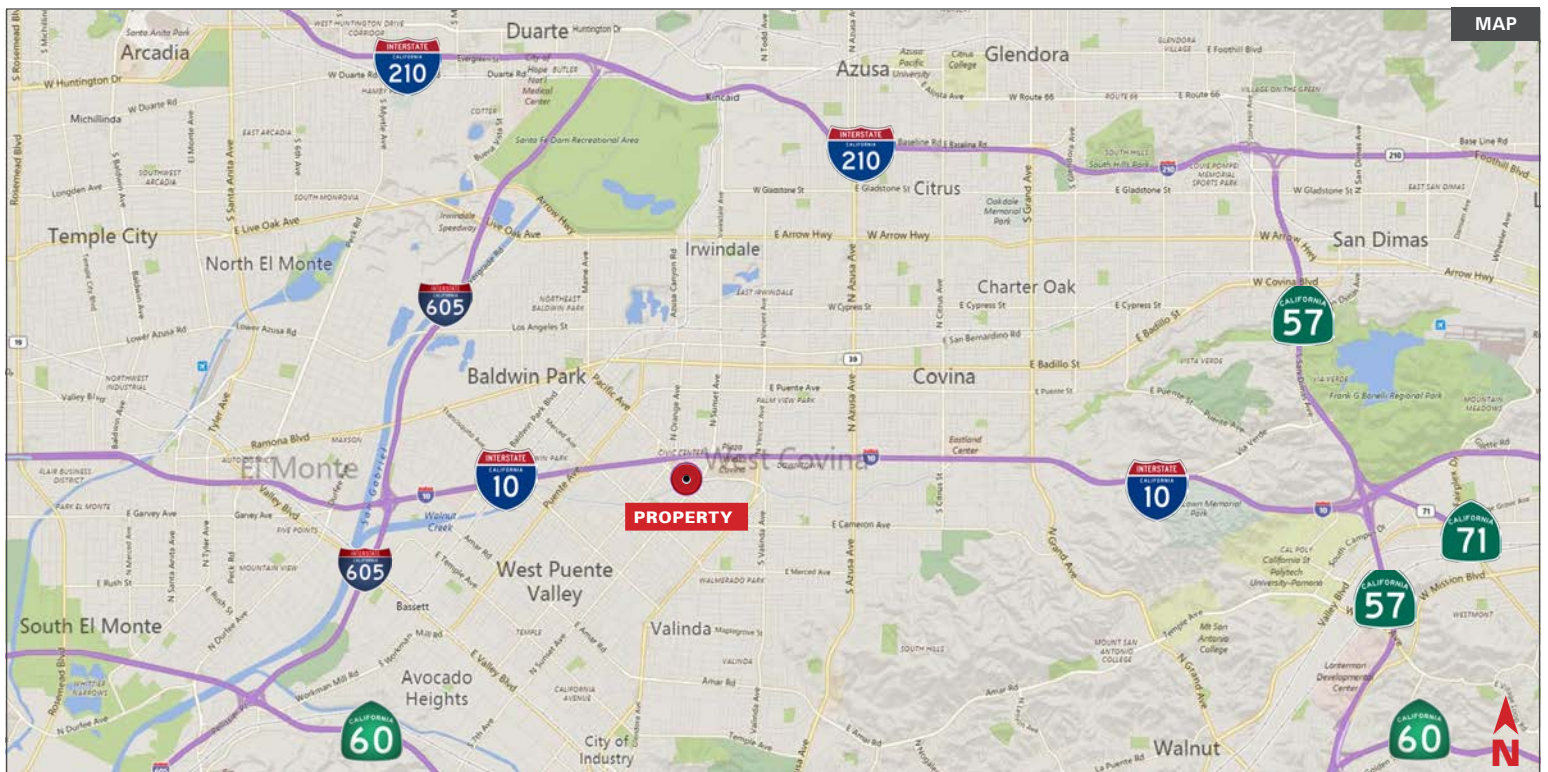

For more information please contact:

**CHRISTOPHER LARIMORE**  
Founding Principal  
D • 626.240.2788  
E • clarimore@lee-associates.com  
LICENSE ID #01314464

**VINCENT MOLITOR**  
Founding Principal  
D • 626.240.2787  
E • vmolitor@lee-associates.com  
LICENSE ID #01295360

**LEE & ASSOCIATES - PASADENA, INC.**  
1055 E. Colorado Blvd., Suite 330  
Pasadena, CA 91106  
Corporate ID 02059558  
lee-pasadena.com



**SITE PLAN**

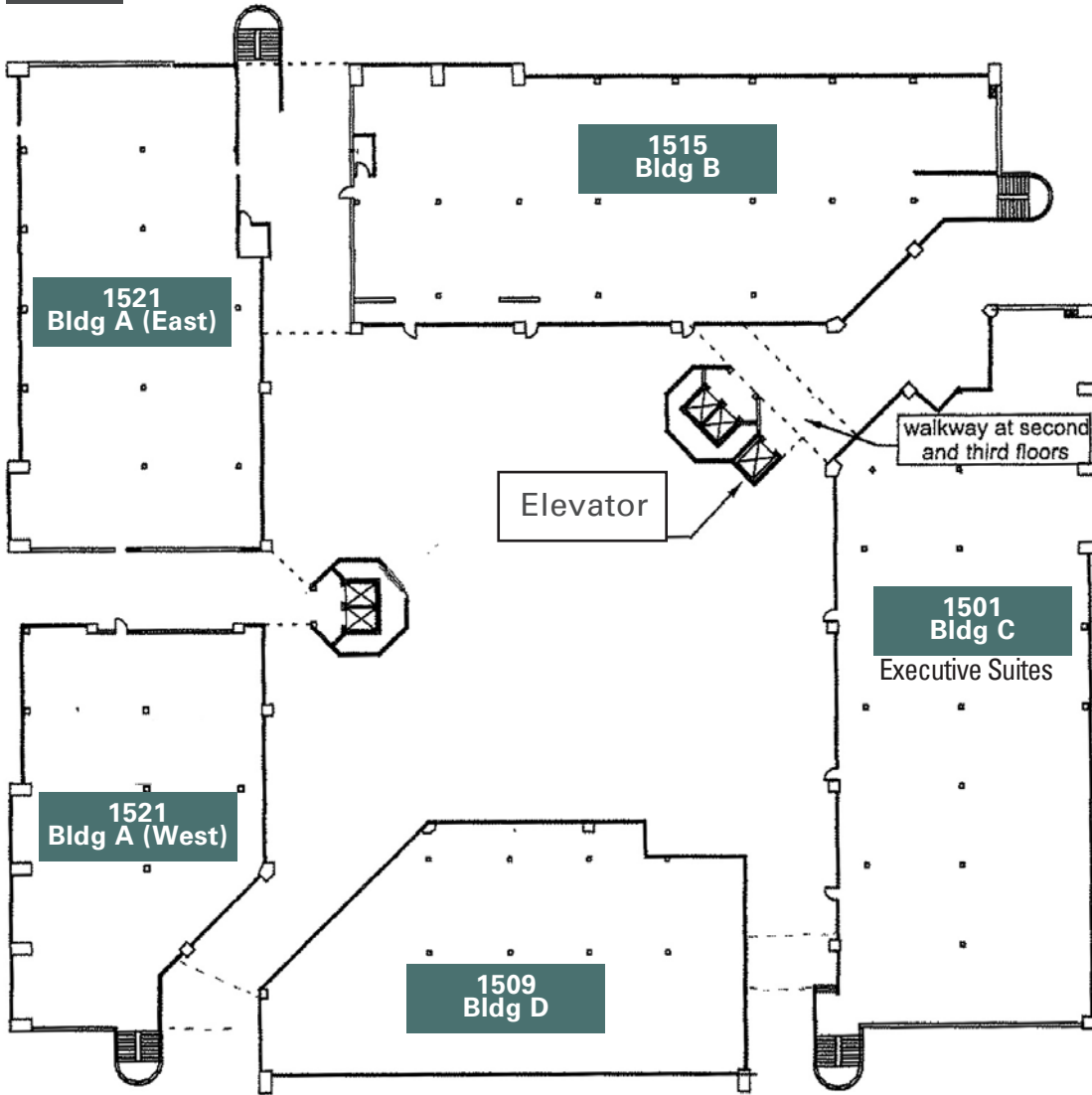

**1501 CAMERON - BLDG C**

SUITE	SQ. FT.
300	10,610

**1509 CAMERON - BLDG D**

SUITE	SQ. FT.
220	1,037
240	690

**1515 CAMERON - BLDG B**

SUITE	SQ. FT.
210	3,546
225	3,663
270	725

**1521 CAMERON - BLDG A**

SUITE	SQ. FT.
200	7,623
300	14,836



For more information please contact:

**CHRISTOPHER LARIMORE**

Founding Principal

D • 626.240.2788

E • clarimore@lee-associates.com

LICENSE ID #01314464

**VINCENT MOLITOR**

Founding Principal

D • 626.240.2787

E • vmolitor@lee-associates.com

LICENSE ID #01295360

LEE & ASSOCIATES - PASADENA, INC.

1055 E. Colorado Blvd., Suite 330

Pasadena, CA 91106

Corporate ID 02059558

lee-pasadena.com