

# FOR SALE

17.5+ Acres at the Corner of Dauphin Island Parkway & Dakota Avenue



# PROPERTY OVERVIEW

17.5+ acre corner lot just south of Bay Palms RV Resort. Excellent development potential with easy access to Dauphin Island, Bayou la Batre and Mobile.

**JEREMY MILLING** SIOR, CCIM

☎ 251 694 5050  
☎ 251 421 0919  
✉ [jeremy@millingre.com](mailto:jeremy@millingre.com)

📍 220 Saint Michael St.  
First Floor  
Mobile AL 36602

📍 PO Box 3086  
Mobile AL 36652

**MCR**COMMERCIAL.COM

The information contained herein is from sources deemed reliable. No representation is made to the accuracy herein.



## LOCATION

Corner of Dauphin Island Pkwy & Dakota Avenue  
Mobile, AL 36523



## FRONTAGE

Dauphin Island Pkwy 230'±  
Dakota Ave 3,630'±



## PRICE

\$211,250



## UTILITIES

Sewer County  
Water County



## SITE SIZE

17.5± Acres  
762,300± SF



## ZONING

County

# DIMENSIONS

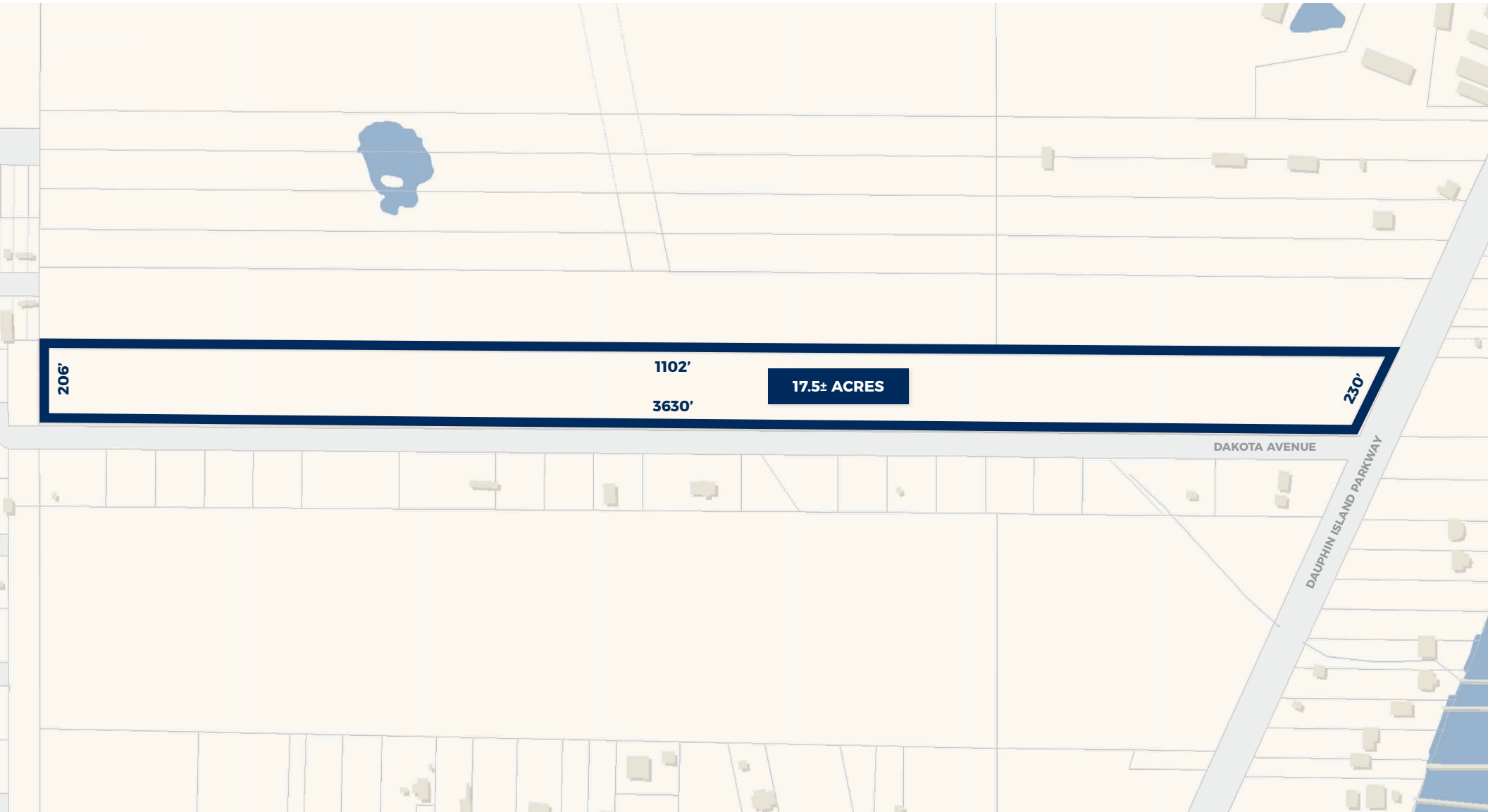

# AREA MAP

