



Switchville Crossing

361 Highland Ave, Glenside, PA 19038

**BERKSHIRE
HATHAWAY**
HOMESERVICES

**FOX & ROACH,
REALTORS®**



DAWN CIGANIK

ASSOCIATE BROKER | LIC: #AB-066539

C: 215-519-5978 | O: 215-887-4000

dawn.ciganik@foxroach.com

dawnciganik.foxroach.com

361 Highland Ave, Ste. 303 - Jenkintown, PA 19046



Jose Casalina

Berkshire Hathaway Fox & Roach - Devon-Wayne

361 Highland Ave, Suite 303, Jenkintown, PA 19046

jose@casalinadesign.com

(215) 498-4149



Switchville Crossing

\$21.50 /SF/YR

Unlock the potential of your business with this versatile 3,262 sq ft office space, perfect for professional services. The flexible floor plan offers private offices, open workspaces, and room to grow. Located in a contemporary office building, at Switchville Crossing, with modern amenities and ample parking, this space provides the perfect blend of function and style. Take your business to the next level with this space!...



Rental Rate:	\$21.50 /SF/YR
Property Type:	Office
Property Subtype:	Medical
Building Class:	A
Rentable Building Area:	3,262 SF
Year Built:	2019
Walk Score ®:	62 (Somewhat Walkable)
Rental Rate Mo:	\$1.79 /SF/MO

1

3rd Floor Ste 301

Space Available	3,262 SF
Rental Rate	\$21.50 /SF/YR
Date Available	Now
Service Type	Modified Gross
Space Type	Relet
Space Use	Office
Lease Term	1 - 5 Years

This 3,262 sq ft office space is ideal for professional services, offering a flexible floor plan that includes private offices, open workspaces, and room for growth. Situated in a contemporary office building at Switchville Crossing, the space features modern amenities and ample parking. It strikes the perfect balance between function and style making it an excellent opportunity to elevate your business.

Major Tenant Information

Tenant	SF Occupied	Lease Expired
Berkshire Hathaway	-	Current
Hanger Clinic	-	Current
Lightbridge Academy	-	Current
Philadelphia Center For Dermatology	-	Current
Sea of Smiles Pediatric Dentistry	-	Current

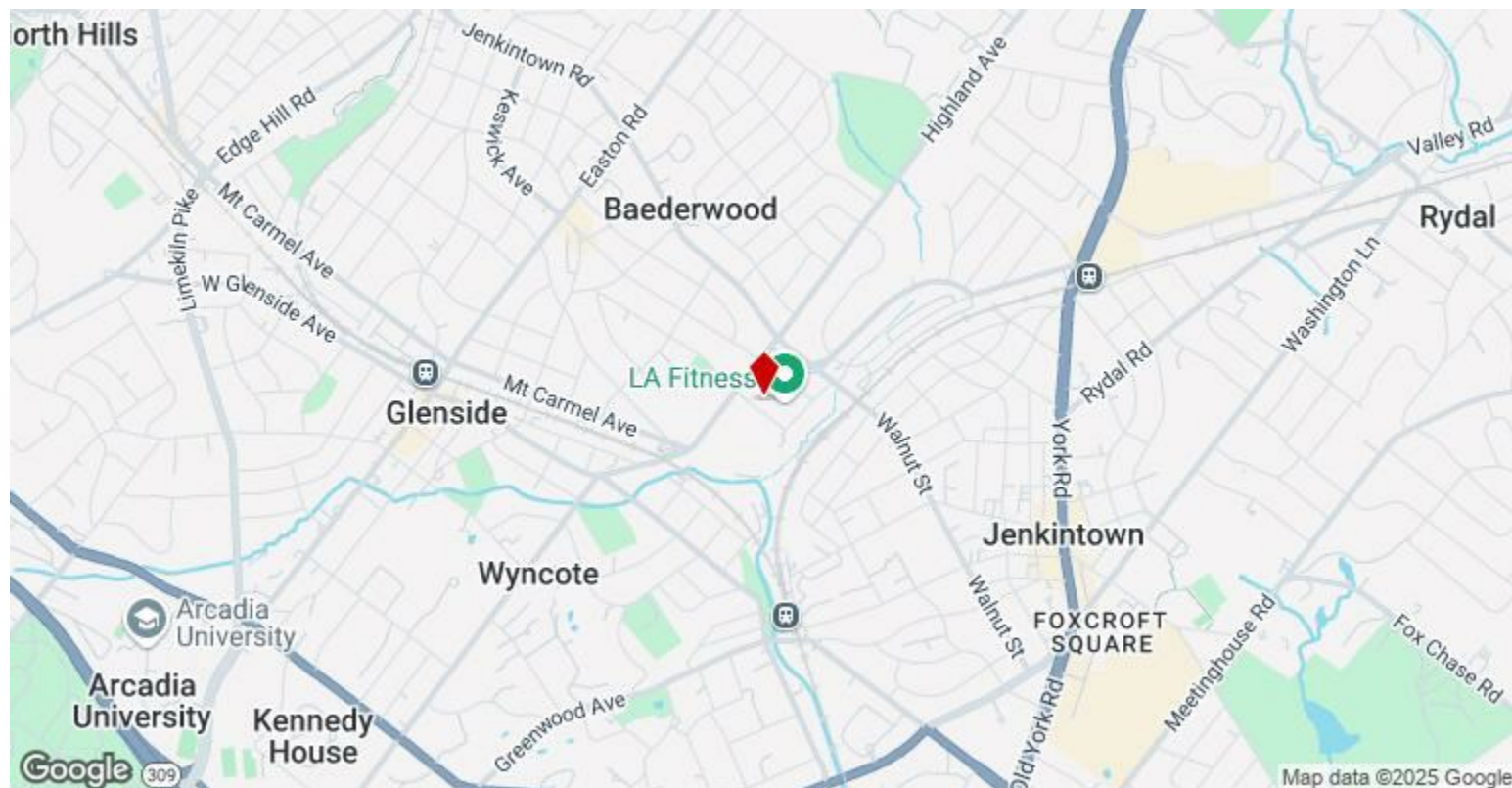

361 Highland Ave, Glenside, PA 19038

Unlock the potential of your business with this versatile 3,262 sq ft office space, perfect for professional services. The flexible floor plan offers private offices, open workspaces, and room to grow. Located in a contemporary office building, at Switchville Crossing, with modern amenities and ample parking, this space provides the perfect blend of function and style. Take your business to the next level with this space!

Property Photos



Property Photos

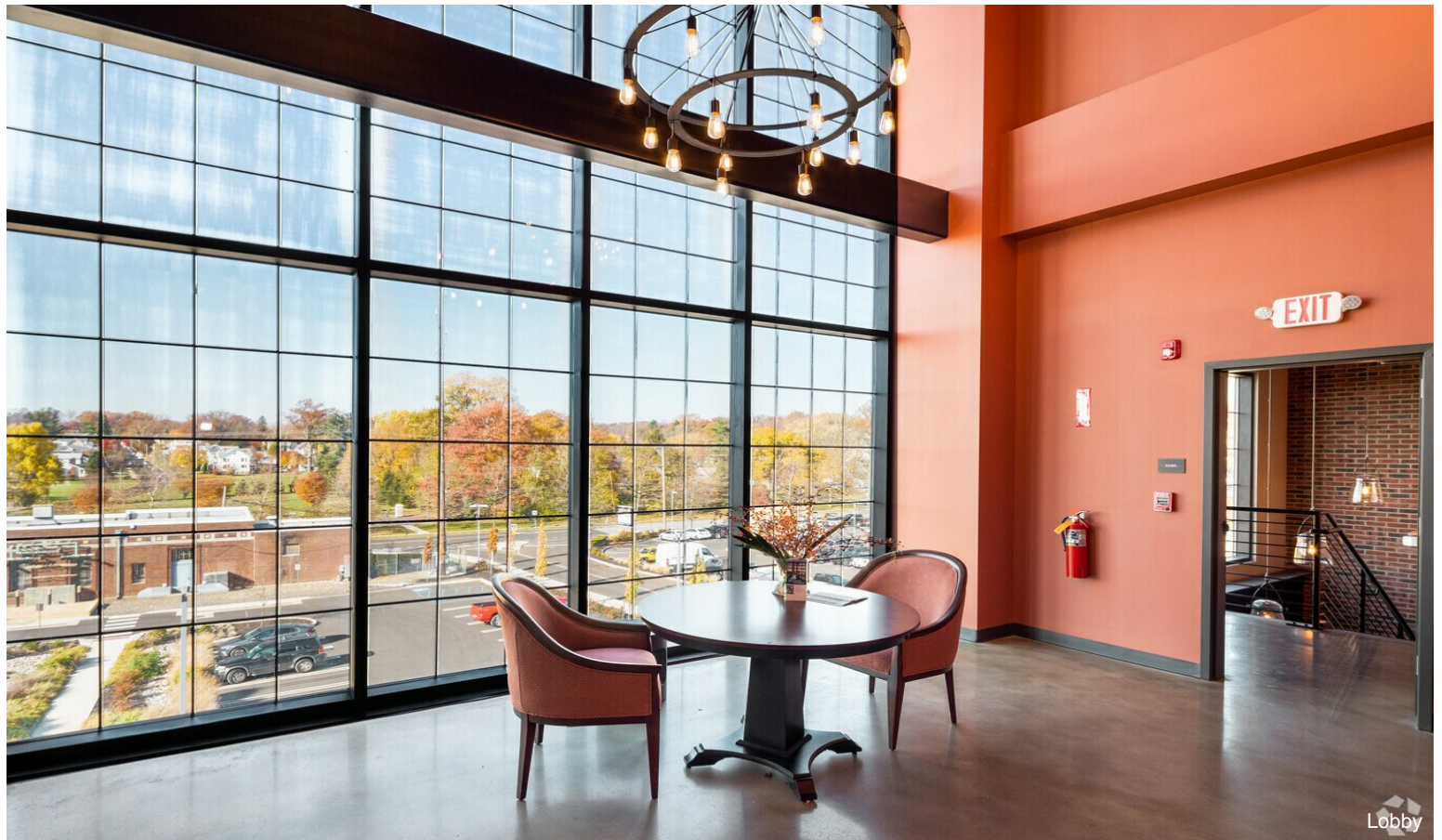

Property Photos

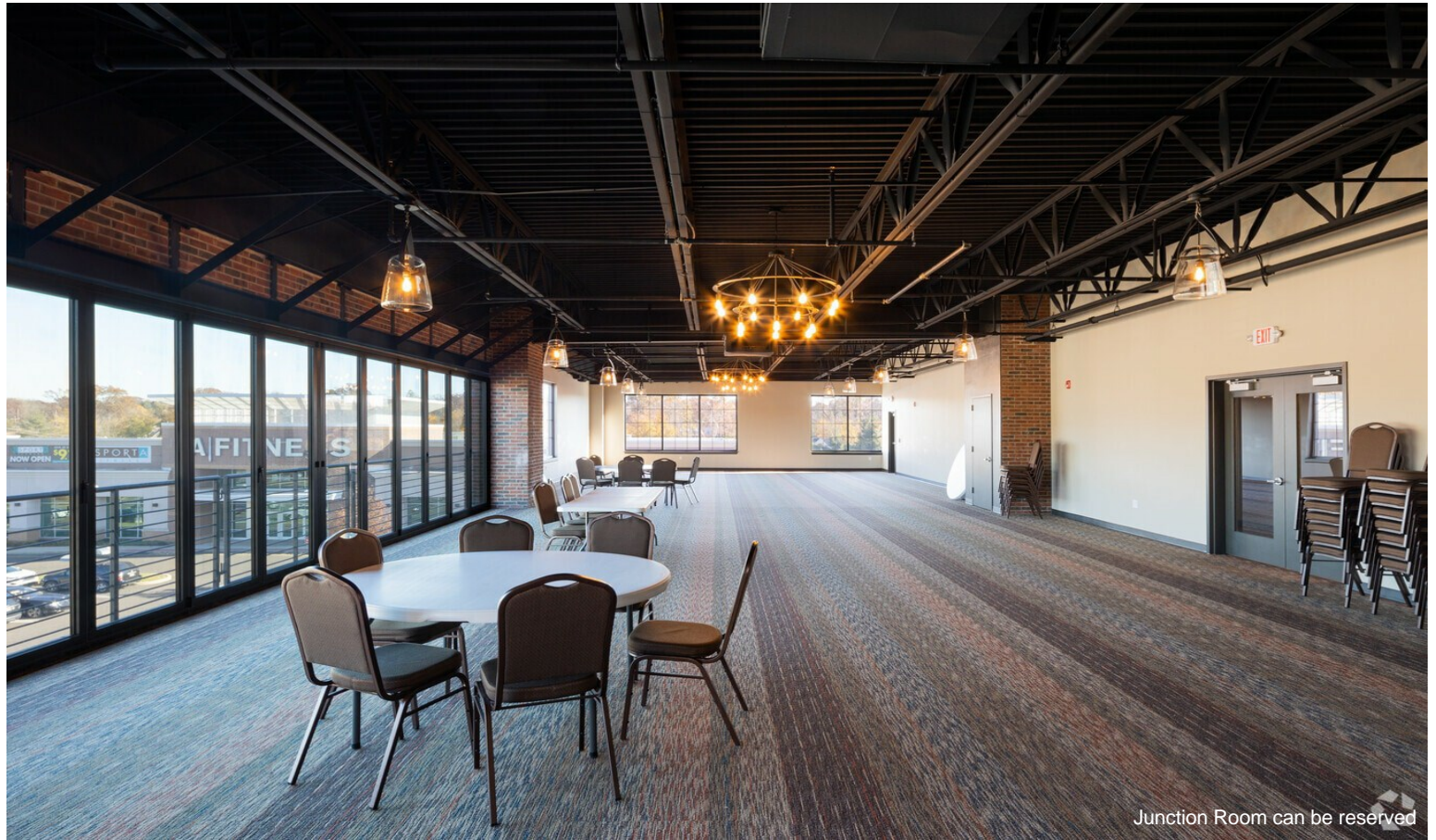

Property Photos

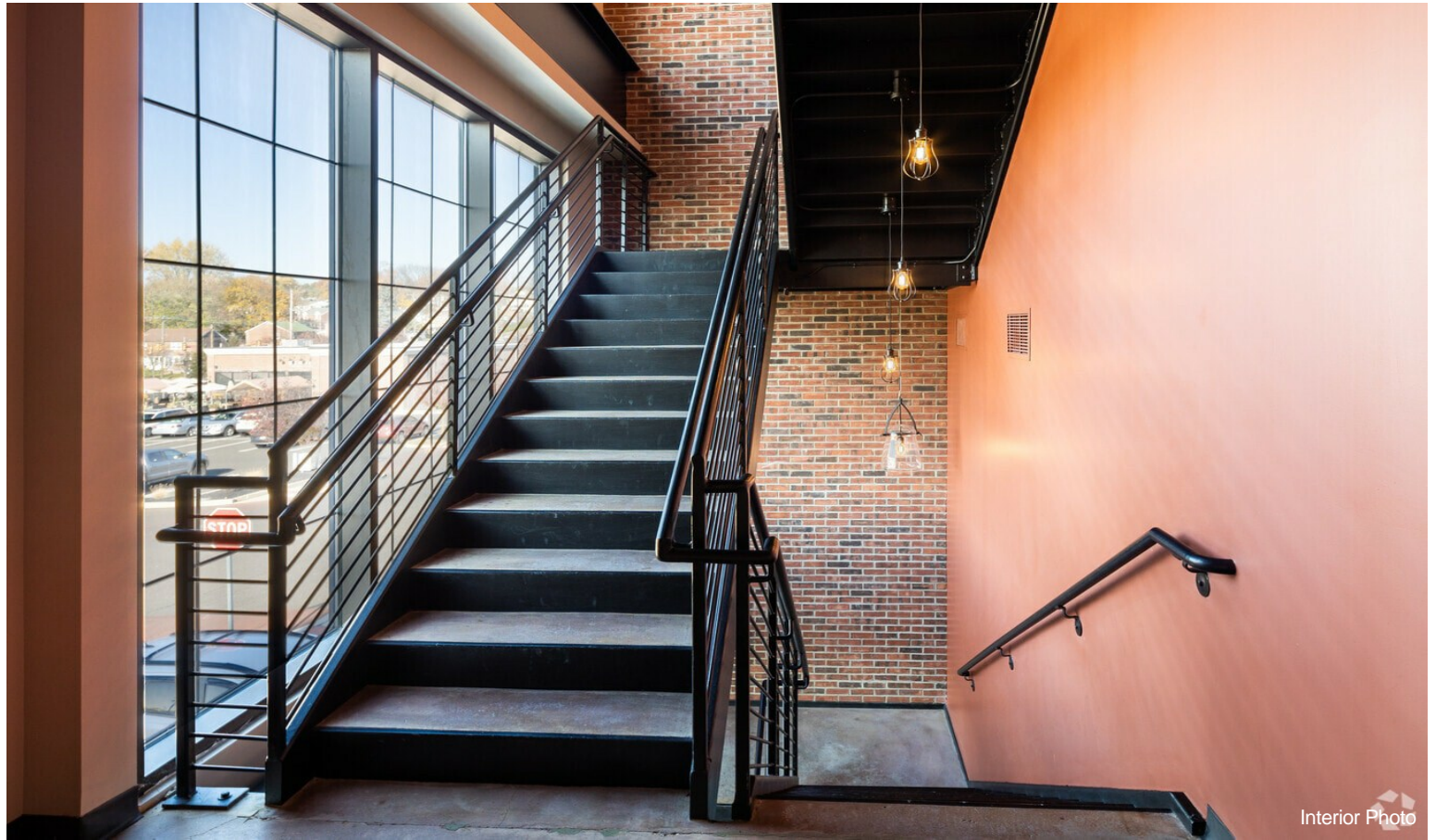

Property Photos

