



| AVAILABLE FOR SALE – 17 ACRES OF COMMERCIALY
ZONED LAND ON LAKE NORMAN |

Mooresville, NC

 **LangTree Lake Norman**
(designates Property of RL West)

DAVIDSON

 **Ingersoll Rand**

 **LangTree**
Lake Norman

Lake Norman

LOWE'S



 **LAKE NORMAN**
REGIONAL MEDICAL CENTER



Lowe's Corporate Headquarters employs nearly 4,000 people in nearly 1.3 million square feet on this impressive office campus. Lowe's is a Fortune 100 Company that is a leader in the sale of hardware and home improvement supplies and operates over 1,800 stores across North America.



Ingersoll-Rand North American Headquarters employs approximately 1,200 people. IR is committed to meeting the world's growing critical need for clean and comfortable air, safe and fresh food, energy efficiency and sustainable business practices through its many brands including Trane, Thermo King and Club Car.



Lake Norman Regional Medical Center employs nearly 1,000 people in its 125 bed acute-care facility and is the core of healthcare in the Mooresville-South Iredell area. Their staff of physicians offers expertise in over 20 specific areas of medical treatment.



Davidson College is a private liberal arts college that employs a combined academic and administrative staff of roughly 750 people and has an enrollment of nearly 1,900 undergraduates. Davidson College has consistently ranked as one of the nation's top liberal arts colleges by the US News and World Report.

MOORESVILLE, NC IS:

20 Minutes from Charlotte, NC
(Charlotte is 2nd fastest growing city in US,
US Census Bureau-2014 Data)

2 Hours from the Blue Ridge Mountains

4 Hours from the Atlantic Coast

Named Race City, USA (NASCAR)

Easily Accessed by I-77; Near I-85 and I-40

Ranked "Best City to Live in NC"
(2014, CreditDonkey.com)



Property Facts

+/- 17 acres zoned Village Center on Lake Davidson/Lake Norman

Direct access off of East/West Connector

E/W Connector is under construction, expected completion in Q3 of 2026

Approximately 1,500 feet of shoreline

Utilities are directly adjacent to the property

AREA MAP AND POTENTIAL SITE PLAN

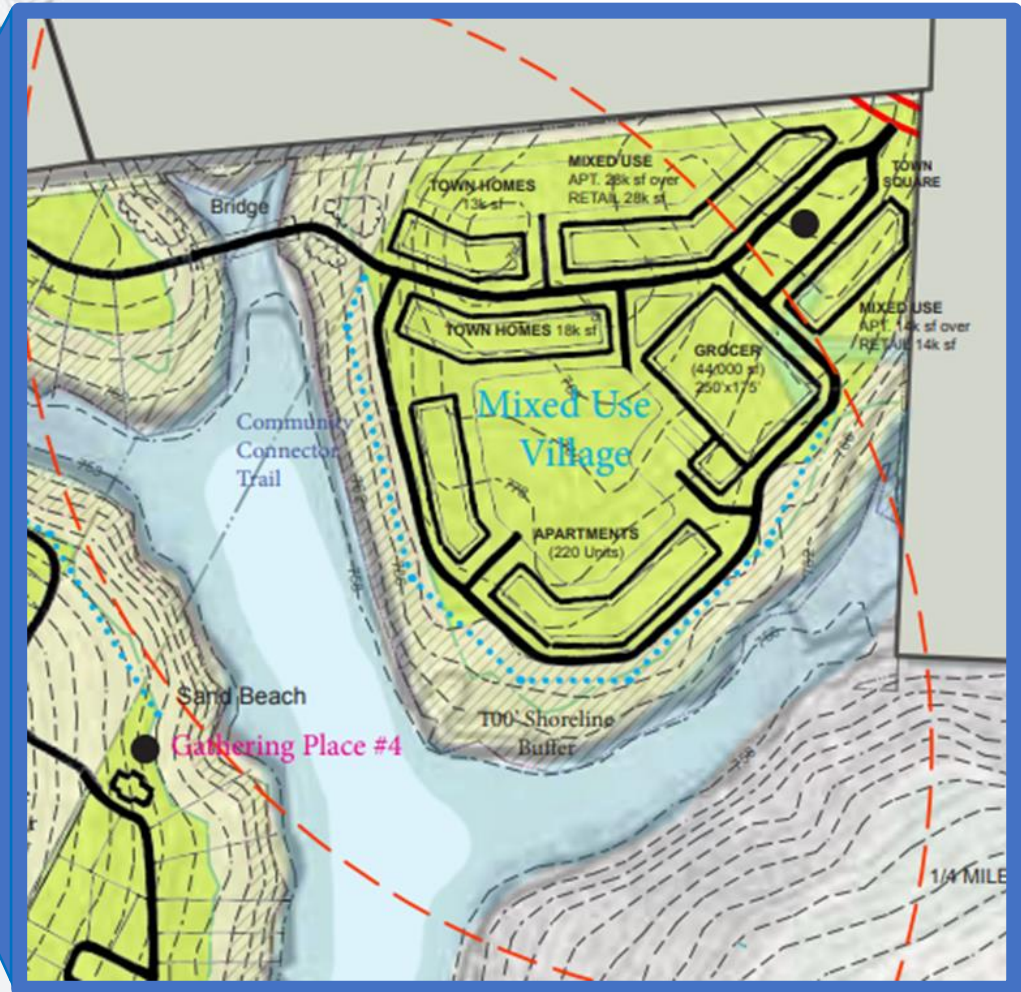
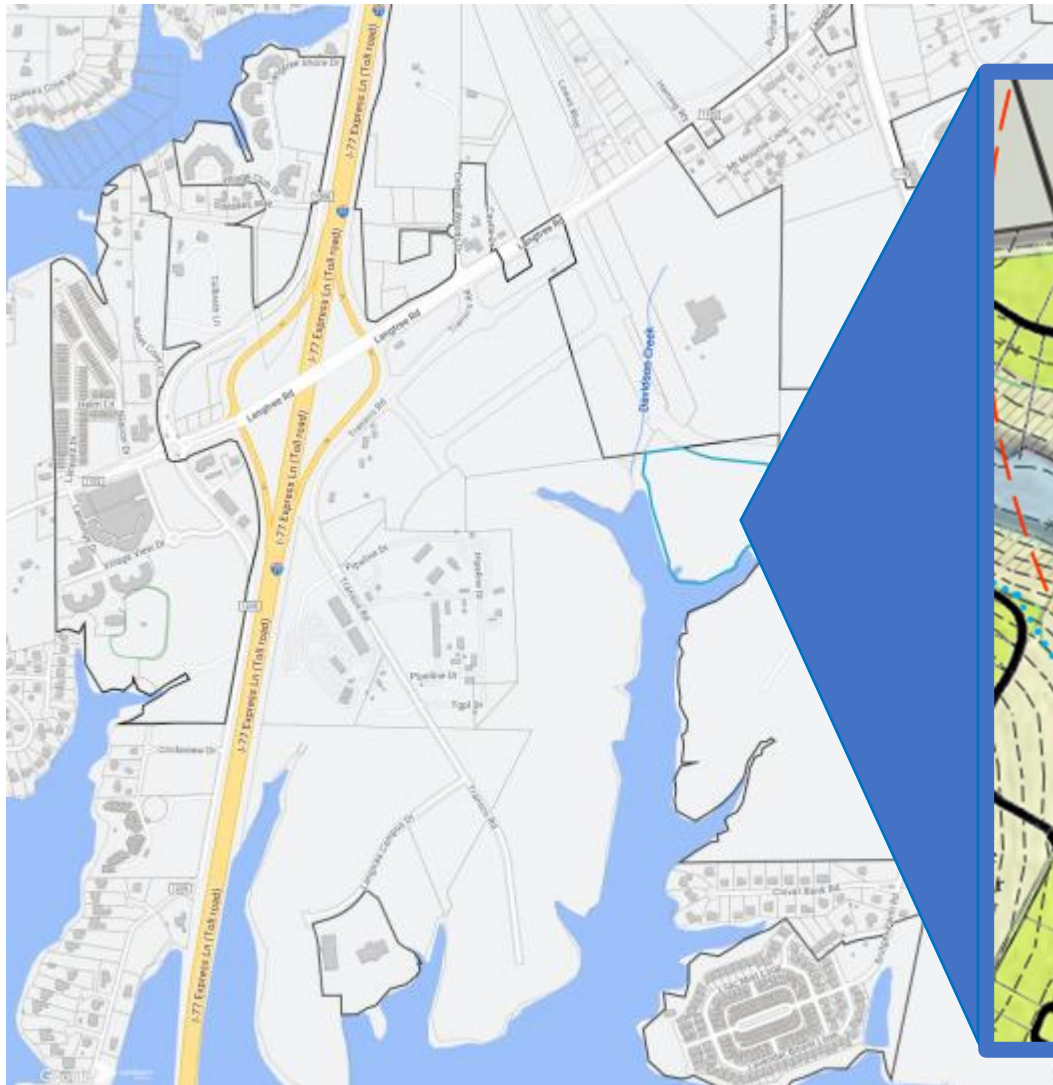

Contact:

Brian Long
Vice President of Sales & Leasing
704.928.7227
blong@rlwest.com