

INDUSTRIAL PROPERTY // FOR SALE

35,600 SF INDUSTRIAL FOR SALE

350 HUBBARD ST
MOUNT CLEMENS, MI 48043



- Size: 35,600 sf with 4,200 sf of Office
- Tenant: Sequoia Tool Inc
- Lease Term: Month-to-Month
- Monthly Lease Rate: \$12,311.66 NNN



26555 Evergreen Road, Suite 1500
Southfield, MI 48076
248.358.0100
pacommercial.com

We obtained the information above from sources we believe to be reliable. However, we have not verified its accuracy and make no guarantee, warranty or representation about it. It is submitted subject to the possibility of errors, omissions, change of price, rental or other conditions, prior sale, lease or financing, or withdrawal without notice. We include projections, opinions, assumptions or estimates for example only, and they may not represent current, past or future performance of the property. You and your tax and legal advisors should conduct your own investigation of the property and transaction.

EXECUTIVE SUMMARY

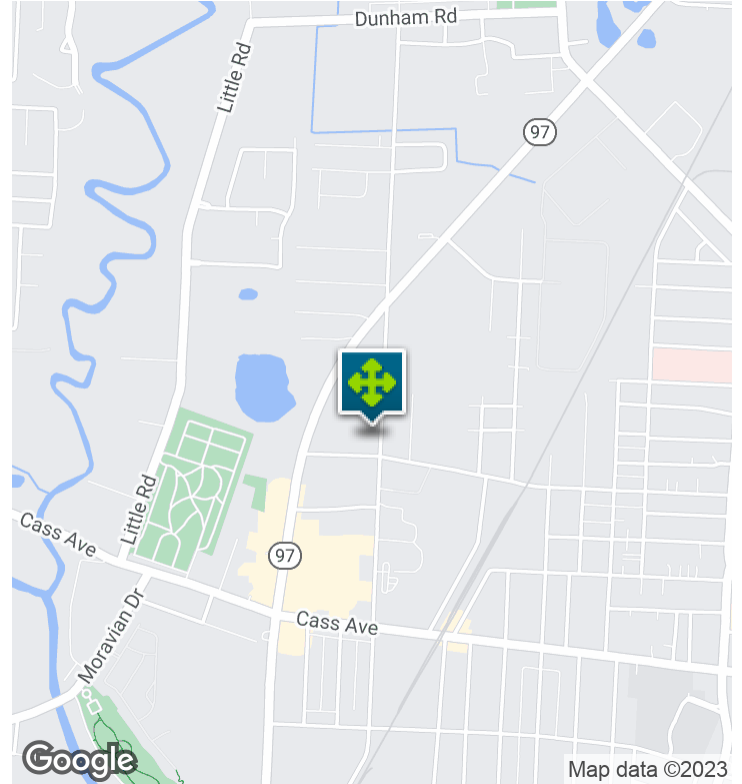

Sale Price	\$2,314,000
-------------------	--------------------

OFFERING SUMMARY

Building Size:	35,600 SF
Available SF:	35,600 SF
Lot Size:	1.18 Acres
Price / SF:	\$65.00
Year Built:	1963
Zoning:	Lt Industrial Hub Zone
Market:	Detroit
Submarket:	Groesbeck North

PROPERTY OVERVIEW

35,600 sf with 4,200 sf of office. 15'-20' clear, 100% fire sprinklered. Double interior truckwell and three (3) - 12'x14' grade level doors. 480 volt/1000 amp, buss duct, airlines, and infered and tube radiant heat. Fenced lot for parking or storage. 1,100 sf breakroom/mezzanine included in total square footage.

Warehouse or manufacturing users, Groesbeck corridor location, Only 2 miles to Hall Road (M-59) and 2.5 mile to I-94. Hub Zone!

LOCATION OVERVIEW

Located just East of Groesbeck Hwy and North of Cass Avenue.

PROPERTY HIGHLIGHTS

- Size: 35,600 sf with 4,200 sf of Office
- Tenant: Sequoia Tool Inc
- Lease Term: Month-to-Month
- Monthly Lease Rate: \$12,311.66 NNN

350 HUBBARD ST, MOUNT CLEMENS, MI 48043 // FOR SALE

INDUSTRIAL DETAILS

Property Type:	Industrial
Building Size:	35,600 SF
Mezzanine SF:	\$2,314,000
Occupancy:	30-60 Days
Zoning:	Lt Industrial Hub Zone
Lot Size:	1.18 Acres
Parking Spaces:	50
Fenced Yard:	Yes
Year Built / Renovated:	1963 / 1965
Construction Type:	Block/Brick
Clear Height:	15' - 20'
Overhead Doors:	(3) - 12' x 14'
Truckwells/Docks:	(2) Interior
Cranes:	None
Power:	480 Volt 1,000 AMP
Buss Duct:	Yes
Air Conditioning:	Office & 11,000 SF of Shop
Heat Type:	Gas Unit, Infrared Tube Type
Lighting:	Fluorescent
Sprinklers:	100%
Taxes:	\$17,978.38



P.A. COMMERCIAL
Corporate & Investment Real Estate

John T. Arthurs PRINCIPAL
D: 248.663.0506 | C: 248.563.3225
johna@pacommercial.com

We obtained the information above from sources we believe to be reliable. However, we have not verified its accuracy and make no guarantee, warranty or representation about it. It is submitted subject to the possibility of errors, omissions, change of price, rental or other conditions, prior sale, lease or financing, or withdrawal without notice. We include projections, opinions, assumptions or estimates for example only, and they may not represent current, past or future performance of the property. You and your tax and legal advisors should conduct your own investigation of the property and transaction.

350 HUBBARD ST, MOUNT CLEMENS, MI 48043 // FOR SALE

ADDITIONAL PHOTOS

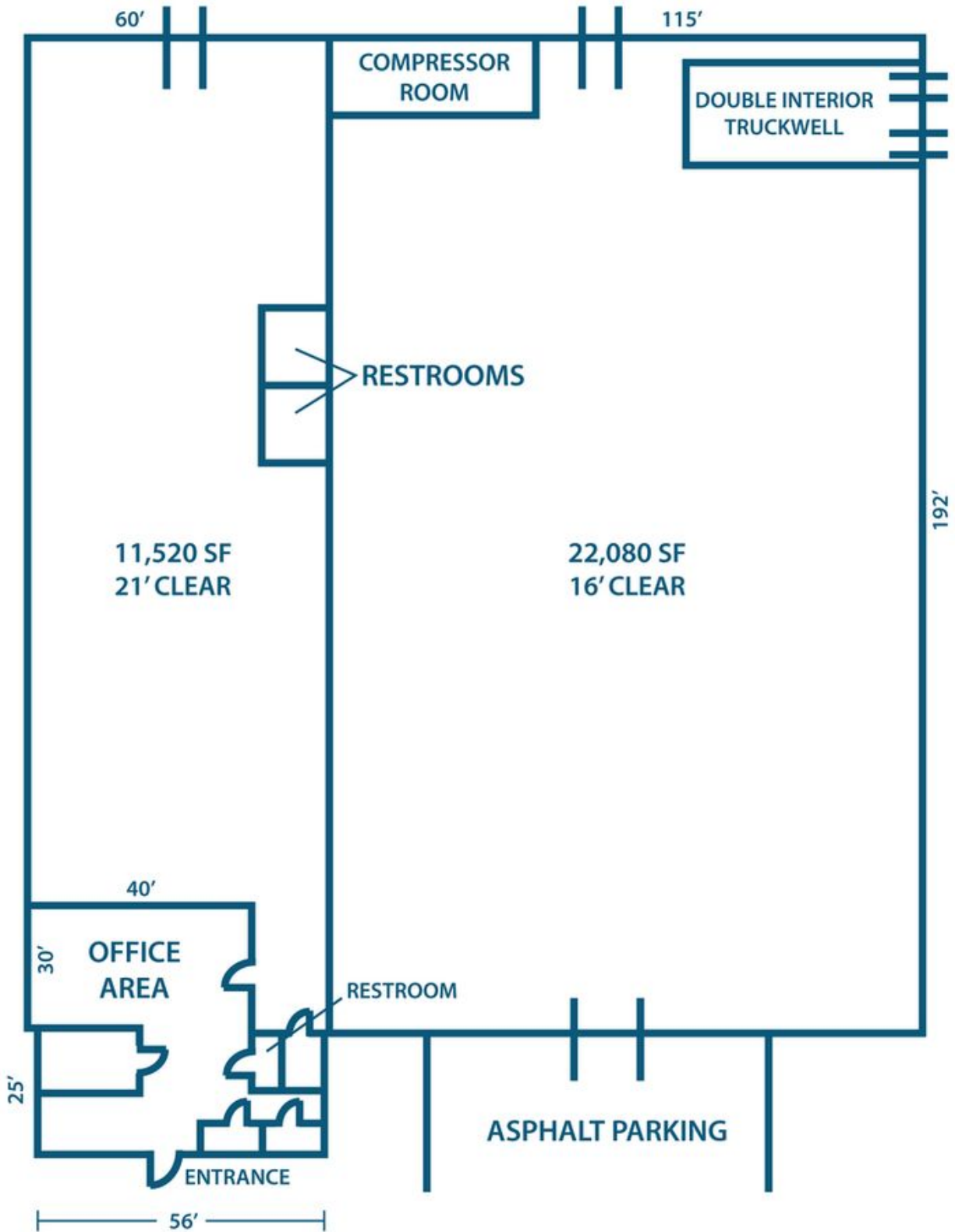

350 HUBBARD ST, MOUNT CLEMENS, MI 48043 // FOR SALE

AERIAL MAP

FOR SALE



Google

Imagery ©2023 CNES / Airbus, Maxar Technologies, U.S. Geological Survey



P.A. COMMERCIAL
Corporate & Investment Real Estate

John T. Arthurs PRINCIPAL

D: 248.663.0506 | C: 248.563.3225

johna@pacommercial.com

We obtained the information above from sources we believe to be reliable. However, we have not verified its accuracy and make no guarantee, warranty or representation about it. It is submitted subject to the possibility of errors, omissions, change of price, rental or other conditions, prior sale, lease or financing, or withdrawal without notice. We include projections, opinions, assumptions or estimates for example only, and they may not represent current, past or future performance of the property. You and your tax and legal advisors should conduct your own investigation of the property and transaction.

350 HUBBARD ST, MOUNT CLEMENS, MI 48043 // FOR SALE

LOCATION MAP

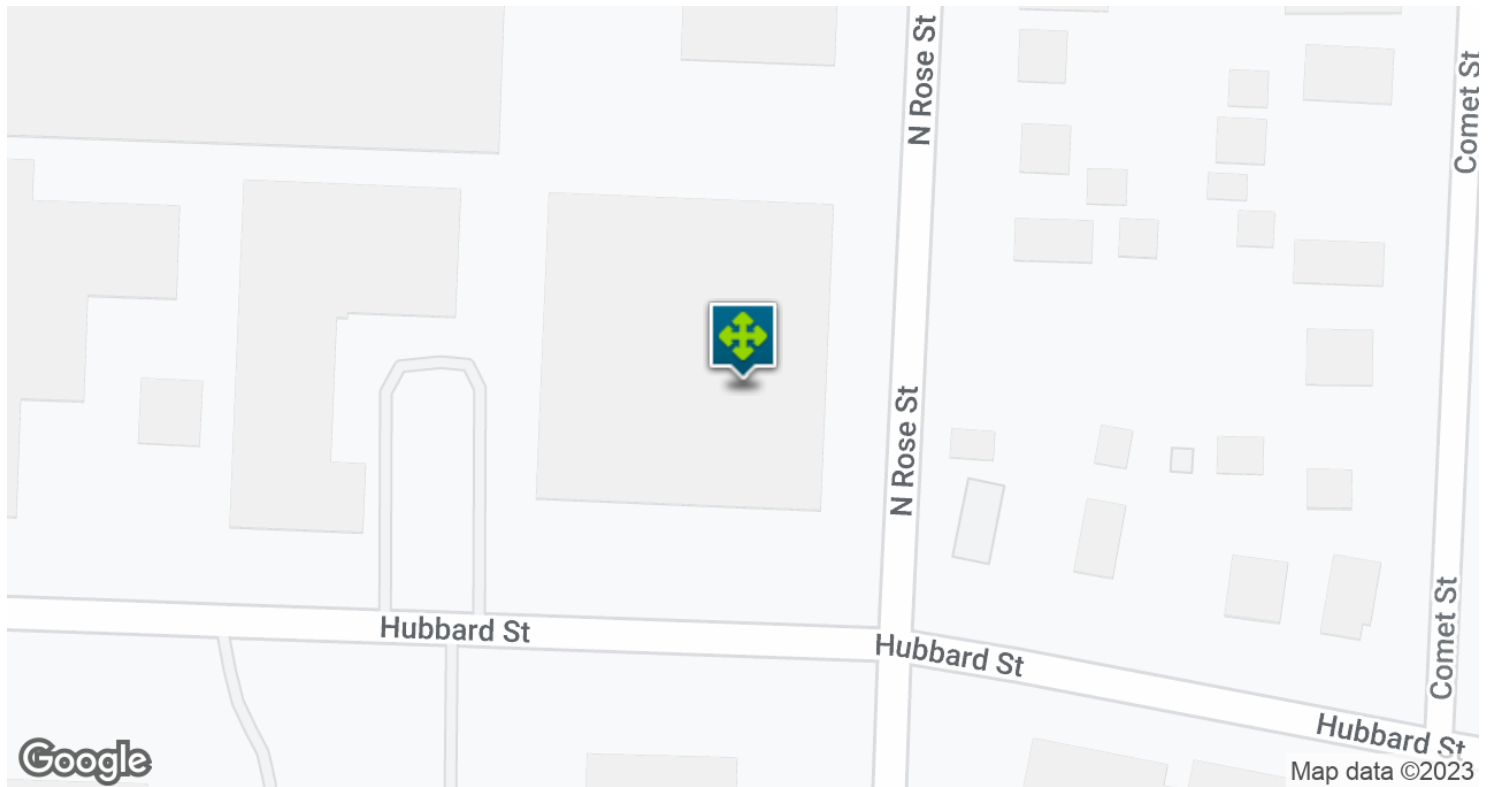

DEMOGRAPHICS MAP & REPORT

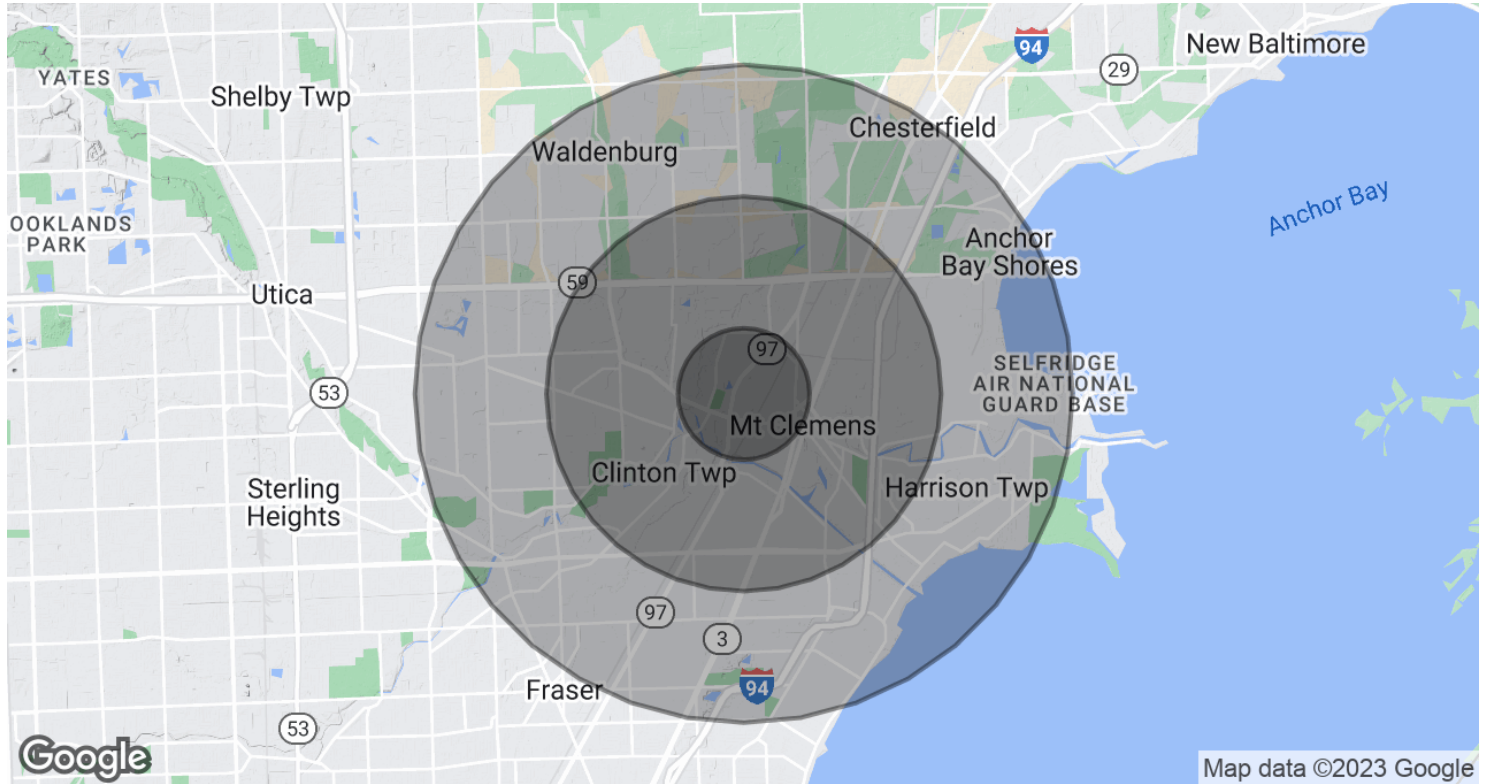

POPULATION	1 MILE	3 MILES	5 MILES
Total Population	10,832	86,344	228,108
Average Age	35.1	39.2	39.1
Average Age (Male)	33.2	37.9	37.6
Average Age (Female)	38.6	40.2	40.1
HOUSEHOLDS & INCOME	1 MILE	3 MILES	5 MILES
Total Households	3,961	35,516	93,109
# of Persons per HH	2.7	2.4	2.4
Average HH Income	\$56,833	\$61,665	\$64,906
Average House Value		\$142,254	\$167,454

* Demographic data derived from 2020 ACS - US Census

350 HUBBARD ST, MOUNT CLEMENS, MI 48043 // FOR SALE

CONTACT US



FOR MORE INFORMATION, PLEASE CONTACT:



John T. Arthurs

PRINCIPAL

D: 248.663.0506

C: 248.563.3225

johna@pacommercial.com

P.A. Commercial

26555 Evergreen Road, Suite 1500

Southfield, MI 48076

P: 248.358.0100

F: 248.358.5300

pacommercial.com

Follow Us!



We obtained the information above from sources we believe to be reliable. However, we have not verified its accuracy and make no guarantee, warranty or representation about it. It is submitted subject to the possibility of errors, omissions, change of price, rental or other conditions, prior sale, lease or financing, or withdrawal without notice. We include projections, opinions, assumptions or estimates for example only, and they may not represent current, past or future performance of the property. You and your tax and legal advisors should conduct your own investigation of the property and transaction.