



FOR SUBLEASE 11,288 SF

# CHARLOTTE DISTRIBUTION CENTER 4

2217 Distribution Center Dr, Charlotte, NC





# PROPERTY HIGHLIGHTS

## BUILDING 4 | SUITE D

AVAILABLE IMMEDIATELY  
TERM THROUGH 5/31/2027



- Immediate Access to I-77 and I-85
- 10 Minutes to Charlotte Douglass International Airport



# PROPERTY INFORMATION

## BUILDING 4 | SUITE D

Building Size: 57,600 SF

Space Available: 11,288 SF

Office Area: 1,724 SF

Site Area: 42.26 AC lot

Clear Height: 22'

Dock High: 2

Drive-In: 1

Bay Size: 40' x 40'

Sprinkler: ESFR

Lighting: LED

Zoning: I-1 (CD)





## BUILDING 4 | SUITE D

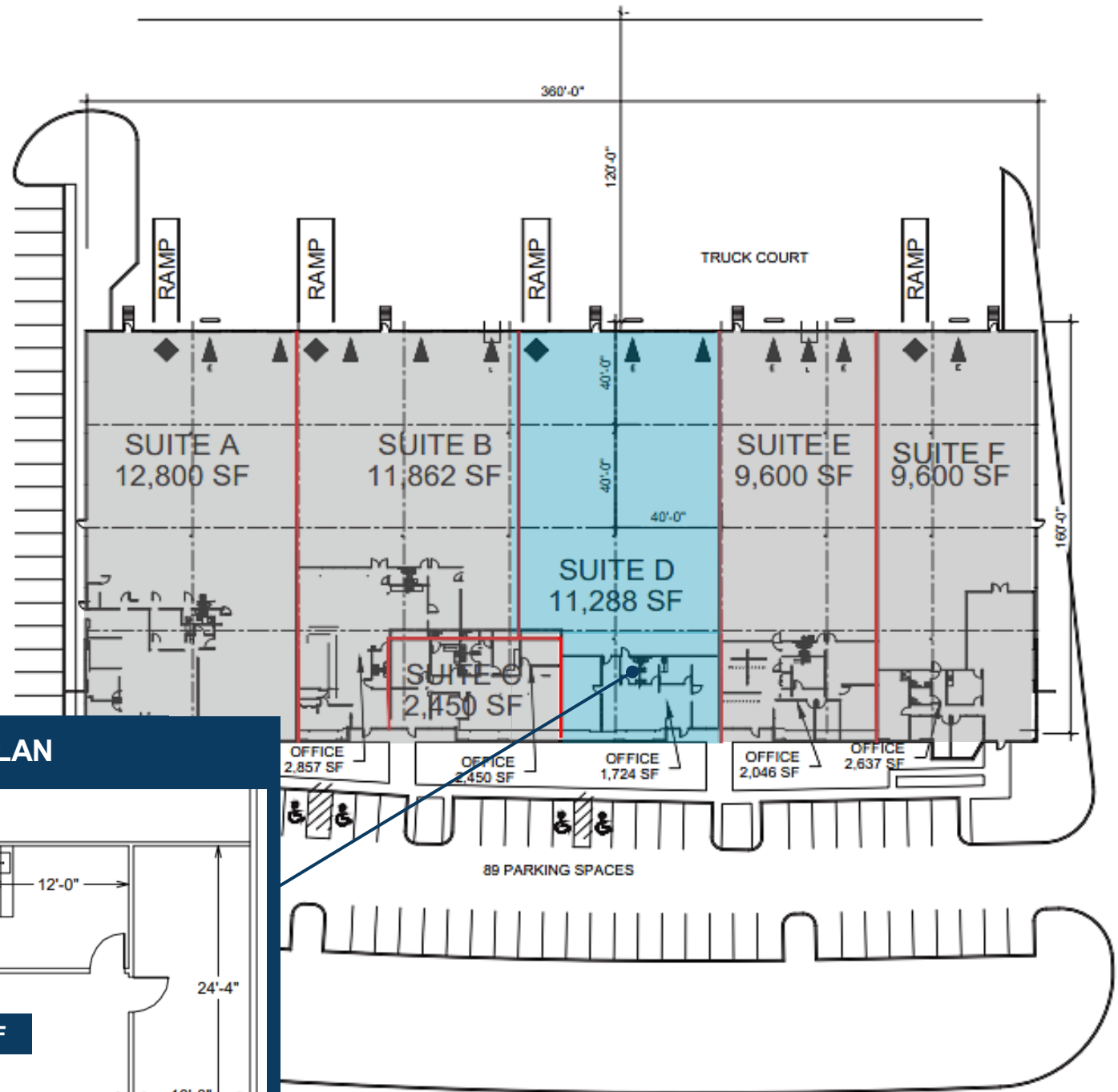

## OFFICE FLOORPLAN

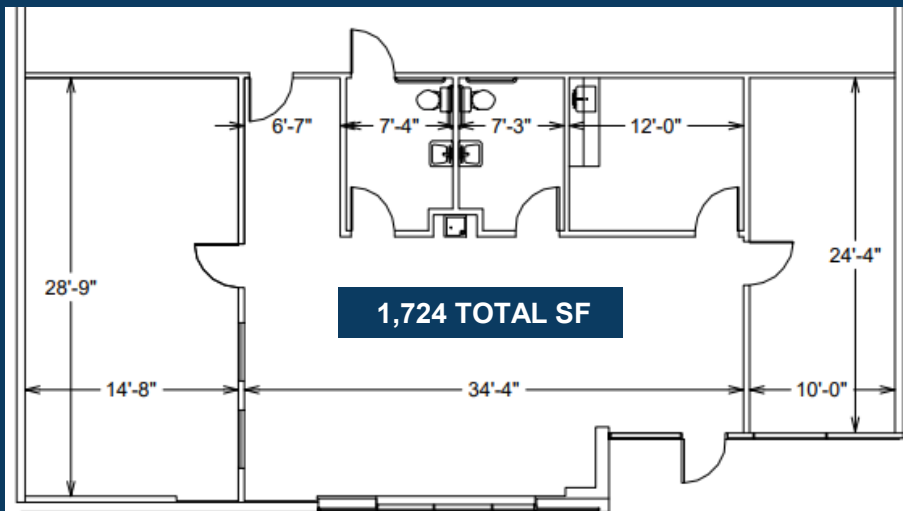





**FOR MORE INFORMATION, CONTACT:**

**FRANCES CRISLER**

Director

+1 704 620 6014

[frances.crisler@cushwake.com](mailto:frances.crisler@cushwake.com)

**ERIN TURULSKI**

Senior Associate

+1 704 916 1565

[erin.turulski@cushwake.com](mailto:erin.turulski@cushwake.com)

©2020 Cushman & Wakefield. All rights reserved. The material in this presentation has been prepared solely for information purposes, and is strictly confidential. Any disclosure, use, copying or circulation of this presentation (or the information contained within it) is strictly prohibited, unless you have obtained Cushman & Wakefield's prior written consent. The views expressed in this presentation are the views of the author and do not necessarily reflect the views of Cushman & Wakefield. Neither this presentation nor any part of it shall form the basis of, or be relied upon in connection with any offer, or act as an inducement to enter into any contract or commitment whatsoever. NO REPRESENTATION OR WARRANTY IS GIVEN, EXPRESS OR IMPLIED, AS TO THE ACCURACY OF THE INFORMATION CONTAINED WITHIN THIS PRESENTATION, AND CUSHMAN & WAKEFIELD IS UNDER NO OBLIGATION TO SUBSEQUENTLY CORRECT IT IN THE EVENT OF ERRORS.



**CUSHMAN &  
WAKEFIELD**