

GLENDALE

CORPORATE CENTER

5281 - 5323 NORTH 99TH AVENUE
GLENDALE, ARIZONA



CLASS A
PREMIUM OFFICE SPACE

CBRE

PROPERTY HIGHLIGHTS

- Five-building complex
- 5:1,000 parking including covered, reserved; additional parking available
- Cox Communications and Lumen Technologies available



LOCATION AMENITIES

- Located in one of the Valley's fastest growing cities
- Numerous restaurants, hotels, and new retail centers nearby
- ±20 minutes from Phoenix Sky Harbor International Airport
- Great freeway access to the Loop 101 Freeway
- Corporate neighbors include Bechtel Corporation, West-MEC, and SunWest Federal Credit Union headquarters



LOCATED WITHIN MINUTES OF:

- *State Farm Stadium*
- *Westgate Entertainment District*
- *Topgolf Glendale*
- *VAI Resort*
- *Mattel Adventure Park*
- *PopStroke*
- *Desert Diamond Arena*
- *Andretti Indoor Karting*
- *Chicken N Pickle*
- *Comfort Suites*
- *Holiday Inn*
- *Renaissance Glendale Hotel & Conference Center*

FLOOR PLAN

5323 N 99TH AVE

SUITE 210

±9,117 SF | Available 3/1/2026

SUITE 215

±9,000 SF | Available Now

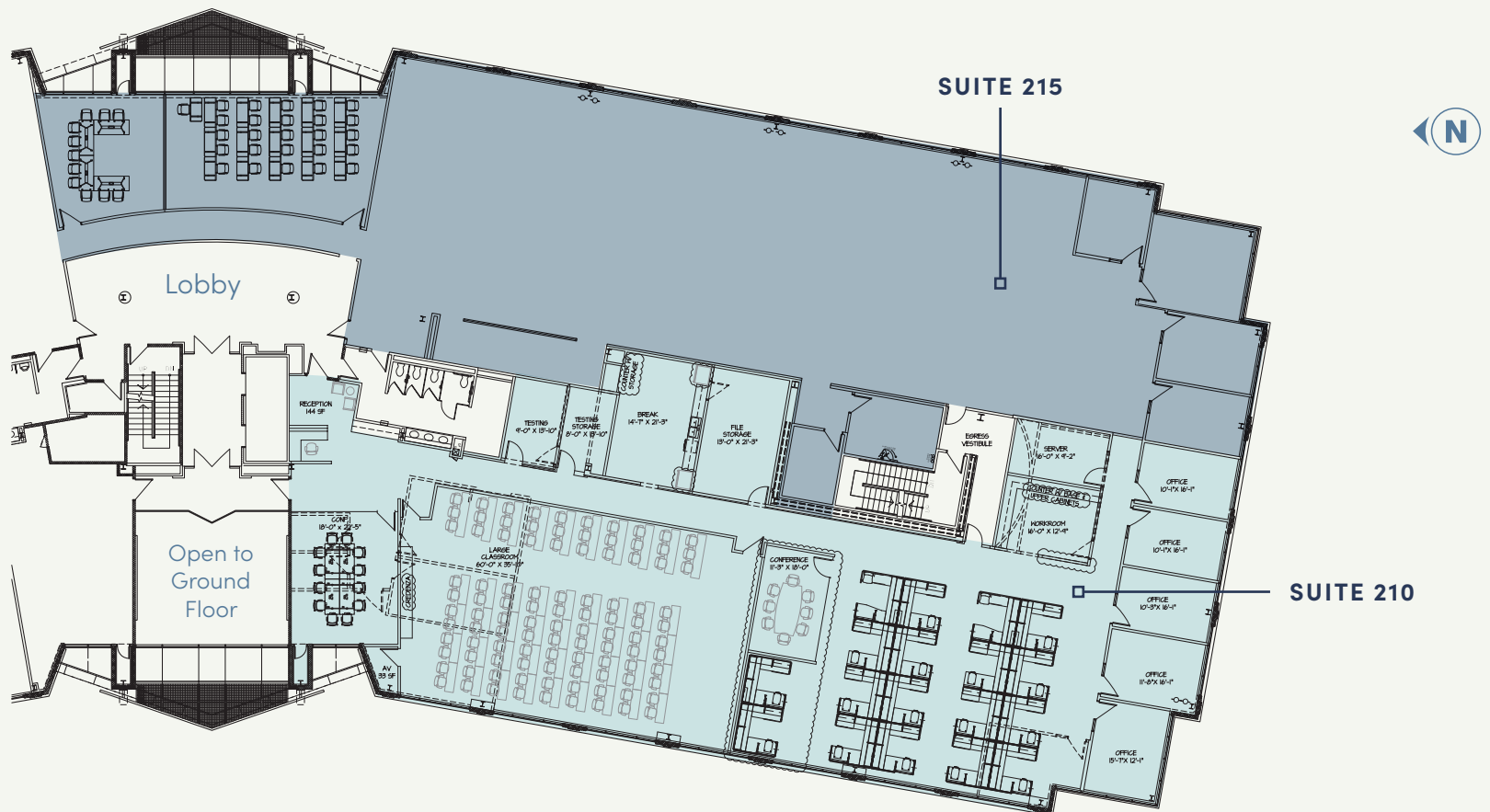



CONTACT

ASHLEY BROOKS, JR.

Senior Vice President

+1 602 735 1758

ashley.brooks@cbre.com

JASMINA BAYS

Client Services Specialist

+1 602 735 5262

jasmina.bays@cbre.com

MELCOR
CBRE

© 2025 CBRE, Inc. All rights reserved. This information has been obtained from reliable sources but has not been verified for accuracy or completeness. CBRE, Inc. makes no guarantee, representation, or warranty and accepts no responsibility or liability for the accuracy, completeness, or reliability of the information contained herein. You should conduct a careful, independent investigation of the property and verify all information. Any reliance on this information is solely at your own risk. CBRE and the CBRE logo are service marks of CBRE, Inc. All other marks displayed on this document are the property of their respective owners, and the use of such marks does not imply any affiliation with or endorsement of CBRE. Photos herein are the property of their respective owners. Use of these images without the express written consent of the owner is prohibited.