

# 80 13th Avenue: Unit 3

RONKONKOMA, NEW YORK

SUBLEASE: 7,500 SF Industrial Unit | 5,500 SF and 2,000 SF Divisions possible

 **PREMIER**  
COMMERCIAL REAL ESTATE

*"Complex Issues – Simple Solutions"*

**Major Price Reduction!**  
**~~\$16.50 PSF~~ \$14.00 PSF!**



**FOR INFORMATION CONTACT EXCLUSIVE BROKERS:**

**Desmond Mullins, Senior Director | [dmullins@pcrellc.com](mailto:dmullins@pcrellc.com) | 631-398-5654**

**PREMIER COMMERCIAL RE LLC**  
500 N. Broadway, Suite 105  
Jericho, NY 11753  
Tel. 516-284-8000 | [www.pcrellc.com](http://www.pcrellc.com)

All information is from sources deemed reliable and is provided subject to errors, omissions, change of price or other terms and conditions, prior to sale, lease, or withdrawal without notice. Such information may not have been verified and no express representations are hereby made.



# 80 13th Avenue: Unit 3

RONKONKOMA, NEW YORK

**SUBLEASE: 7,500 SF Industrial Unit | 5,500 SF and 2,000 SF Divisions possible**

## PROPERTY SPECIFICATIONS:

Total Unit Size: +/- 7,500 SF

Total Office: +/- 1,500 SF

Loading Docks: 1

Drive Ins: 2

**Division A:** +/- 5,500 SF

+/- 1,500 SF Office

1 Loading Dock, 1 Drive-in

**Division B:** +/- 2,000 SF

1 Drive-in

Ceiling Height: 18' Clear

Heat: Gas

Parking: Ample

Zoning: IND1

## PROPERTY HIGHLIGHTS:

- o Ideal for a variety of distribution and manufacturing uses
- o Very clean industrial unit
- o Long or short rental term options available
- o Approx. 2 Miles from Exit 59 of the Long Island Expressway, Macarthur Airport, and the new Ronkonkoma "Station Yards" Hub.

[CLICK HERE FOR A VIRTUAL TOUR!](#)

## PRICING:

\*Asking Rent: ~~\$16.50~~ PSF Modified Gross

**\$14.00 PSF Modified Gross**

## FOR INFORMATION CONTACT EXCLUSIVE BROKERS:

**Desmond Mullins, Senior Director | dmullins@pcrellc.com | 631-398-5654**

**PREMIER COMMERCIAL RE LLC**  
500 N. Broadway, Suite 105  
Jericho, NY 11753  
Tel. 516-284-8000 | [www.pcrellc.com](http://www.pcrellc.com)

# 80 13th Avenue: Unit 3

RONKONKOMA, NEW YORK

SUBLEASE: 7,500 SF Industrial Unit | 5,500 SF and 2,000 SF Divisions possible

**PREMIER**  
COMMERCIAL REAL ESTATE

"Complex Issues – Simple Solutions"

## INTERIOR, EXTERIOR AND FLOOR PLAN:

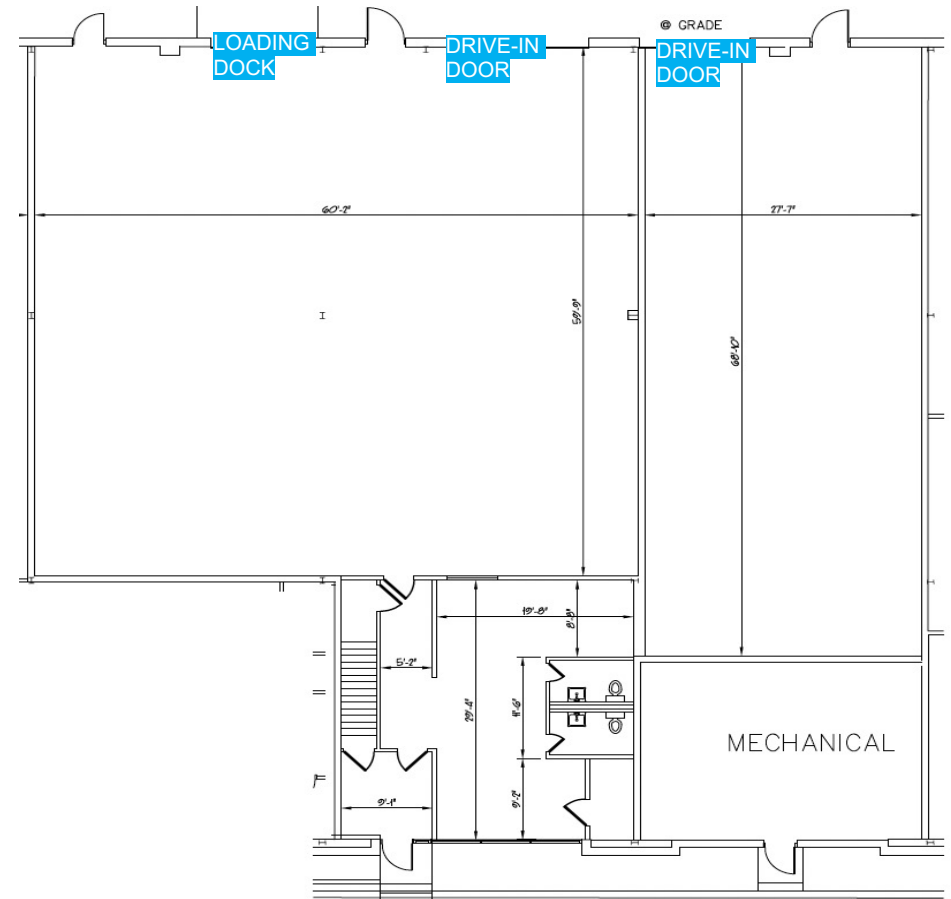

① EXISTING 1ST FLR PLAN  
SCALE: HTS

## FOR INFORMATION CONTACT EXCLUSIVE BROKERS:

Desmond Mullins, Senior Director | [dmullins@pcrellc.com](mailto:dmullins@pcrellc.com) | 631-398-5654

**PREMIER COMMERCIAL RE LLC**  
500 N. Broadway, Suite 105  
Jericho, NY 11753  
Tel. 516-284-8000 | [www.pcrellc.com](http://www.pcrellc.com)

All information is from sources deemed reliable and is provided subject to errors, omissions, change of price or other terms and conditions, prior to sale, lease, or withdrawal without notice. Such information may not have been verified and no express representations are hereby made.



# 80 13th Avenue: Unit 3

RONKONKOMA, NEW YORK

SUBLEASE: 7,500 SF Industrial Unit | 5,500 SF and 2,000 SF Divisions possible

**PREMIER**  
COMMERCIAL REAL ESTATE

"Complex Issues – Simple Solutions"

## Map:

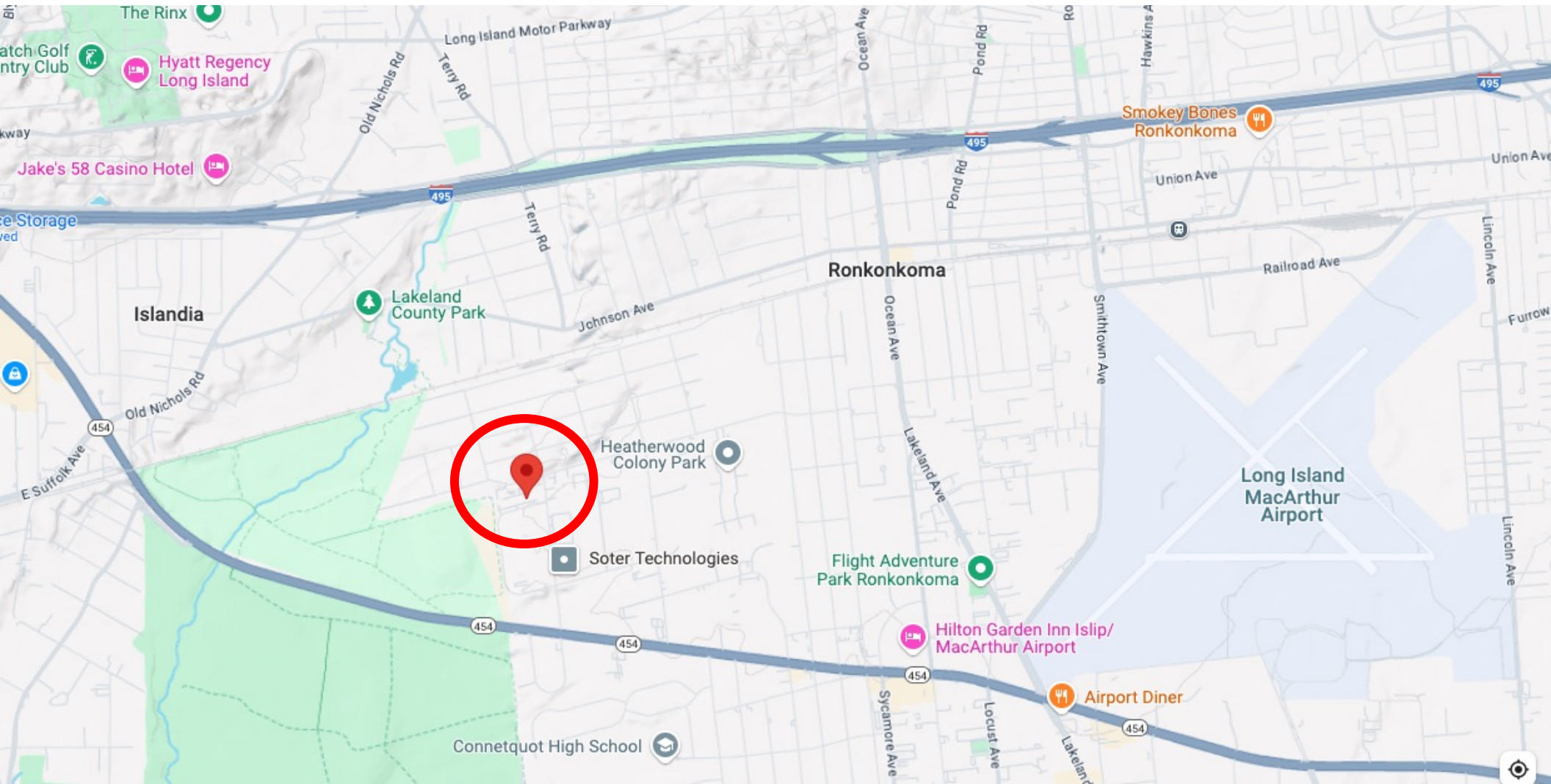

**FOR INFORMATION CONTACT EXCLUSIVE BROKERS:**

**Desmond Mullins, Senior Director | [dmullins@pcrellc.com](mailto:dmullins@pcrellc.com) | 631-398-5654**

**PREMIER COMMERCIAL RE LLC**  
500 N. Broadway, Suite 105  
Jericho, NY 11753  
Tel. 516-284-8000 | [www.pcrellc.com](http://www.pcrellc.com)

All information is from sources deemed reliable and is provided subject to errors, omissions, change of price or other terms and conditions, prior to sale, lease, or withdrawal without notice. Such information may not have been verified and no express representations are hereby made.