

# 15,000 SF Available

USDA Approved Food Processing Facility

12 Cedar Court  
Union, MO 63084  
[www.cbre.com/stlouis](http://www.cbre.com/stlouis)

Lease Rate: \$7.95/SF, NNN



# 15,000 Food Processing Facility

12 Cedar Court | Union, MO 63084

For Lease

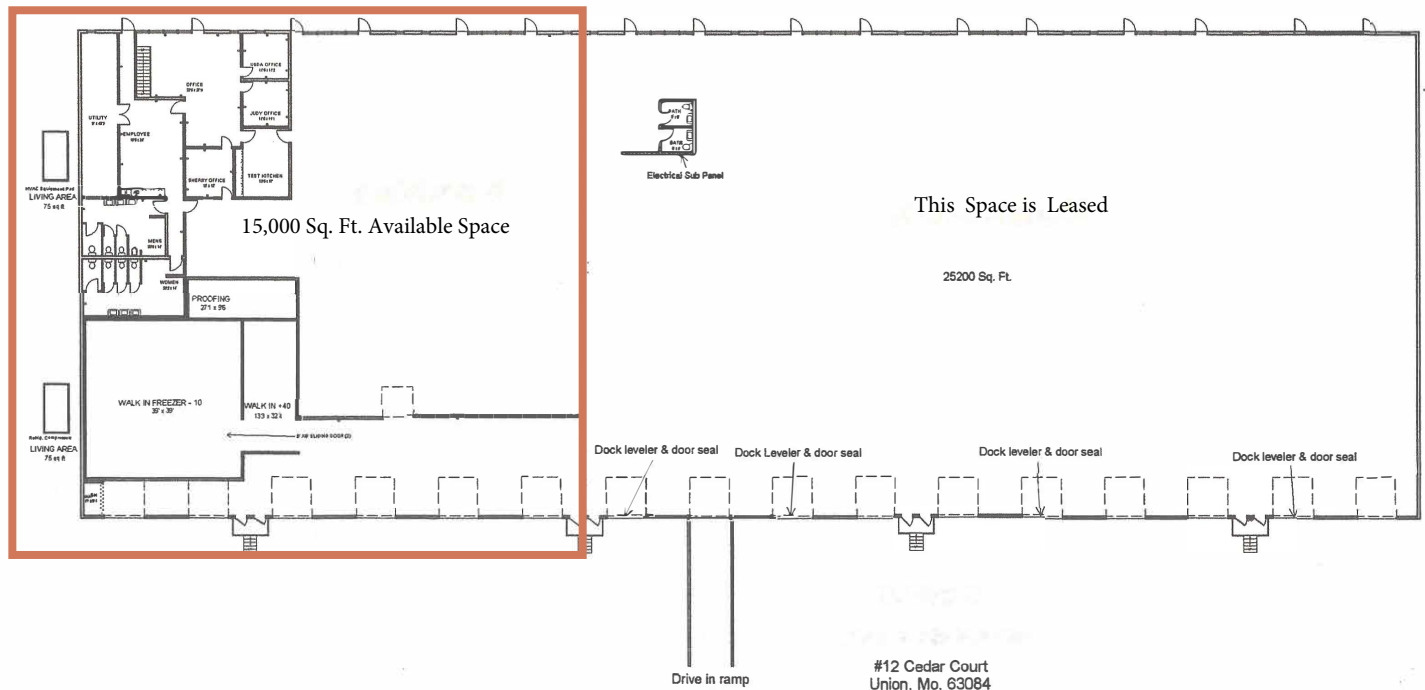

## Property Details

- + Approximately 3,000 SF office on two levels
- + 5 loading docks with ample truck parking
- + 3 ADA restrooms
- + 12' ceilings in production area
- + 20' ceilings in warehouse area
- + 400 amps, 3 phase power
- + Fully sprinklered building
- + 830 SF cooler
- + 1,600 SF freezer (-30° special sub-floor and racking)
- + Large floor drains
- + Additional plumbing
- + Washable surfaces
- + 2 kitchens: test kitchen and employee break room kitchen
- + Climate controlled
- + Production lighting
- + Lease rate: \$7.95/SF, NNN



## Property Photos





# 15,000 Food Processing Facility

12 Cedar Court | Union, MO 63084

For Lease

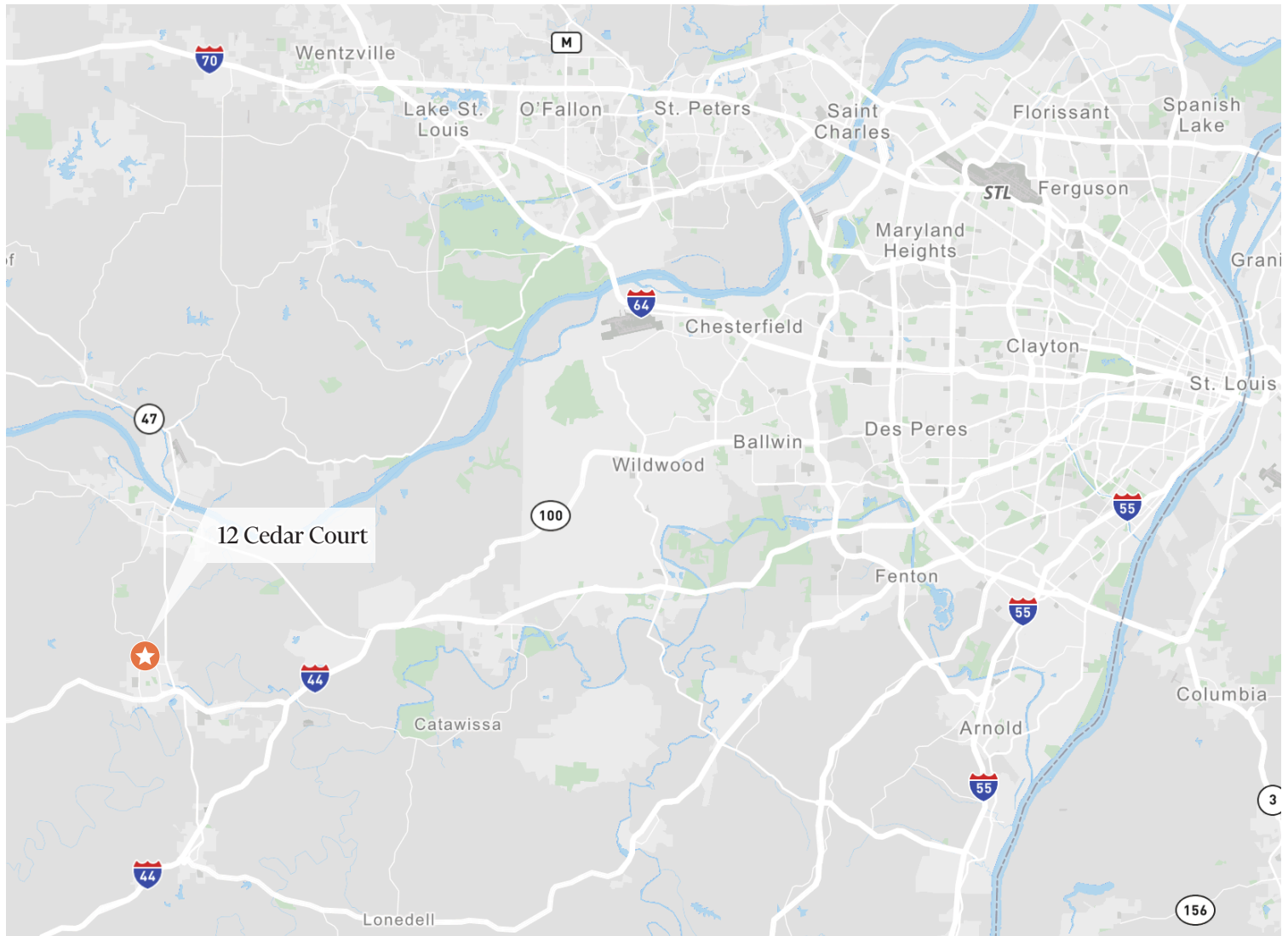

## Contact Info

### John Frith

Senior Associate

+1 314 655 6096

john.frith@cbre.com

### Dave Randolph

First Vice President

+1 314 655 6006

dave.randolph@cbre.com

© 2025 CBRE, Inc. All rights reserved. This information has been obtained from sources believed reliable, but has not been verified for accuracy or completeness. You should conduct a careful, independent investigation of the property and verify all information. Any reliance on this information is solely at your own risk. CBRE and the CBRE logo are service marks of CBRE, Inc. All other marks displayed on this document are the property of their respective owners, and the use of such logos does not imply any affiliation with or endorsement of CBRE. Photos herein are the property of their respective owners. Use of these images without the express written consent of the owner is prohibited.