



**2,241 SF**  
Former Bluemercury

**STREET RETAIL SPACE**

**82 ELM  
STREET**

Located in Downtown Westfield

**WESTFIELD**  
NEW JERSEY



**RIPCO**  
REAL ESTATE



SPACE DETAILS

GROUND FLOOR

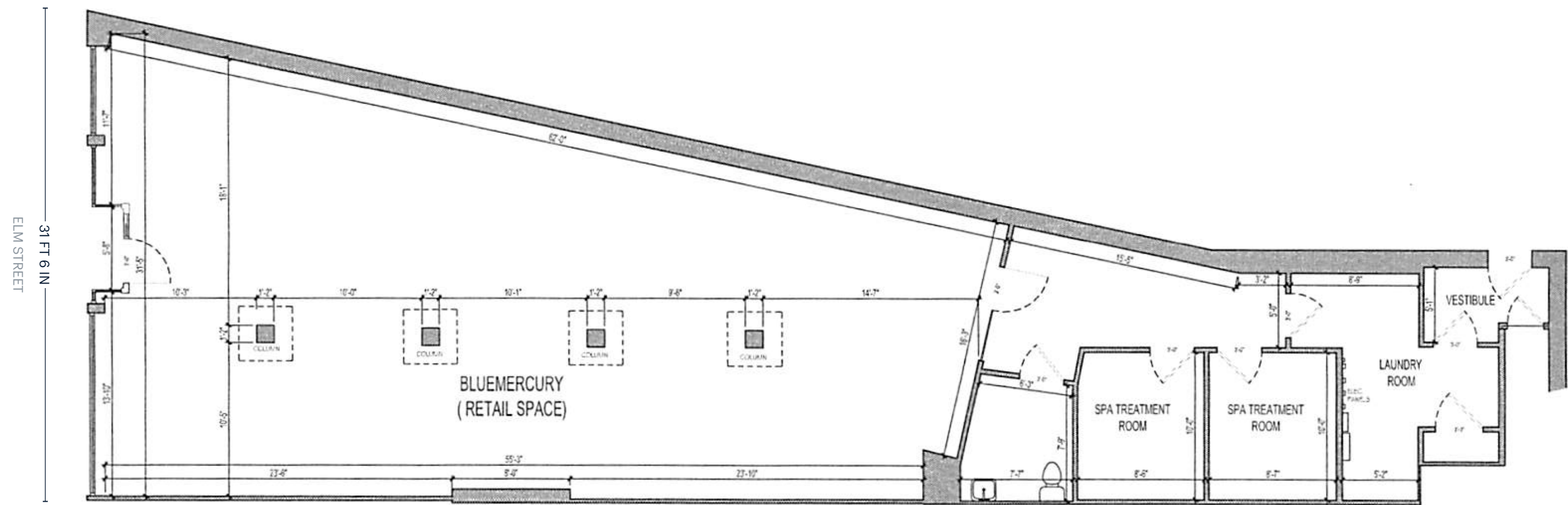

**LOCATION**  
Prominent position on Elm Street near the corner of Broad Street

**SIZE**  
Ground Floor      2,241 SF

**STATUS**  
Formerly Bluemercury

**FRONTAGE**  
Elm Street      31 FT 6 IN

**TERM**  
10 years

**RENT**  
Upon request

**NEIGHBORS**  
QDOBA Mexican Eats, Trader Joe’s, Starbucks, Athleta, Warby Parker, Casa di Pizza, J. McLaughlin, Urban Outfitters, Sweet Waters Steakhouse, Sugaring NYC, sweetgreen, GAP, StretchLab, Faherty, Rumble, Banana Republic, 2nd Street, Chipotle, Millburn Deli

**COMMENTS**  
Prime opportunity coming soon to one of Westfield’s most sought after blocks  
  
Central location surrounded by national retailers with excellent visibility from Westfield’s main signaled intersection  
  
Exceptional demographics in the surrounding area



AREA NEIGHBORS





MARKET AERIAL

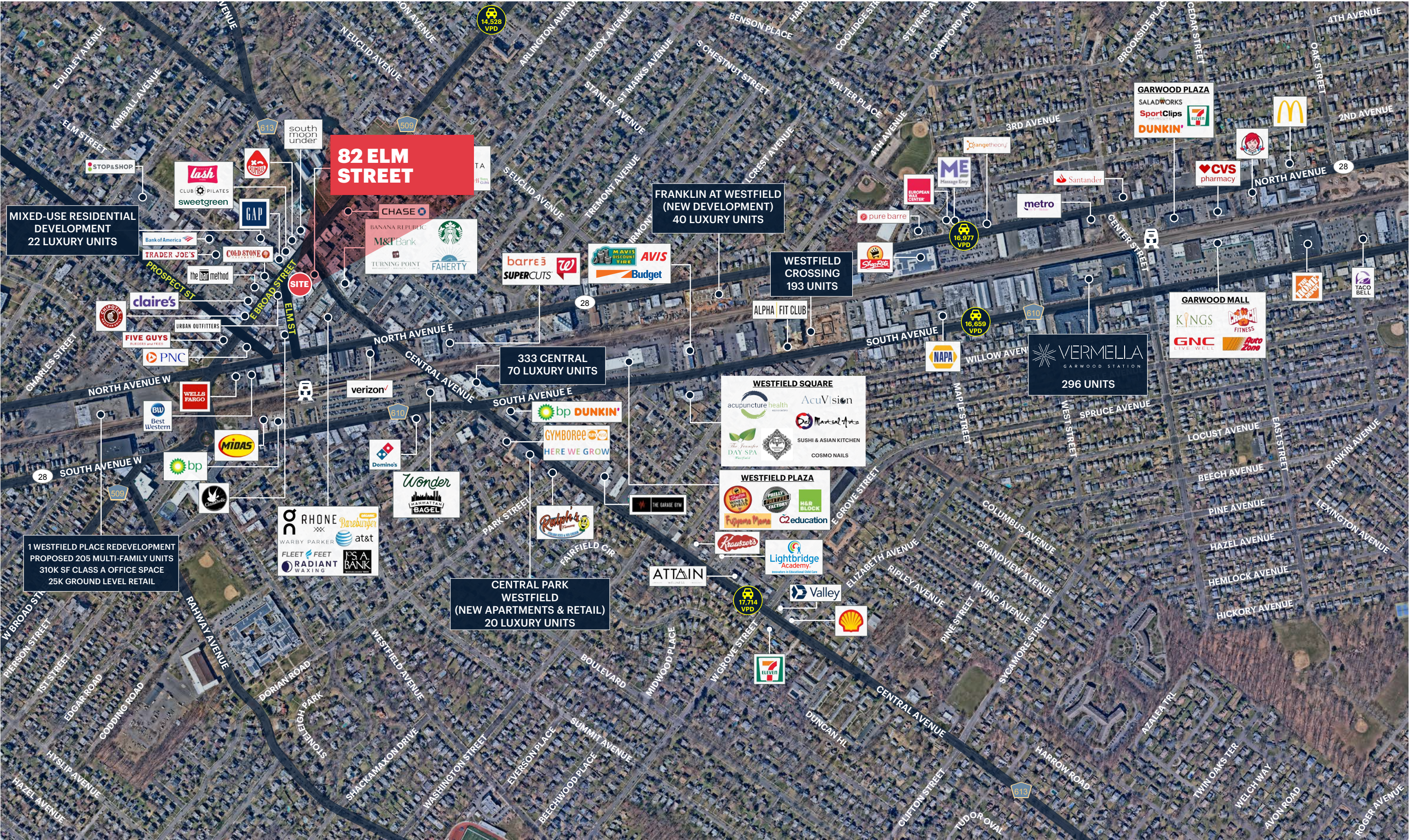



LOCATED IN THE CENTER OF DOWNTOWN WESTFIELD





This aerial map shows the Westfield Station area, featuring several parking lots and numerous businesses. The map includes the following labels:

- Streets:** COWPERTHWAIT PLACE, ORCHARD STREET, ELM STREET, PROSPECT STREET, NELSON PLACE, LUDLOW PLACE, CLARK STREET, FERRIS PLACE, NORTH AVENUE W, SOUTH AVENUE W, CENTRAL AVENUE, SOUTH AVENUE E, ROSS PLACE, LENOX AVENUE, ST PAUL STREET, ST MARKS AVENUE.
- Highways:** 613, 509, 610, 28.
- Businesses:** STOP&SHOP, ExamOne, Bank of America, TRADER JOE'S, sweetgreen, GAP, the bar method, COLD STONE CREAMERY, STRETCH LAB, claire's, Gong cha, CHIPOTE MEXICAN BURGERS, FIVE GUYS, PNC, WELLS FARGO, Best Western, south moon under, essilor, CHASE, CLUB PILATES, RUMBLE, ATHLETA, SUGARING NYC, FAHERTY, BANANA REPUBLIC, TURNING POINT, WARBY PARKER, Bareburger, City MD, THE UPS STORE, UPS, at&t, verizon, NTRANSIT, WESTFIELD STATION, HANNAH BAGEL, Wonder, CrossFit, barre3, SUPERCUTS, M&T Bank, Starbucks.
- Parking Lots:** LOT 1 (212 SPOTS), LOT 2 (71 SPOTS), LOT 3 (552 SPOTS), LOT 4 (142 SPOTS), LOT 5 (111 SPOTS), LOT 7 (99 SPOTS), LOT 8.
- Other Labels:** RT-28 W, RT-28 E, PLAZA, MAIZE FLEET FEET, JackRabbit, J.S. A. BANK, J.McAUGHIN, QDOBA MEXICAN EATS, URBAN OUTFITTERS, Learning Express Toys & Gifts, REYES, SUGARING NYC, BANANA REPUBLIC, TURNING POINT, WARBY PARKER, Bareburger, City MD, THE UPS STORE, UPS, at&t, verizon, NTRANSIT, WESTFIELD STATION, HANNAH BAGEL, Wonder, CrossFit, barre3, SUPERCUTS, M&T Bank, Starbucks.

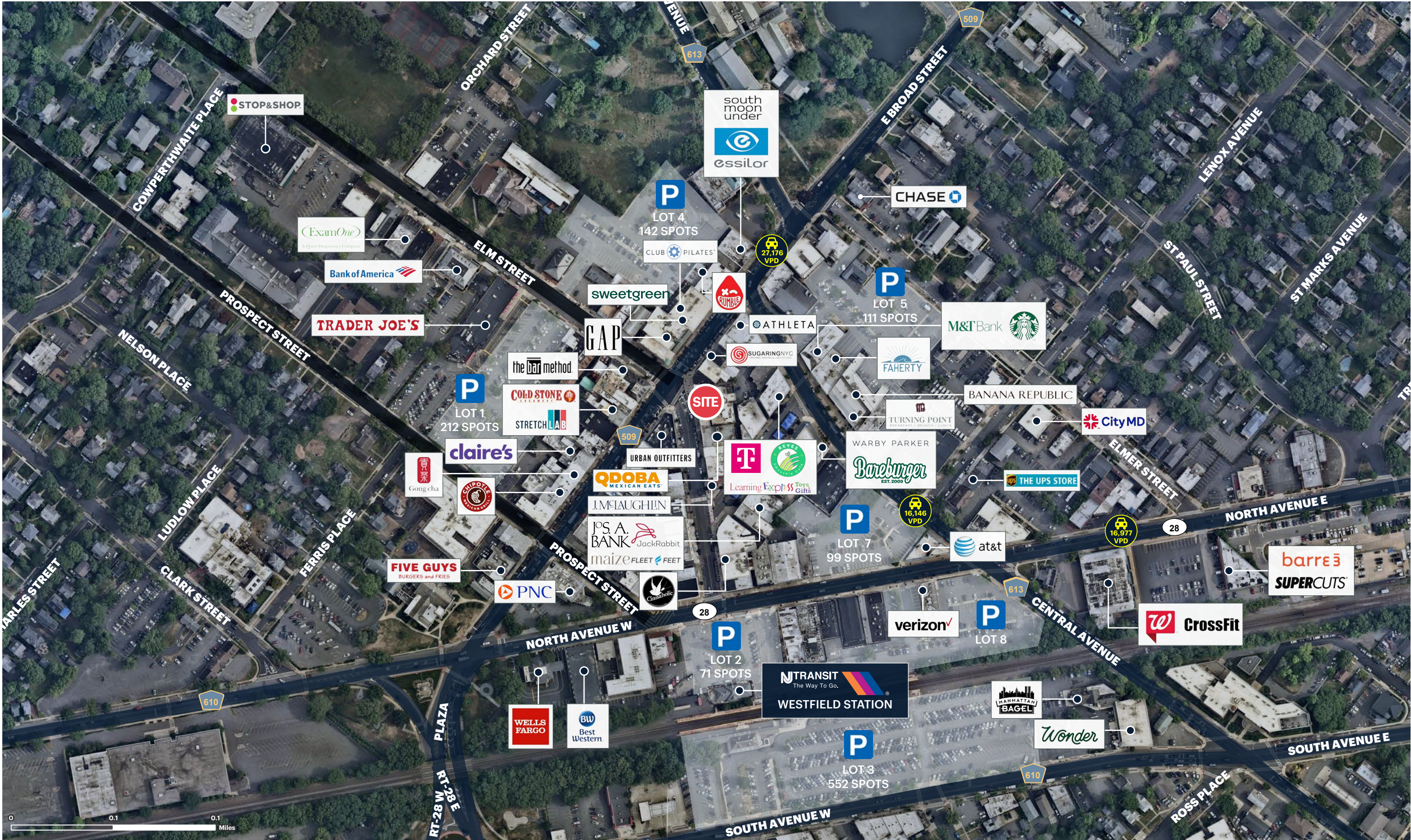



DEMOGRAPHICS



1 MILE RADIUS

|   |                                 |
|---|---------------------------------|
| <b>POPULATION</b>                       | <b>TOTAL BUSINESSES</b>         |
| 17,659                                  | 1,082                           |
| <b>HOUSEHOLDS</b>                       | <b>TOTAL EMPLOYEES</b>          |
| 6,217                                   | 16,507                          |
| <b>MEDIAN AGE</b>                       | <b>AVERAGE HOUSEHOLD INCOME</b> |
| 41.6                                    | \$288,168                       |
| <b>COLLEGE GRADUATES (Bachelor's +)</b> |                                 |
| 8,962 - 76.3%                           |                                 |

3 MILE RADIUS

|   |                                 |
|---|---------------------------------|
| <b>POPULATION</b>                       | <b>TOTAL BUSINESSES</b>         |
| 109,663                                 | 4,661                           |
| <b>HOUSEHOLDS</b>                       | <b>TOTAL EMPLOYEES</b>          |
| 39,481                                  | 63,873                          |
| <b>MEDIAN AGE</b>                       | <b>AVERAGE HOUSEHOLD INCOME</b> |
| 42.6                                    | \$240,490                       |
| <b>COLLEGE GRADUATES (Bachelor's +)</b> |                                 |
| 50,761 - 66.7%                          |                                 |

5 MILE RADIUS

|   |                                 |
|---|---------------------------------|
| <b>POPULATION</b>                       | <b>TOTAL BUSINESSES</b>         |
| 362,745                                 | 13,531                          |
| <b>HOUSEHOLDS</b>                       | <b>TOTAL EMPLOYEES</b>          |
| 128,843                                 | 176,615                         |
| <b>MEDIAN AGE</b>                       | <b>AVERAGE HOUSEHOLD INCOME</b> |
| 41.5                                    | \$186,659                       |
| <b>COLLEGE GRADUATES (Bachelor's +)</b> |                                 |
| 134,327 - 52.7%                         |                                 |

\*2025 estimates

## CONTACT EXCLUSIVE AGENTS

**CLARE GOLZ**

cgolz@ripconj.com  
201.636.7104

**LISA RICCA**

lricca@ripconj.com  
201.636.7449



611 River Drive  
3rd Floor  
Elmwood Park, NJ 07407  
201.777.2300

**Please visit us at [ripconj.com](https://www.ripconj.com) for more information**

This information has been secured from sources we believe to be reliable, but we make no representations as to the accuracy of the information. References to square footage are approximate. Buyer must verify the information and bears all risk for any inaccuracies.