

2009 SUMMER STREET

STAMFORD, CT



753 SF & 996 SF AVAILABLE

FOR LEASE



Choyce Peterson

Commercial Real Estate Specialists

UPDATED LOBBY AND BUILDING CONFERENCE ROOM



BUILDING AND LOCATION FEATURES

- Updated Entry, Lobby and Restrooms
- Building Conference Room
- 3/1,000sf Parking

- Walkable to Restaurants and Coffee Shops
- 0.7 Miles from Court House
- 0.6 Miles from Tully Health Center
- 1.6 Miles to Stamford Train Station
- Adjacent to Bus Stop and Traffic Light

2009 SUMMER

753sf & 996sf Available on 2nd floor

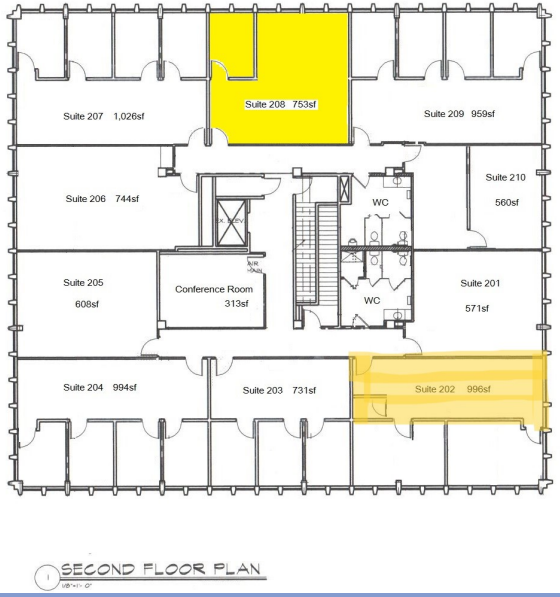

Suite 208 - 753sf

Suite 202- 996sf



2009 SUMMER

CONVENIENT LOCATION

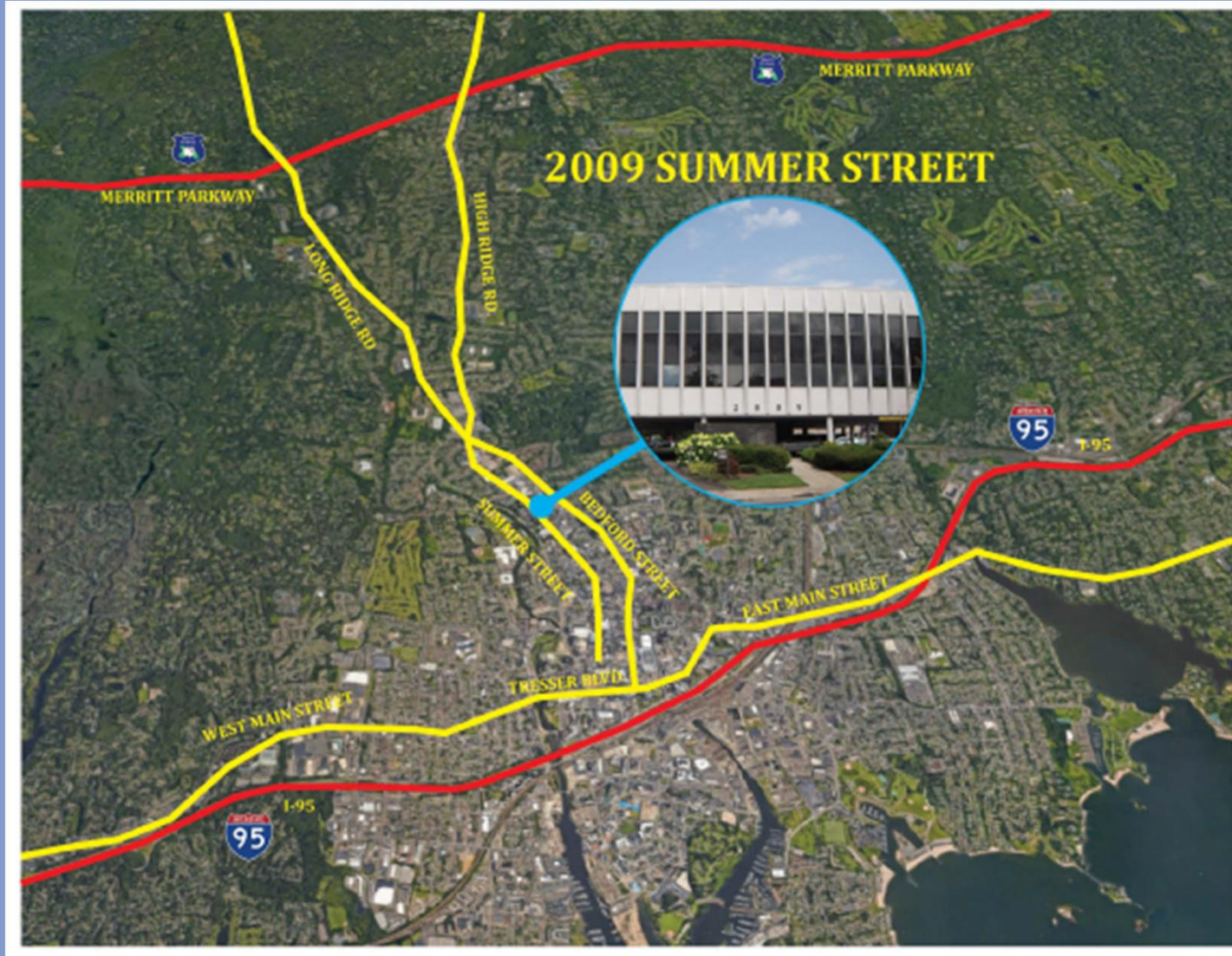

For more information contact:



JAMES M. RIFFICE | Associate | 203.224.9427 | jriffice@choycepeterson.com

CHARLENE S. O'CONNELL | Vice President | 203.961.8174 | coconnell@choycepeterson.com

Any information contained herein has been obtained from sources deemed reliable. However, Choyce Peterson, Inc., and/or their representatives, brokers or agents make no representation as to the accuracy of the information contained and offer the Property without express or implied warranties of any kind. Our principal(s) reserve the right to withdraw, modify, or condition the listing without prior notice.