

# OFFICE BUILDING FOR SALE

20173 Isle of Wight Industrial Park Road  
Smithfield, Isle of Wight County, Virginia



## ABOUT PROPERTY

- Located on Benn's Church Blvd. close to the new Riverside Smithfield Hospital
- 6,750 square feet on 1.14 acres
- Great visibility and access
- Ample parking
- County is open to rezoning for a medical use
- SALE PRICE: 1.1 million



### FOR MORE INFORMATION:

**ANDY STEIN**

757.640.9463

[AndyStein@HarveyLindsay.com](mailto:AndyStein@HarveyLindsay.com)

**HARVEY LINDSAY**  
COMMERCIAL REAL ESTATE

# FLOOR PLAN

20173 IWIP Rd

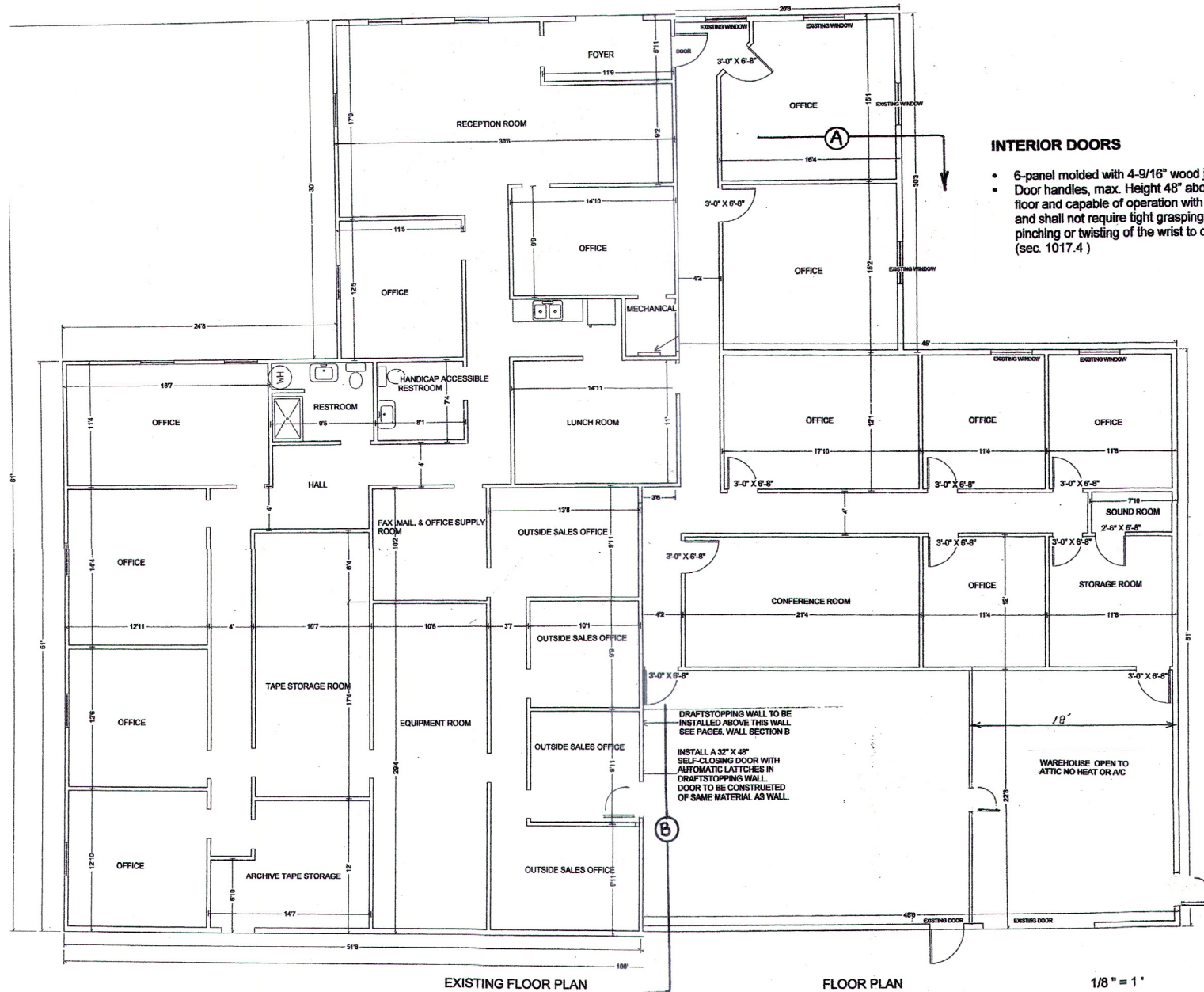

**FOR MORE INFORMATION:**

**ANDY STEIN**

757.640.9463

AndyStein@HarveyLindsay.com

**HARVEY LINDSAY**  
COMMERCIAL REAL ESTATE



# AERIAL VIEW

20173 IWIP Rd



FOR MORE INFORMATION:

**ANDY STEIN**

757.640.9463

[AndyStein@HarveyLindsay.com](mailto:AndyStein@HarveyLindsay.com)

**HARVEY LINDSAY**

COMMERCIAL REAL ESTATE



# DEMOGRAPHICS

20173 IWIP Rd

## 1 MILE



POPULATION  
121



HOUSEHOLDS  
60



AVERAGE HHI  
\$133,898



BUSINESSES  
19



EMPLOYEES  
156

## 3 MILES



POPULATION  
4,015



HOUSEHOLDS  
1,535



AVERAGE HHI  
\$130,079



BUSINESSES  
76



EMPLOYEES  
650

## 5 MILES



POPULATION  
21,135



HOUSEHOLDS  
8,204



AVERAGE HHI  
\$139,792



BUSINESSES  
511



EMPLOYEES  
4,139

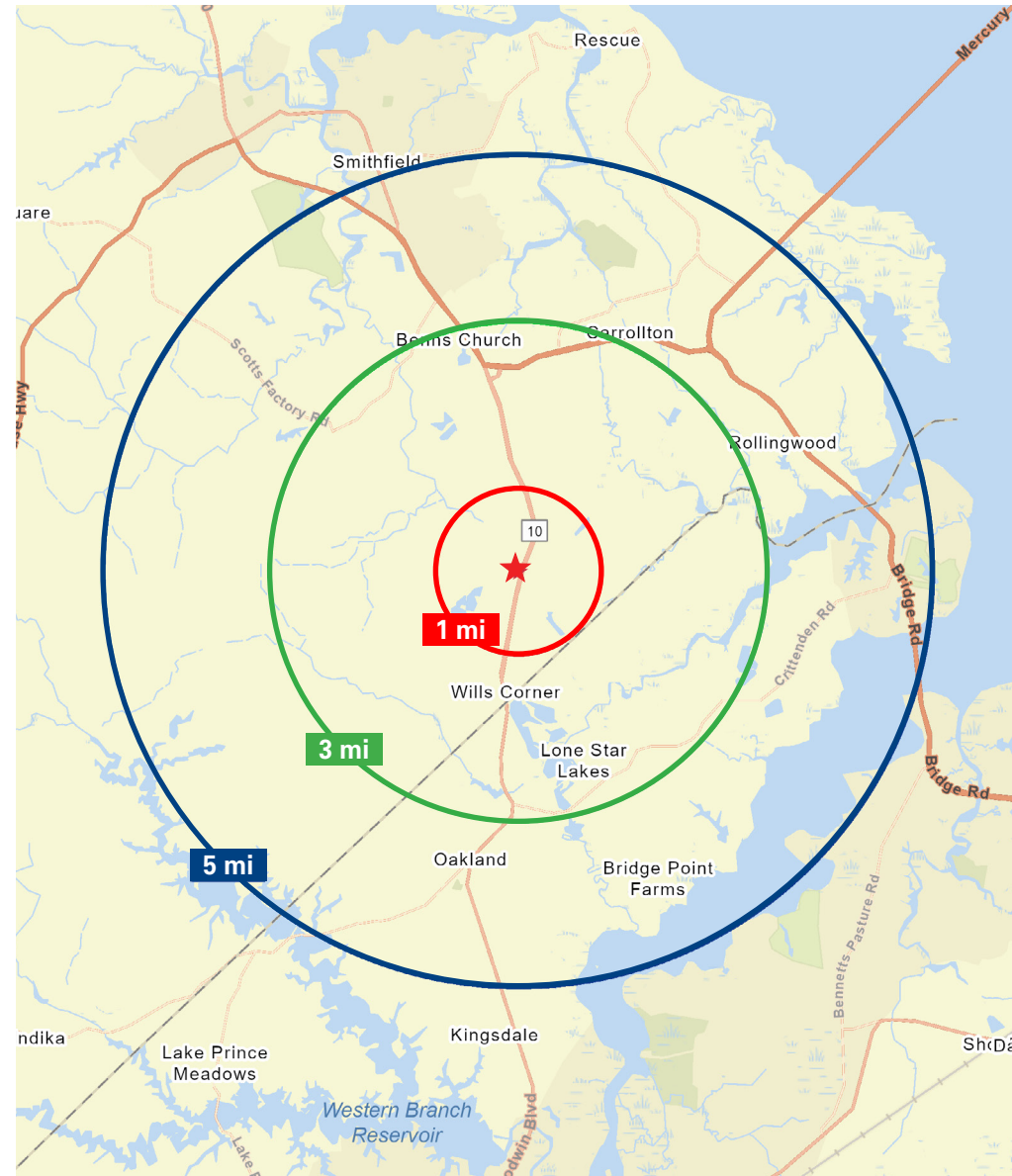

### FOR MORE INFORMATION:

**ANDY STEIN**

757.640.9463

[AndyStein@HarveyLindsay.com](mailto:AndyStein@HarveyLindsay.com)

**HARVEY LINDSAY**  
COMMERCIAL REAL ESTATE