

Preston Lake Grocery Anchored Development

Spotswood Trail, Harrisonburg, Virginia

8 OUTPARCELS AVAILABLE FOR LEASE



DAVID CRAWFORD
First Vice President
804 697 3446
david.crawford@thalhimer.com

KEVIN SOUTH
Principal
804 344 7181
kevin.south@thalhimer.com



Preston Lake Grocery Anchored Development

Spotswood Trail, Harrisonburg, Virginia

- Ground lease or build-to-suit options available
- Flexible pad sizes from ± 0.5 acres up to ± 3 acres
- Located within Preston Lake, a 760-unit master-planned residential community
- Highly amenitized environment featuring sidewalks, open spaces, landscaped buffers with fencing, and ample outdoor seating
- Drive-thrus permitted by right
- Excellent visibility with signalized access from Stone Spring Road and Spotswood Trail
- Strong nearby demand drivers, including:
 - Massanutten Resort — a 2,600-unit, four-season destination
 - Sentara RMH Medical Center
 - James Madison University
 - Merck's new \$5 billion pharmaceutical expansion
- Just 2.5 miles (± 7 minutes) from the JMU campus



Preston Lake Grocery Anchored Development

Spotswood Trail, Harrisonburg, Virginia

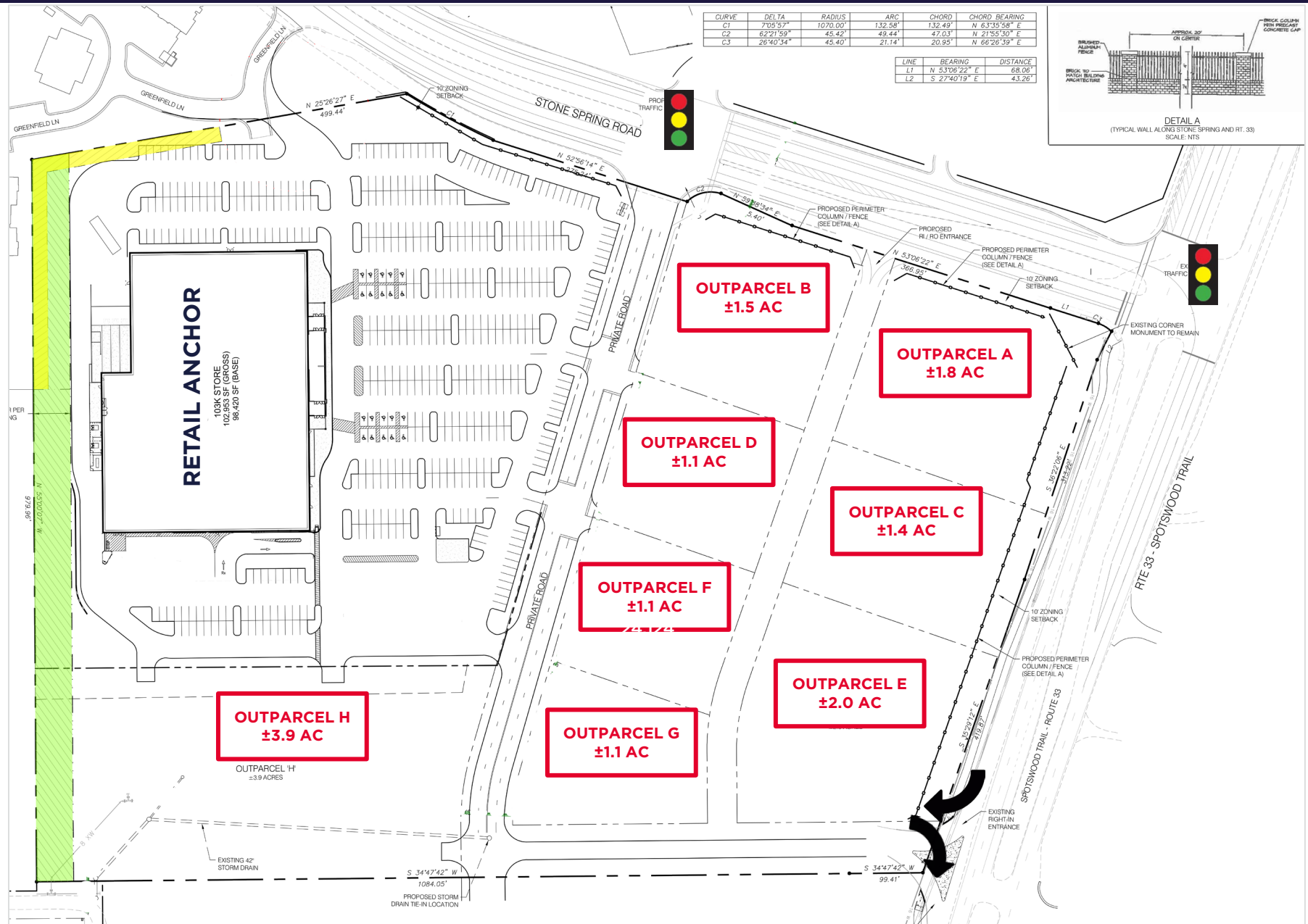



For more information, please contact:

David Crawford | david.crawford@thalhimer.com | 804 697 3446

Kevin South | kevin.south@thalhimer.com | 804 344 7181



CUSHMAN & WAKEFIELD

THALHIMER

Thalhimer Center
1100 W. Broad Street
Glen Allen, VA 23060
thalhimer.com

Independently Owned and Operated / A Member of the Cushman & Wakefield Alliance

Cushman & Wakefield | Thalhimer © 2025. No warranty or representation, express or implied, is made to the accuracy or completeness of the information contained herein, and same is submitted subject to errors, omissions, change of price, rental or other conditions, withdrawal without notice, and to any special listing conditions imposed by the property owner(s). As applicable, we make no representation as to the condition of the property (or properties) in question.