





PLATTE
STREET
RETAIL PORTFOLIO

WELCOME TO PLATTE STREET



HIGHLIGHTS

- Historic brick & timber mixed-use project at the nexus of LoDo & LoHi
- Unparalleled location in the heart of Platte Street
- 2nd generation restaurant infrastructure in place
- Ideal blend of boutique retailers, popular restaurants, and creative office users
- Direct access to Platte Street Plaza & Highland Bridge
- Incredible walking, biking, and commuter access to Downtown Denver
- Over 14,000 multi-family units within a mile





PLATTE
STREET

RETAIL PORTFOLIO

RETAIL SITE PLAN

LOWER LEVEL



- AVAILABLE
- LEASED
- PATIO

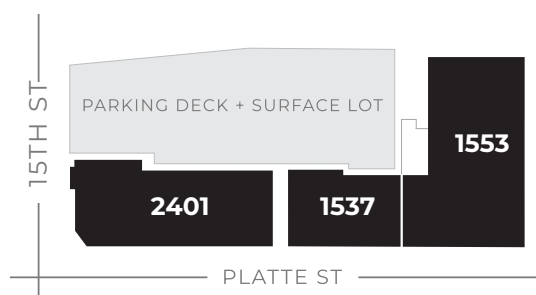

GROUND LEVEL

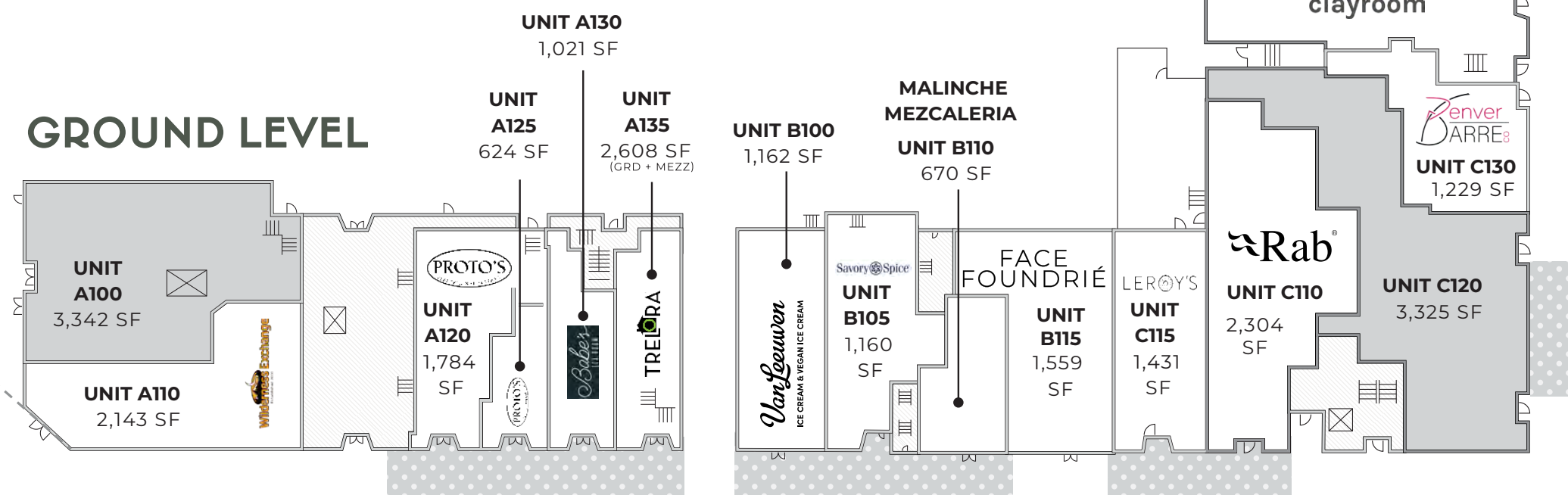





PLATTE
STREET

RETAIL PORTFOLIO

DEMOGRAPHICS

	1 mile	3 miles	5 miles
POPULATION	42,511	238,749	487,920
HOUSEHOLDS	23,210	118,461	223,777
AVG HOUSEHOLD INCOME	\$128K	\$103K	\$102K





PLATTE STREET

RETAIL PORTFOLIO

Union Station
12 MIN WALK

Commons Park
12 MIN WALK

16th Street Mall
10 MIN WALK

Larimer Square
15 MIN WALK

Ball Arena
15 MIN WALK

Elitch Gardens
15 MIN WALK

REI
1 MIN WALK

246,000 VPD

Highland Arch Bridge
1 MIN WALK



ASANA
PARTNERS



SAM ZAITZ
+1 303 931 1201
sam.zaitz@jll.com

JEFF FELDMAN
+1 214 564 7188
jeff.feldman@jll.com

BROKERAGE DISCLOSURE

Although information has been obtained from sources deemed reliable, neither Owner nor JLL makes any guarantees, warranties or representations, express or implied, as to the completeness or accuracy as to the information contained herein. Any projections, opinions, assumptions or estimates used are for example only. There may be differences between projected and actual results, and those differences may be material. The Property may be withdrawn without notice. Neither Owner nor JLL accepts any liability for any loss or damage suffered by any party resulting from reliance on this information. If the recipient of this information has signed a confidentiality agreement regarding this matter, this information is subject to the terms of that agreement. ©2023. Jones Lang LaSalle IP, Inc. All rights reserved.