

580 THIRD STREET BUSINESS PARK

580 3RD STREET, LAKE ELSINORE, CALIFORNIA 92530

FOR LEASE

+/- 1,430 SF - +/-1,500 SF
INDUSTRIAL SPACE

YEAR END PROMO!

FOR NEW LEASES SIGNED BY 12/31/24:

*50% DISCOUNT ON 1ST

6 MONTH'S BASE RENT OAC

**\$1 SF BROKER BONUS



FOR MORE INFORMATION, PLEASE CONTACT:

CAREY PASTOR | Senior Vice President

(951) 297-7434 | cpastor@cbsocalgroup.com

CalDRE License # 01403298



**COLDWELL
BANKER
COMMERCIAL
SC**

580 THIRD STREET BUSINESS PARK

580 3RD STREET, LAKE ELSINORE, CALIFORNIA 92530

FOR LEASE
+/- 1,430 SF - +/-1,500 SF
INDUSTRIAL SPACE

PROPERTY HIGHLIGHTS

- Small industrial space for lease
- Reception area, 1 private office, balance of space is warehouse with front loading roll up door
- M-1 zoning – City of Lake Elsinore
- Close proximity to I-15 free via Central Avenue, on/off ramp
- Located near a number of new retail and restaurants including: Lowe's, The Home Depot, Costco, Chili's Wendy's, Panda Express, Target, Marshalls, Panera, and more



580 THIRD STREET BUSINESS PARK

580 3RD STREET, LAKE ELSINORE, CALIFORNIA 92530

FOR LEASE
 +/- 1,430 SF - +/-1,500 SF
INDUSTRIAL SPACE

AVAILABILITY

UNIT	UNIT SIZE	MONTHLY RENTAL RATE	DESCRIPTION
G	±1,430 SF	\$1,716.00 Base Rent + \$787.00 CAOE Per month*	Reception area, 1 private office, 1 restroom, warehouse with roll up door.
H	±1,500 SF	\$1,800.00 Base Rent + \$825.00 CAOE Per month*	Reception area, 1 restroom, warehouse with roll up door.

* 2024 Common Area Operating Expenses (CAOE) are estimated and subject to annual reconciliation and adjustment

SITE PLAN

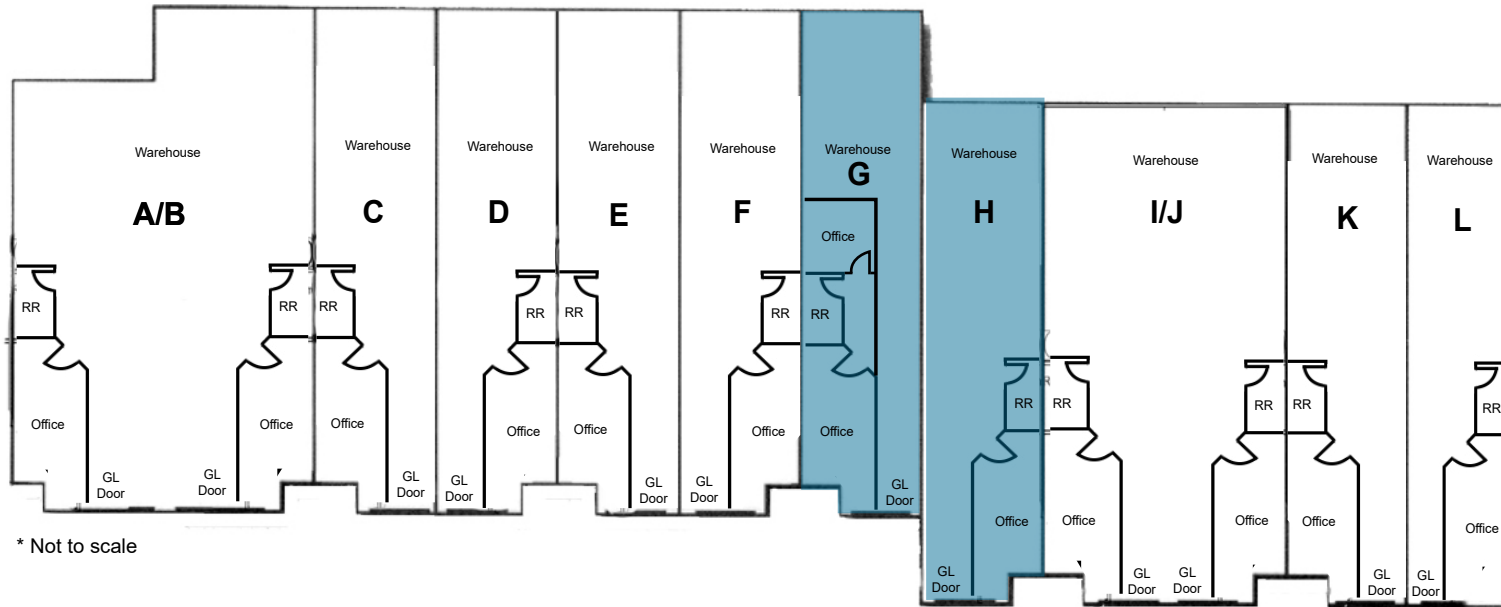

* Not to scale

Typical Floor Plan

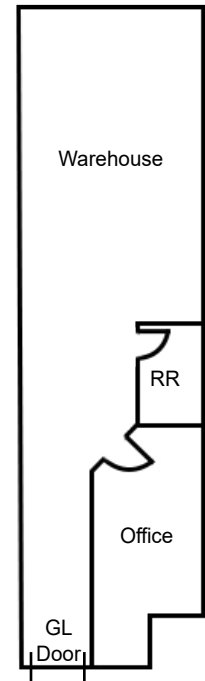

* Not to scale

580 THIRD STREET BUSINESS PARK

580 3RD STREET, LAKE ELSINORE, CALIFORNIA 92530

FOR LEASE
+/- 1,430 SF - +/-1,500 SF
INDUSTRIAL SPACE



580 THIRD STREET BUSINESS PARK

580 3RD STREET, LAKE ELSINORE, CALIFORNIA 92530

FOR LEASE

+/- 1,430 SF - +/-1,500 SF
INDUSTRIAL SPACE



FOR MORE INFORMATION, PLEASE CONTACT:

CAREY PASTOR

Senior Vice President

951.297.7434

cpastor@cbcsocalgroup.com

CalDRE # 01403298

27368 Via Industria | Suite 102
Temecula | California | 92590
t 951.200.7683 | f 951.239.3147
cbcsocalgroup.com



**COLDWELL
BANKER
COMMERCIAL**
SC