



MIDWAY BUSINESS PARK

12 Buildings Total | 258,846 SF Total | 2,000-40,000 SF Available

OFFERING SUMMARY

Midway Business Park is a premier industrial development spanning 258,846 square feet across twelve versatile buildings in the heart of Richland Hills, Texas. Strategically located in central Tarrant County, this dynamic business hub offers exceptional freeway visibility and immediate access to major highways, placing tenants just minutes from downtown Fort Worth and DFW International Airport. Surrounded by a robust and diverse labor pool, Midway Business Park is designed to accommodate a wide range of tenant needs, with flexible suite sizes from 2,000 to 40,000 square feet. Whether you're a growing business or an established enterprise, Midway Business Park delivers the accessibility, visibility, and workforce proximity essential for success.

Owned by:

Ackerman & Co.

Leased by:

HPI

6,048 SF FOR LEASE

MBP | MIDWAY BUSINESS PARK

2842 Dogwood Park, Richland Hills, TX 76118
Suite 100

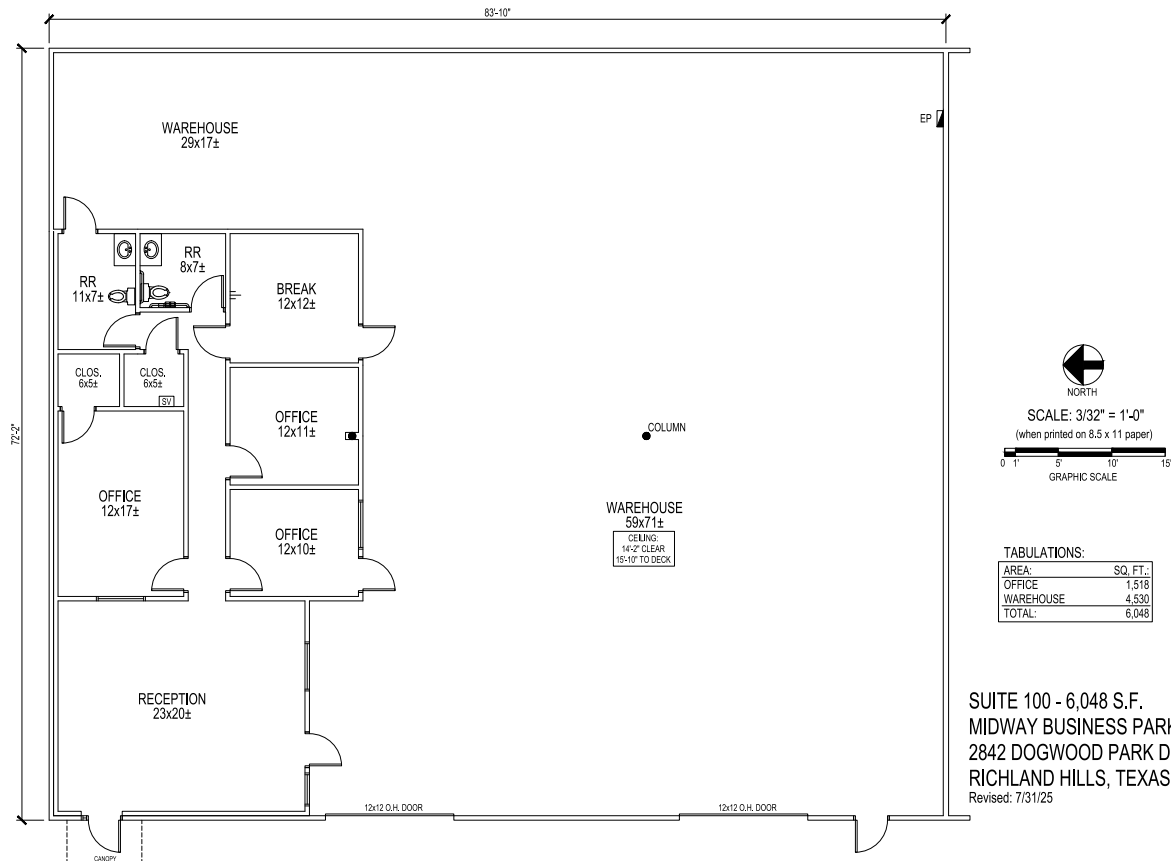

SUITE 100 - 6,048 S.F.
MIDWAY BUSINESS PARK
2842 DOGWOOD PARK DRIVE
RICHLAND HILLS, TEXAS
Revised: 7/31/25

HIGHLIGHTS

- | | |
|---------------------------------|--|
| 6,048 Total SF | 14' Clear Height |
| 4,530 SF Warehouse | Ample Parking |
| 1,518 SF Office | Billboard Sign Available |
| Two (2) 12x12 Grade Level Doors | Prime Location with Close Proximity to Highway 121, Loop 820 + I-35W |



FOR LEASE

MBP | MIDWAY BUSINESS PARK



FOR LEASE

MBP | MIDWAY BUSINESS PARK

