

HARRIMAN COMMONS

Routes 17/32 & 6 | Monroe (Harriman), NY | Orange County

RETAIL/PADS SITES/
ANCHOR SPACE FOR LEASE

706,236 SF REGIONAL POWER CENTER



BROKER CONTACT

SCOTT MESHIL
914-237-3400, Ext. 106
Scott@RoyalPropertiesInc.com

JEFF KINTZER
914-237-3400, Ext. 103
Jeff@RoyalPropertiesInc.com



HARRIMAN COMMONS

Routes 17/32 & 6 | Monroe (Harriman), NY | Orange County

RETAIL/PADS SITES/
ANCHOR SPACE FOR LEASE

1,650 SF – 30,247 SF AVAILABLE



AVAILABLE:

1,650 SF In-Line (16.5' x 100')
1,930 SF End Cap (13' x 120' irr.)
5,827 SF End Cap (50' x 107' irr.)
30,247 SF (170' x 172')

PAD SITES AVAILABLE:

2,850 SF (42.3' x 66.3' irr.) – PAD E1
2,865 SF (34.9' x 83.17' irr.) – PAD E2
3,000 SF (44.3' x 66.33') – PAD C1

ADDITIONAL INFORMATION:

- 706,236 SF Regional Power Center
- Easy Access from Routes 17/6 & 32
- A mile from Woodbury Common Premium Outlets
- Future Pad Available In Front Of BJ's Wholesale Club and Next to New BJ's Gas Station
- Two Future Pad Sites Each With Drive-thru Available
- Pad Sites Have Flexible Footprints and are Ideal for Fast Food
- 3,800± Parking Spaces

JOIN CO-TENANTS:

Walmart, Target, The Home Depot, BJ's Wholesale Club, PetSmart, Burlington, Old Navy, Party City, Dollar Tree, Famous Footwear, America's Best, World of Appliances (coming soon), and more

NEIGHBORING RETAILERS:

Stop & Shop, Planet Fitness, TJ Maxx, Barneys New York Warehouse, Dior, GAP, Bare + Beauty, Columbia Factory Store, Vineyard Vines, GUESS, J. Crew Factory, Verizon, Walgreens, AutoZone, Chase Bank, Garnet Health, Outback Steakhouse, Mattress Firm, Taco Bell, McDonald's, CVS, ShopRite, Kohl's, Michael's, Verizon, Dunkin', Rite Aid, Great Clips, Burger King, AT&T, Dollar General, Advance Auto Parts and many more

TRAFFIC COUNTS:

56,182 Cars per Day Along Route 17/6
29,404 Cars per Day Along Route 32

RENT:

Call For Details

NNN:

\$5.50/SF

BROKER CONTACT

SCOTT MESHIL

914-237-3400, Ext. 106

Scott@RoyalPropertiesInc.com

JEFF KINTZER

914-237-3400, Ext. 103

Jeff@RoyalPropertiesInc.com

ROYAL
PROPERTIES

HARRIMAN COMMONS

Routes 17/32 & 6 | Monroe (Harriman), NY | Orange County

RETAIL/PADS SITES/
ANCHOR SPACE FOR LEASE

1,650 SF – 30,247 SF AVAILABLE

PARCEL I		
		SQ. FT.
A	WALMART	203,990
B	HOME DEPOT	110,000
C	BJ'S WHOLESALE	108,532
C1	AVAILABLE PAD (44.3' x 66.33')	3,000

PARCEL II		
		SQ. FT.
D	TARGET	124,717
1A	AVAILABLE (50' x 107' irr.)	5,827
1B	WORLD OF APPLIANCES	6,125
1C	STORAGE	5,317
2	OLD NAVY	15,277
3	PARTY CITY	14,136
4	DOLLAR TREE	10,640
5	BURLINGTON	23,986
6	AVAILABLE (170' x 172')	30,247
7	PETSMART	20,087
9	FIVE BELOW	11,012
9A	AMERICA'S BEST	4,320
9B	AVAILABLE (13' x 120' irr.)	1,930
10	RIGHTLY DENTAL	1,650
11	AVAILABLE (16.5' x 100')	1,650
12	FAMOUS FOOTWEAR	6,800
E1	AVAILABLE PAD (42.3' x 66.3')	2,850
E2	AVAILABLE PAD (34.9' x 83.17')	2,865

PHASE III EXPANSION		
		ACRES
F	FUTURE RETAIL/OFFICE	3.52



56,182 VPD

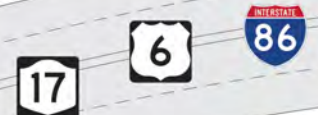

ROYAL
PROPERTIES

HARRIMAN COMMONS

Routes 17/32 & 6 | Monroe (Harriman), NY | Orange County

RETAIL/PADS SITES/
ANCHOR SPACE FOR LEASE

PROPOSED RESTAURANT PADS AVAILABLE

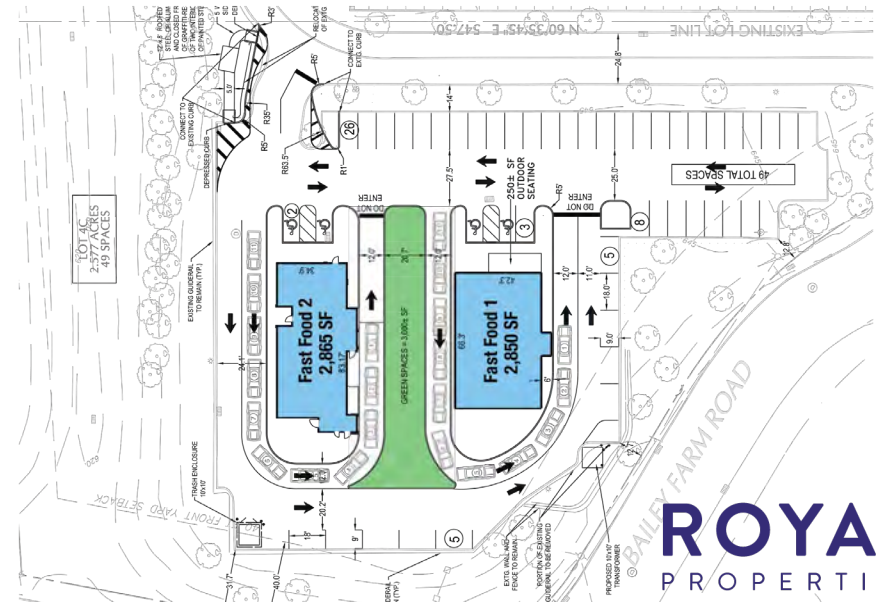
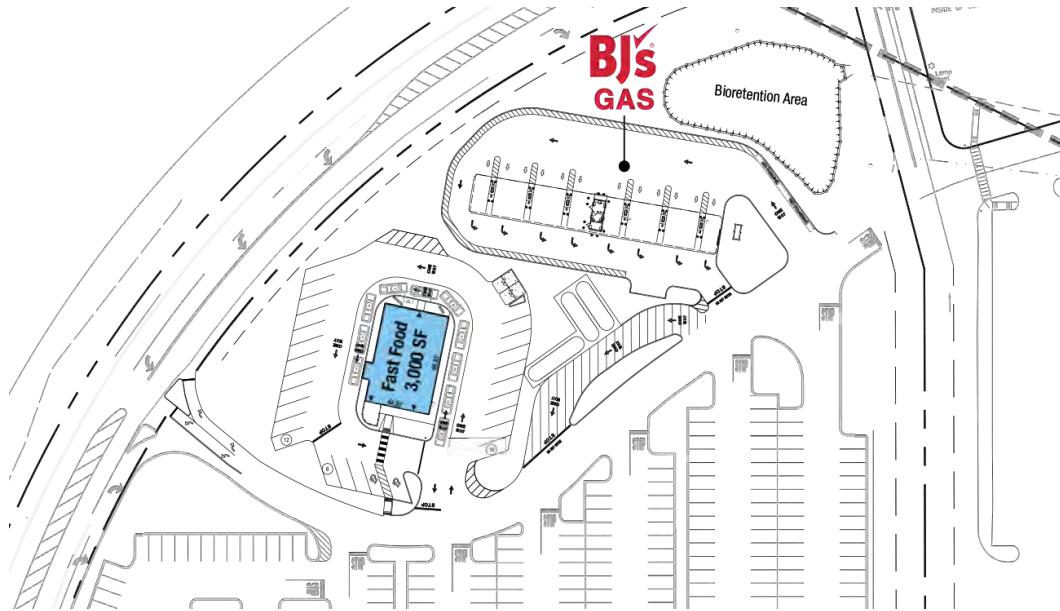

ROYAL
PROPERTIES

HARRIMAN COMMONS

Routes 17/32 & 6 | Monroe (Harriman), NY | Orange County

RETAIL/PADS SITES/
ANCHOR SPACE FOR LEASE

1,650 SF – 30,247 SF AVAILABLE

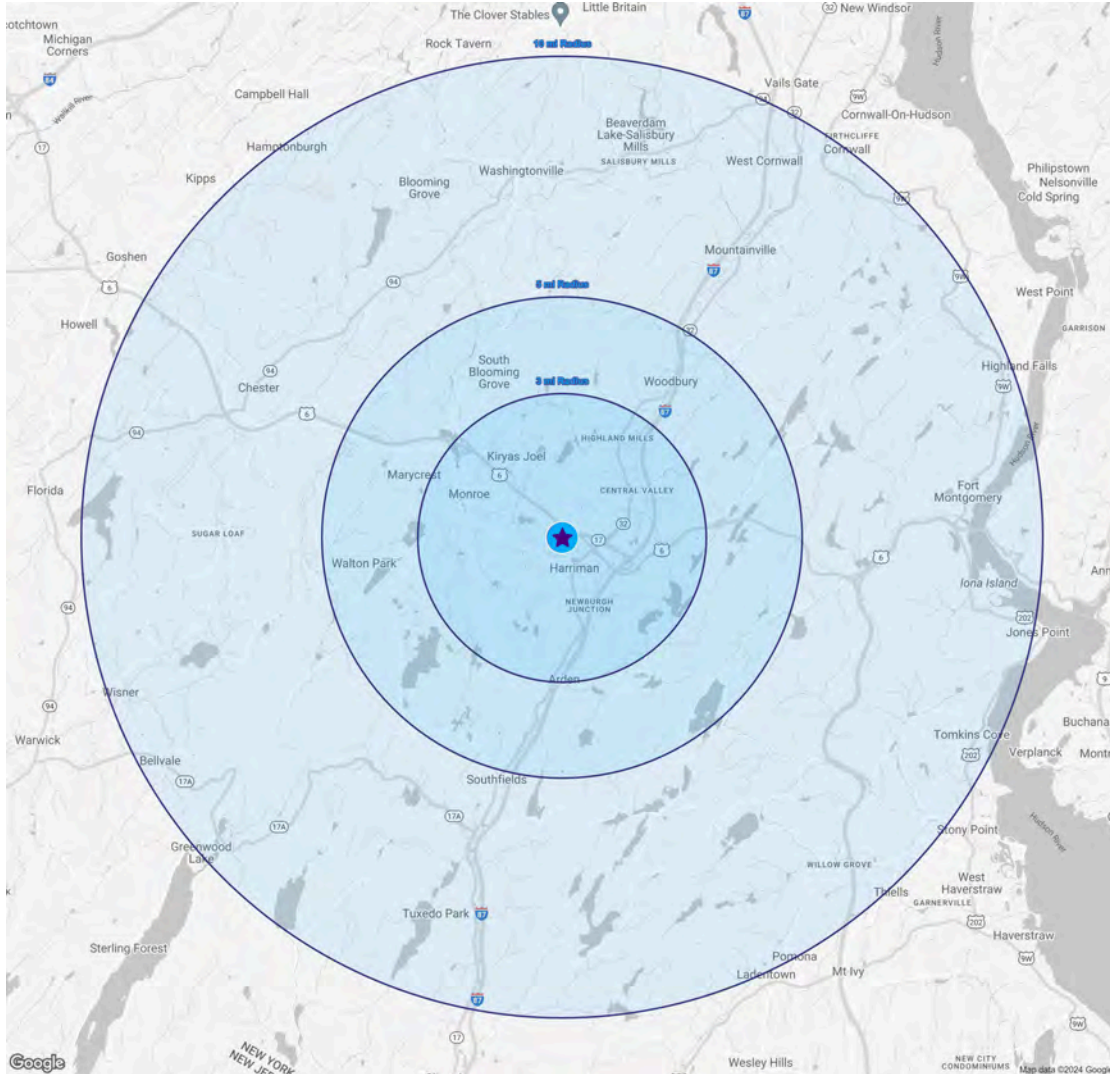

3 Mile Radius

2024 Est. Population	60,551
2024 Est. Avg. HH Income	\$123,243
Households	14,935
Total Employees	14,977

5 Mile Radius

2024 Est. Population	76,768
2024 Est. Avg. HH Income	\$129,479
Households	19,987
Total Employees	16,456

10 Mile Radius

2024 Est. Population	140,721
2024 Est. Avg. HH Income	\$150,597
Households	42,526
Total Employees	32,882

ROYAL
PROPERTIES

HARRIMAN COMMONS

Routes 17/32 & 6 | Monroe (Harriman), NY | Orange County

RETAIL/PADS SITES/
ANCHOR SPACE FOR LEASE

1,650 SF – 30,247 SF AVAILABLE

